

8856

B.M. Spike in East End of Culvert
headwall 15' N. of S. Lomita Blvd.
300' W. of President Ave.
Elev. 46.25
Per L.A.C.E. - F.B. 21205-18

LOMITA BLDG. DIST. No 7L

Note:
No representative of the County Engineer will survey or layout any portion of the work.
The owner or his Authorized representative shall furnish the County Engineer with grade sheets and stations at all house laterals and pipe branches and shall provide stakes for them at their proper locations with stationing plainly marked, any change in location shall be requested in writing by the owner or his Authorized representative.
No revisions shall be made in this plan without the approval of the County Engineer.

1. Use standard Manhole, Frame and Cover 5'-a-117.
2. Use standard strength pipe - Except as noted.
3. Use cement for all vitrified clay pipe joints.
4. Resurface all trench within paved area to meet Los Angeles County Road Dept. requirements.
5. Excavate 4 feet of sewer at points of interference with poles per 5-a-118.
6. All structures shall be brick sewer structures 5-a-104.
7. House laterals shall be constructed with inverts at property line 1/2" below City's Grade.
8. For allowable leakage test, use formula No. 1, spec. Sec. 51.
9. Provide stakes on the property lines or property lines produced at right angles to the sewer line at the centerline of each manhole.

PROFILE, ALIGNMENT AND GRADE OF SANITARY SEWERS TO BE CONSTRUCTED IN

TRACT No. 15915

PRIVATE CONTRACT No. 2803

W.S. 28
August 1963

SHEET 1 OF 1 SHEET
Prepared in the office of
Engineering & Surveying Service Co.
By E. Hewitt & E. Epperson
1963

Page 1
P.C. 2803
U.N. 093171

18,855

CITY OF TORRANCE
CHECKED BY Richard W. Bishop REBELO
APPROVED Richard W. Bishop REBELO
CITY ENGINEER

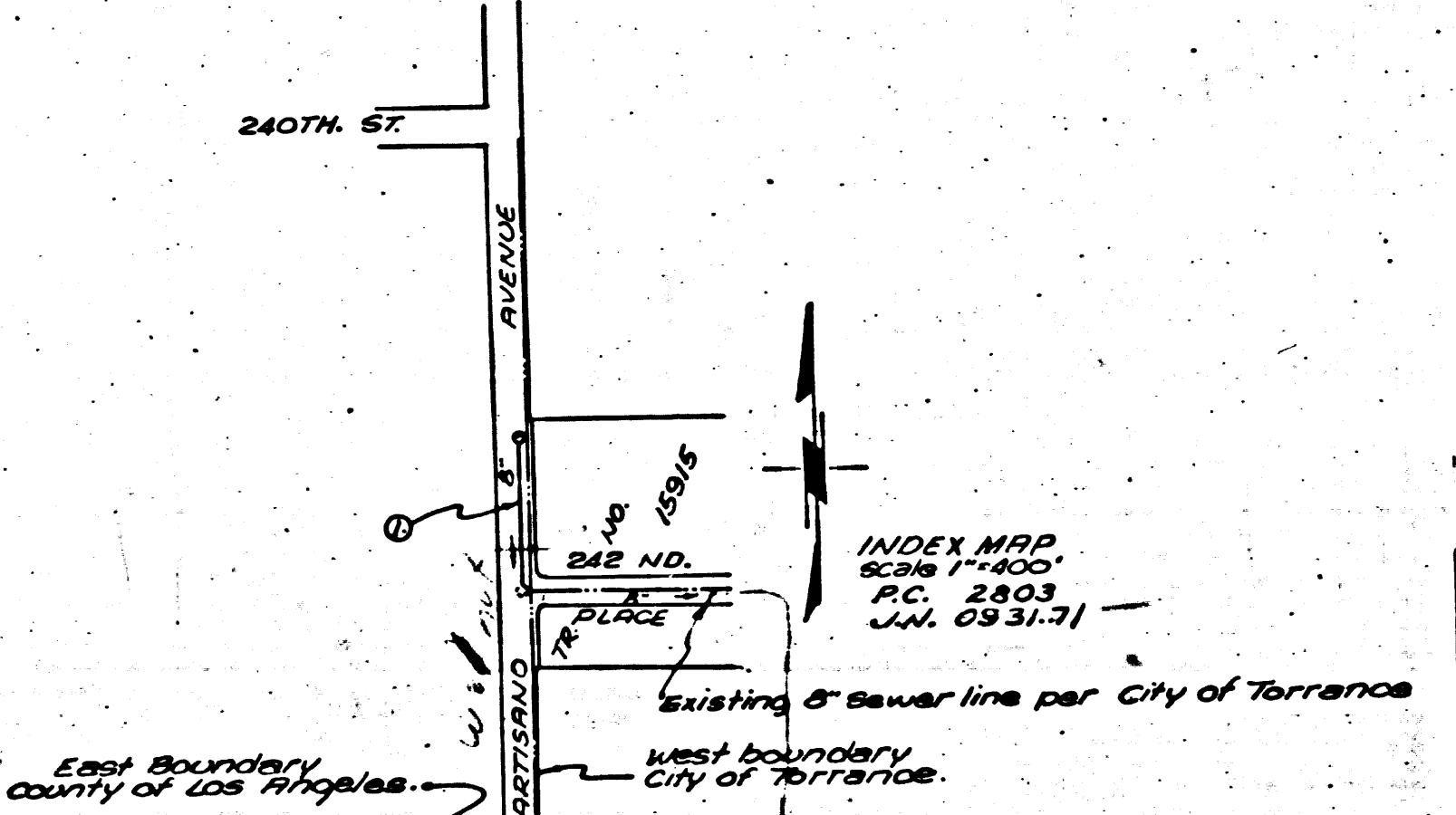

SHEET NO	PAGES
1	1-2

COLLECT CHARGES
AS INDICATED
2x 4/1/63

APPROVED, WILLIAM J. FOX
Sanitation Engineer

APPROVED, A. M. RAWN
Chief Engineer, District No. 5
By George J. [Signature]
District Engineer

Checked by Richard W. Bishop 5-25-64
Office of the County Engineer Reg. C.E. No. 1860

checked 8-17-54 McFarren

TRACT No. 15915
P.C. 2803
U.N. 093171
PC 2803
U.N. 093171
PC 2803
U.N. 093171

P.C. 2803

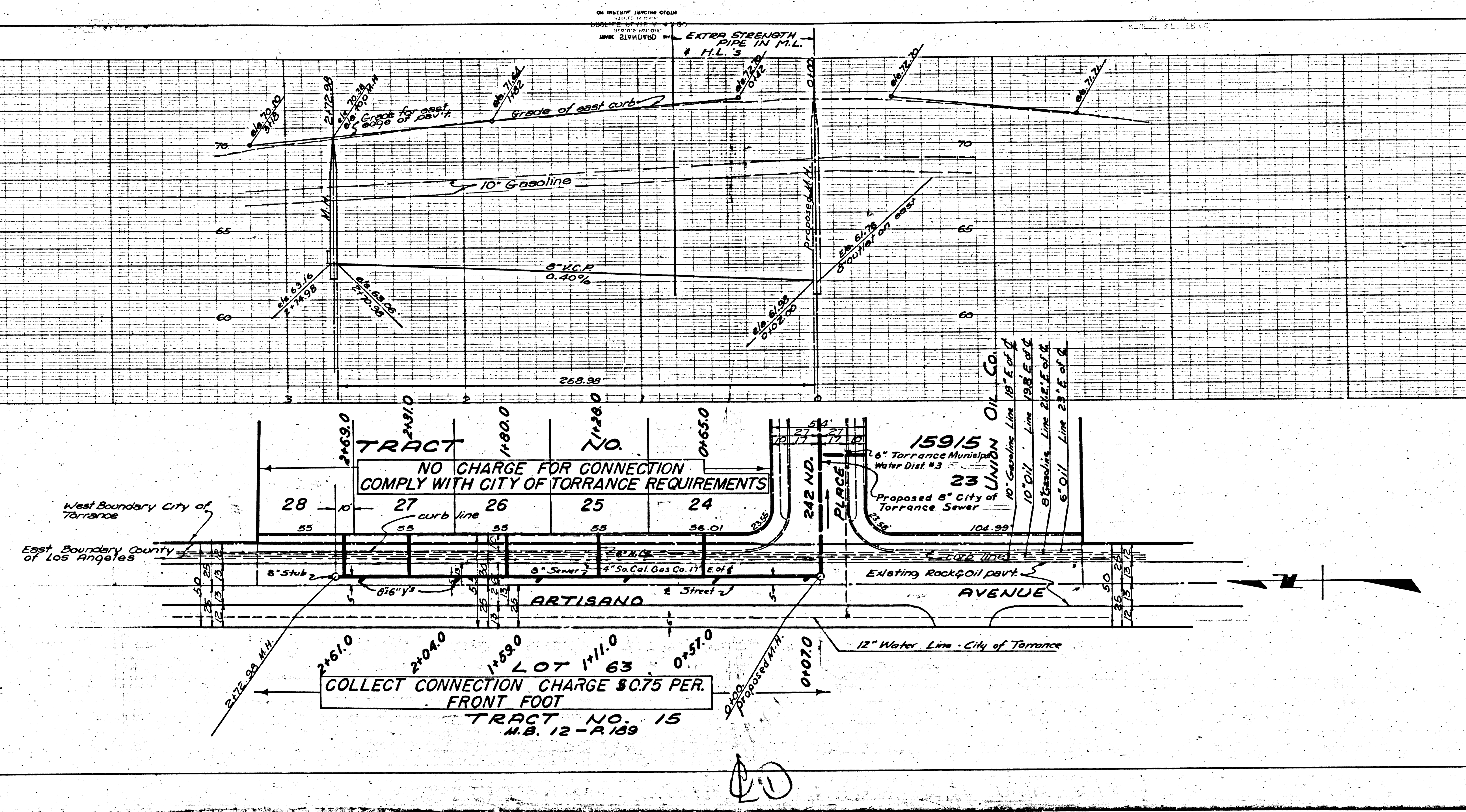

Page 2
P.C. 2803
JAN. 0931.71

18856