

PC 2820  
J.N. F.773  
Page 2

17,704

WHITTIER BLDG. DIST. NO. 11

DM: 88-35 EG-191, 238 FB-1176 29-9  
BROADWAY & 1ST ALLEY S. OF WHITTIER BLVD.  
S. F. 408-87-SPIKE IN CURB, 10 FT. 16"  
OF SOUTH END OF C.R.

- NOTE:
1. NO REPRESENTATIVE OF THE COUNTY ENGINEER WILL SURVEY OR LAY OUT ANY PORTION OF THE WORK.
  2. THE OWNER OR HIS AUTHORIZED REPRESENTATIVE SHALL FURNISH THE COUNTY ENGINEER WITH GRADE SHEETS AND STATIONS FOR ALL HOUSE LATERALS AND BRANCHES AND SHALL PROVIDE STAKES FOR THEM AT THEIR PROPER LOCATIONS WITH STATIONING PLAINLY MARKED. ANY CHANGES IN LOCATION SHALL BE REQUESTED IN WRITING BY THE OWNER OR HIS REPRESENTATIVE.
  3. NO REVISIONS SHALL BE MADE IN THESE PLANS WITHOUT APPROVAL OF THE COUNTY ENGINEER.
  4. USE STANDARD MANHOLE FRAME AND COVERS 5'-6" HT.
  5. USE STANDARD STRENGTH PIPE EXCEPT AS NOTED.
  6. USE CEMENT MORTAR FOR ALL VITRIFIED CLAY PIPE JOINTS.
  7. REINFORCE ALL TRENCH WITHIN RAISED RASCA TO MEET L.A. COUNTY ROAD DEPT. REQUIREMENTS.
  8. ENCASE FOUR FEET OF TOWER AT POINTS OF INTERFERENCE WITH ROADS 5'-6" HT.
  9. HOUSE LATERALS TO BE CONSTRUCTED WITH 1/4" RISE PER FOOT TO PROPERTY LINE EXCEPT AS NOTED.
  10. ALL STRUCTURES SHALL BE BENCH SEWER STRUCTURES 5'-6" DIA. PRODUCED AT RIGHT ANGLES TO THE SEWER LINE AT THE CENTER LINE OF EACH MANHOLE.
  11. FOR LEAKAGE TEST USE FORMULA N1 SPEC'S SECTION 51 10. WIDE TAGS NOT REQUIRED.

RC.2120  
J.N.F.773  
Page 1

PROFILE, ALIGNMENT, AND GRADE OF  
**SANITARY SEWERS**  
TO BE CONSTRUCTED IN  
**BROADWAY**  
BETWEEN WHITTIER BLVD. AND 1ST ALLEY SOUTH OF WHITTIER BLVD.  
**1ST ALLEY SOUTH OF WHITTIER BLVD.**  
FROM BROADWAY TO 165° WESTERLY

17,703

PRIVATE CONTRACT NO. 2820  
W. S. 37  
ONE SHEET  
SCALE: VERT. 1" = 4'  
HORIZ. 1" = 40' OCT. 1953

PREPARED IN THE OFFICE OF  
TED H. JAENN CIVIL & STRUC. ENG.  
BY: *Ted H. Jaenn*  
FOR LEGEND SEE PLAN NO. S-a-66

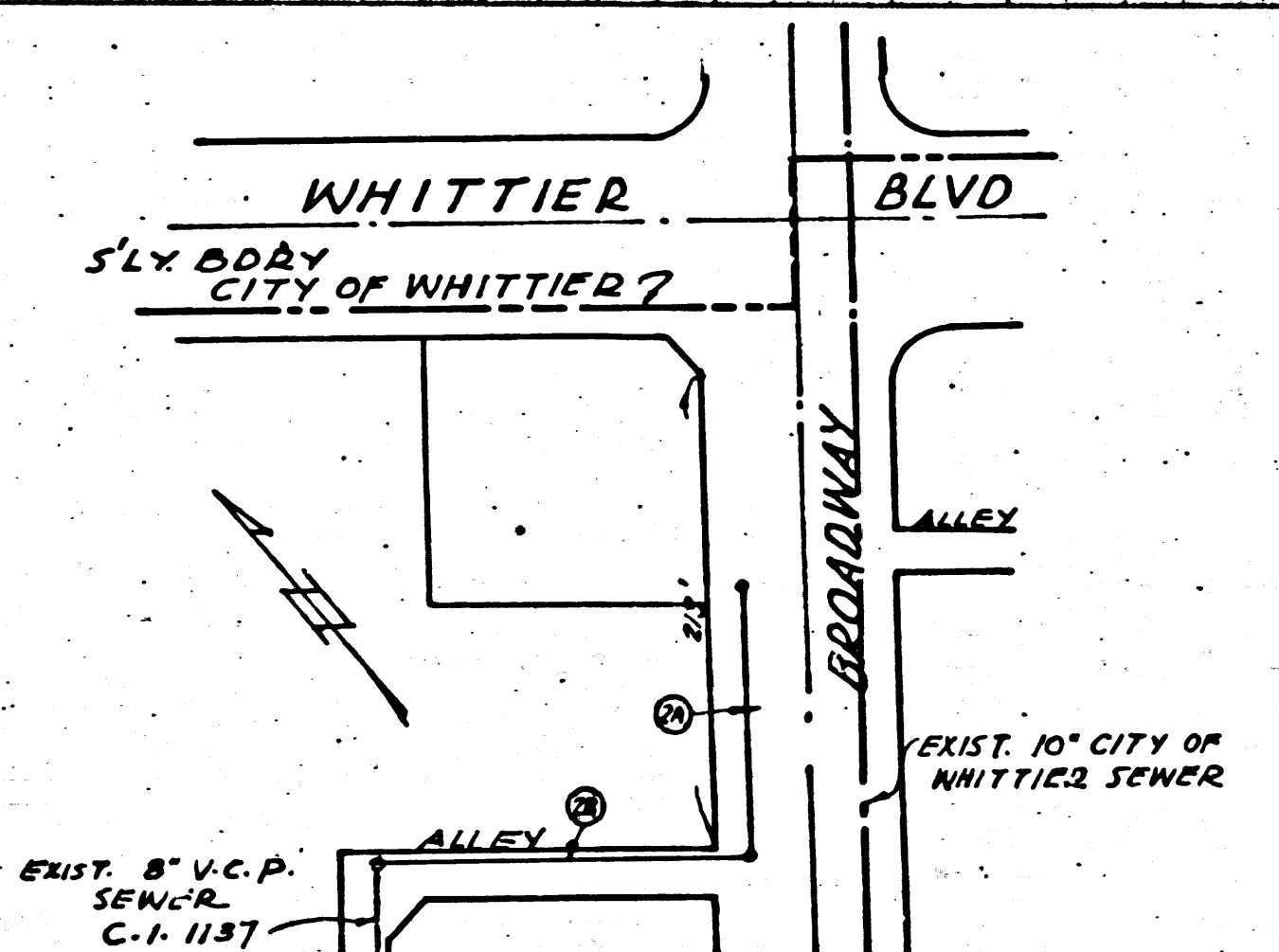

SHEET NO. 1  
PAGE NO. 1-2

NOTE:

GRADES TO WHICH THIS IMPROVEMENT IS TO BE CONSTRUCTED ARE SHOWN ON PLANS AND PROFILES. GRADE POINTS FOR TOP OF CURB, CENTER LINE OF STREET, OR CENTER LINE OF ALLEY ARE SHOWN BY CIRCLES ON PROFILES. AT ALL POINTS BETWEEN DESIGNATED POINTS THE GRADE SHALL BE ESTABLISHED SO AS TO CONFORM TO A STRAIGHT LINE DRAWN BETWEEN SAID DESIGNATED POINTS. ELEVATIONS ARE IN FEET ABOVE U.S. 65' DATUM OR MEAN SEA LEVEL.

THIS DRAWING AND THE DATA HEREON ARE HEREBY MADE A PART OF THE SPECIFICATIONS. WORK SHALL BE CONSTRUCTED ACCORDING TO SPECIFICATIONS ON FILE IN THE OFFICE OF THE COUNTY ENGINEER AND SHALL BE PROSECUTED ONLY IN THE PRESENCE OF THE COUNTY ENGINEER. BEFORE WORK CAN BE STARTED, THE CONTRACTOR MUST OBTAIN A PERMIT TO EXCAVATE IN COUNTY STREETS FROM THE L.A. COUNTY ROAD DEPT. JOB IN 200 ST. AND MAKE A DEPOSIT WITH THE COUNTY ENGINEER, 733 L.A. COUNTY ENGINEERING BUILDING, SUFFICIENT TO COVER THE COST OF CONSTRUCTION INSPECTION AND RECORD PLANS.

APPROVAL OF THIS PLAN BY THE COUNTY OF LOS ANGELES DOES NOT CONSTITUTE A REPRESENTATION AS TO THE ACCURACY OF THE LOCATION OF OR THE EXISTENCE OR NON-EXISTENCE OF ANY UNDERGROUND UTILITY, PIPE, OR STRUCTURE WITHIN THE LIMITS OF THIS PROJECT.

APPROVED *William J. Fox* DATE 12/10/53  
WILLIAM J. FOX COUNTY ENGINEER  
INDUSTRIAL WASTE ENGINEER  
DEPT. OF COUNTY ENGINEER

APPROVED *A.M. Rawlin*  
A.M. RAWLIN  
CHIEF ENGR. OF SAN. DIST. NO. 18  
OFFICE ENGINEER

CHECKED BY: *Arthur J. Rosenthal*  
OFFICE OF COUNTY ENGINEER, REG. C.E. NO. 8865

PC 2820  
J.N.F.773  
17,703

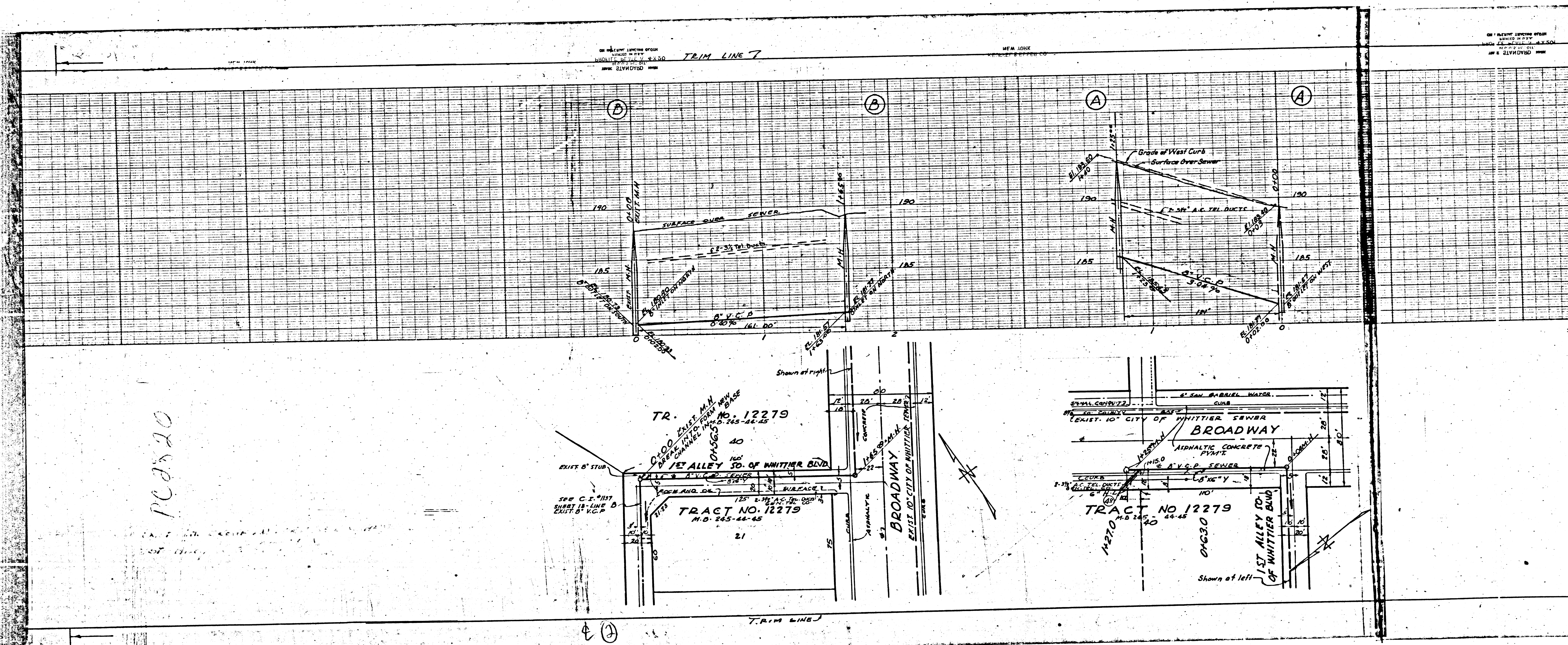

PC 20

NEW YORK  
 ENGINEERS  
 110 NASSAU ST.  
 NEW YORK 38, N.Y.

TRIM LINE 7

NEW YORK  
 ENGINEERS  
 110 NASSAU ST.  
 NEW YORK 38, N.Y.

NEW YORK  
 ENGINEERS  
 110 NASSAU ST.  
 NEW YORK 38, N.Y.

TR. DIST. M. 12279  
 12' ALLEY SO. OF WHITTIER BOVD.

TRACT NO. 12279  
 M.O. 145-44-45

TRACT NO. 12279  
 M.O. 145-44-45

12' ALLEY SO. OF WHITTIER BOVD.

TRIM LINE

TRIM LINE

Shown at left

M16