

PC 2834
J.N.F. 790
Page 2

(17,892)

B.M. T.C.L. 8 El. 407.336 F.B. 1796-8
At Sp. 23.50. of end of West Curb
of GARRYDON AVE. at N6 Line of
TRACT No 13978

Trim Line 1

NOTE

PROVIDE STAKES ON THE PROPERTY LINES OF PROPERTY LINES PRODUCED AT RIGHT ANGLES TO THE SEWER LINE AT THE CENTER LINE OF EACH MANHOLE. NO REPRESENTATIVE OF THE COUNTY ENGINEER WILL SURVEY OR LAYOUT ANY PORTION OF THE WORK. THE OWNER OR HIS AUTHORIZED REPRESENTATIVE SHALL FURNISH THE COUNTY ENGINEER WITH GRADE SHEETS AND STATIONS FOR ALL HOUSE LATERALS AND Y-BRANCHES AND SHALL PROVIDE STAKES FOR THEM AT THEIR PROPER LOCATIONS WITH SPRAWNING PLAINLY MARKED. ANY CHANGE IN LOCATION SHALL BE REQUESTED IN WRITING BY THE OWNER OR HIS REPRESENTATIVE. NO REVISIONS SHALL BE MADE IN THESE PLANS WITHOUT APPROVAL OF THE COUNTY ENGINEER.

1. USE STANDARD MANHOLE FRAMES AND COVERS, S-Q-117, EXCEPT AS NOTED.
2. USE STANDARD STRENGTH PIPE, EXCEPT AS NOTED.
3. USE CEMENT MORTAR FOR ALL WITRIFIED CLAY PIPE JOINTS.
4. RESURFACE ALL TRENCH WITHIN PAVED AREA TO MEET L.A. COUNTY ROAD DEPT. OR CALIF. STATE HWY. DEPT. REQUIREMENTS IN ACCORDANCE WITH PERMIT.
5. ENCASE FOUR FEET OF SEWER AT POINTS OF INTERFERENCE WITH POLES 5.0-119.
6. HOUSE LATERALS TO BE CONSTRUCTED WITH INVERTS AT PROPERTY LINE 6 FEET BELOW CURB GRADE, EXCEPT AS NOTED.
7. ALL STRUCTURES SHALL BE BRICK SEWER STRUCTURES, J-Q-104, EXCEPT AS NOTED.
8. FOR ALLOWABLE LEAKAGE TEST, USE FORMULA NO. 1 - SPEC. SEC. 51.
9. MANHOLE TOPS IN UNIMPROVED RIGHTS-OF-WAY TO BE 6" ABOVE FINISHED GRADE.

TEMPLE CITY BLDG. DIST. NO. 5

PROFILE ALIGNMENT AND GRADE OF
SANITARY SEWERS
TO BE CONSTRUCTED IN
TRACT No 19009

PC 2834
J.N.F. 790
Page 1
J.N. 0942.72

(17,891)

(2)

PRIVATE CONTRACT NO 2834
W.S. 46

SHEET 1 OF 1 SHEET
SCALE: VERT. 1" = 4'
HORIZ. 1" = 40' SEPT. 1953

PREPARED IN THE OFFICES OF
W.A. TREADWELL JR.
By W.A. Treadwell Jr.
Reg. R.E. No. 410
FOR LEGEND SEE PLAN NO. 5-Q-64

NOTE:
GRADES TO WHICH THIS IMPROVEMENT IS TO BE CONSTRUCTED ARE SHOWN IN PLANS AND PROFILES. GRADE POINTS FOR TOP OF CURB, CENTER LINE OF STREET OR CENTER LINE OF ALLEY ARE SHOWN BY CIRCLES ON PROFILE. AT ALL POINTS BETWEEN DESIGNATED POINTS THE GRADE SHALL BE ESTABLISHED SO AS TO CONFORM TO A STRAIGHT LINE DRAWN BETWEEN SAID DESIGNATED POINTS. ELEVATIONS ARE IN FEET ABOVE U.S.G.S. DATUM OR MEAN SEA LEVEL. THIS DRAWING AND THE DATA HEREON ARE HEREBY MADE A PART OF THE SPECIFICATIONS. WORK SHALL BE CONSTRUCTED ACCORDING TO SPECIFICATIONS ON FILE IN THE OFFICE OF THE COUNTY ENGINEER AND SHALL BE PROSECUTED ONLY IN THE PRESENCE OF THE COUNTY ENGINEER.
BEFORE WORK CAN BE STARTED, THE CONTRACTOR MUST OBTAIN A PERMIT TO EXCAVATE IN COUNTY STREETS FROM THE L.A. COUNTY ROAD DEPT., 108 WEST 2ND ST. AND MAKE A DEPOSIT WITH THE COUNTY ENGINEER, 733 L.A. CO. ENGR. BLDG., SUFFICIENT TO COVER THE COST OF CONSTRUCTION INSPECTION AND RECORD PLANS.
APPROVAL OF THIS PLAN BY THE COUNTY OF LOS ANGELES DOES NOT CONSTITUTE A REPRESENTATION AS TO THE ACCURACY OF THE LOCATION OR THE EXISTENCE OR NON-EXISTENCE OF ANY UNDERGROUND UTILITIES, PIPE, OR STRUCTURE WITHIN THE LIMITS OF THIS PROJECT. (THIS NOTE APPLIES TO ALL SHEETS)
IF WORK IS TO BE DONE IN A STATE HIGHWAY, A PERMIT MUST BE OBTAINED FROM THE STATE OF CALIF. DIVISION OF HIGHWAYS, 120 SO. SPRING ST.

COUNTY OF LOS ANGELES, CALIFORNIA
APPROVED, WILLIAM J. FOX, COUNTY ENGINEER
BY J.W. [Signature] ASST. CHIEF DEPUTY
APPROVED, J.M. RAWN, CHIEF ENGR. CALIF. DIST. NO. 15
BY J.M. [Signature] DEPUTY OFFICE ENGINEER
CHECKED BY Robert S. [Signature] 11-A-53
OFFICE OF COUNTY ENGINEER, REG. C.E. NO. 2860.

Sheet No.	Pages
1	1-2

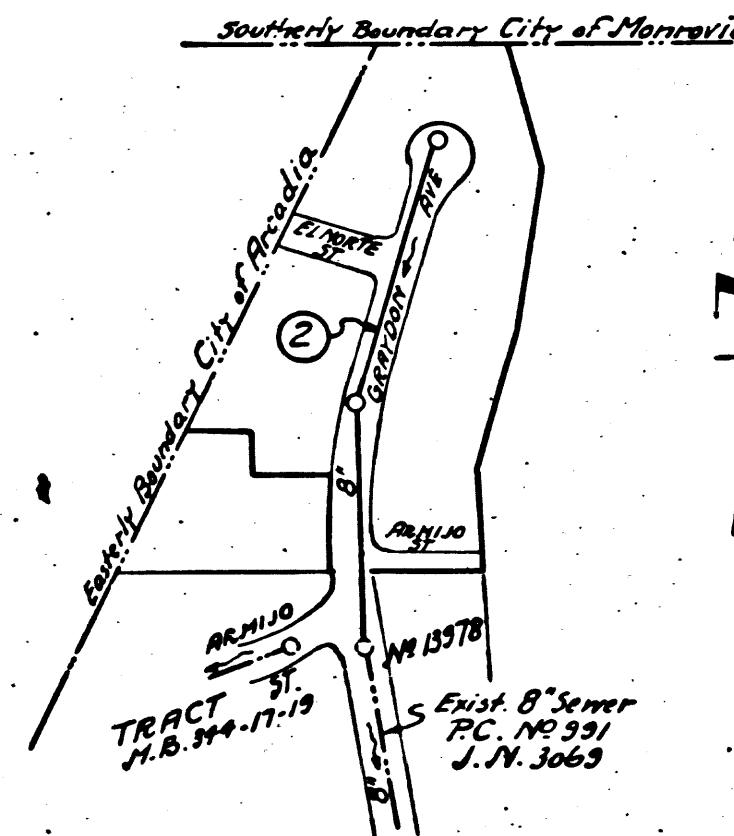

INDEX MAP
Scale 1"=300'
TRACT No 19009
PC. 2834 J.N.F. 790

checked 4-13-54 M. [Signature]

Trim Line 3

(17,892)

TRACT No 19009

P.C. 2834
J.N.F. 790
Page 1

