

061
990.61
2

OR
YS

18,996

TEMPLE CITY BUILDING DIST. N°5

B.M. WM-607, Elev. 337.302, F.B. 1412, P. 224
San Gabriel Blvd. (S. side) at Hill Dr.
Bt. Spike in curb, 6' E of the YK end

NOTE: PROVIDE STAKES ON THE PROPERTY LINES OR PROPERTY LINES PRODUCED AT RIGHT ANGLES TO THE SEWER LINE AT THE CENTER LINE OF EACH MANHOLE. NO REPRESENTATIVE OF THE COUNTY ENGINEER WILL SURVEY OR LAY OUT ANY PORTION OF THE WORK.

THE OWNER OR HIS AUTHORIZED REPRESENTATIVE SHALL FURNISH THE COUNTY ENGINEER WITH GRADE SHEETS AND STATIONS FOR ALL HOUSE LATERALS AND Y-BRANCHES AND SHALL PROVIDE STAKES FOR THEM AT THEIR PROPER LOCATIONS WITH STATIONING PLAINLY MARKED. ANY CHANGE IN LOCATION SHALL BE REQUESTED IN WRITING BY THE OWNER OR HIS REPRESENTATIVE. NO REVISIONS SHALL BE MADE IN THESE PLANS WITHOUT APPROVAL OF THE COUNTY ENGINEER.

1. USE STANDARD MANHOLE FRAMES AND COVERS, S-Q-117, EXCEPT AS NOTED.
2. USE STANDARD STRENGTH PIPE EXCEPT AS NOTED.
3. USE CEMENT MORTAR FOR ALL VITRIFIED CLAY PIPE JOINTS.
4. RESURFACE ALL TRENCH WITHIN PAVED AREA TO MEET L.A. COUNTY ROAD DEPT. & CALIF. STATE HWY. DEPT. REQUIREMENTS IN ACCORDANCE WITH PERMIT.
5. ENCASE FOUR FEET OF SEWER AT POINTS OF INTERFERENCE WITH POLES S-Q-118.
6. HOUSE LATERALS TO BE CONSTRUCTED WITH INVERTS AT PROPERTY LINE 6 FEET BELOW CURB GRADE EXCEPT AS NOTED.
7. ALL STRUCTURES SHALL BE BRICK SEWER STRUCTURES, S-Q-104 EXCEPT AS NOTED.
8. FOR ALLOWABLE LEAKAGE TEST, USE FORMULA NO. 1, SPEC'S SEC. 51.
9. MANHOLES FORBIDDEN UNIMPROVED RIGHTS OF WAY TO BE 6' ABOVE FINISHED GRADE.

SANITARY SEWERS
TO BE CONSTRUCTED IN

TRACT N° 19627

P.C. 3061
J.N. 0990.61
Page 1

18,995

(2)

TRACT N° 19627
18,000 W.V.

PRIVATE CONTRACT N° 3061
W.S. 36
ONE SHEET

SCALE: VERT. 1"=4'
HORIZ. 1"=40' DATE: JUNE, 1954

PREPARED IN THE OFFICES OF
W. A. TREADWELL, JR.
BY W. A. Treadwell, Jr. REG. C.E. N° 40
FOR LEGEND SEE PLAN N° S-8-64

NOTE: GRADES TO WHICH THIS IMPROVEMENT IS TO BE CONSTRUCTED ARE SHOWN ON PLANS AND PROFILES. GRADE POINTS FOR TOP OF CURB, CENTER LINE OF STREET OR CENTER LINE OF ALLEY ARE SHOWN BY CIRCLES ON PROFILE AT ALL POINTS BETWEEN DESIGNATED POINTS. THE GRADE SHALL BE ESTABLISHED SO AS TO CONFORM TO A STRAIGHT LINE DRAWN BETWEEN SAID DESIGNATED POINTS. ELEVATIONS ARE IN FEET ABOVE U.S.S. DATUM OR MEAN SEA LEVEL. THIS DRAWING AND THE DATA HEREON ARE HEREBY MADE A PART OF THE SPECIFICATIONS. WORK SHALL BE CONSTRUCTED ACCORDING TO SPECIFICATIONS ON FILE IN THE OFFICE OF THE COUNTY ENGINEER AND SHALL BE PROSECUTED ONLY IN THE PRESENCE OF THE COUNTY ENGINEER.

BEFORE WORK CAN BE STARTED, THE CONTRACTOR MUST OBTAIN A PERMIT TO EXCAVATE IN COUNTY STREETS FROM THE L.A. COUNTY ROAD DEPT. 108 W. 2nd ST. AND MAKE A DEPOSIT WITH THE COUNTY ENGINEER, 733 L.A. CO. ENGR. BLDG. SUFFICIENT TO COVER THE COST OF CONSTRUCTION INSPECTION AND RECORD PLANS.

APPROVAL OF THIS PLAN BY THE COUNTY OF LOS ANGELES DOES NOT CONSTITUTE A REPRESENTATION AS TO THE ACCURACY OF THE LOCATION OF OR THE EXISTENCE OR NON-EXISTENCE OF ANY UNDERGROUND UTILITY WIRE OR STRUCTURE WITHIN THE LIMITS OF THIS PROJECT.

IF WORK IS TO BE DONE IN A STATE HIGHWAY, A PERMIT MUST BE OBTAINED FROM THE STATE OF CALIF. DIVISION OF HIGHWAYS, 120 SO. SPRING ST.

NO CHARGE FOR CONNECTIONS
JK Under

INDEX MAP
Scale 1"=200'
TRACT N° 19627
P.C. 3061 J.N. 0990.61

Checked
W. A. Treadwell, Jr.
10-1-54

APPROVED, WILLIAM J. FOX, COUNTY ENGINEER
BY *W. J. Fox*
ASST. SANITATION ENGINEER

APPROVED, A. M. RAWN
CHIEF ENGR., CO. SAN. DIST. N° 15
BY *A. M. Rawn*
ASST. OFFICE ENGINEER

CHECKED BY *H. L. Swales* 8-26-54
OFFICE OF COUNTY ENGINEER, REG. C.E. N° 442

SHEET	PAGE
1	1-2

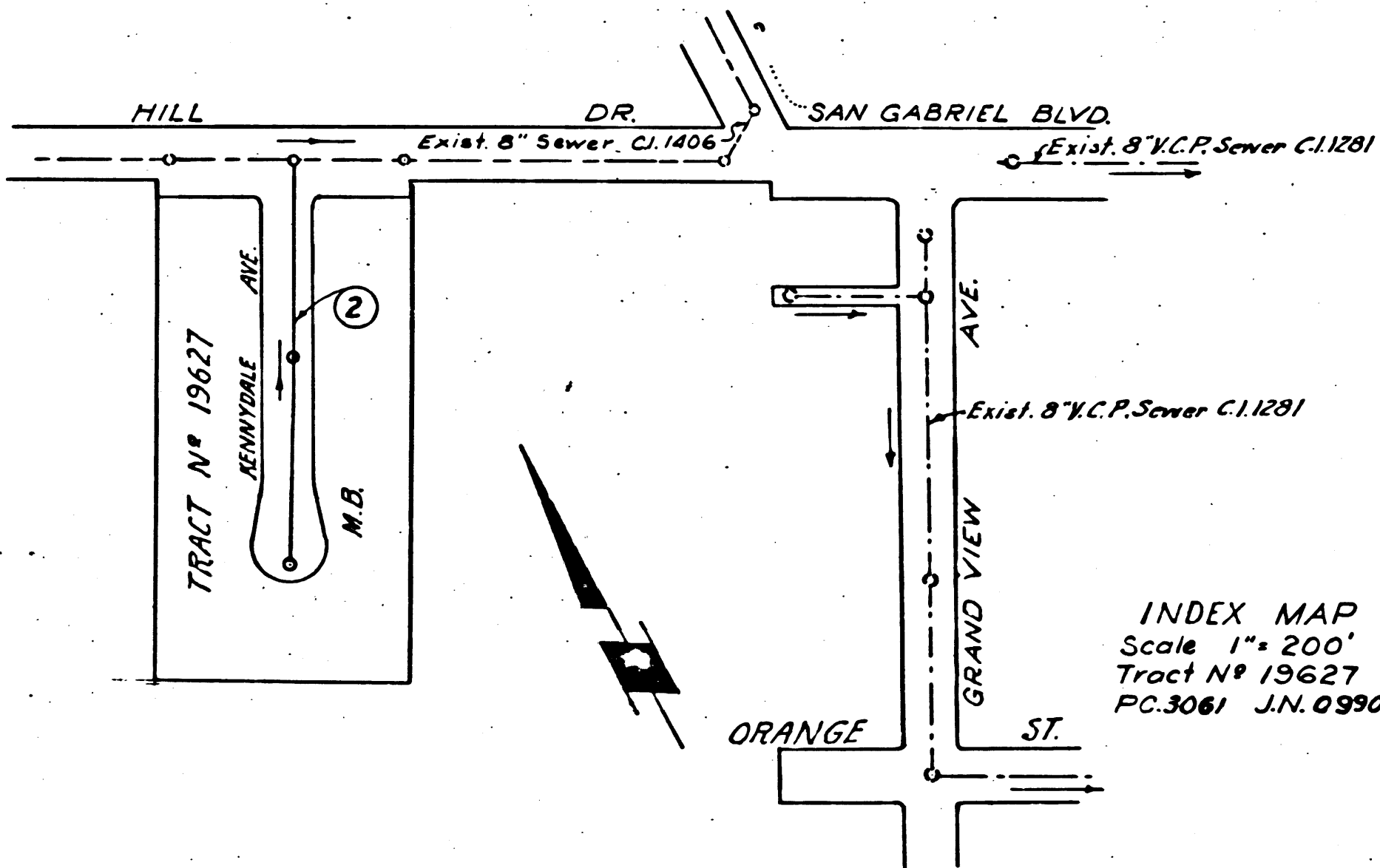

PC 3061
b.c. 3061
18,000 W.V.

