

PC 3094
J.N. 0594.71
Page 2

NO CHARGE FOR CONNECTIONS

18,796

BELLFLOWER BLDG. DIST. NO. 4

NOTE:
Provide stakes on the property lines or property lines produced at right angles to the sewer line at the center line of each manhole.
No representative of the County Engineer will survey or layout any portion of the work.
The owner or his authorized representative shall furnish the County Engineer with grade sheets and stations for all house laterals and Y branches and shall provide stakes for them at their proper locations with stationing plainly marked. Any change in location shall be requested in writing by the owner or his representative.
No revisions shall be made in these plans without the approval of the County Engineer.

1. Use standard manhole frames and covers, S-a-117.
2. Use standard strength pipe except as noted.
3. Use cement mortar for all vitrified clay pipe joints.
4. Resurface all trench within paved area to meet L.A. County Road Dept. or California State Highway Dept. requirements in accordance with permit.
5. Encase four feet of sewer at points of interference with poles, S-a-119.
6. House Laterals To Be Constructed With 1/4" Rise Per Foot To Property Line.
7. All structures shall be brick sewer structures, S-a-104.
8. For allowable leakage test, use Formula No. 1, Spec's., Sec. 51.
9. Manhole tops in unimproved Rights-Of-Way to be 6" above finish grade.

B.M. C-4 FB 1207-9 El. 04.081
Rosecrans Ave. & Woodruff Ave., 16.3'
South 12' East of 'B' Intersection.

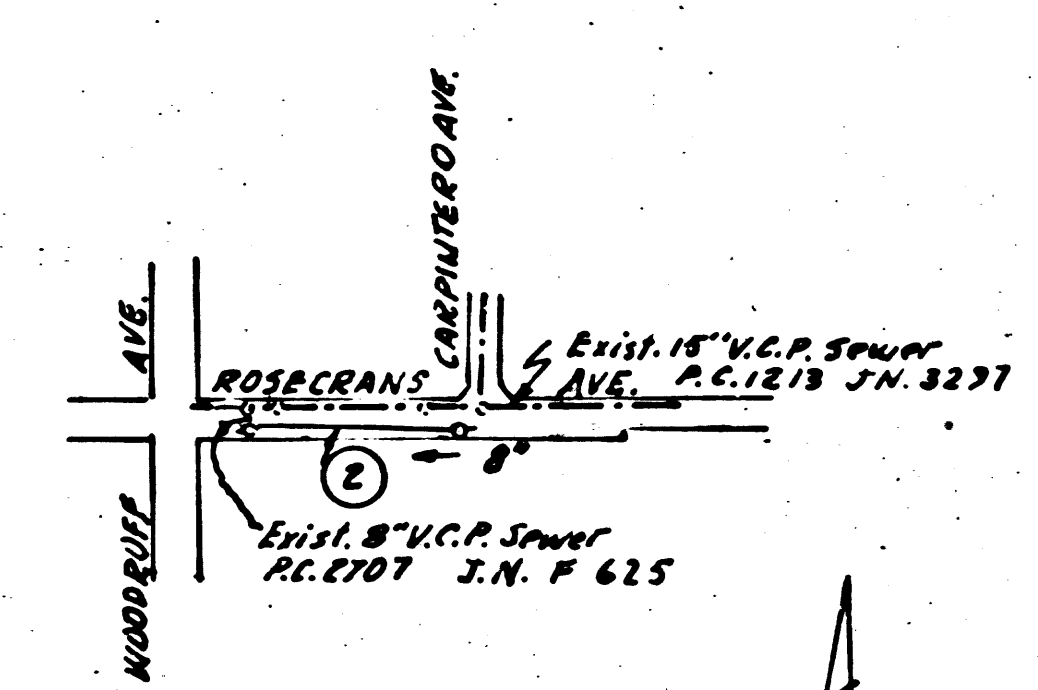

INDEX MAP
Scale 1"=600'
P.C. 3094
J.N. 0594.71

checked 8-2-54 M. L. ...

SHEET	PAGE
1	1-2

NO CHARGE FOR CONNECTIONS
L. Collins 7-12-54

Approved: *Arthur P. ...*
Industrial Waste Engineer

PROFILE, ALIGNMENT AND GRADE OF SANITARY SEWERS TO BE CONSTRUCTED IN

ROSECRANS AVENUE EAST OF WOODRUFF AVENUE

PRIVATE CONTRACT NO. 3094
W. S. 33
1 SHEET

Scale: VERT. 1"=4'
HORIZ. 1"=40'
JUNE 1954

PREPARED IN THE OFFICES OF
ARTHUR G. ROSENTHAL
Reg. C. E. No. 8806

FOR LEGEND SEE PLAN NO. S-a-64

NOTE:
Grades to which this improvement is to be constructed are shown on plans and profiles. Grade points for top of curbs, center line of streets, or center line of alleys are shown by circles on profiles. At all points between designated points the grade shall be established so as to conform to a straight line drawn between said designated points.
Elevations are in feet above U.S.C.S. datum or mean sea level.
This drawing and the data hereon are hereby made a part of the specifications.
Work shall be constructed according to specifications on file in the office of the County Engineer and shall be prosecuted only in the presence of the County Engineer.
Before work can be started, the contractor must obtain a permit to excavate in County streets from the L.A. County Road Dept., 108 W. 2nd St. and make a deposit with the County Engineer, 733 L.A. County Engineering Building, sufficient to cover the cost of construction inspection and record plant.
Approval of this plan by the County of Los Angeles does not constitute a representation as to the accuracy of the location of or the existence or non-existence of any underground utility, pipe, or structure within the limits of this project. This note applies to all sheets.
If work is to be done in a State Highway, a permit must be obtained from the State of California, Division of Highways, 120 South Spring Street.

COUNTY OF LOS ANGELES, CALIFORNIA
Approved, William J. Fox, County Engineer
Approved, A. M. Rawm
CHIEF ENGR. CO. SAN. DIST. NO. 2
A. P. Collins
Sanitation Engineer
Checked by: *R. K. ...* 7-12-54
Office of County Engineer, Reg. C. E. No. 7860

PC 3094
J.N. 0594.71
Page 1

18,795

(2)

ROSECRANS AVE.

WOODRUFF AVE

PC 3094
J.N. 0594.71

RL

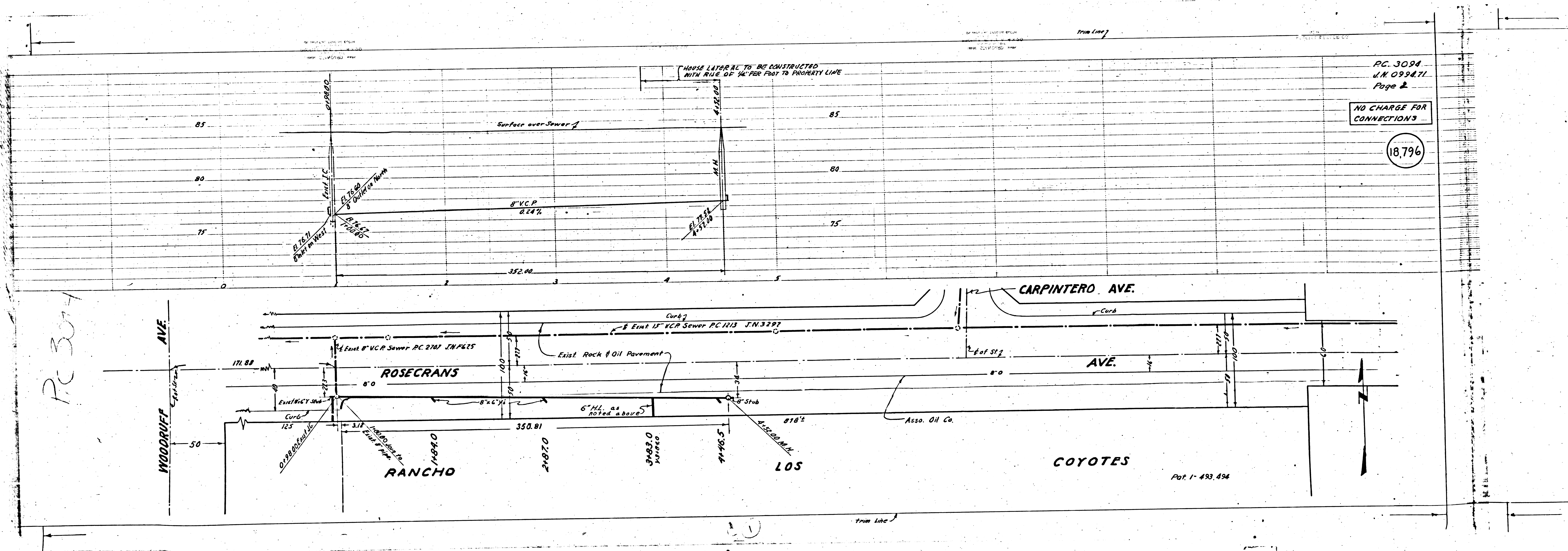

PC. 3094
J.M. 0994.71
Page 2

NO CHARGE FOR
CONNECTIONS

18796

PC 3074

WOODRUFF
AVE.

ROSECRANS

RANCHO

LOS

CARPINTERO AVE.

AVE.

COYOTES

Pat. 1-493,494

HOUSE LATERAL TO BE CONSTRUCTED
WITH RISE OF 1/4" PER FOOT TO PROPERTY LINE

Surface over Sewer

8" V.C.P.
0.24%

352.00

Exist. 8" V.C.P. Sewer PC 2702 J.N. 6215

Exist. 15" V.C.P. Sewer PC 1213 J.N. 3297

Exist. Rock & Oil Pavement

6" HLL as noted above

Asso. Oil Co.

171.88

125

8'0"

8'x6'x1'

350.81

2+87.0

3+83.0

4+46.5

5+50.0

8'18"

2+50.00 HLL

trim line