

**BENCH MARK**  
 ABOUT 0.6 MILE N.W. ALONG THE STEUBEN TOPPER AND SANTA FE RAILWAY FROM THE BUENA VISTA STATION IN ORANGE COUNTY, ABOUT 300' N.W. OF THE LOS ANGELES-ORANGE COUNTY LINE AND 29' N.E. OF THE N.E. RAIL AND 40' S.W. OF THE CENTER LINE OF STAGE ROAD. A STANDARD DISK STAMPED "N718 1945" AND SET IN THE TOP OF A CONCRETE POST.  
 COUNTY SURVEYOR'S F.B. 1704-7 1952 ADJ. EL. 101.179

**BELLFLOWER** Bldg. Dist. No. 4

- NOTE:**  
 Provide stakes on the property lines or property lines produced at right angles to the sewer line at the center line of each manhole.  
 No representative of the County Engineer will survey or layout any portion of the work. The owner or his authorized representative shall furnish the County Engineer with grade sheets and stations for all house laterals and Y branches and shall provide stakes for them at their proper locations with stationing plainly marked. Any change in location shall be requested in writing by the owner or his representative.  
 No revisions shall be made in these plans without the approval of the County Engineer.
1. Use standard manhole frames and covers, S-a-117.
  2. Use standard strength pipe except as noted.
  3. Use cement mortar for all vitrified clay pipe joints.
  4. Resurface all trench within paved area to meet L.A. County Road Dept. or Calif. State Highway Dept. requirements in accordance with permit.
  5. Encase four feet of sewer at points of interference with poles, S-a-119.
7. All structures shall be brick sewer structures, S-a-104.
  8. For allowable leakage test, use Formula No. ...., Specs., Sec. 51.
  9. Manhole tops in unimproved Rights-of-Way to be 6" above finish grade.

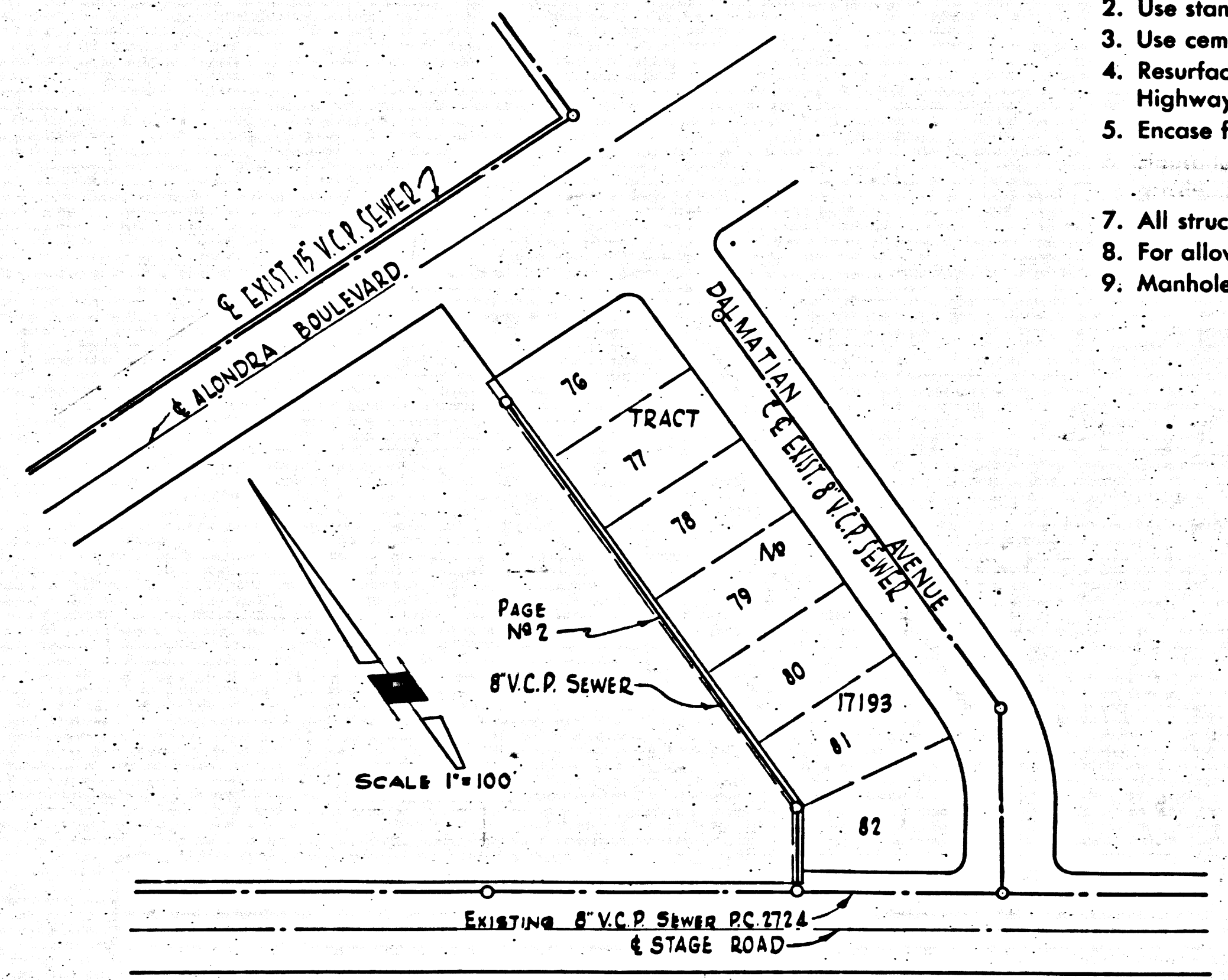

SHEET NO.	PAGES
1	1-2

**INDEX MAP**  
 SCALE 1"=100'  
 NW 1/4 SEC. 26, T.35, R.11W  
 P.C. 3123 J.N. 0998.01

**NO CHARGE FOR CONNECTIONS**  
*L. Austin 9-20-54*

*Checked 10-26-54 W. L. ...*

PROFILE, ALIGNMENT AND GRADE OF  
**SANITARY SEWERS**  
 TO BE CONSTRUCTED IN  
 NW 1/4 SEC. 26, T.35, R.11W,  
 IN THE RANCHO LOS COVOTES

P. C. 3123  
 J. N. 0998.01  
 PAGE 1  
 DOUBLE SCALE:

PRIVATE CONTRACT NO. 3123  
 W. S. 34

Scale: VERT. 1"=8'  
 HORIZ. 1"=40'  
 AUGUST 1954 SHEET  
 PREPARED IN THE OFFICES OF  
**EDWARD N. FRISIUS**  
*Edward N. Frisius*  
 Reg. C.E. No. 6369  
 FOR LEGEND SEE PLAN NO. S-a-64

**NOTE:**  
 Grades to which this improvement is to be constructed are shown on plans and profiles. Grade points for top of curbs, center line of streets, or center line of alleys are shown by circles on profiles. At all points between designated points the grade shall be established so as to conform to a straight line drawn between said designated points.  
 Elevations are in feet above U.S.G.S. datum or mean sea level.  
 This drawing and the data hereon are hereby made a part of the specifications.  
 Work shall be constructed according to specifications on file in the office of the County Engineer and shall be prosecuted only in the presence of the County Engineer.  
 Before work can be started, the contractor must obtain a permit to excavate in County streets from the L.A. County Road Dept., 108 W. 2nd St., and make a deposit with the County Engineer, 733 L.A. County Engineering Building, sufficient to cover the cost of construction inspection and record plans.  
 Approval of this plan by the County of Los Angeles does not constitute a representation as to the accuracy of the location of or the existence or non-existence of any underground utility, pipe, or structure within the limits of this project. This note applies to all sheets.  
 If work is to be done in a State Highway, a permit must be obtained from the State of California, Division of Highways, 120 South Spring Street.

**COUNTY OF LOS ANGELES, CALIFORNIA**  
 Approved, William J. Fox, County Engineer  
 Approved, A. M. Rawm  
 Chief Eng'r, Co. Eng. Dist. No. 18  
*A. P. Collins* Sanitation Engineer  
*L. P. ...* Office Engineer  
 Checked By: *R. L. ...* 9-21-54  
 Office of County Engineer, Reg. C. E. No. 7862

19,148

(2)

10,880 M.L.  
 P. C. 3123

TRIM LINE (17)



