

Trim Line 7  
**PUENTE BLDG. DIST. NO 2**

**NOTE:**  
 Provide stakes on the property lines or property lines produced at right angles to the sewer line at the center line of each manhole.  
 No representative of the County Engineer will survey or layout any portion of the work. The owner or his authorized representative shall furnish the County Engineer with grade sheets and stations for all house laterals and Y branches and shall provide stakes for them at their proper locations with stationing plainly marked. Any change in location shall be requested in writing by the owner or his representative.  
 No revisions shall be made in these plans without the approval of the County Engineer.

1. Use standard manhole frames and covers, S-a-117, except as noted
2. Use standard strength pipe
3. Use cement mortar for all vitrified clay pipe joints.
4. Resurface all trench within paved area to meet L.A. County Road Dept. or Calif. State Highway Dept. requirements in accordance with permit.
5. Encase four feet of sewer at points of interference with poles, S-a-119.

6. All structures shall be brick sewer structures, S-a-104, except as noted.
7. Manhole tops in unimproved Rights-Of-Way to be 6" above finish grade.
8. For allowable leakage test, use Formula No. 1, Spec's., Sec. 51.

Before breaking into any existing structure  
 and before final acceptance of this work,  
 County Sanitation District should be notified  
 in order that required inspection may be made.

**TABLE**

SHEET NO	PAGES
1	1-2

**NO CHARGE FOR CONNECTIONS**  
*L. L. Latta - 12-6-54*

*checked 2-3-55 M. J. M.*

**PROFILE, ALIGNMENT AND GRADE OF  
 SANITARY SEWERS  
 TO BE CONSTRUCTED IN  
 SANITARY SEWER R/W IN  
 BLK. 14 O. T. BASSETT'S SUBDIVISION**

**PRIVATE CONTRACT NO. 3183**  
 W. S. 46  
 1 SHEET  
 Scale: VERT. 1"=4' HORIZ. 1"=40'  
 PREPARED IN THE OFFICES OF  
**WM. H. FAIR, JR.**  
 Reg. C. E. No. 2583  
 FOR LEGEND SEE PLAN NO. S-a-64

**NOTE:**  
 Grades to which this improvement is to be constructed are shown on plans and profiles. Grade points for top of curbs, center line of streets, or center line of alleys are shown by circles on profiles. At all points between designated points the grade shall be established so as to conform to a straight line drawn between said designated points.  
 Elevations are in feet above U.S.G.S. datum or mean sea level.  
 This drawing and the data hereon are hereby made a part of the specifications.  
 Work shall be constructed according to specifications on file in the office of the County Engineer and shall be prosecuted only in the presence of the County Engineer.  
 Before work can be started, the contractor must obtain a permit to excavate in County streets from the L.A. County Road Dept., 108 W. 2nd St. and make a deposit with the County Engineer, 733 L.A. County Engineering Building, sufficient to cover the cost of construction inspection and record plans.  
 Approval of this plan by the County of Los Angeles does not constitute a representation as to the accuracy of the location of or the existence or non-existence of any underground utility, pipe, or structure within the limits of this project. This note applies to all sheets.  
 If work is to be done in a State Highway, a permit must be obtained from the State of California, Division of Highways, 120 South Spring Street.

**COUNTY OF LOS ANGELES, CALIFORNIA**  
 Approved, William J. Fox, County Engineer  
 Approved, A. M. Rowan  
 CHIEF ENGR. CO. SAN. DIST. NO. 15  
 Checked By: *J. P. Collins*  
 Sanitation Engineer  
 Checked By: *S. J. [Signature]*  
 Office Engineer  
 Checked By: *R. L. [Signature]*  
 Office Engineer  
 Office of County Engineer, Reg. C. E. No. 7860.

*EI. 313.35 - L.A. Co. Sanitation Bench MK.  
 R.R. Spk. in P.P. #334006 E of E Side  
 Vineland Ave. 100' So. of E of Torch St.*

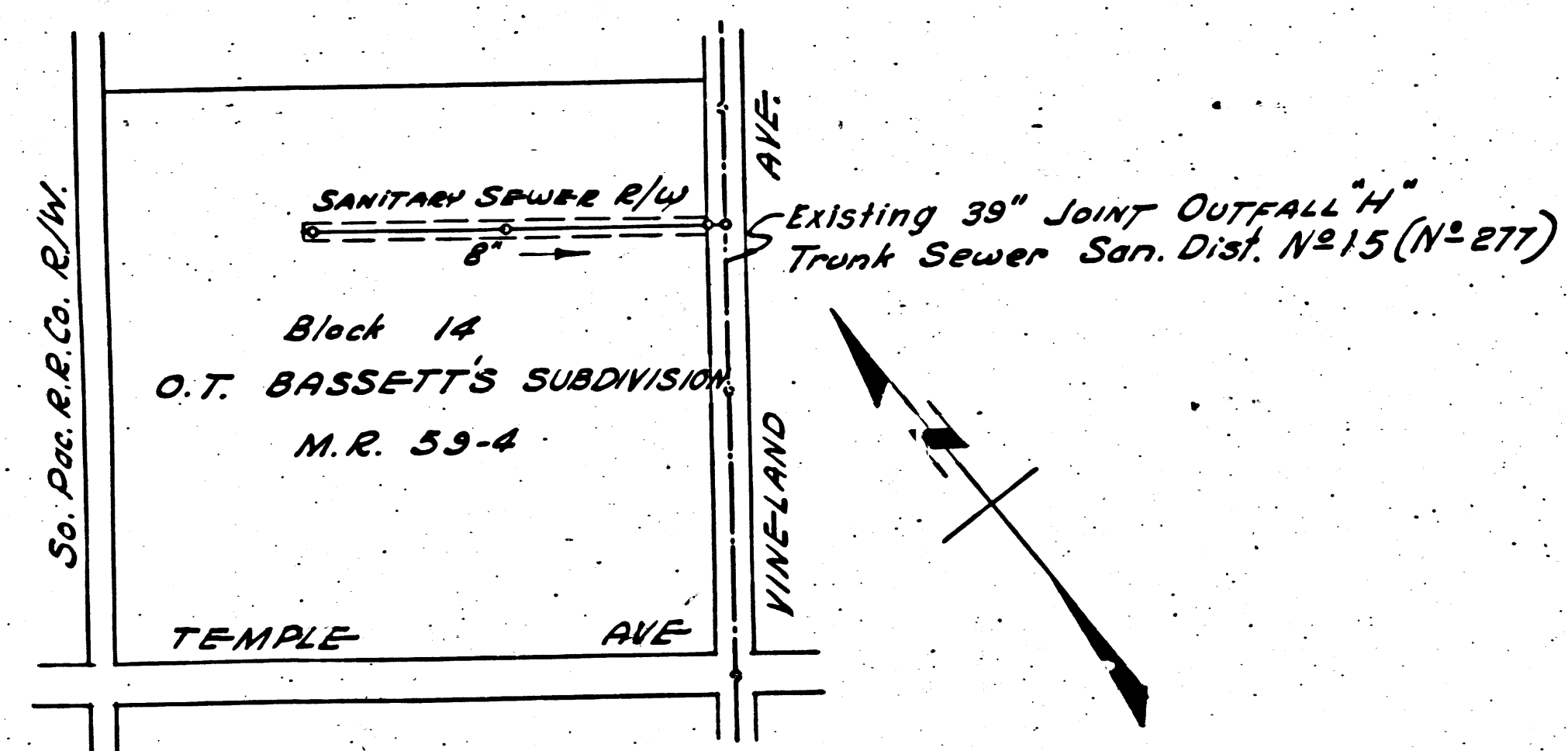

P.C. 3183  
 J.N. 1005.21  
 PAGE 1

19,670

(2)

P.C. 3183  
 J.N. 1005.21  
 PAGE 1  
 19,670  
 (2)  
 25-81-52  
 P.C. 3183  
 J.N. 1005.21  
 PAGE 1

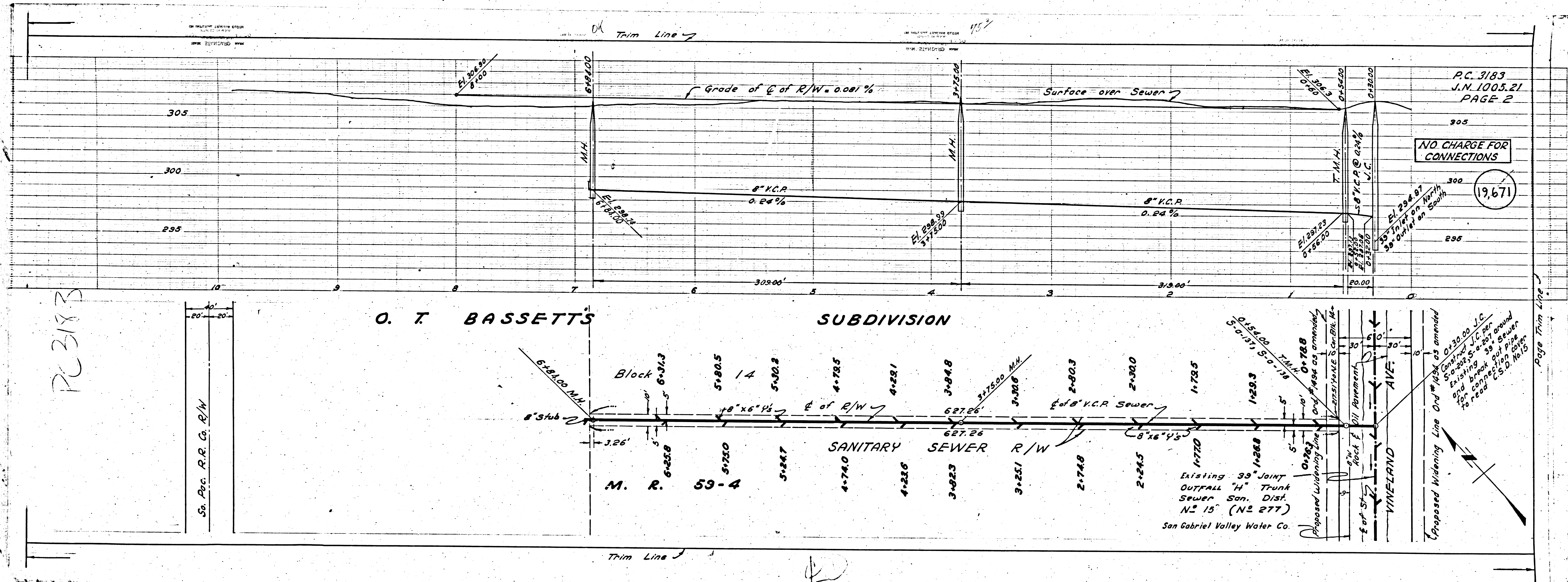

PC 3183

O. T. BASSETTS SUBDIVISION

PC 3183  
J.N. 1005.21  
PAGE 2

NO CHARGE FOR CONNECTIONS

19.671

Existing 30" Joint  
Outfall 14" Trunk  
Sewer Son. Dis.  
N<sup>o</sup> 15" (N<sup>o</sup> 277)  
San Gabriel Valley Water Co.

Proposed Widening Line Ord<sup>n</sup> 14<sup>th</sup> as amended  
Contract 0130.00 J.C.  
Existing 30" J.C. per  
Ord<sup>n</sup> 14<sup>th</sup> as amended  
for 30" joint outfall  
for connection with  
to read C.S.D. 106.0

Page Trim Line