

Lomita Bldg. Dist. 7-L

B.M. Elev. 39.175 F.B. 1517, pg 43  
 S.E. cor. General Scott Park  
 C.S. Mon. 30' W of Pavenna Ave. & 34' N of N.E. cor. School fence

USE EXTRA STRENGTH PIPE  
 USE CEMENT MORTAR FOR ALL VITRIFIED CLAY PIPE JOINTS  
 ALL STRUCTURES SHALL BE BRICK SEWER STRUCTURES  
 AS PER PLAN NO. S-A-104  
 USE STANDARD MANHOLE FRAMES AND COVERS  
 AS PER PLAN NO. S-A-117  
 RESURFACE ALL TRENCHES WITHIN PAVED AREA WITH  
 PREMIX ROCK AND OIL 6 IN. IN THICKNESS  
 USE FORMULA NO. 1, SEC. 51 OF SPECIFICATIONS TO  
 COMPUTE ALLOWABLE LEAKAGE  
 WIRE AND TAGS SHALL BE OMITTED

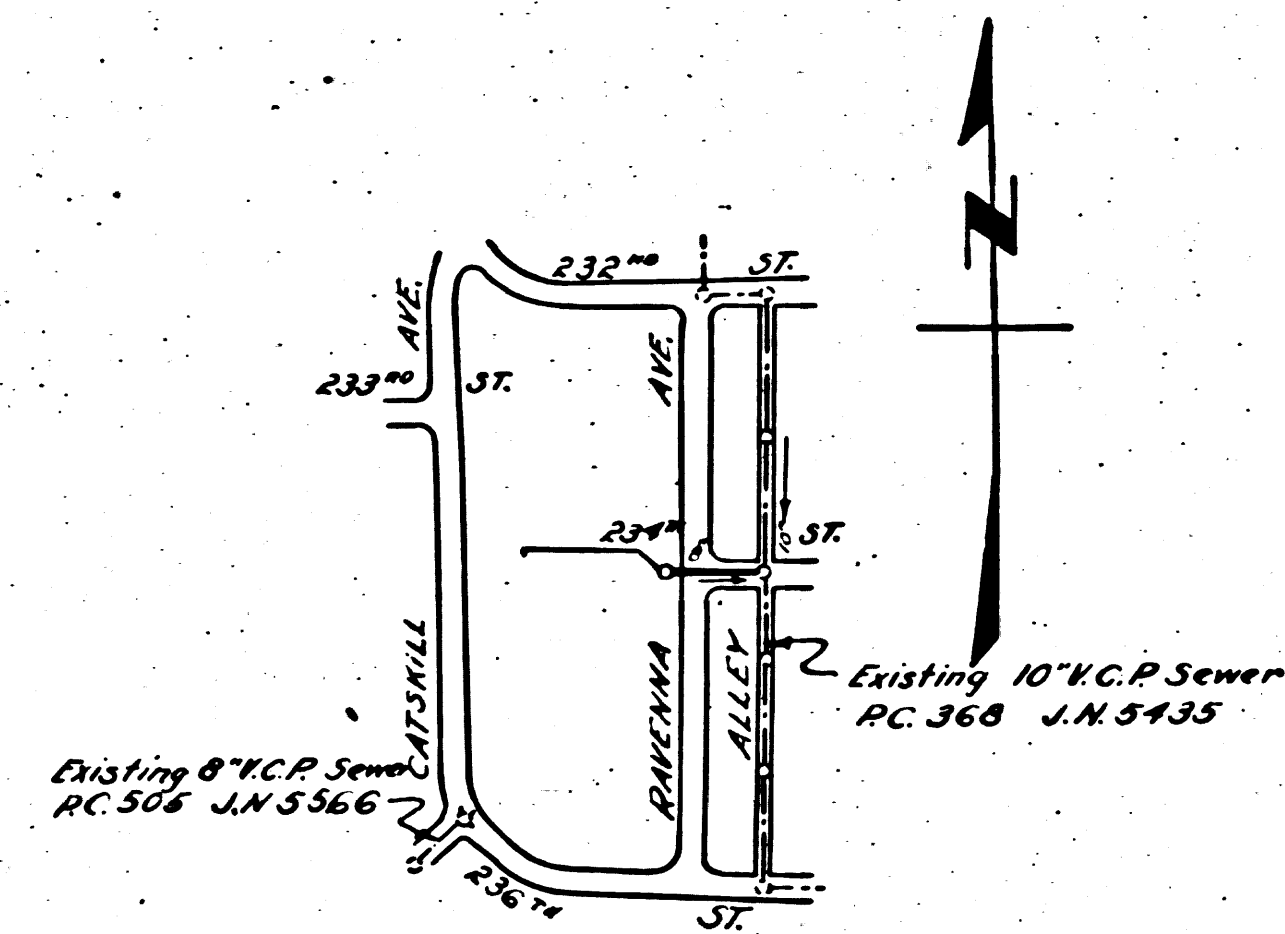

INDEX MAP  
 SCALE 1" = 600'  
 GENERAL SCOTT PARK  
 PC. 3190 J.N. 8775.05

checked 5-3-55 M. Lamm

PROFILE, ALIGNMENT AND GRADE OF  
**SANITARY SEWERS**  
 TO BE CONSTRUCTED FOR  
**GENERAL SCOTT PARK**  
 PRIVATE CONTRACT NO. 3190  
 CAPITAL PROJECT NO. 8775.05

PC. 3190  
 J.N. 8775.05  
 Page 1

(20,299)

(2)

ONE SHEET

SCALE VERT. 1" = 4' HORIZ. 1" = 20' NOVEMBER 1954

COUNTY OF LOS ANGELES, CALIFORNIA

WILLIAM J. FOX COUNTY ENGINEER

SUBMITTED *L. A. Hughes*  
 ASSISTANT SANITATION ENGINEER

APPROVED *A. P. Collins*  
 SANITATION ENGINEER

DEPARTMENT OF PARKS AND RECREATION  
 APPROVED *B. J. Kummerfeld*  
 SUPERINTENDENT

A. M. RAWN  
 CHIEF ENGINEER OF COUNTY  
 SANITATION DISTRICT NO. 4  
 BY *J. P. Williams*  
 OFFICE ENGINEER

FOR LEGEND  
 SEE PLAN NO. S-A-64  
 NOTE: GRADES TO WHICH THIS IMPROVEMENT IS TO BE CONSTRUCTED ARE SHOWN ON PLANS AND PROFILES.  
 GRADE POINTS FOR TOP OF CURB, CENTER LINE OF STREET OR CENTER LINE OF ALLEY ARE SHOWN BY  
 CIRCLES ON PROFILES. AT ALL POINTS BETWEEN DESIGNATED POINTS THE GRADE SHALL BE ESTABLISHED  
 SO AS TO CONFORM TO A STRAIGHT LINE DRAWN BETWEEN SAID DESIGNATED POINTS.  
 ELEVATIONS ARE IN FEET ABOVE U. S. G. S. DATUM OR MEAN SEA LEVEL.  
 UNIT PRICES FOR ADDITIONAL WORK WHICH MAY BE REQUIRED BUT WHICH CANNOT BE ASCERTAINED  
 IN ADVANCE SHALL BE SUBMITTED IN THE PROPOSAL.  
 THIS DRAWING AND THE DATA HEREON ARE HEREBY MADE A PART OF THE SPECIFICATIONS.

REFERENCES		
A. B.	DESIGNED	C. PEARSON NOV 19 54
W. S.	TRACED	C. PEARSON NOV 19 54
F. B.	CHECKED	K. KUMMERFELD NOV 19 54

BM checked  
 11/24/54

PARK SCOTT GENERAL PC. 3190  
 20377 W. 19th St. W 811302

PC 3190  
J.N. 8775.05  
Page 2

(20,300)

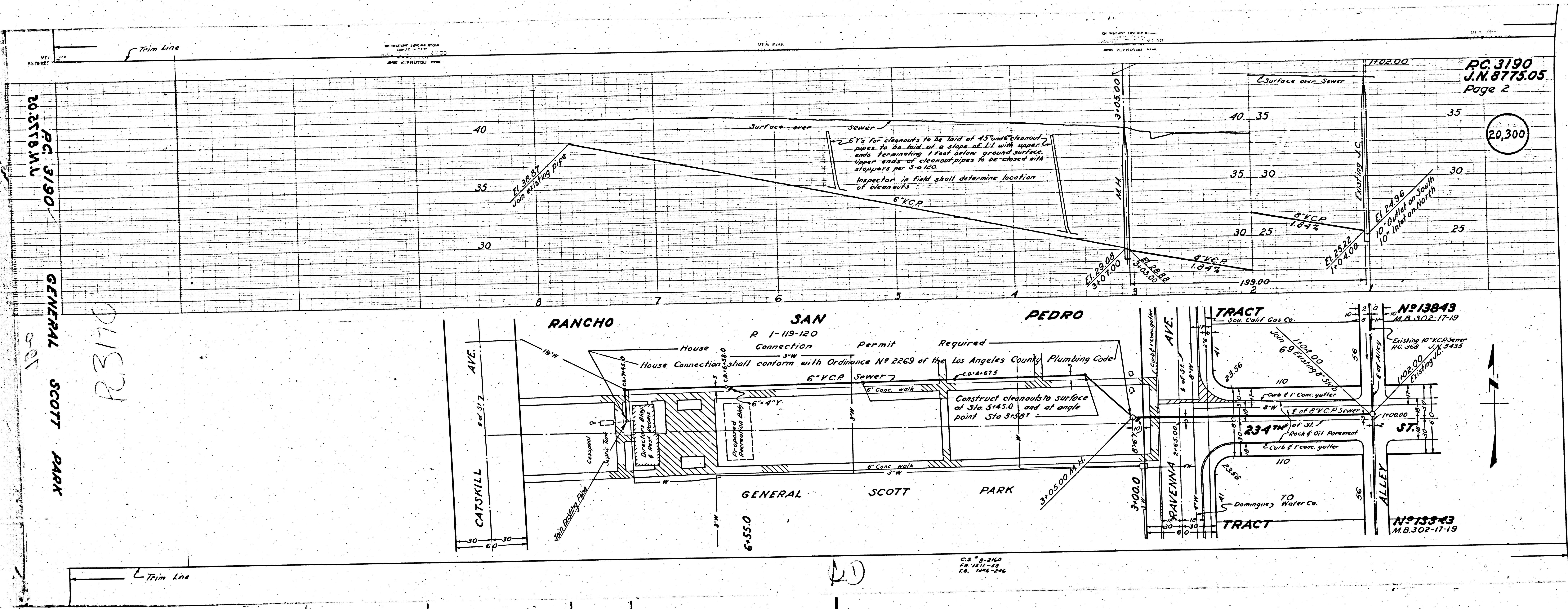

PC 3190  
20258 MV

GENERAL SCOTT PARK

PC 3170

Trim Line

(10)