

B.M. Rd. Dept. 57 748 Elev. 51.590
Gridley Rd. & Orangethorpe Ave.
L. & T. 1' South E Intersection.

BELLFLOWER BLDG. DIST. N° 4

- NOTE:**
Provide stakes on the property lines or property lines produced at right angles to the sewer line at the center line of each manhole.
No representative of the County Engineer will survey or layout any portion of the work.
The owner or his authorized representative shall furnish the County Engineer with grade sheets and stations for all house laterals and Y branches and shall provide stakes for them at their proper locations with stationing plainly marked. Any change in location shall be requested in writing by the owner or his representative.
No revisions shall be made in these plans without the approval of the County Engineer.
1. Use standard manhole frames and covers, S-a-117, except as noted.
 2. Use standard strength pipe except as noted.
 3. Use joint compound for all vitrified clay pipe joints per Spec's, Sec. 31.
 4. Resurface all trench within paved area to meet L.A. County Road Dept. or California State Highway Dept. requirements in accordance with permit.
 5. Encase four feet of sewer at points of interference with poles, S-a-119.
 6. ~~Manholes shall be constructed with inverted property lines.~~
 7. All structures shall be brick sewer structures, S-a-104, except as noted.
 8. For allowable leakage test, use Formula No. 2, Spec's, Sec. 61.
- ~~Manholes to be constructed with inverted property lines.~~

PROFILE, ALIGNMENT AND GRADE OF
SANITARY SEWERS
TO BE CONSTRUCTED IN

PC. 3235
J.N. 1010.71
Page 1

ORANGETHORPE BLVD.

PRIVATE CONTRACT NO. 3235
W. S. 31
1 SHEET

Scale: VERT. 1" = 4'
HORIZ. 1" = 40' OCTOBER 1954
PREPARED IN THE OFFICES OF

VALLEY ENGINEERING CO.

By *J. L. Manning* Reg. C. E. No. 7676
FOR LEGEND SEE PLAN NO. S-a-64

NOTE:
Grades to which this improvement is to be constructed are shown on plans and profiles. Grade points for top of curbs, center line of streets, or center line of alleys are shown by circles on profiles. At all points between designated points the grade shall be established so as to conform to a straight line drawn between said designated points.
Elevations are in feet above U.S.G.S. datum or mean sea level.
This drawing and the data hereon are hereby made a part of the specifications.
Work shall be constructed according to specifications on file in the office of the County Engineer and shall be prosecuted only in the presence of the County Engineer.
Before work can be started, the contractor must obtain a permit to excavate in County streets from the L.A. County Road Dept., 108 W. 2nd St. and make a deposit with the County Engineer, 733 L.A. County Engineering Building, sufficient to cover the cost of construction inspection and record plans.
Approval of this plan by the County of Los Angeles does not constitute a representation as to the accuracy of the location of or the existence or non-existence of any underground utility, pipe, or structure within the limits of this project. This note applies to all sheets.
If work is to be done in a State Highway, a permit must be obtained from the State of California, Division of Highways, 120 South Spring Street.

COUNTY OF LOS ANGELES, CALIFORNIA
Approved, William J. Fox, County Engineer Approved, A. M. Ravn
CHIEF ENGR. CO. SAN. DIST. NO. 12
By *W. S. 31* By *A. M. Ravn*
Checked By *W. S. 31* Office Engineer
Office of County Engineer, Reg. C. E. No. 7862.

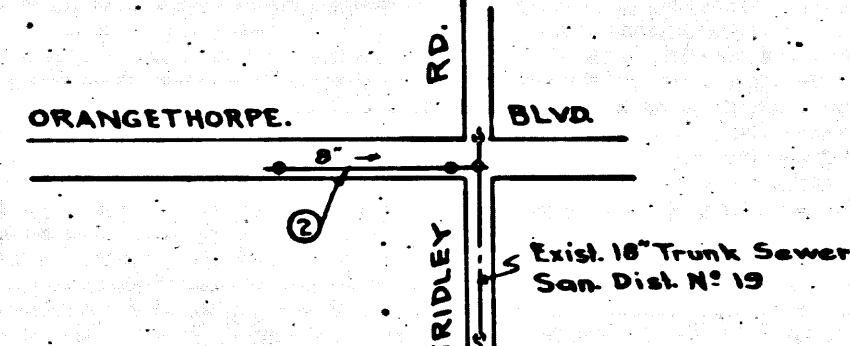

CHARGES AS INDICATED
FOR CONNECTIONS
W. S. 31 10-25-54

Before breaking into any existing structure
and before final acceptance of this work,
County Sanitation District should be notified
in order that required inspection may be made.

INDEX MAP
SCALE: 1" = 400'
PC. 3235 J.N. 1010.71

INDUSTRIAL WASTE
APPROVED *W. S. 31*

SHEET	PAGES
1	1-2

PC. 3235
ORANGETHORPE BLVD.
BELLFLOWER BLDG. DIST. N° 4

W. S. 31

PC3235

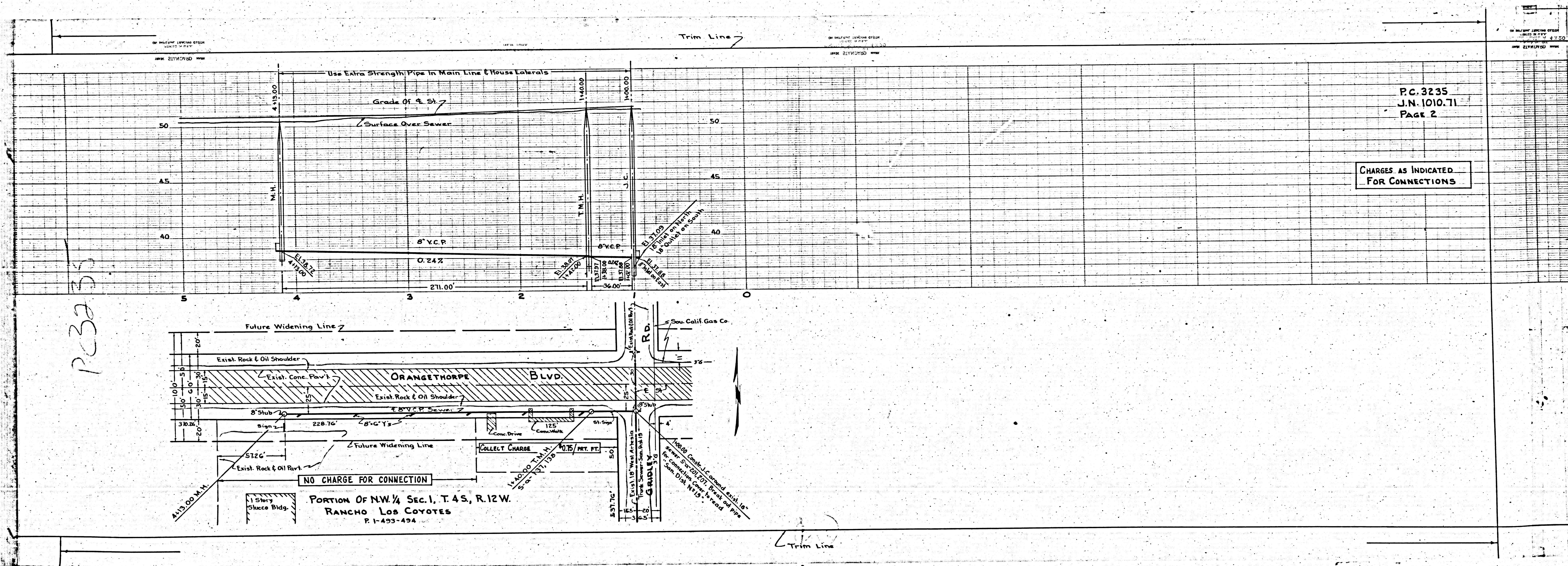

P.C. 3235
J.N. 1010.71
PAGE 2

CHARGES AS INDICATED
FOR CONNECTIONS

PORTION OF NW 1/4 SEC. 1, T. 4 S., R. 12 W.
RANCHO LOS COYOTES
P. 1-493-494