

B.M. ME16 EL. 274.743
Garvey Ave. & Peck Road. NE Cor.
Bl. spk. in conc. base of signal stand

- NOTE.**
1. Provide stakes on the property lines or property lines produced at right angles to the sewer line at the center line of each manhole.
 2. No representative of the County Engineer will survey or layout any portion of the work. The owner or his authorized representative shall furnish the County Engineer with grade sheets and stations for all house laterals and Y branches and shall provide stakes for them at their proper locations with stationing plainly marked. Any change in location shall be requested in writing by the owner or his representative.
 3. No revisions shall be made in these plans without the approval of the County Engineer.
 4. Use standard manhole frames and covers, S-a-117.
 5. Use standard strength pipe.
 6. Use cement mortar for all vitrified clay pipe joints.
 7. Resurface all trench within paved area to meet L.A. County Road Dept. or Calif. State Highway Dept. requirements in accordance with permit.
 8. Encase four feet of sewer at points of interference with poles, S-a-119.
 9. House laterals to be constructed with inverts at property line...feet below curb grade except as noted.
 10. All structures shall be brick sewer structures, S-a-104.
 11. Manhole tops in unimproved Rights-Of-Way to be 6" above finish grade.
 12. For allowable leakage test, use Formula No. 1, Specs., Sec. 51.

PROFILE, ALIGNMENT AND GRADE OF
SANITARY SEWERS
TO BE CONSTRUCTED IN
PECK ROAD & ALLEY P.C. 3284
PAGE 1

PRIVATE CONTRACT NO. 3284
W. S. 46

SHEET 22,165

DATE: VERT. 1"=4'
HORIZ. 1"=40' NOV. 1954

PREPARED IN THE OFFICES OF
Chas. N. Bell, Civil Engineer
John D. Bell, Civil Engineer

FOR LEGEND SEE PLAN NO. S-a-64

NOTE.

Grades to which this improvement is to be constructed are shown on plans and profiles. Grade points for top of curbs, center line of streets, or center line of alleys are shown by circles on profiles. At all points between designated points the grade shall be established so as to conform to a straight line drawn between said designated points.

Elevations are in feet above U.S.G.S. datum or mean sea level.

This drawing and the data hereon are hereby made a part of the specifications.

Work shall be constructed according to specifications on file in the office of the County Engineer and shall be prosecuted only in the presence of the County Engineer.

Before work can be started, the contractor must obtain a permit to excavate in County streets from the L.A. County Road Dept., 108 W. 2nd St. and make a deposit with the County Engineer, 733 L.A. County Engineering Building, sufficient to cover the cost of construction inspection and record plans.

Approval of this plan by the County of Los Angeles does not constitute a representation as to the accuracy of the location of or the existence or non-existence of any underground utility, pipe, or structure within the limits of this project. This note applies to all sheets.

If work is to be done in a State Highway, a permit must be obtained from the State of California, Division of Highways, 120 South Spring Street.

COUNTY OF LOS ANGELES, CALIFORNIA

Approved, William J. Fox, County Engineer
Approved, A. M. Rawns
CHIEF ENGR. CO. SAN. DIST. NO. 15

Checked by: J. P. Collins, Sanitation Engineer
Checked by: J. P. Collins, Sanitation Engineer

Office of County Engineer, Reg. C. E. No. 7860

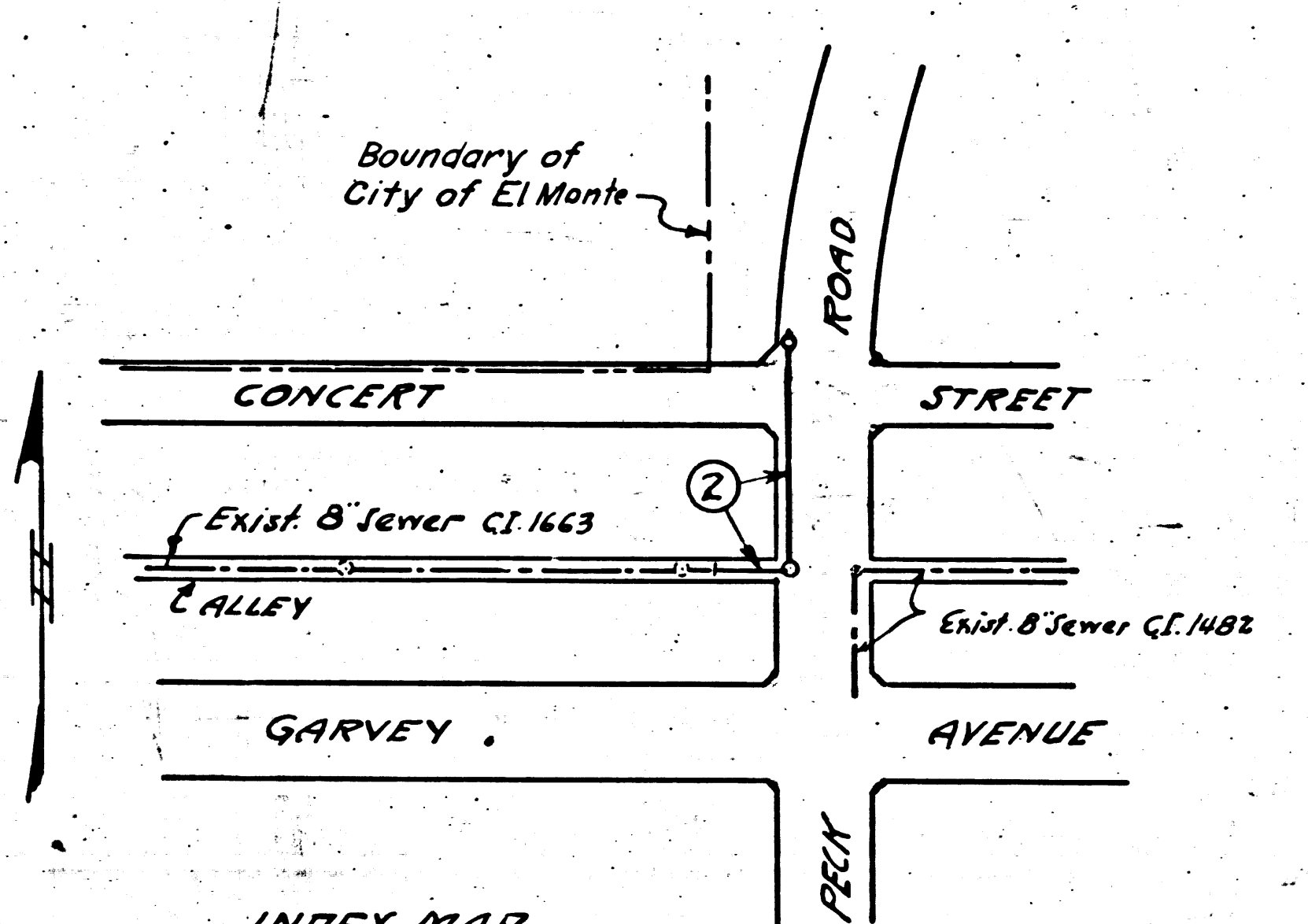

SHEET NO.	PAGES
1	1-2

NO CHARGE FOR CONNECTIONS
PR 12-17-54

checked 1-25-56 W. J. Fox

P.C. 3284

PAGE 2

NO CHARGE FOR CONNECTIONS

22,166

RL

830

Issue-11/11
P.C. 3284

RL

INDEX MAP Scale 1"=200' P.C. 3284

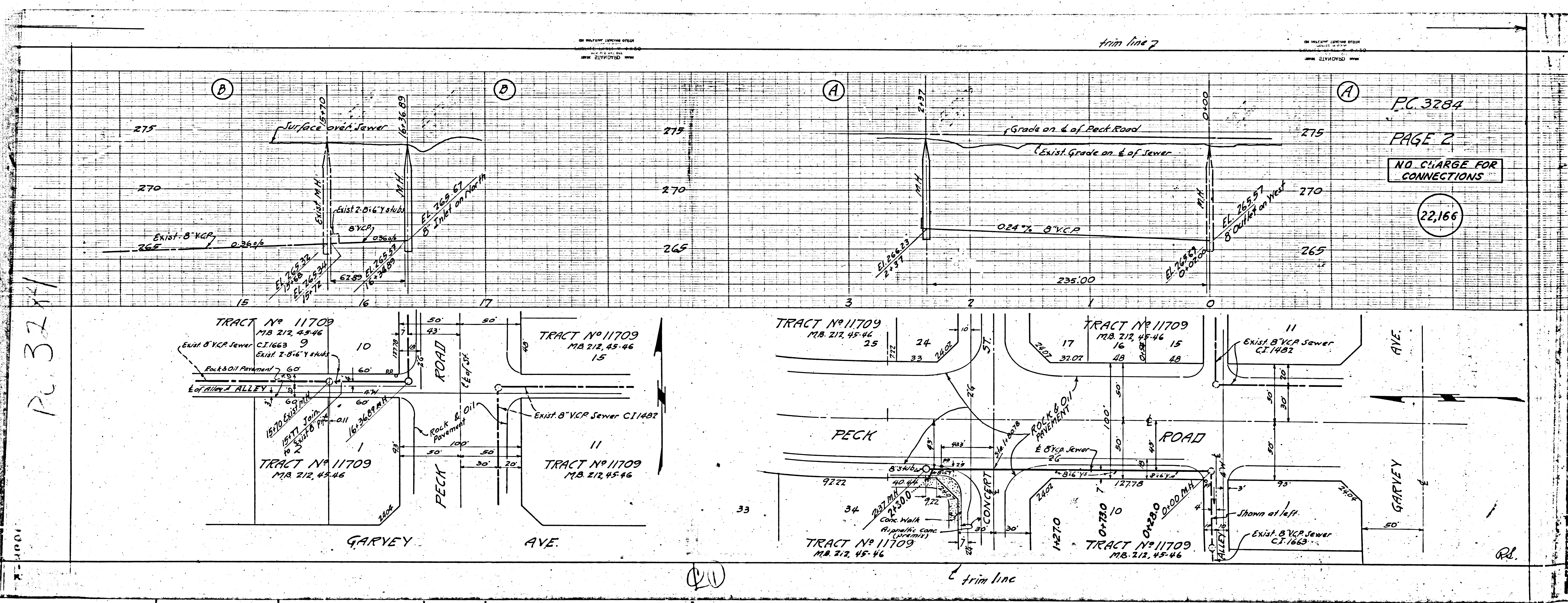

PC 3284

PC 3284

PAGE 2

NO. CHARGE FOR CONNECTIONS

22,166

from line 7

from line

QU

RL