

3407  
E 2  
2  
Page Trim Line

B.M. S-Y 3640 El. 54.620 L & B.N. South  
Curb South St. 1' East of Curb Ref of  
S.E. Corner Lakewood Blvd. & South St.

NO CHARGE FOR  
CONNECTIONS  
to Utility 3-9-55

SHEET No	PAGES
1	1-2

Checked 4-7-55 W. Fox

Trim Line  
**BELLFLOWER BLDG. DIST. No 4**

- NOTE:**  
Provide stakes on the property lines or property lines produced at right angles to the sewer at the center line of each manhole.  
No representative of the City Engineer will survey or layout any portion of the work.  
The owner or his authorized representative shall furnish the City Engineer with grade sheets and stations for all house laterals and Y branches and shall provide stakes for them at their proper locations with stationing plainly marked. Any change in location shall be requested in writing by the owner or his representative.  
No revisions shall be made in these plans without the approval of the City Engineer.
1. Use standard manhole frames and covers, S-a-117.
  2. Use standard strength pipe except as noted.
  3. Use cement mortar for all vitrified clay pipe joints.
  4. Resurface all trench within paved area to meet City Road Dept. or California State Highway Dept. requirements in accordance with permit.
  5. Encase four feet of sewer at points of interference with poles, S-a-119.
  6. House laterals to be constructed with inverts at property line  $\frac{1}{2}$  feet below curb grade except as noted.
  7. All structures shall be brick sewer structures, S-a-104.
  8. For allowable leakage test, use Formula No. 1, Spec's, Sec. 51.
  9. Manhole tops in unimproved Rights-Of-Way to be 6" above finish grade.

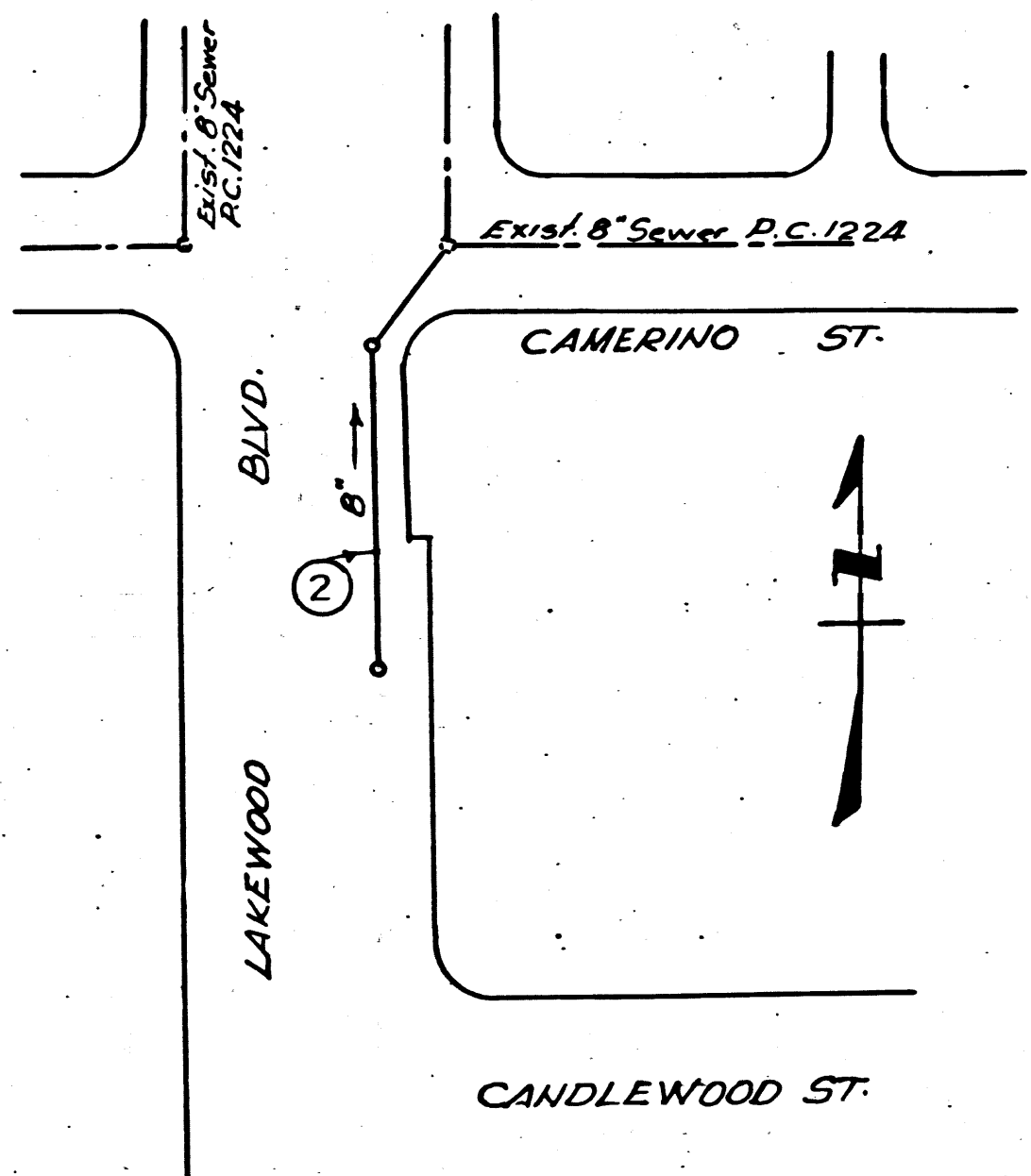

APPROVED  
INDUSTRIAL WASTE DIVISION  
*Arthur P. Schmitt*  
DIVISION ENGINEER

INDEX MAP  
SCALE: 1" = 100'  
PC 3407

PROFILE, ALIGNMENT AND GRADE OF  
**SANITARY SEWERS**  
TO BE CONSTRUCTED IN  
**LAKEWOOD BLVD.**  
FOR  
**UNION OIL COMPANY.**

PC 3407  
PAGE 1

(20,061)

PRIVATE CONTRACT NO. 3407  
W. S. 33 & 31

1 SHEET  
Scale: VERT. 1" = 4'  
HORIZ. 1" = 40'  
MARCH 1955  
PREPARED IN THE OFFICES OF

**NATIONAL ENGINEERING & SURVEYING SERVICE.**  
*Edworth J. Esperson*  
Reg. C. E. No. 5282  
FOR LEGEND SEE PLAN NO. S-a-64

**NOTE:**  
Grades to which this improvement is to be constructed are shown on plans and profiles. Grade points for top of curbs, center line of streets, or center line of alleys are shown by circles on profiles. At all points between designated points the grade shall be established up as to contour to a straight line drawn between said designated points.  
Elevations are in feet above U.S.G.S. datum or mean sea level.  
This drawing and the data hereon are hereby made a part of the specifications.  
Work shall be constructed according to specifications on file in the office of the City Engineer and shall be prosecuted only in the presence of the City Engineer.  
Before work can be started, the contractor must obtain a permit to excavate in County streets from the City Road Dept., 108 W. 2nd St. and make a deposit with the City Engineer, Room 324, 253 So. Broadway, sufficient to cover the cost of construction inspection and record plans.  
Approval of this plan by the City of Lakewood does not constitute a representation as to the accuracy of the location of or the existence or non-existence of any underground utility, pipe, or structure within the limits of this project. This note applies to all sheets.  
If work is to be done in a State Highway, a permit must be obtained from the State of California, Division of Highways, 120 South Spring Street.

CITY OF LAKEWOOD, CALIFORNIA  
Approved, William J. Fox, City Engineer  
Approved, A. M. Rawen  
CHIEF ENGR.-CO. SAN. DIST. NO. 3  
*A. P. Collins* *A. M. Rawen*  
Sanitation Engineer Office Engineer  
Checked by *R. J. ...* 3-17-55  
Office of City Engineer, Reg. C. E. No. 7860

PC 3407

RS

Trim Line



