

B.M. 544 - P. 244.044 - F.B. 730, pg 21
Via Campo & Sadler Ave., N.W. Cor.
Bent Sol in Curb-6' N. of Al. End Curb Return.

TRIM LINE

EAST LOS ANGELES Bldg. Dist. No. 6

- NOTE:
Provide stakes on the property lines or property lines produced at right angles to the center line at the center line of each manhole.
No representative of the County Engineer will survey or layout any portion of the work. The owner or his authorized representative shall furnish the County Engineer with grade sheets and stations for all house laterals and Y branches and shall provide stakes for them at their proper locations with stationing plainly marked. Any change in location shall be requested in writing by the owner or his representative.
No revisions shall be made in these plans without the approval of the County Engineer.
1. Use standard manhole frames and covers, S-a-117.
 2. Use standard strength pipe except as noted.
 3. Use cement mortar for all vitrified clay pipe joints.
 4. Resurface all trench within paved area to meet L.A. County Road Dept. or Calif. State Highway Dept. requirements in accordance with permit.
 5. Encase four feet of sewer at points of interference with poles, S-a-119.
 6. House laterals to be constructed with inverts at property line 6 feet below grade of the centerline of the Alley, except as noted.
 7. All structures shall be brick sewer structures, S-a-104.
 8. For allowable leakage test, use Formula No. 1, Spec's., Sec. 51.
 9. Manhole tops in unimproved Rights-of-Way to be 6" above finish grade.

PROFILE, ALIGNMENT AND GRADE OF
SANITARY SEWERS
TO BE CONSTRUCTED IN

P. C. 3482
PAGE 1

TRACT NO 21436

PRIVATE CONTRACT NO. 3482

W. S. 36 / SHEETS

Scale: VERT. 1"=4'
HORIZ. 1"=40'

APRIL 1953

PREPARED IN THE OFFICES OF
KARL TUTTLE ENGINEERING CO.

Jay M. Ressler 4-20-53
Reg. C. E. No. 8336
FOR LEGEND SEE PLAN NO. S-a-64

21,406

TRACT NO 21436

REVISION
REVISED ALIGNMENT ON 1ST ALLEY
SOUTH OF POMONA BLVD ON PAGE 2

APPROVED COUNTY ENGINEER

BY *G. V. Onda* Date 8-22-55
RS 8406

KARL F. TUTTLE ENGINEERING CO. INC.

Jay M. Ressler Date August 18, 1955
R.E. 8336

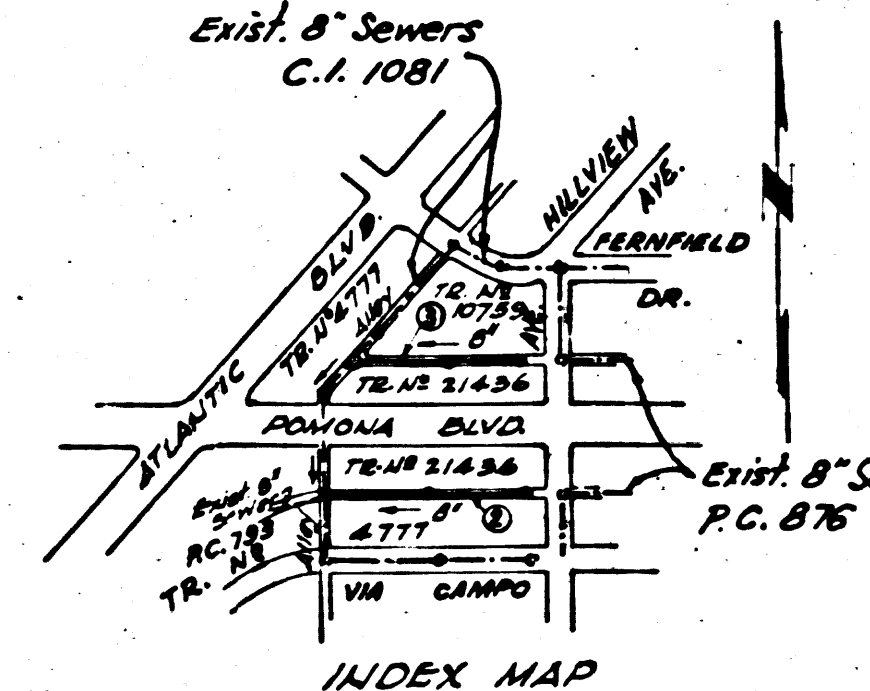

NO CHARGE FOR CONNECTIONS
Ressler 6-31-55

SHEET NO	PAGES
1	1-3

Revised 9-22-55 *McGraw*

TRIM LINE

NOTE:
Grades to which this improvement is to be constructed are shown on plans and profiles. Grade points for top of curbs, center line of streets, or center line of alleys are shown by circles on profiles. At all points between designated points the grade shall be established so as to conform to a straight line drawn between said designated points.
Elevations are in feet above U.S.G.S. datum or mean sea level.
This drawing and the data hereon are hereby made a part of the specifications.
Work shall be constructed according to specifications on file in the office of the County Engineer and shall be prosecuted only in the presence of the County Engineer.
Before work can be started, the contractor must obtain a permit to excavate in County streets from the L.A. County Road Dept., 108 W. 2nd St., and make a deposit with the County Engineer, Rm. 224, 253 South Broadway, sufficient to cover the cost of construction inspection and record plans.
Approval of this plan by the County of Los Angeles does not constitute a representation as to the accuracy of the location of or the existence or non-existence of any underground utility pipe, or structure within the limits of this project. This note applies to all sheets.
If work is to be done in a State Highway, a permit must be obtained from the State of California, Division of Highways, 120 South Spring Street.

COUNTY OF LOS ANGELES, CALIFORNIA
Approved, William J. Fox, County Engineer
Approved, A. M. Rawl
CHIEF ENGR. SAN. DIST. NO. 2
By *J. P. Collins*
Sanitation Engineer
Checked by *Ressler* 6-30-55
Office Engineer
Office of County Engineer, Reg. C. E. No. 2860

P.C. 3482
SBAE:CA

PR

P.C. 3482
PAGE 3

CHARGE FOR
REVISIONS

21,408

P.C. 3482
PAGE 2

NO CHARGE FOR
CONNECTIONS

21,407

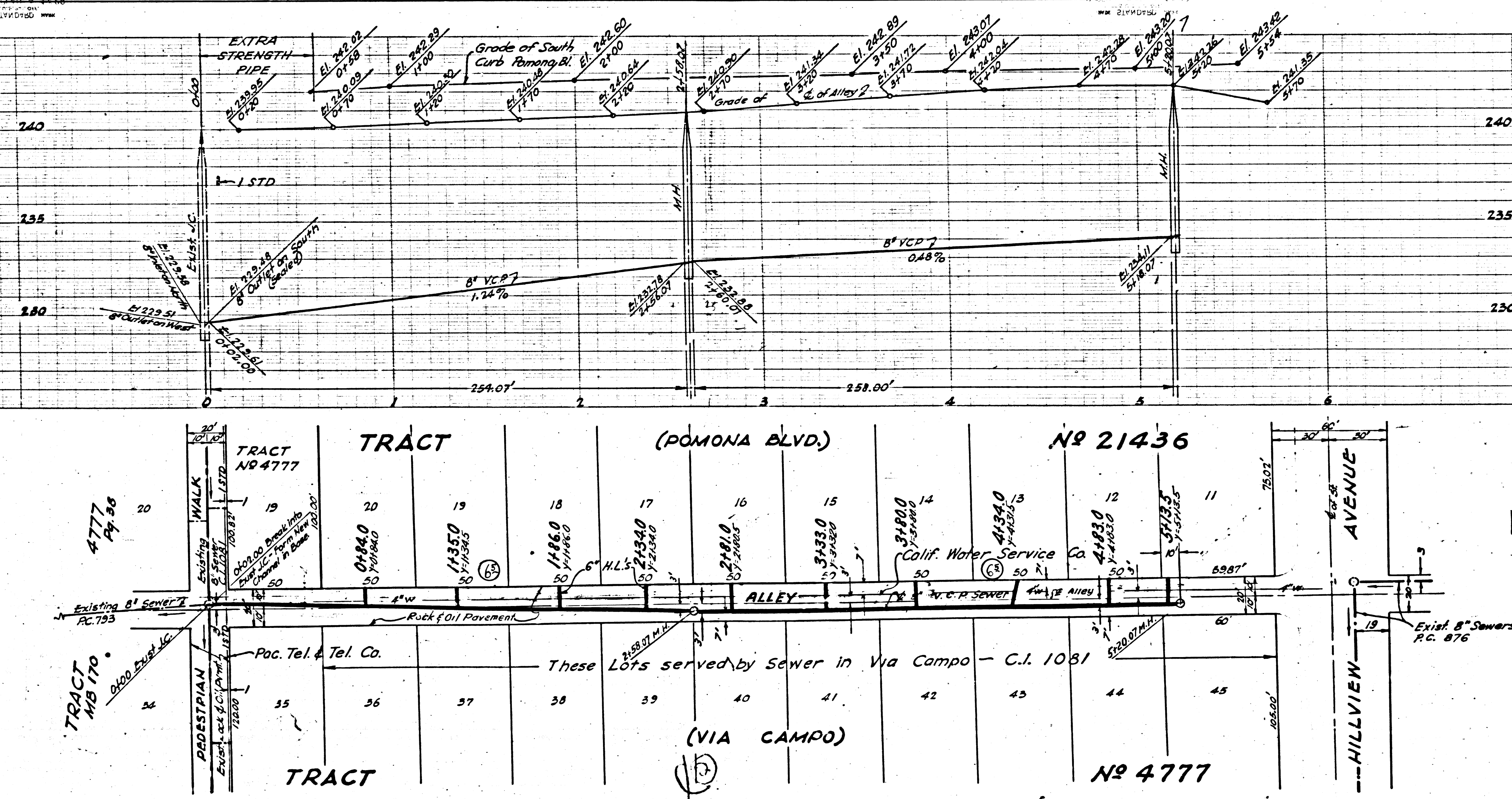

PC 3492

Trim Line

House Laterals to be constructed with 1/4" rise per foot to property line

PC 3492
PAGE 3

NO CHARGE FOR CONNECTIONS

21,408

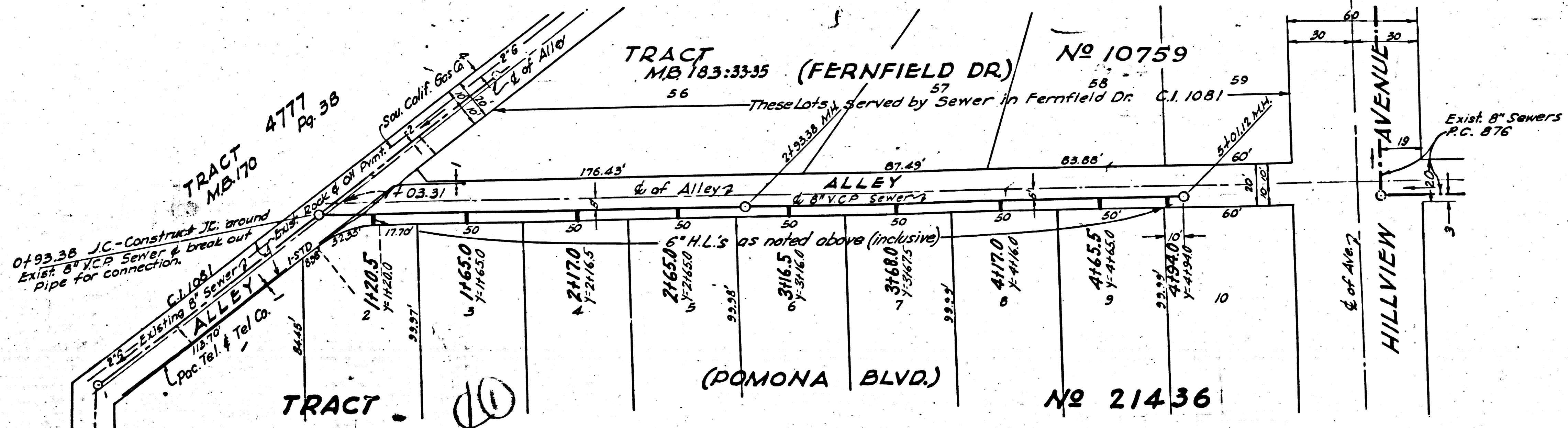

Trim Line