

BMATIO Elev. 139.679 FB 1A53 pg. 10
 Claymore St & 14th Alley, E. of Serapia Ave.
 N.E. cor. Bl. Spk. In RR # 742908 E.

WHITTIER BLVD. DIST. N^o 11

- NOTE:**
- Provide stakes on the property lines or property lines produced at right angles to the sewer line at the center line of each manhole.
- No representative of the County Engineer will survey or layout any portion of the work.
- The owner or his authorized representative shall furnish the County Engineer with grade sheets and stations for all house laterals and Y branches and shall provide stakes for them at their proper locations with stationing plainly marked. Any change in location shall be requested in writing by the owner or his representative.
- No revisions shall be made in these plans without the approval of the County Engineer.
1. ~~Use standard strength pipe except as noted.~~
 2. Use standard strength pipe except as noted.
 3. Use cement mortar for all vitrified clay pipe joints.
 4. Resurface all trench within paved area to meet L.A. County Road Dept. or California State Highway Dept. requirements in accordance with permit.
 5. Encase four feet of sewer at points of interference with poles, S-a-119.
 6. ~~House laterals to be constructed with inverts at property line~~ feet below curb grade ~~except as noted.~~
 7. All structures shall be per S-d-145.
 8. For allowable leakage test, use Formula No. 1, Spec's., Sec. 51.
 9. Manhole tops in unimproved Rights-Of-Way to be 6" above finish grade.

NO CHARGE FOR CONNECTIONS
L. Carter 7-5-55

TABLE	
SHEET NO.	PAGE
1	1-2

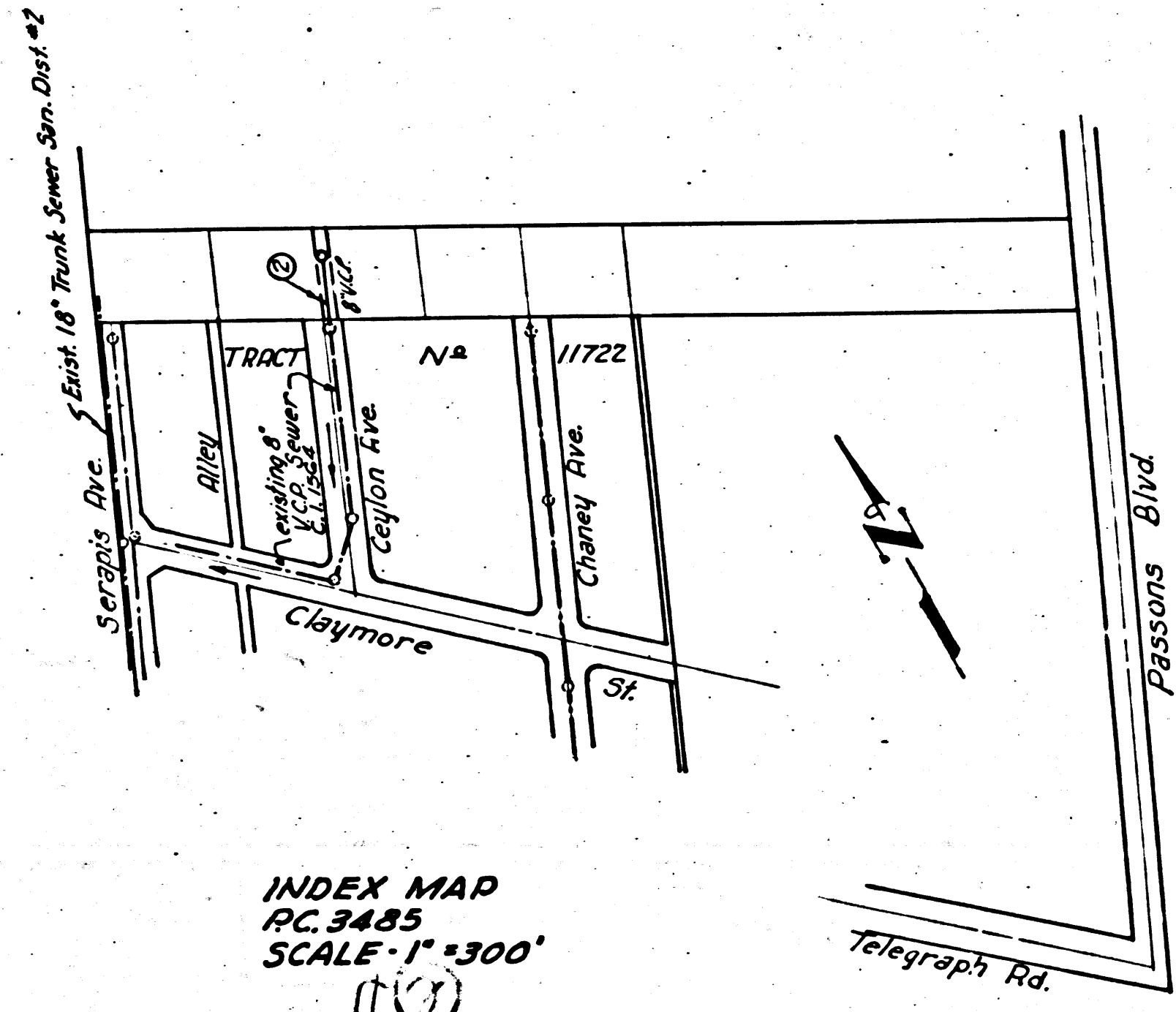

INDEX MAP
 PC 3485
 SCALE - 1" = 300'

checked 7-18-55 W. Kern

PROFILE, ALIGNMENT AND GRADE OF
SANITARY SEWERS
 TO BE CONSTRUCTED IN
CEYLON AVENUE RIGHT OF WAY

PAGE-1
 PC 3485

20,902

PRIVATE CONTRACT NO. 3485
 W. S. 36
 1 SHEET

Scale: VERT. 1" = 4'
 HORIZ. 1" = 40' MAY 1955

PREPARED IN THE OFFICES OF
LOVETT AND HART
 ENGINEERS & SURVEYORS

S. Hart
 Reg. C. E. No. 7086

FOR LEGEND SEE PLAN NO. S-a-64

NOTE:

Grades to which this improvement is to be constructed are shown on plans and profiles. Grade points for top of curbs, center line of streets, or center line of alleys are shown by circles on profiles. At all points between designated points the grade shall be established so as to conform to a straight line drawn between said designated points.

Elevations are in feet above U.S.G.S. datum or mean sea level.

This drawing and the data hereon are hereby made a part of the specifications.

Work shall be constructed according to specifications on file in the office of the County Engineer and shall be prosecuted only in the presence of the County Engineer.

Before work can be started, the contractor must obtain a permit to excavate in County streets from the L.A. County Road Dept., 108 W. 2nd St. and make a deposit with the County Engineer, 255 S. Broadway, Rm 518 sufficient to cover the cost of construction inspection and record plans.

Approval of this plan by the County of Los Angeles does not constitute a representation as to the accuracy of the location of or the existence or non-existence of any underground utility, pipe, or structure within the limits of this project. This note applies to all sheets.

If work is to be done in a State Highway, a permit must be obtained from the State of California, Division of Highways, 120 South Spring Street.

COUNTY OF LOS ANGELES, CALIFORNIA

Approved, William J. Fox, County Engineer

Approved, A. M. Rawns
 CHIEF ENGR. OF SAN. DIST. NO. 2
A. P. Collins
 Sanitation Engineer

Checked by: *R. S. Kuhn 7-5-55*
 Office of County Engineer, Reg. C. E. No. 7840

CEYLON AVENUE RIGHT OF WAY

PC 3485
 284E.C.A.

P.R.

PC 3485

NO CHARGE
FOR CONNECTIONS

20,903

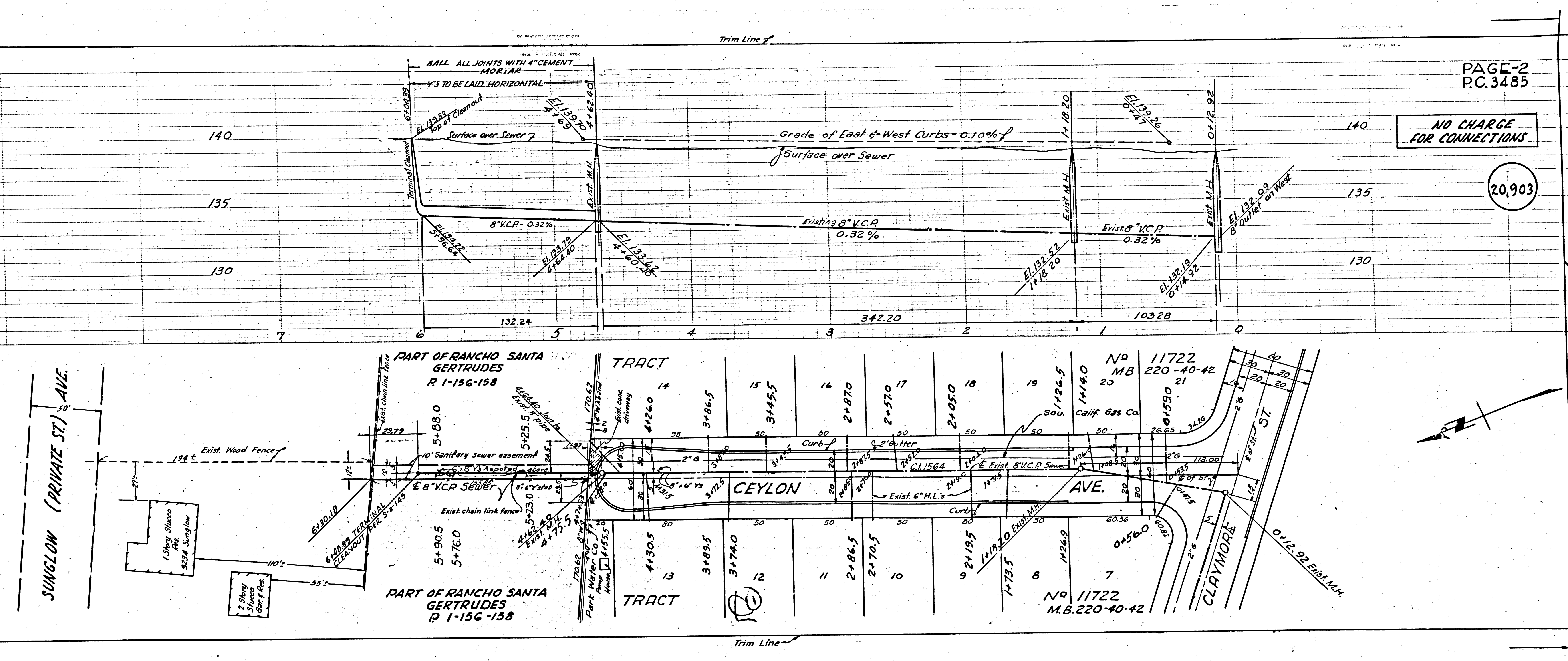

SUNGLON (PRIVATE ST.) AVE.

PART OF RANCHO SANTA GERTRUDES P. 1-156-158

TRACT

PART OF RANCHO SANTA GERTRUDES P. 1-156-158

TRACT

CEYLON AVE.

CLAYMORE ST.

No 11722 M.B. 220-40-42

No 11722 M.B. 220-40-42

Calif. Gas Co.

