

**LENNOX BLDG DIST. No 7**

- NOTE:**
1. Provide stakes on the property lines or property lines produced at right angles to the sewer line at the corner line of each manhole.
  2. No representative of the County Engineer will survey or layout any portion of the work.
  3. The owner or his authorized representative shall furnish the County Engineer with grade sheets and stations for all house laterals and Y branches and shall provide stakes for them at their proper locations with stationing plainly marked. Any change in location shall be requested in writing by the owner or his representative.
  4. No revisions shall be made in these plans without the approval of the County Engineer.
  5. Use standard manhole frames and covers, S-o-117.
  6. Use standard strength pipe except as noted.
  7. Use cement mortar for all vitrified clay pipe joints.
  8. Resurface all trench within paved area to meet L.A. County Road Dept. or California State Highway Dept. requirements in accordance with permit.
  9. Encase four feet of sewer at points of interference with poles, S-o-113.
  10. House laterals to be constructed with inverts at property line  $\frac{1}{2}$  foot below curb grade except as noted.
  11. All structures shall be brick sewer structures, S-o-104.
  12. For allowable leakage test, use Formula No. 1, Spec's., Sec. 51.
  13. Manhole tops in unimproved Rights-Of-Way to be 6" above finish grade.

**BY:**  
 DISTRICT ENGINEER AS APPROVED  
 TO BE EXERCISED ON PROVISIONS OF  
 THE HEALTH AND SAFETY ACT IN FORCE  
 OR APPLICABLE TO THIS DISTRICT  
 CITY OF LOS ANGELES  
 DIVISION OF INDUSTRIAL WASTE  
 DIVISION OF HIGHWAYS, 120 SOUTH SPRING STREET  
 DIVISION OF WATER SUPPLY  
 DIVISION OF PUBLIC WORKS  
 DIVISION OF PUBLIC UTILITIES  
 DIVISION OF PUBLIC SAFETY  
 DIVISION OF PUBLIC WORKS  
 DIVISION OF PUBLIC UTILITIES  
 DIVISION OF PUBLIC SAFETY

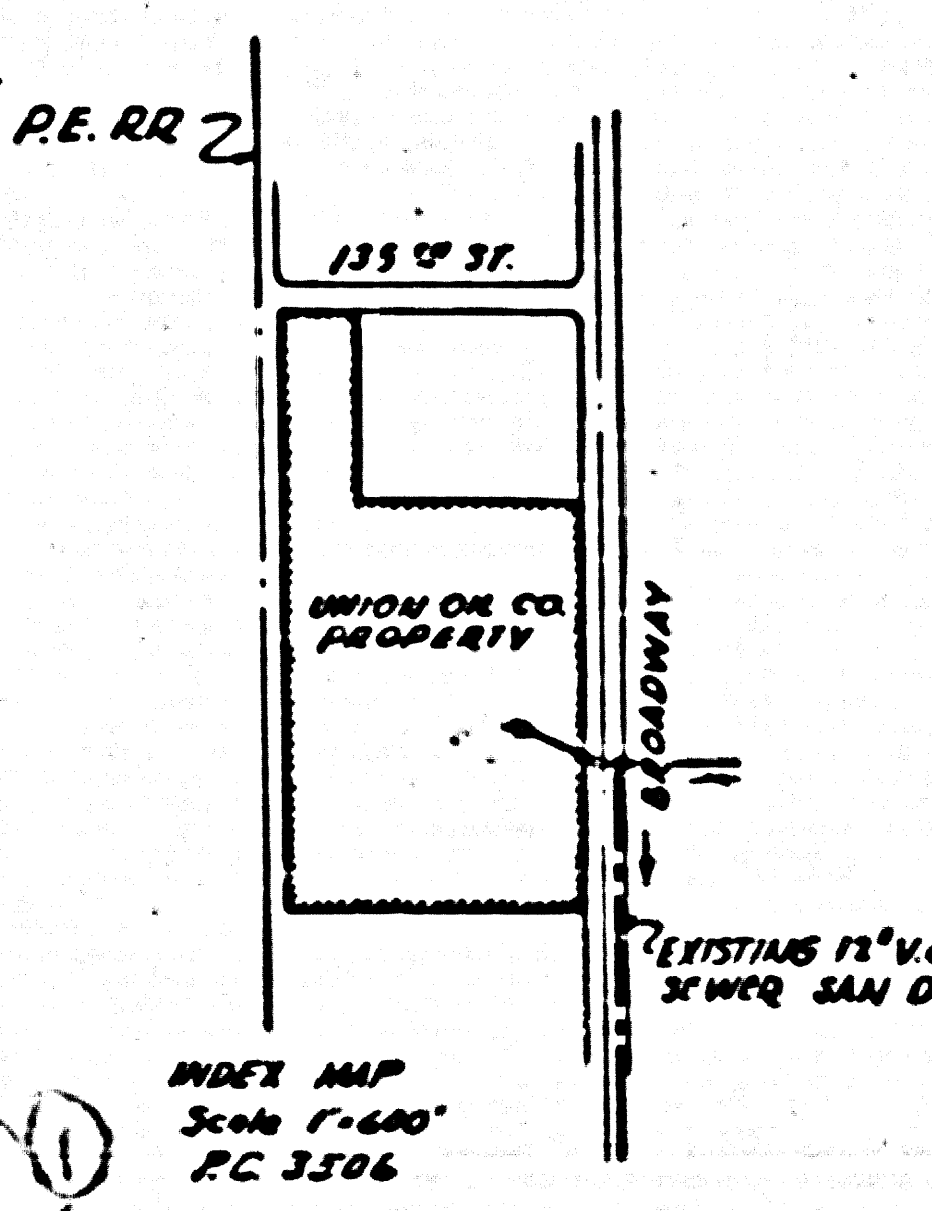

SHEET	PAGE
1	1

**NO CHARGE FOR CONNECTION**  
 5-23-55

Revised 8-17-55

PC. 3506  
 Page 1

PROFILE, ALIGNMENT AND GRADE OF  
**SANITARY SEWERS**  
 TO BE CONSTRUCTED FOR  
**UNION OIL COMPANY**

(21151)

PRIVATE CONTRACT NO. 3506  
 W. S. 26  
**ONE SHEET**

Scale: VERT. 1" = 40'  
 HORIZ. 1" = 40'  
 MAY, 1955  
 PREPARED IN THE OFFICES OF  
**BECHTEL CORPORATION, SAN FRANCISCO**

*Henry K. Schlegel*  
 Reg. C.E. No. 6854

FOR LEGEND SEE PLAN NO. S-o-64

**NOTE:**  
 Grades to which this improvement is to be constructed are shown on plans and profiles. Grade points for top of curbs, center line of streets, or center line of alleys are shown by circles on profiles. At all points between designated points the grade shall be established as to conform to a straight line drawn between said designated points.  
 Elevations are in feet above U.S.G.S. datum or mean sea level.  
 This drawing and the data hereon are hereby made a part of the specifications.  
 Work shall be constructed according to specifications on file in the office of the County Engineer and shall be procured only in the presence of the County Engineer.  
 Before work can be started, the contractor must obtain a permit to excavate in County streets from the L.A. County Road Dept., 108 W. 2nd St. and make a deposit with the County Engineer, Rm. 224, 233 St. Broadway, sufficient to cover the cost of construction inspection and record plans.  
 Approval of this plan by the County of Los Angeles does not constitute a representation as to the accuracy of the location of or the existence or non-existence of any underground utility, pipe, or structure within the limits of this project. This note applies to all sheets.  
 If work is to be done at a State Highway, a permit must be obtained from the State of California, Division of Highways, 120 South Spring Street.

**COUNTY OF LOS ANGELES, CALIFORNIA**  
 Approved, William J. Fox, County Engineer

Approved, A. M. Ravn  
 CHIEF ENGR. CO. SAN DIST. NO. 8  
*A.P. Allen*  
 District Engineer  
 Checked by *R.P. ...* 5-24-55  
 Office of County Engineer, Reg. C. & No. 7262

APPROVED BY INDUSTRIAL WASTE DIVISION  
 BY *John ...* DATE 5-20-55

UNION OIL COMPANY

W.S. 26

PC 3506

PC 3506