

**BELLFLOWER BLDG. DIST 4**

- NOTE:**  
 Provide stakes on the property lines or property lines produced at right angles to the sewer line at the corner line of each manhole.
- No representative of the County Engineer will survey or layout any portion of the work. The owner or his authorized representative shall furnish the County Engineer with grade sheets and stations for all house laterals and Y branches and shall provide stakes for them at their proper locations with stationing plainly marked. Any change in location shall be requested in writing by the owner or his representative.
- No revisions shall be made in these plans without the approval of the County Engineer.
1. Use standard manhole frames and covers, S-6-117.
  2. Use standard strength pipe except as noted.
  3. Use cement mortar for all vitrified clay pipe joints.
  4. Resurface all trench within paved area to meet L.A. County Road Dept. or California State Highway Dept. requirements in accordance with plans.
  5. Excavate four feet of cover at points of interference with poles, S-6-119.
  6. House laterals to be constructed with "N" Pipe per foot to property line, except as noted.
  7. All structures shall be brick sewer structures, S-6-104.
  8. For allowable leakage test, see Formula No. 1, Sec. 51.
  9. Manhole tops in unimproved Right-of-Way to be 6" above finish grade.

**NOTE: ISSUE NO PERMITS UNTIL ALBERTIS AVE IS DEDICATED TO AND ACCEPTED BY L.A. COUNTY - CALL MAIN OFFICE - RA-9-4747 EXT. 404**

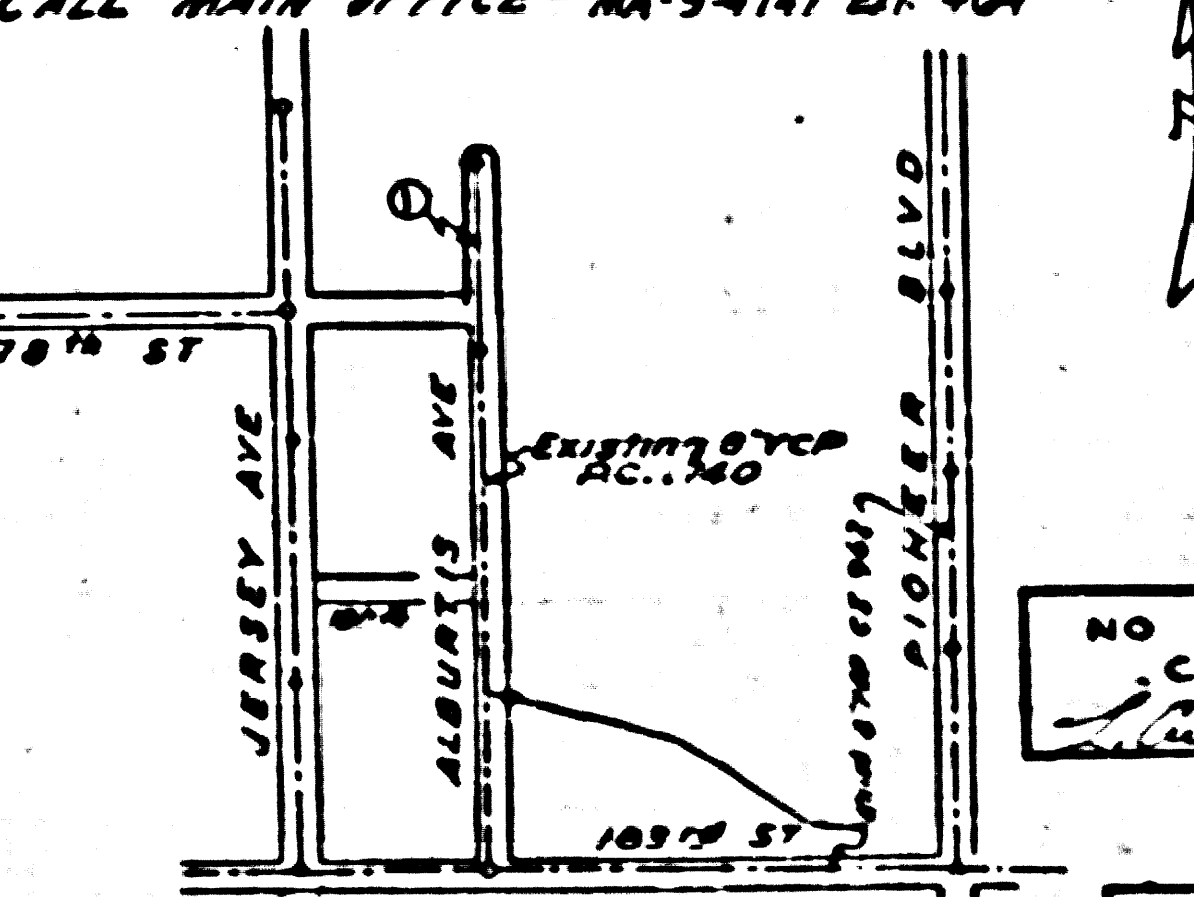

INDEX MAP  
 SCALE 1"=400'  
 P.C. 3563  
 Dated 9-22-55

NO CHARGE FOR CONNECTIONS  
 7-26-55

SHEET	PAGE
1	1

PROFILE, ALIGNMENT AND GRADE OF  
**SANITARY SEWERS**  
 TO BE CONSTRUCTED IN  
**ALBERTIS AVE**  
 NORTH OF 178<sup>TH</sup> STREET

PRIVATE CONTRACT NO. 3563  
 W. S. 53  
 SHEETS

Scale:  $\frac{1}{4}$ " = 1'-0"  
 July 1955

PREPARED IN THE OFFICES OF  
**TRI ENGINEERING SERVICE**

*Paul E. Roemer*  
 Reg. C.E. No. 2874

FOR LEGEND SEE PLAN NO. S-6-64

**NOTE:**  
 Grades to which the improvement is to be constructed are shown on plans and profiles. Grade points for top of curbs, center line of streets, or center line of alleys are shown by circles on profiles. At all points between designated points the grade shall be established so as to conform to a straight line between said designated points.

Elevations are in feet above U.S.G.S. datum or mean sea level.

This drawing and the data hereon are hereby made a part of the specifications. Work shall be constructed according to specifications on file in the office of the County Engineer and shall be prosecuted only in the presence of the County Engineer.

Before work can be started, the contractor must obtain a permit to occupy in County streets from the L.A. County Road Dept. 108 W. and St. and make a deposit with the County Engineer, Room 200, 200 South Broadway, sufficient to cover the cost of construction inspection and record plans.

Approval of this plan by the County of Los Angeles does not constitute a representation as to the accuracy of the location of or the existence or non-existence of any underground utility, pipe, or structure within the limits of this project. The note applies to all sheets.

If work is to be done on State Highway, a permit must be obtained from the State of California, Division of Highways, 120 South Spring Street.

**COUNTY OF LOS ANGELES, CALIFORNIA**

Approved, William J. Fox, County Engineer  
 Approved, A. M. Roem  
 Chief Eng. Co. SAN DIST NO. 12  
*A. P. Collins*  
 Chief Engineer  
 Dated 7-27-55  
 Office of County Engineer, Reg. C.E. No. 7860

P.C. 3563  
 Page 1

21,409

ALBERTIS AVE