

Pl. 3585

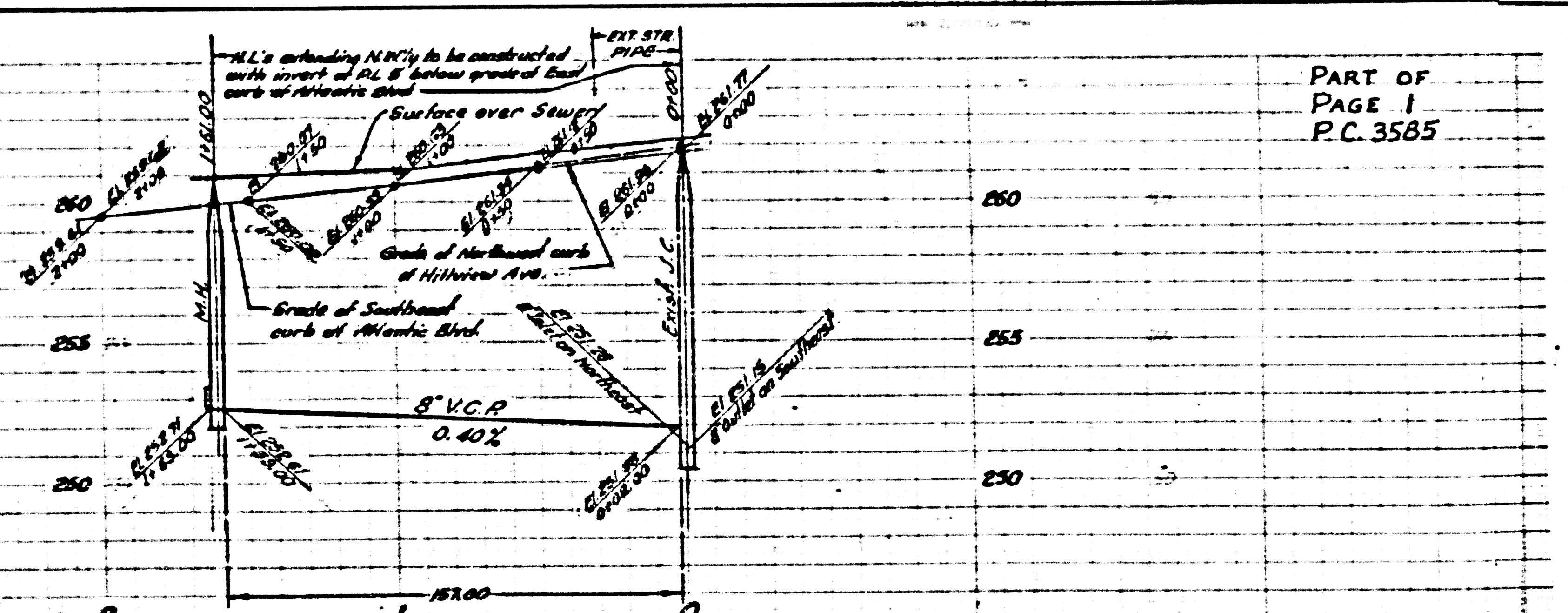

PART OF  
PAGE 1  
P.C. 3585

### EAST LOS ANGELES BLDG. DIST. No 6

- NOTE:**
- Provide stakes on the property lines or property lines produced at right angles to the sewer line at the center line of each manhole.
- No representative of the County Engineer will survey or layout any portion of the work.
- The owner or his authorized representative shall furnish the County Engineer with grade sheets and stations for all house laterals and Y branches and shall provide stakes for them at their proper locations with stationing plainly marked. Any change in location shall be requested in writing by the owner or his representative.
- No revisions shall be made in these plans without the approval of the County Engineer.
1. Use standard manhole frames and covers, S-a-117.
  2. Use standard strength pipe except as noted.
  3. Use cement mortar for all vitrified clay pipe joints.
  4. Resurface all trench within paved area to meet L.A. County Road Dept. or California State Highway Dept. requirements in accordance with permit.
  5. Excuse four feet of sewer at points of interference with poles, S-a-119.
- Manhole to be constructed with curb at property line.
7. All structures shall be brick cover structures, S-a-104.
  8. For allowable leakage test, use Formula No. 1, Sp. 1, Sec. 91.
  9. Manhole tops in unimproved Rights-Of-Way to be 6" above finish grade.

B.M. 511 Elev. 263.451 F.B. 789-R10  
Brooklyn Ave. & Hillview Ave. S.E.  
cor. 61 5/8" in curb 6' E. of  
Curb Return.

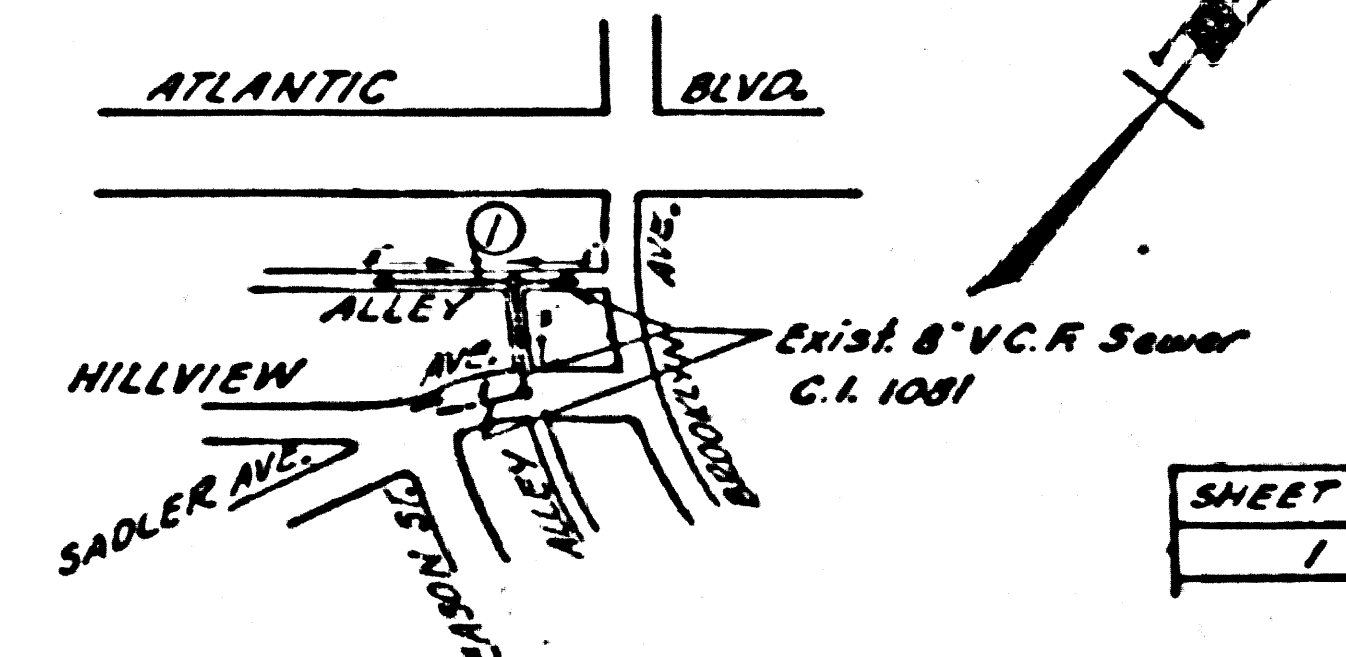

SHEET NO.	PAGES
1	1

CONNECTION CHARGES  
AS INDICATED

INDEX MAP  
P.C. 3585  
SCALE: 1" = 200'  
Dated 8-22-55

PROFILE, ALIGNMENT AND GRADE OF  
SANITARY SEWERS  
TO BE CONSTRUCTED IN  
**FIRST ALLEY WEST OF  
HILLVIEW AVE.**  
Southerly of Brooklyn Ave.  
PRIVATE CONTRACT NO. 3585  
W. S. 36  
1 SHEET

Scale: VERT. 1" = 4' HORIZ. 1" = 40' JULY 1955  
PREPARED IN THE OFFICES OF  
**KEMMERER ENGR. CO., INC.**  
By Wm. C. Johnson C.E. No. 8244

FOR LEGEND SEE PLAN NO. S-a-64

**NOTE:**

Grades to which this improvement is to be constructed are shown on plans and profiles. Grade points for top of curb, center line of streets, or center line of alleys are shown by circles on profiles. At all points between designated points the grade shall be established so as to conform to a straight line drawn between said designated points.

Spot elevations are in feet above U.S.C.T.S. datum or mean sea level.

This drawing and the data herein are hereby made a part of the specifications.

Work shall be constructed according to specifications on file in the office of the County Engineer and shall be prosecuted only in the presence of the County Engineer.

Before work can be started, the contractor must obtain a permit to excavate in County streets from the L.A. County Road Dept., 100 W. 2nd St. and make a deposit with the County Engineer, 24, 24 1/2 S. Broadway sufficient to cover the cost of construction inspection and record plans.

Approval of this plan by the County of Los Angeles does not constitute a representation as to the accuracy of the location of or the existence or non-existence of any under- and utility, pipe, or structure within the limits of this project. This note applies to all sheets.

If work is to be done in a State Highway, a permit must be obtained from the State of California, Division of Highways, 120 South Spring Street.

**COUNTY OF LOS ANGELES, CALIFORNIA**

Approved, William J. Fox, County Engineer  
Approved, A. M. Ream, Chief Eng. Co. DIST. NO. 2  
By A.P. Collins Sanitation Engineer  
By W. Mathews Office Engineer  
Checked by Richard Thayer  
Office of County Engineer, Dep. C. E. No. 78645

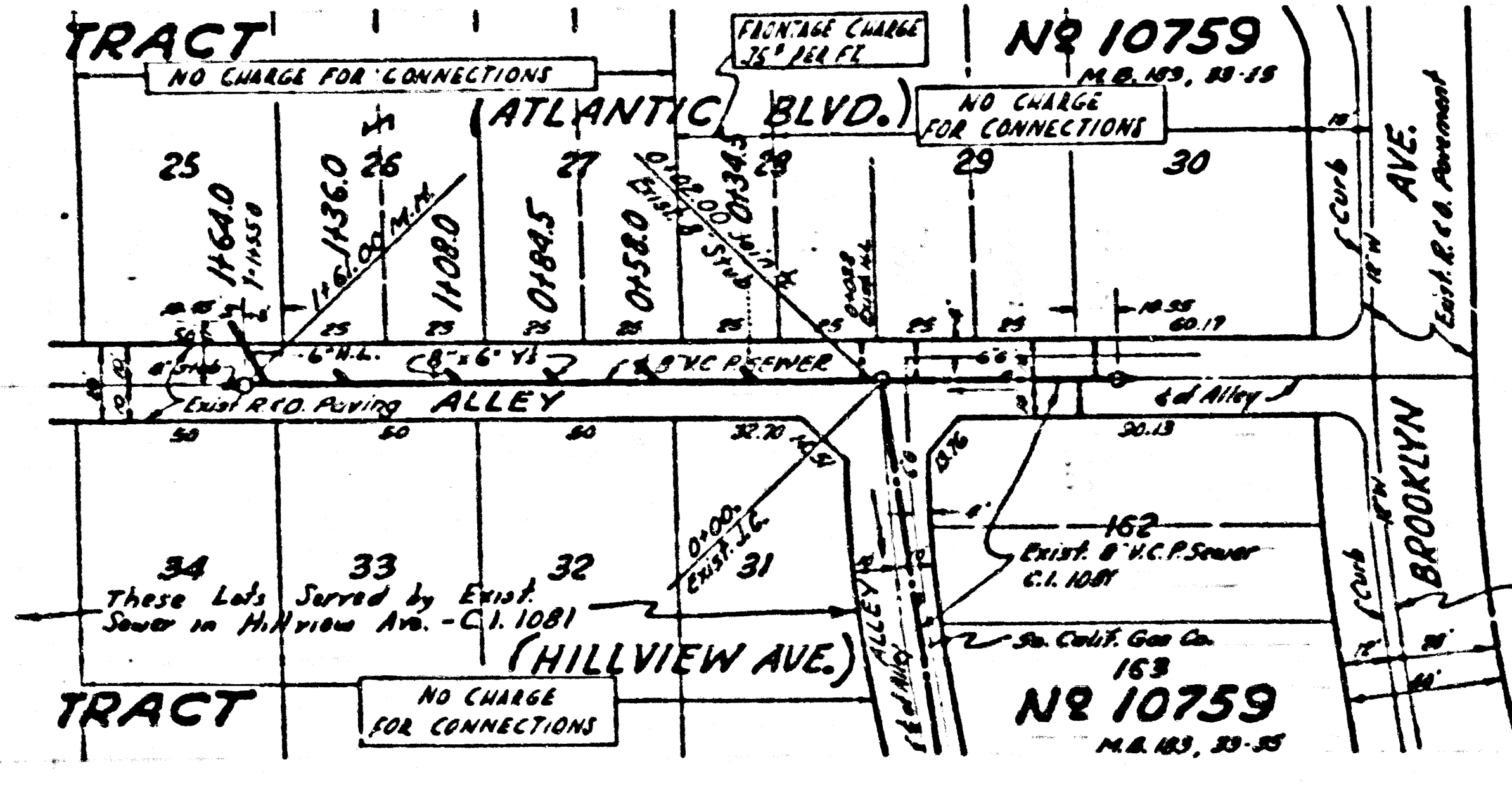

TRACT No 10759  
M.R. 107, 23-15

TRACT No 10759  
M.R. 107, 23-15

PAGE 1  
P.C. 3585

21,152

ALLEY  
BETWEEN ATLANTIC BLVD. & HILLVIEW AVE.  
SOUTHWEST OF BROOKLYN ST.

P.C. 3585  
B.C. 3282  
23-23-55