

B.M. SY 3052 El. 46.687
 L & B. nail S.W. cor culvert headwall
 1.30' E of 1st Normandie Ave 121.30' S of 1st EPP 0.51'

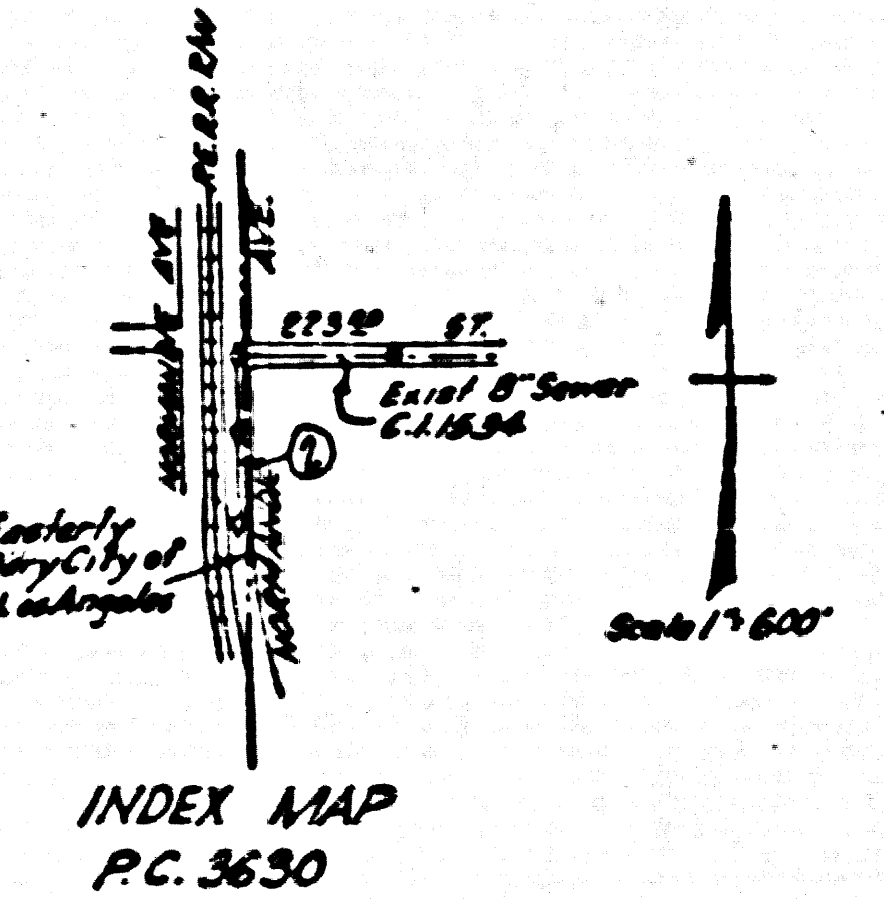

Checked 5-10-56 Milgren

LOMITA BLDG. DIST. N^o 7L

NOTE:

- Provide stakes on the property lines or property lines produced at right angles to the sewer line at the center line of each manhole.
- No representative of the County Engineer will survey or layout any portion of the work.
- The owner or his authorized representative shall furnish the County Engineer with grade sheets and stations for all house laterals and Y branches and shall provide stakes for them at their proper locations with stationing plainly marked. Any change in location shall be requested in writing by the owner or his representative.
- No revisions shall be made in these plans without the approval of the County Engineer.
1. Use standard masonry frames and covers, S-o-117.
 2. Use standard strength pipe except as noted.
 3. Use cement mortar for all vitrified clay pipe joints.
 4. Resurface all trench within paved area to meet L.A. County Road Dist. or California State Highway Dist. requirements in accordance with permit.
 5. Excise four feet of sewer at points of interference with poles, S-o-119.
 6. House laterals to be constructed with inverts at property line $\frac{1}{2}$ foot below curb grade except as noted.
 7. All structures shall be brick sewer structures, S-o-104.
 8. For alternate leakage test, use Formula No. 1, Spec's, Sec. 51.
- Contractor shall obtain necessary permit for excavation in City Streets at Room 605, San Raulo City Hall

SHEET	PAGES
1	1-2

NO CHARGE FOR CONNECTIONS
 as per Ord. 7-26-58

SUBMITTED January 15 1955
 BY REC'D by [Signature]
[Signature]
 ASST. ENGINEER OF DESIGN

APPROVED Feb. 11 1955
[Signature]
 CITY ENGINEER

PROFILE, ALIGNMENT AND GRADE OF
 SANITARY SEWERS
 TO BE CONSTRUCTED IN
 NORMANDIE AVE.
 FROM 223rd TO 455th SOUTHERLY THEREOF

P.C. 3630
 Page 1

22,611

(2)

PRIVATE CONTRACT NO. 3630
 W. S. 28
 ONE SHEET
 Scale: VERT. 1" = 4' HORIZ. 1" = 40'
 AUGUST 1955
 PREPARED IN THE OFFICE OF
 OLSON SURVEYING SERVICE

[Signature]
 No. C.E. No. 1120
 FOR LEGEND SEE PLAN NO. S-o-64

NOTE:

Grades to which this improvement is to be constructed are shown on plans and profiles. Grade points for top of curbs, center line of streets, or center line of alleys are shown by circles on profiles. At 2' points between designated points the grade shall be established so as to conform to a straight line drawn between said designated points.

Elevations are in feet above U.S.G.S. datum or mean sea level.

This drawing and the data hereon are hereby made a part of the specifications.

Work shall be constructed according to specifications on file in the office of the County Engineer and shall be prosecuted only in the presence of the County Engineer.

Before work can be started the contractor must obtain a permit to excavate in County Streets from the L.A. County Road Dist., 2270 1st St. and make agreement with the County Engineer, Box 245, 151 1/2 Broadway, sufficient to cover the cost of construction inspection and rework.

Approval of this plan by the County of Los Angeles does not constitute a representation as to the accuracy of the location of or the existence or non-existence of any underground utility, pipe, or structure within the limits of this project. This note applies to all sheets.

If work is to be done in a State Highway, a permit must be obtained from the State of California, Division of Highways, 120 South Spring Street.

COUNTY OF LOS ANGELES, CALIFORNIA

Approved, William J. Fox, County Engineer
[Signature]
 City Engineer

Approved, A. M. Rawl
[Signature]
 City Engineer

Checked by: [Signature] 9-16-55
 Office of County Engineer, Box, C. E. No. 3406

NORMANDIE AVE.

P.C. 3630
 10535.00

RE.

PC 3630

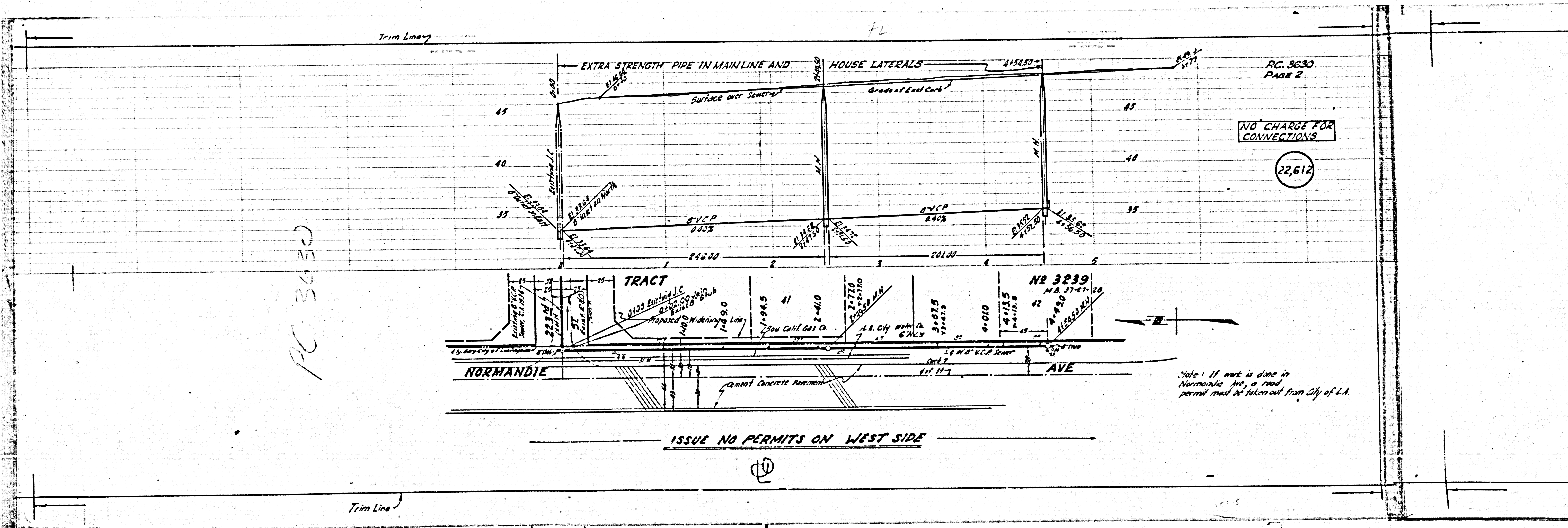

PC. 3630
PAGE 2

NO CHARGE FOR
CONNECTIONS

22,612

Note: If work is done in
Normandie Ave, a road
permit must be taken out from City of L.A.

ISSUE NO PERMITS ON WEST SIDE