

PAGE 2  
P.C. 3715

22,253

Trim Line 1

### WHITTIER BLDG. DIST. NO 11

#### NOTE:

- Provide stakes on the property lines or property lines produced at right angles to the sewer line at the center line of each manhole.
- No representative of the County Engineer will survey or layout any portion of the work.
- The owner or his authorized representative shall furnish the County Engineer with grade sheets and stations for all house laterals and Y branches and shall provide stakes for them at their proper locations with stationing plainly marked. Any change in location shall be requested in writing by the owner or his representative.
- No revisions shall be made in these plans without the approval of the County Engineer.
1. Use standard manhole frames and covers, S-a-117.
  2. Use standard strength pipe.
  3. Use cement mortar for all vitrified clay pipe joints.
  4. Reconstruct all trench within paved area to meet L. A. County Road Dept. or California State Highway Dept. requirements in accordance with permit.
  5. Encase four feet of cover at points of interference with poles, S-a-119.
  6. House laterals to be constructed with W rags per foot to the easement line.
  7. All structures shall be brick sewer structures, S-a-104.
  8. For allowable leakage test, see Formula No. 1, Spec's, Sec. 51.
  9. Manhole tops in unimproved Right-Of-Way to be 6" above finish grade.

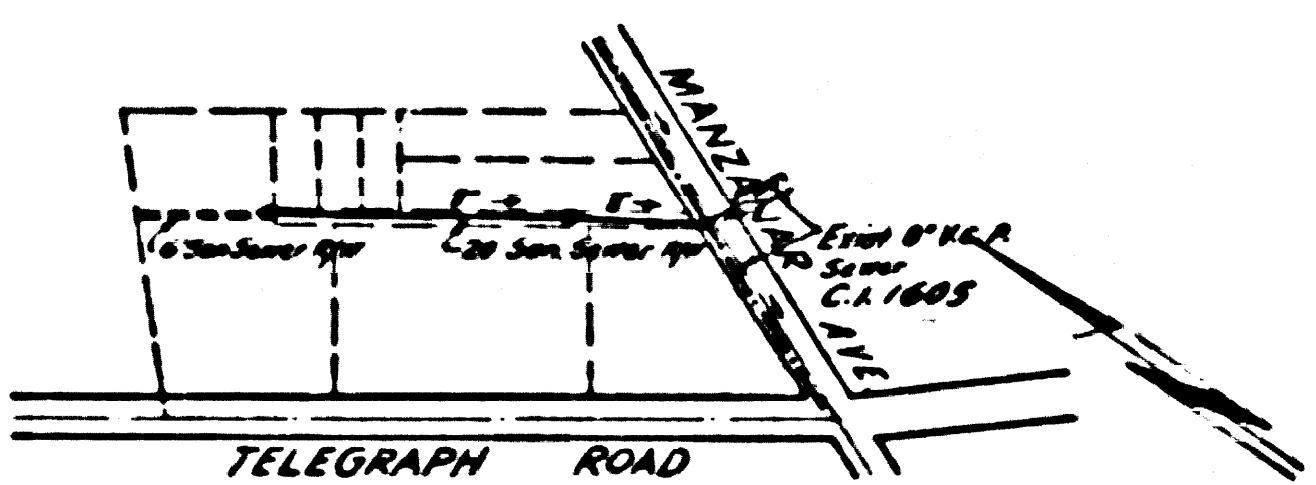
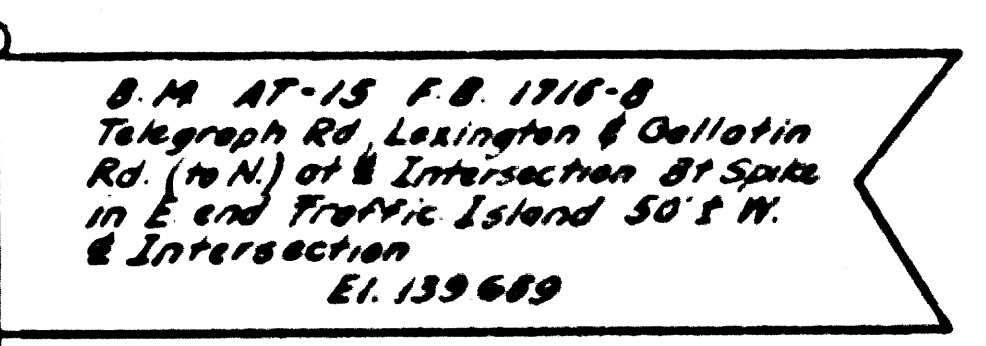

INDEX MAP  
Scale 1"=300'  
P.C. 3715

SHEET NO.	PAGES
1	1-2

NO CHARGE FOR CONNECTIONS  
L. Curtis 12-9-55

REVISION:  
Relocate M.H.'s & reroute alignment of 8" c.c.p. sewer. Offer outlet on upper Manhole.  
Approved: *[Signature]* 1-12-56 By C.E. No. 3406  
Chief of County Engineer

Checked 3-5-56 *[Signature]*  
Trim Line 2

PAGE 1  
P.C. 3715

22,252

#### PROFILE, ALIGNMENT AND GRADE OF SANITARY SEWERS TO BE CONSTRUCTED IN

### SANITARY SEWER R/W WEST OF MANZANAR AVENUE 1801 FEET NORTHERLY FROM TELEGRAPH ROAD

PRIVATE CONTRACT NO. 3715  
W. S. 38  
1 SHEET

Scale: VERT. 1"=4'  
HORIZ. 1"=40'

SEPT. 1955  
PREPARED IN THE OFFICES OF

KEMMERER ENGINEERING CO. INC.

By *[Signature]* Reg. C.E. No. 8244

FOR LEGEND SEE PLAN NO. S-a-64

#### NOTE:

Grades to which this improvement is to be constructed are shown on plans and profiles. Grade points for top of curb, center line of streets, or center line of alleys are shown by circles on profiles. At all points between designated points the grade shall be established so as to conform to a straight line drawn between said designated points.

Elevations are in feet above U.S.C. & G.S. one level datum of 1929.

This drawing and the data hereon are hereby made a part of the specification.

Work shall be constructed according to specifications on file in the office of the County Engineer and shall be prosecuted only in the presence of the County Engineer.

Before work can be started, the contractor must obtain a permit to occupy in County streets from the L.A. County Road Dept., 108 W. 2nd St., and make a deposit with the County Engineer, Room 824, 235 South Broadway, sufficient to cover the cost of construction inspection and record plans.

Approval of this plan by the County of Los Angeles does not constitute a representation as to the accuracy of the location of or the existence or non-existence of any underground utility, pipe, or structure within the limits of this project. This note applies to all sheets.

If work is to be done in a State Highway, a permit must be obtained from the State of California, Division of Highways, 120 South Spring Street.

#### COUNTY OF LOS ANGELES, CALIFORNIA

Approved, John A. Lambos County Engineer  
Approved, A. M. Ryan  
Chief of County Engineer  
By *[Signature]* 1-12-56  
Office of County Engineer, Reg. C.E. No. 3406

SANITARY SEWER R/W.  
P.C. 3715

P.C. 3715

Trim Line 2

Trim Line 1

PAGE 2  
PG. 3715

NO CHARGE FOR  
CONNECTIONS

22,253

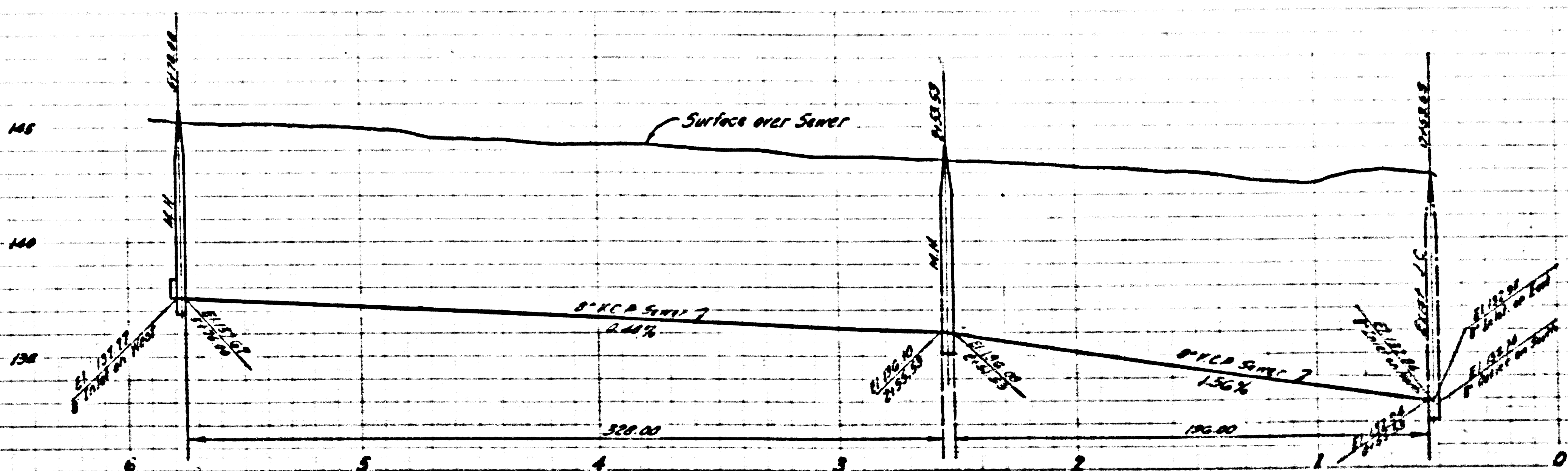

PORTION OF RANCHO SANTA GERTRUDES FINALLY CONFIRMED TO J.P. McFARLAND & J.G. DOWNEY P. 156-158

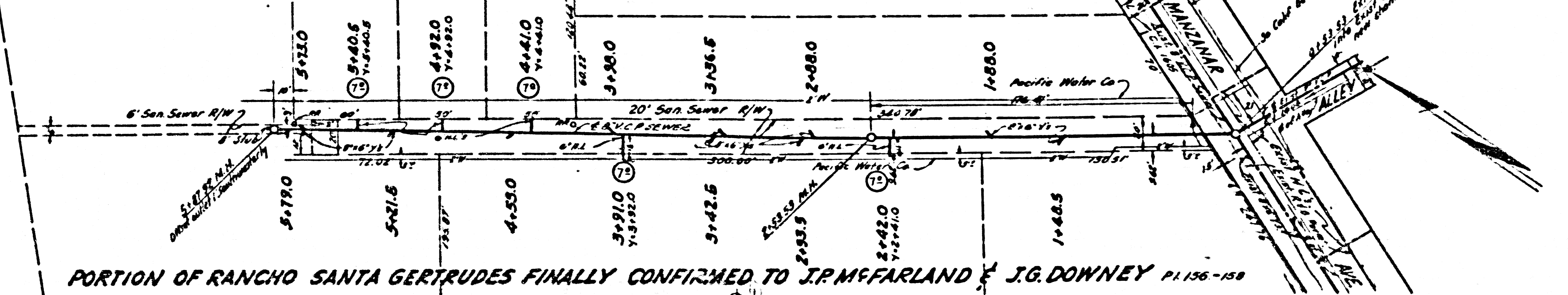

PORTION OF RANCHO SANTA GERTRUDES FINALLY CONFIRMED TO J.P. McFARLAND & J.G. DOWNEY P. 156-158

Trim Line 2

Trim Line 1

REVISED