

WHITTIER BLDG. DIST. NO. 11

- NOTE:**
- Provide stakes on the property lines or property lines produced at right angles to the sewer line at the corner line of each manhole.
 - No representative of the County Engineer will survey or layout any portion of the work.
 - The owner or his authorized representative shall furnish the County Engineer with grade sheets and stations for all house laterals and Y branches and shall provide stakes for them at their proper locations with stationing plainly marked. Any change in location shall be requested in writing by the owner or his representative.
 - No revisions shall be made in these plans without the approval of the County Engineer.
 - Use standard manhole frames and covers, S-a-117.
 - Use standard strength pipe except as noted.
 - Use cement mortar for all vitrified clay pipe joints.
 - Resurface all trench within paved area to meet L.A. County Road Dept. or California State Highway Dept. requirements in accordance with permit.
 - Excise four feet of sewer at points of interference with poles, S-a-119.
 - House laterals to be constructed with 4" rise per foot to R/W Line except as noted.
 - All structures shall be brick sewer structures, S-a-104.
 - For airtightness leakage test, use Formula No. 1, Spec's., Sec. 51.
 - Manhole tops in unimproved Right-of-Way to be 6" above finish grade.

B.M. #7 M.J. 7622 E.I.M. 116
 Spl. in conc. wall 1" deep
 50' R.T. & P.E. 98129 97

ISSUE NO PERMITS
 UNTIL RIGHT OF WAY
 IS COMPLETELY DEDICATED
 CALL MAIN OFFICE

NO CHARGE FOR
 CONNECTIONS
 10-20-55

SHEET	PAGE
1	1

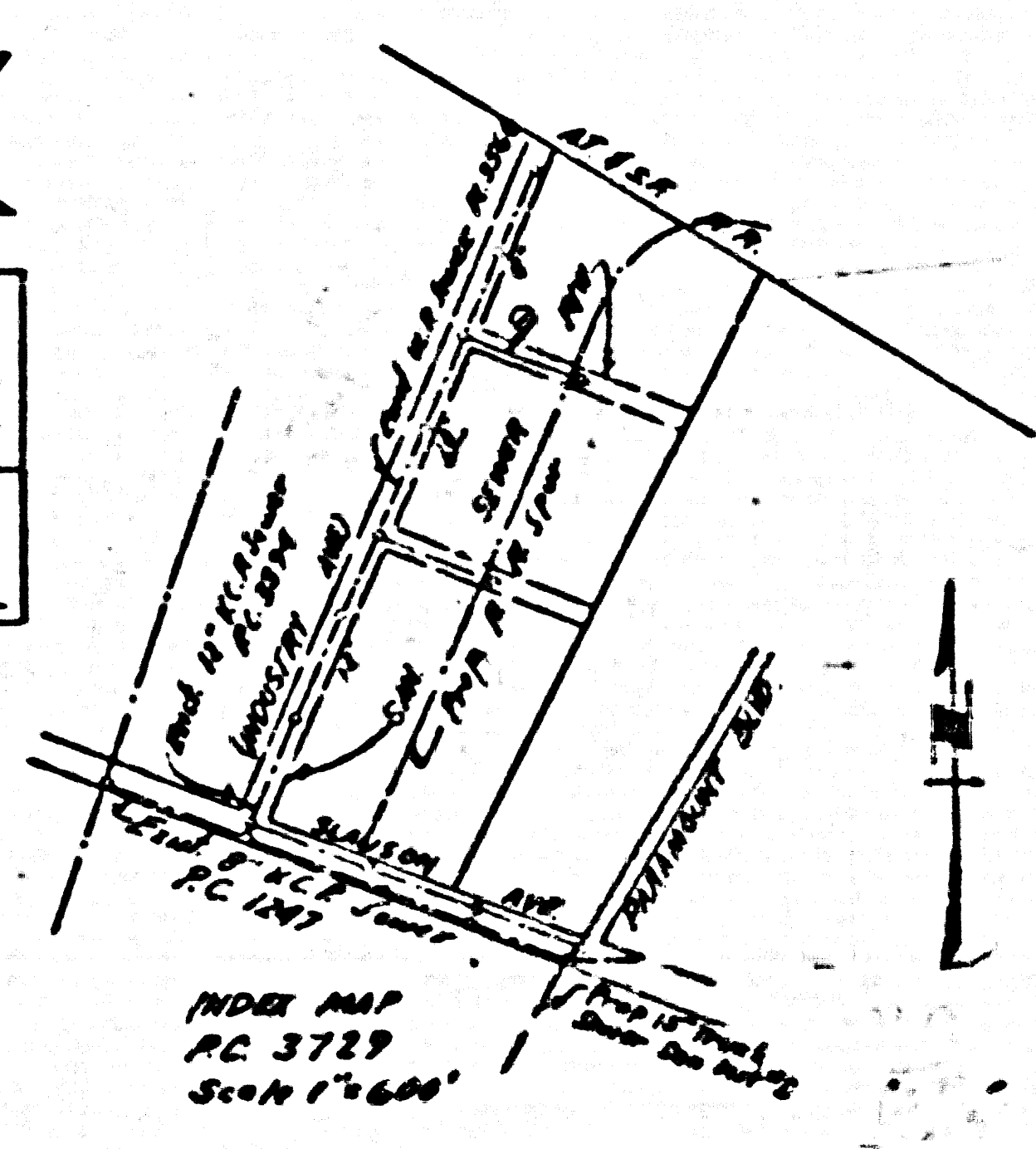

**PC. 3729
 Page 1**

**PROFILE, ALIGNMENT AND GRADE OF
 SANITARY SEWERS
 TO BE CONSTRUCTED IN
 SANITARY SEWER R/W
 EAST OF INDUSTRY AVE.**

**PRIVATE CONTRACT NO. 3729
 W. S. 36
 ONE SHEET**

Scale: VERT. 1" = 4'
 HORIZ. 1" = 40' Oct. 1955

DESIGNED BY THE OFFICES OF
RALPH W. BOGGS

BY **J.P. Edwards** Eng. C.E. No. 4729
 FOR LEGEND SEE PLAN NO. S-a-64

NOTE:

Grades to which this improvement is to be constructed are shown on plans and profiles. Grade points for top of curb, center line of streets, or center line of alleys are shown by circles on profiles. At all points between designated points the grade shall be established so as to conform to a straight line drawn between said designated points.

Elevations are in feet above U.S.G.S. datum or mean sea level.

This drawing and the data hereon are hereby made a part of the specifications.

Work shall be constructed according to specifications on file in the office of the County Engineer and shall be prosecuted only in the presence of the County Engineer.

Before work can be started, the contractor must obtain a permit to excavate in County streets from the L.A. County Road Dept., 108 W. 2nd St. and make a deposit with the County Engineer, 215 S.W. 253 St. Broadway, sufficient to cover the cost of construction inspection and record plans.

Approval of this plan by the County of Los Angeles does not constitute a representation as to the accuracy of the location of or the existence or non-existence of any underground utility, pipe, or structure within the limits of this project. This note applies to all sheets.

If work is to be done on a State Highway, a permit must be obtained from the State of California, Division of Highways, 120 South Spring Street.

COUNTY OF LOS ANGELES, CALIFORNIA

Approved, John A. Lambie County Engineer Approved, A. M. Rawn
 DIST. MAP
 PC. 3729
 SHEET 1 OF 1

R/W East of Industry Ave.
 PC. 3729