

SAN DIMAS BLDG. DIST. NO. 10

PROFILE ALIGNMENT AND GRADE OF P.C. 3806
SANITARY SEWERS PAGE 1
 TO BE CONSTRUCTED IN
R/W SOUTH OF SAN BERNARDINO RD.

PRIVATE CONTRACT NO. 3806

W.S. 47
2 SHEETS, 3 PAGES

SCALE: 1" = 4' January, 1956

PREPARED IN THE OFFICES OF
HAROLD L. JOHNSON

REG. C. E. NO. 7668 (3)

FOR LEGEND SEE PLAN NO. S-A-64

NOTE:
 GRADES TO WHICH THIS IMPROVEMENT IS TO BE CONSTRUCTED ARE SHOWN ON PLANS AND PROFILES. GRADE POINTS FOR
 TOP OF CURB, CENTER LINE OF STREET, OR CENTER LINE OF ALLEY ARE SHOWN BY CIRCLES ON PROFILES AT ALL POINTS BETWEEN
 BENCHMARK POINTS THE GRADE SHALL BE ESTABLISHED AS TO CORRESPOND TO A STRAIGHT LINE DRAWN BETWEEN SAID BENCH-
 MARKED POINTS.
 ELEVATIONS ARE IN FEET ABOVE U.S.C. & G.S. MEAN SEA LEVEL, DATUM OF 1929.
 THIS DRAWING AND THE DATA HEREON ARE HEREBY MADE A PART OF THE SPECIFICATIONS.
 WORK SHALL BE CONSTRUCTED ACCORDING TO SPECIFICATIONS ON FILE IN THE OFFICE OF THE COUNTY ENGINEER AND SHALL
 BE PROSECUTED ONLY IN THE PRESENCE OF THE COUNTY ENGINEER.
 WORK WHICH CAN BE STARTED THE CONTRACTOR MUST OBTAIN A PERMIT TO EXCAVATE IN COUNTY STREETS FROM THE
 L. A. COUNTY ROAD DEPT. THE WORK SHALL BE DONE IN ACCORDANCE WITH THE COUNTY ENGINEER, FORM 224 PLAN AMERICAN BLDG.
 THE 224 IS SO INCORPORATED TO CD IN THE COST OF CONSTRUCTION INSPECTION AND RECORD PLANS.
 APPROVAL OF THIS PLAN BY THE COUNTY OF LOS ANGELES DOES NOT CONSTITUTE A REPRESENTATION AS TO THE ACCURACY
 OF THE LOCATION OR OF THE EXISTENCE OR NON-EXISTENCE OF ANY UNDERGROUND UTILITY PIPE, OR STRUCTURE WITHIN THE
 LIMITS OF THIS PROJECT. THIS NOTE APPLIES TO ALL PAGES.
 IF WORK IS TO BE DONE IN A STATE HIGHWAY, A PERMIT MUST BE OBTAINED FROM THE STATE OF CALIFORNIA, DIVISION OF
 HIGHWAYS, 120 SOUTH BRIDGE STREET.

COUNTY OF LOS ANGELES, CALIFORNIA

APPROVED, JOHN A. LAMME, COUNTY ENGINEER
 APPROVED, A. M. RAWLIN, CHIEF ENGINEER
 COL SAN DIST. NO. 22
 BY A. P. Collins BY G. P. Johnson
 SANITATION ENGINEER OFFICE ENGINEER
 CHECKED BY PE Johnson 2-15-56
 OFFICE OF COUNTY ENGINEER, REG. C. E. NO. 7660

B.M. 56.71 El. 491.887
 1/4 CORNER W of Curve Return of NW
 Cor. of Alamo Ave & San Bernardino Rd.

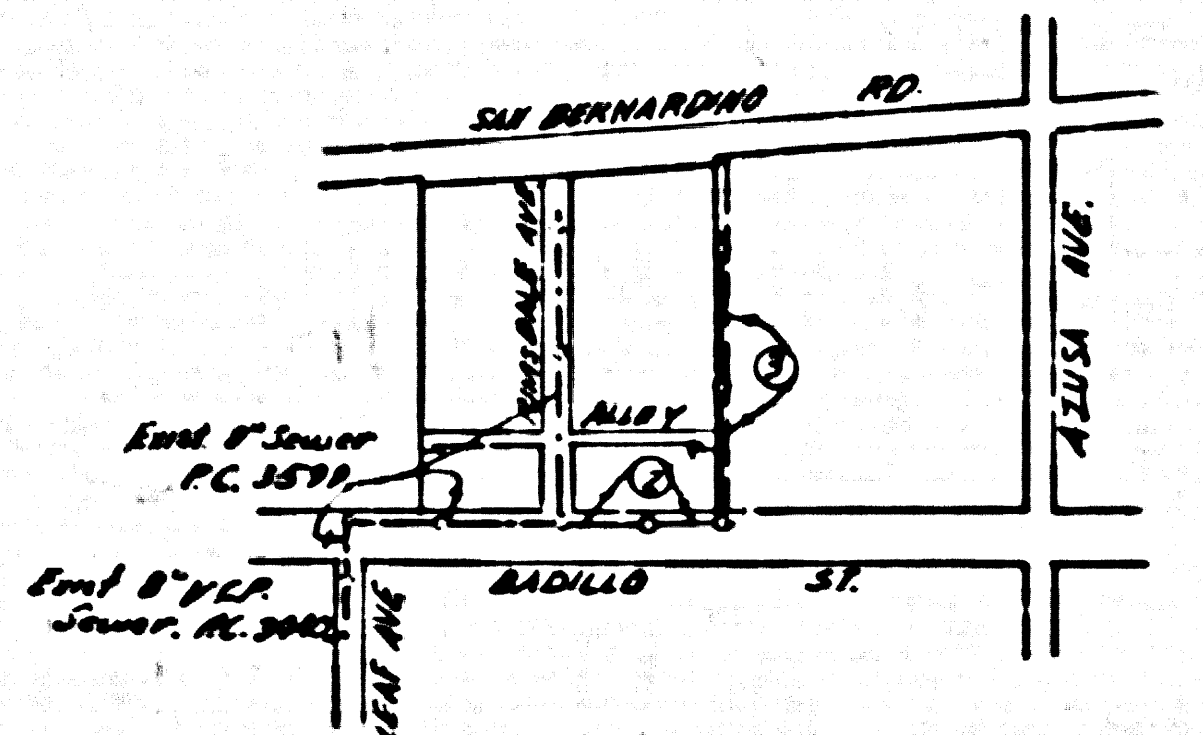

INDEX MAP
 Scale 1" = 600'
 P.C. 3806

COLLECT CHARGES
 AS INDICATED
 2-16-56

P.C. 3806 PAGE 2

COLLECT CHARGES
 AS INDICATED

22,333

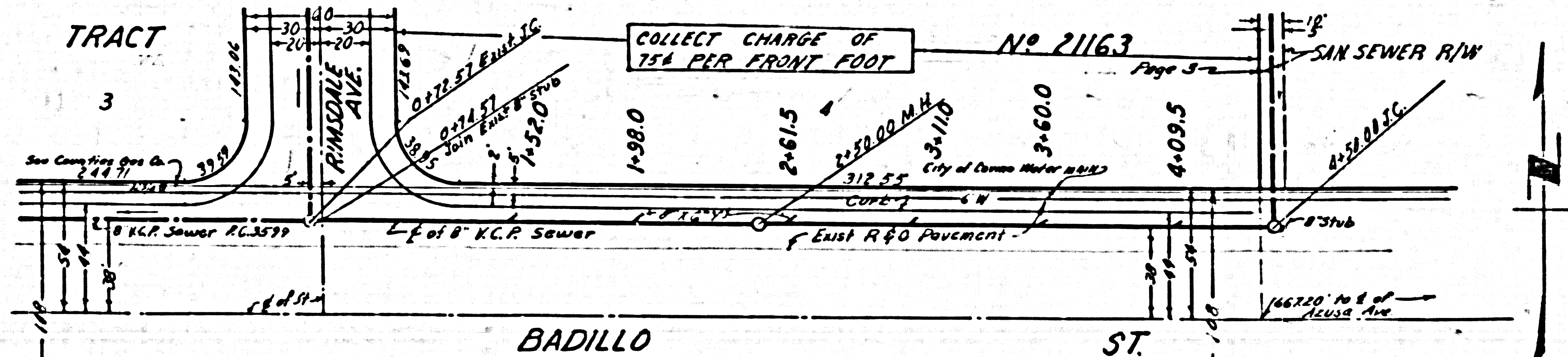
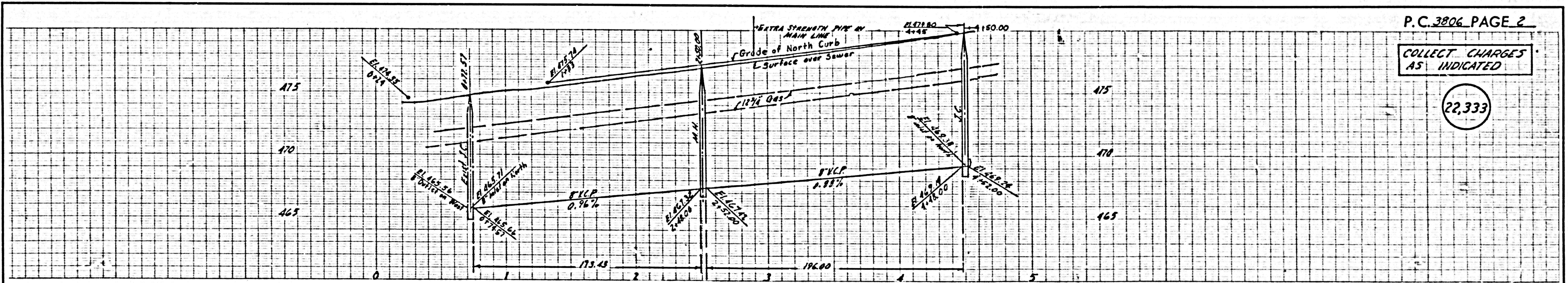

Checked 3-28-56 W. L. Lamm

P.C. 3806

R/W SOUTH OF SAN BERNARDINO RD

P.C. 3806