

*Trim Line*

### WHITTIER BLDG. DIST. NO 11

**NOTE:**  
 Provide stakes on the property lines or property lines produced at right angles to the sewer line at the center line of each manhole.  
 No representative of the County Engineer will survey or layout any portion of the work.  
 The owner or his authorized representative shall furnish the County Engineer with grade sheets and stations for all house laterals and Y branches and shall provide stakes for them at their proper locations with stationing plainly marked. Any change in location shall be requested in writing by the owner or his representative.  
 No revisions shall be made in these plans without the approval of the County Engineer.

1. Use standard manhole frames and covers, S-a-117
2. Use standard strength pipe except as noted.
3. Use cement mortar for all vitrified clay pipe joints.
4. Resurface all trench within paved area to meet L.A. County Road Dept. or California State Highway Dept. requirements in accordance with permit.
5. Encase four feet of sewer at points of interference with poles, S-a-119
6. Manholes to be constructed in accordance with property lines.
7. All structures shall be brick sewer structures, S-a-104.
8. For allowable leakage test, use Formula No. 1, Spec's., Sec. 51
9. Manhole tops in unimproved Rights-of-Way to be level with finish grade.

*PC 3856 Part of Page 1*

*El. 194.71 3+52.00*  
*El. 196.54 3+75.00*  
*El. 185.92 0+02.00*  
*346.00*  
*El. 185.92 0+02.00*

*PC 3856*

*NO CHARGE FOR CONNECTIONS*

*NO 2281*  
 M.B. 24-2  
 Sta 2+68.92 (PC 3560)  
 = 0+00 J.C.  
 Construct J.C. around  
 exist 8" V.C.P. Sewer.  
 Break out pipe for conc.  
 Soil Counties Gas Co.

*NO 2281*  
 M.B. 24-2  
 Exist. M.H. - Sta 3+50.00  
 (per PC 3360)

*PC 3560*

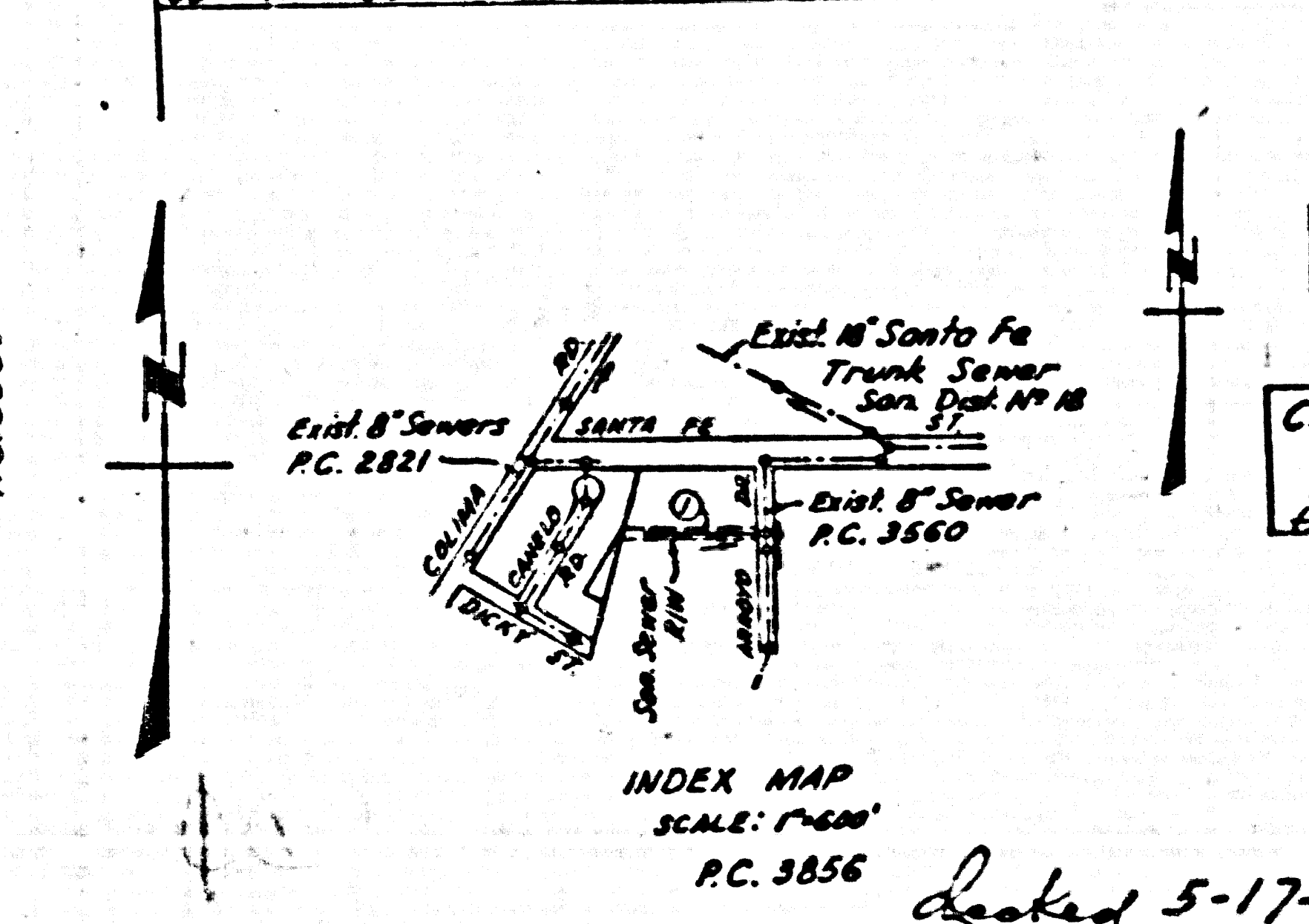

*Trim Line*

*PC 3856 PAGE 1*

**PROFILE ALIGNMENT AND GRADE OF  
 SANITARY SEWERS  
 TO BE CONSTRUCTED IN  
 FRANCIS STUART  
 SANITARY SEWER  
 RIGHT OF WAY**

**PRIVATE CONTRACT NO. 3856  
 W. S. 34  
 ONE SHEET  
 JANUARY 1956**

Scale:  $\frac{1}{4}$ " = 1'-0"  
 PREPARED UNDER THE SUPERVISION OF

*George D. Hughes*  
 CIVIL ENGINEER  
 No. C.E. No. 2642

FOR LEGEND SEE PLAN NO. S-a-64

**NOTE:**  
 Grades to which this improvement is to be constructed are shown in plan and profile. Grade shown at top of curb, center line of street, or center line of alley are shown by circles on profile. At all points between designated points the grade shall be established so as to conform to a straight line drawn between said designated points.  
 Elevations are in feet above U.S.C. & G.S. sea level datum of 1929.  
 This drawing and the data hereon are hereby made a part of the specifications.  
 Work shall be constructed according to specifications on file in the office of the County Engineer and shall be prosecuted only in the presence of the County Engineer.  
 Before work can be started, the contractor must obtain a permit to excavate in County streets from the L.A. County Road Dept., 108 W. 2nd St. and make a deposit with the County Engineer, Room 324, 253 South Broadway, sufficient to cover the cost of construction inspection and record plans.  
 Approval of this plan by the County of Los Angeles does not constitute a representation as to the accuracy of the location of or the existence or non-existence of any underground utility, pipe, or structure within the limits of this project. This note applies to all sheets.  
 If work is to be done in a State Highway, a permit must be obtained from the State of California, Division of Highways, 170 South Spring Street.  
 COUNTY OF LOS ANGELES, CALIFORNIA  
 Approved, John A. Lambie, County Engineer  
 Approved, A. M. Rasmussen  
 CIVIL ENGINEER  
 CIVIL ENGINEER  
 No. C.E. No. 2642  
 No. C.E. No. 2642  
 Office of County Engineer, Box, P. O. No. 7860

**SHEETS PAGES**

1	1
---	---

**CONNECTION CHARGES AS INDICATED**

*PC 3856*

*PC 3856*

*FRANCIS STUART SANITARY SEWER R/W*

*PC 3856*