

PUENTE BLDG. DIST. NO. 2

PROFILE ALIGNMENT AND GRADE OF P.C. 3912
 SANITARY SEWERS PAGE 1
 TO BE CONSTRUCTED IN
 ORANGE AVENUE (25.181)

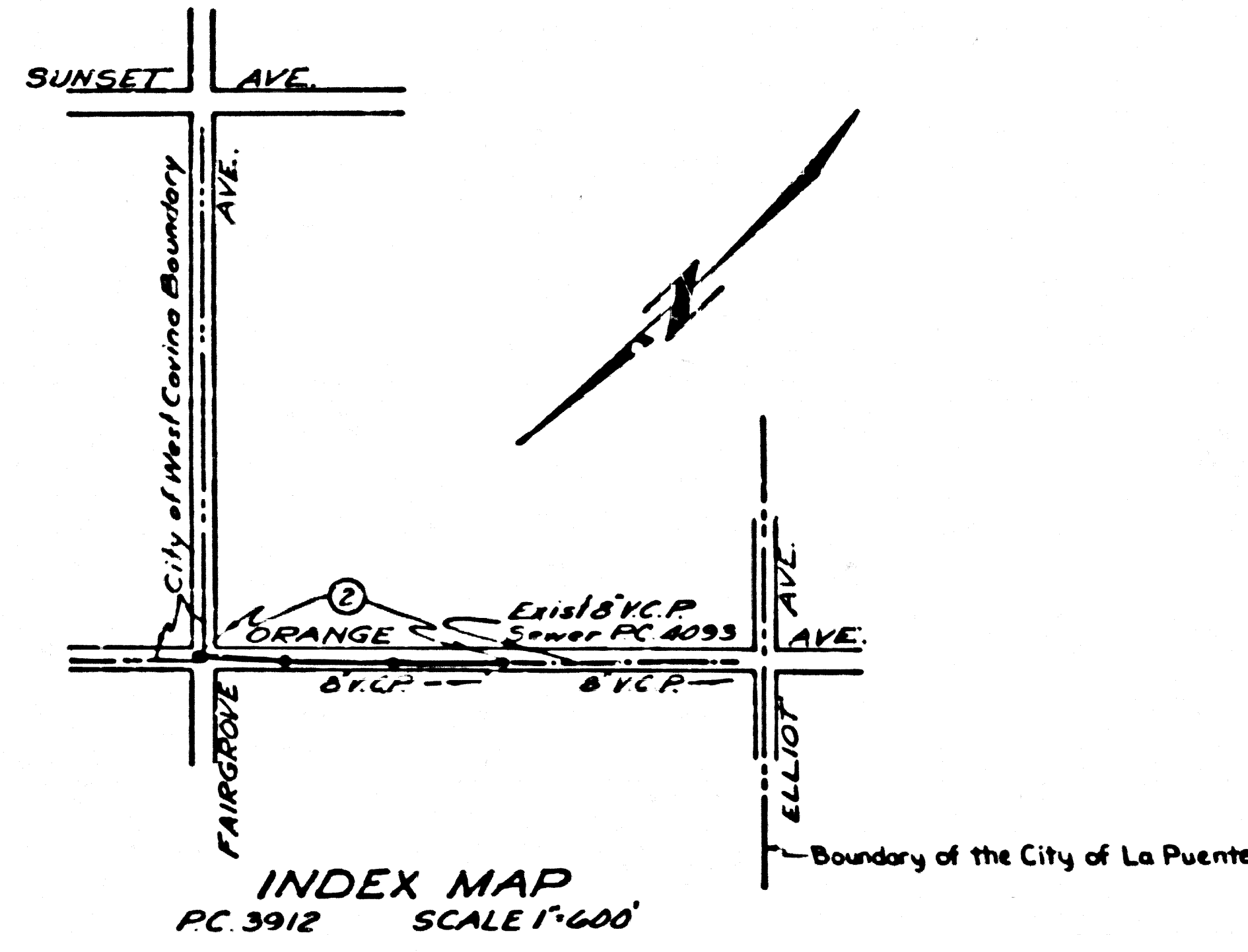

INDEX MAP
 P.C. 3912 SCALE 1"=600'

BENCH MARK N° 56 1118
 Los Angeles County Surveyors
 Monument Near Intersection of
 Elliot Avenue & Willow Avenue
 Elev. 316.855

INDEX TABLE	
SHEETS	PAGES
1	2

CONNECTION CHARGES
 AS INDICATED
 L. C. 11-26-56

- NOTES
- PROVIDE STAKES ON THE PROPERTY LINE OR PROPERTY LINES PRODUCED AT RIGHT ANGLES TO THE SEWER LINE AT THE CENTER LINE OF EACH MANHOLE.
 - NO REPRESENTATIVE OF THE COUNTY ENGINEER WILL SURVEY OR LAYOUT ANY PORTION OF THE WORK.
 - THE OWNER OR HIS AUTHORIZED REPRESENTATIVE SHALL FURNISH THE COUNTY ENGINEER WITH GRADE SHEETS AND STATIONING FOR ALL HOUSE LATERALS AND Y BRANCHES AND SHALL PROVIDE STAKES FOR THEM AT THEIR PROPER LOCATIONS WITH STATIONING AND PLANNING NUMBERS. ANY CHANGE IN LOCATION SHALL BE REQUESTED IN WRITING BY THE OWNER OR HIS REPRESENTATIVE.
 - NO REVISIONS SHALL BE MADE IN THESE PLANS WITHOUT THE APPROVAL OF THE COUNTY ENGINEER.
 - USE STANDARD MANHOLE FRAMES AND COVERS, S-A-117, EXCEPT AS NOTED.
 - USE C 7.75" A STRENGTH PIPE.
 - USE CEMENT MORTAR FOR ALL VITRIFIED CLAY PIPE JOINTS.
 - RESURFACE ALL TRENCH WITHIN PAVED AREA TO MEET L. A. COUNTY ROAD DEPT. OR CALIF. STATE HIGHWAY DEPT. REQUIREMENTS IN ACCORDANCE WITH PERMITS.
 - ENCASE FOUR FEET OF SEWER AT POINTS OF INTERFERENCE WITH POLES, S-A-116.
 - HOUSE LATERALS TO BE CONSTRUCTED WITH 18" DIA. 15' DEEP MANHOLES.
 - ALL STRUCTURES SHALL BE BRICK SEWER STRUCTURES, S-A-194, EXCEPT AS NOTED.
 - FOR ALLOWABLE LEAKAGE TEST USE FORMULA NO. 1 SPEC. SEC. 54.
 - MANHOLE TOPS IN UNIMPROVED RIGHTS OF WAY TO BE 6" ABOVE FINISHED GRADE.

PRIVATE CONTRACT NO. 3912
 W.S. 38
 1 SHEETS, 2 PAGES
 SCALE: 1"=100' HORIZ. 1"=10' VERT.
 OCTOBER, 1956
 PREPARED IN THE OFFICES OF
 ADAMS & ELLS ENGINEERS
 BY: [Signature] REG. C. E. NO. 617
 FOR LEGEND SEE PLAN NO. S-A-64

APPROVED, CITY OF WEST COVINA
 Nov 23, 1956
 BY: W.M. Keller
 SANITATION ENGINEER

APPROVED, JOHN A. LAMBE, COUNTY ENGINEER
 APPROVED, A. M. RAWN, CHIEF ENGINEER
 BY: [Signature] BY: [Signature]
 SANITATION ENGINEER OFFICE ENGINEER
 CHECKED BY: [Signature] 11-27-56
 OFFICE OF COUNTY ENGINEER, REG. C. E. NO. 7860

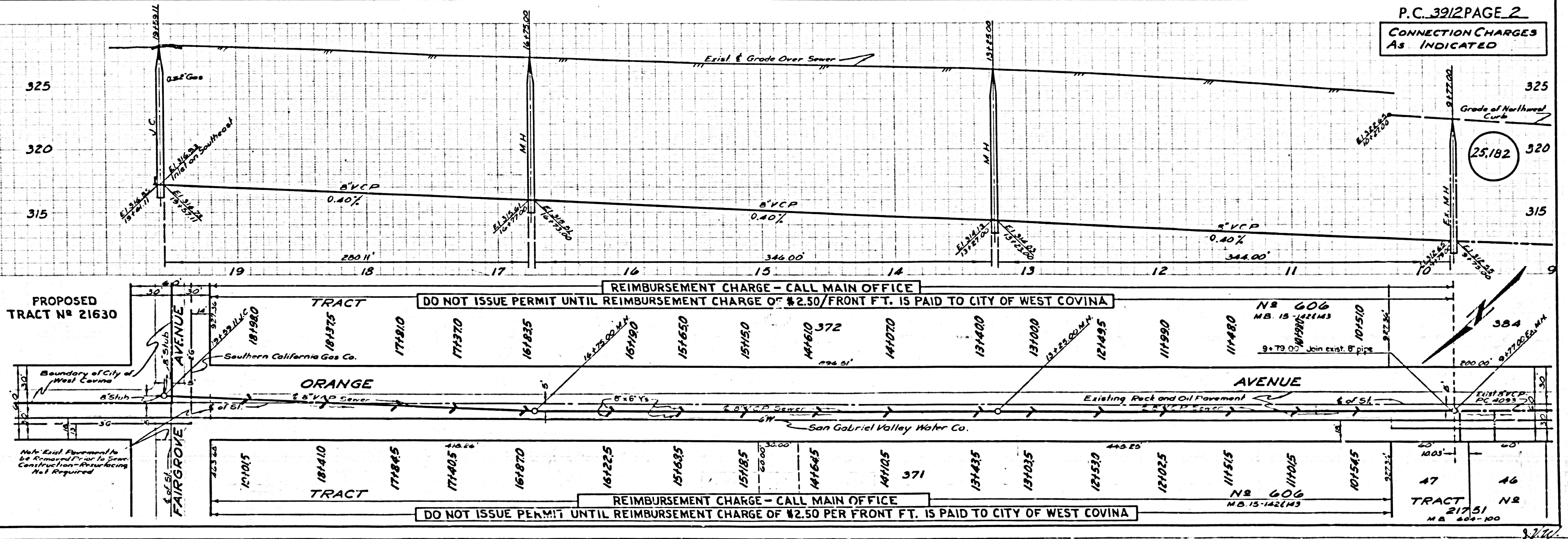

P.C. 3912 PAGE 2
 CONNECTION CHARGES
 AS INDICATED

(25.182)

PROPOSED TRACT N° 21630

REIMBURSEMENT CHARGE - CALL MAIN OFFICE
 DO NOT ISSUE PERMIT UNTIL REIMBURSEMENT CHARGE OF \$2.50/FRONT FT. IS PAID TO CITY OF WEST COVINA

NB 606
 NB. 15-142643
 9' 79.00' Join exist. 8" pipe

Note: Existing Pavement to be Removed Prior to Sewer Construction - Resurfacing Not Required

REIMBURSEMENT CHARGE - CALL MAIN OFFICE
 DO NOT ISSUE PERMIT UNTIL REIMBURSEMENT CHARGE OF \$2.50 PER FRONT FT. IS PAID TO CITY OF WEST COVINA

TRACT N° 21751
 NB. 606-100