

B.M. 5Y 3361 El. 879.10
 Set L & B. nail in N. Ch. Leffingwell Rd.
 6' W. of Dr. to No. 10919 Leffingwell Bl.

NORWALK BLDG. DIST. NO. 4.2

- NOTES
- PROVIDE STAKES ON THE PROPERTY LINE OR PROPERTY LINES PRODUCED AT RIGHT ANGLES TO THE SEWER LINE AT THE CENTER LINE OF EACH SANITARY.
 - THE REPRESENTATIVE OF THE COUNTY ENGINEER WILL SURVEY OR LAYOUT ANY PORTION OF THE WORK.
 - THE OWNER OR HIS AUTHORIZED REPRESENTATIVE SHALL FURNISH THE COUNTY ENGINEER WITH GRADE SHEETS AND STATIONING FOR ALL HOUSE LATERALS AND Y BRANCHES AND SMALL PROPERTY STAKES FOR THEM AT THESE PROPER LOCATIONS WITH STATIONING PLAINLY MARKED. ANY CHANGE IN LOCATION SHALL BE REQUESTED IN WRITING BY THE OWNER OR HIS REPRESENTATIVE.
 - NO REVISIONS SHALL BE MADE IN THESE PLANS WITHOUT THE APPROVAL OF THE COUNTY ENGINEER.
 - USE STANDARD HANDBOOK IN LINES AND COVERS, S.A. 111, EXCEPT AS NOTED.
 - USE STANDARD STRENGTH PIPE.
 - USE CEMENT MORTAR FOR ALL WIPED CLAY PIPE JOINTS.
 - RESURFACE ALL TRENCH WITHIN PAVED AREA TO MEET L. A. COUNTY ROAD DEPT., OR CALIF. STATE HIGHWAY DEPT. REQUIREMENTS IN ACCORDANCE WITH PERMITS.
 - INDICATE FOUR FEET OF SEWER AT POINTS OF INTERFERENCE WITH POLES, S.A. 112.
 - HOUSE LATERALS TO BE CONSTRUCTED WITH JOINTS AT PROPERTY LINE 6" BELOW CURB GRADE EXCEPT AS NOTED.
 - ALL STRUCTURES SHALL BE BRICK SEWER STRUCTURES, S.A. 104, EXCEPT AS NOTED.
 - FOR ALLOWABLE LEAKAGE TEST USE FORMULA NO. 1, SPEC. SEC. 11.
 - THE PRIVATE ENGINEER IS TO FURNISH THE HOUSE LATERAL DEPTH AT THE PROPERTY LINE BELOW THE TOP OF CURB ELEVATION OR 6" OF ALLEY FOR EACH HOUSE LATERAL, ON THE GRADE SHEET.

PROFILE ALIGNMENT AND GRADE OF
SANITARY SEWERS P.C. 3928
 TO BE CONSTRUCTED IN PAGE 1
 TRACT No 22409 (22,912)

PRIVATE CONTRACT NO. 3928
 W.S. 39 (2)
 1 SHEET, 2 PAGES
 SCALE: 1" = 4' MAR., 1956
 PREPARED IN THE OFFICES OF
OLSON SURVEYING SERVICE
 by *Frank A. Phillips*
 REG. C. E. NO. 790
 FOR LEGEND SEE PLAN NO. S-A-64

NO CHARGE FOR CONNECTIONS
 7' 2" Diameter S-4-24

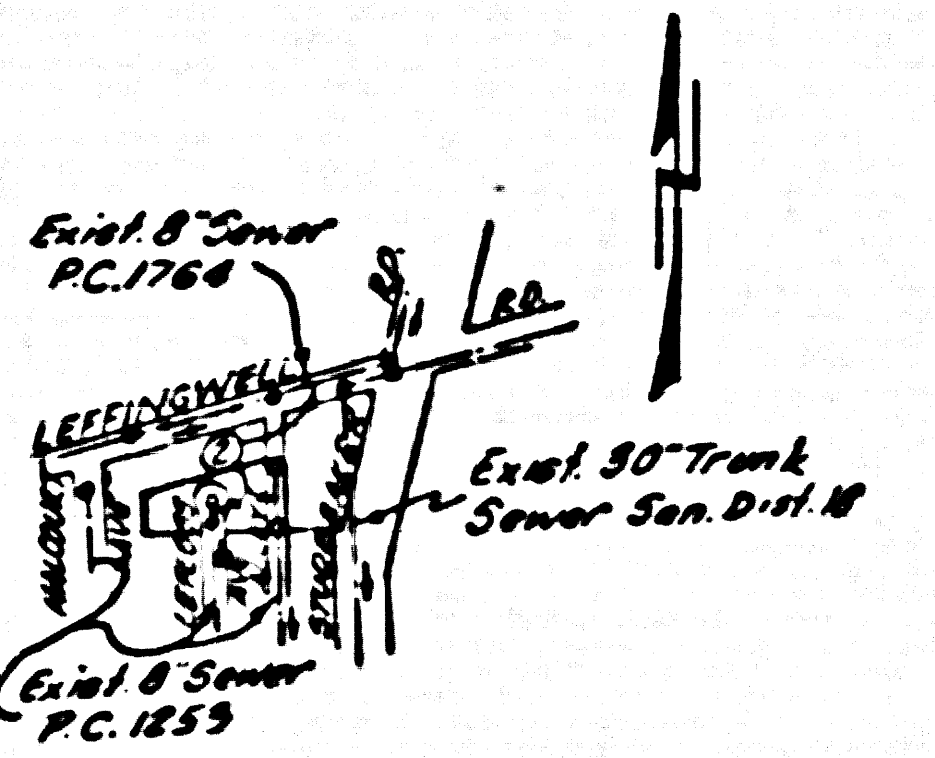

INDEX MAP
 TRACT No 22409 P.C. 3928
 SCALE: 1" = 800'

checked 6-19-56 *McLaren*

NOTES

GRADES TO WHICH THE IMPROVEMENT IS TO BE CONSTRUCTED ARE SHOWN ON PLANS AND PROFILES GRADE POINTS FOR TOP OF CURB, CENTER LINE OF STREETS, OR CENTER LINE OF ALLEYS ARE SHOWN BY CIRCLES ON PROFILES AT ALL POINTS BETWEEN RESEARCHED POINTS THE GRADE SHALL BE ESTABLISHED SO AS TO CONFORM TO A STRAIGHT LINE DRAWN BETWEEN SAID RESEARCHED POINTS.

ELEVATIONS ARE IN FEET ABOVE U.S.C. & G.S. MEASUREMENT SURFACE OF 1929.

THE DRAWING AND THE DATA HEREON ARE HEREBY MADE A PART OF THE SPECIFICATIONS.

WORK SHALL BE CONSTRUCTED ACCORDING TO SPECIFICATIONS ON FILE IN THE OFFICE OF THE COUNTY ENGINEER AND SHALL BE PRODUCED ONLY IN THE PRESENCE OF THE COUNTY ENGINEER.

BEFORE WORK CAN BE STARTED, THE CONTRACTOR MUST OBTAIN A PERMIT TO EXCAVATE IN COUNTY STREETS FROM THE L. A. COUNTY ROAD DEPT. USE OF THIS ST. AND MAKE A REPORT WITH THE COUNTY ENGINEER ROOM 514 SAN ANTONIO BLDG. 330 S.W. BROADWAY SUFFICIENT TO COVER THE COST OF CONSTRUCTION INSPECTION AND RECORD PLANS.

APPROVAL OF THIS PLAN BY THE COUNTY OF LOS ANGELES DOES NOT CONSTITUTE A REPRESENTATION AS TO THE ACCURACY OR THE LOCATION OF OR THE EXISTENCE OR NON-EXISTENCE OF ANY UNDERGROUND UTILITY PIPE, OR STRUCTURE WITHIN THE LIMITS OF THE PROJECT THIS NOTE APPLIES TO ALL PAGES.

IF WORK IS TO BE DONE IN A STATE HIGHWAY, A PERMIT MUST BE OBTAINED FROM THE STATE OF CALIFORNIA, DIVISION OF HIGHWAYS, 120 SOUTH SPRING STREET.

COUNTY OF LOS ANGELES, CALIFORNIA

APPROVED, JOHN A. LAMBE, COUNTY ENGINEER APPROVED, A. M. RAWN, CHIEF ENGINEER
 DIST. NO. 18

BY *A.P. Collins* SANITATION ENGINEER BY *J.P. Williams* OFFICE ENGINEER
 CHECKED BY *R. Keller* 5-14-56
 OFFICE OF COUNTY ENGINEER, REG. C. E. NO. 7860

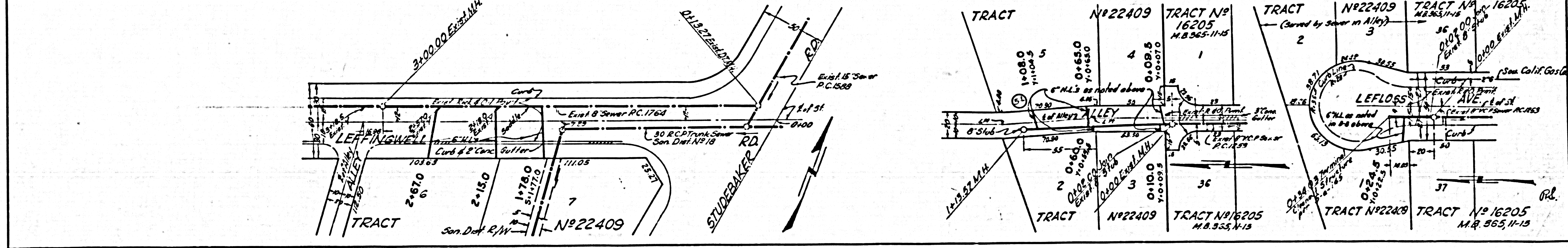
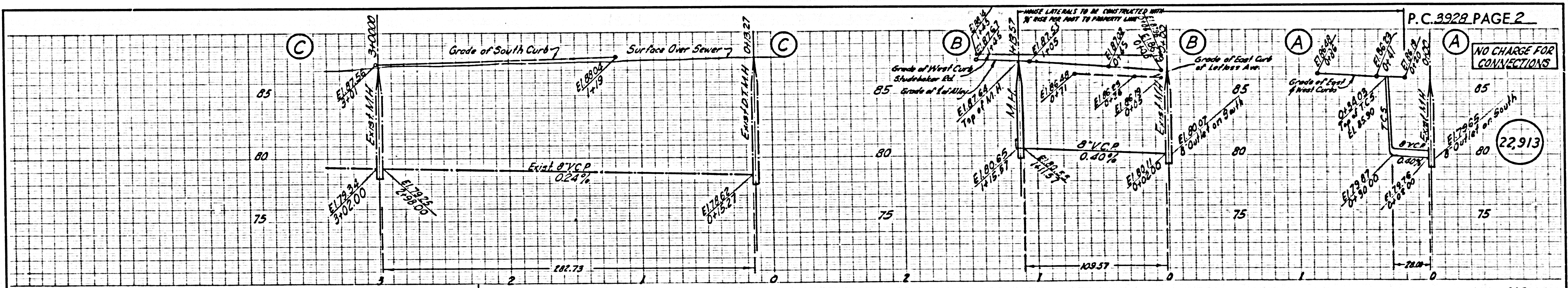

P.C. 3928

TRACT - No 22409

P.C. 3928