

B.M. Elev. 49.636  
Lead & bench nail of S.W. corner of  
catch basin at N.E. corner of CRENSHAW  
BLVD. & El Segundo Blvd. Sta. 997 (Vol. #2 pg. 344)

BENCH MARK ELEV. 43.636  
Lead & bench nail of S.W. corner of  
catch basin at N.E. corner of Crenshaw  
Blvd. & El Segundo Blvd. Sta. 997  
(Vol. #2 pg. 344)

# LENNOX BLDG. DIST. NO. 7

PROFILE ALIGNMENT AND GRADE OF  
**SANITARY SEWERS** PAGE 1

23,497  
(3)

CRENSHAW BOULEVARD FROM  
EL SEGUNDO BLVD. TO R.E. RY.

PRIVATE CONTRACT NO. 3971

W.S. 25

2 SHEETS, 3 PAGES

SCALE: 1" = 40' April, 1956

PREPARED IN THE OFFICES OF  
**ENGINEERING SERVICE CORP.**

By: *E. J. ...*  
REG. C. E. NO. 3602

FOR LEGEND SEE PLAN NO. S-A-64

**NOTE:**  
GRADES TO WHICH THIS IMPROVEMENT IS TO BE CONSTRUCTED ARE SHOWN ON PLANS AND PROFILES. GRADE POINTS FOR  
TOP OF CURB, CENTER LINE OF STREETS, OR CENTER LINE OF ALLEYS ARE SHOWN BY CHARACTERS ON PROFILES AT ALL POINTS BETWEEN  
DESIGNATED POINTS THE GRADE SHALL BE ESTABLISHED SO AS TO CONFORM TO A STRAIGHT LINE DRAWN BETWEEN SAID DESIGNATED  
POINTS.  
ELEVATIONS ARE IN FEET ABOVE U.S.C. & G.S. MEAN SEA LEVEL OF 1929.  
THIS DRAWING AND THE DATA HEREON ARE HEREBY MADE A PART OF THE SPECIFICATIONS.  
WORK SHALL BE CONSTRUCTED ACCORDING TO SPECIFICATIONS ON FILE IN THE OFFICE OF THE COUNTY ENGINEER AND SHALL  
BE PROSECUTED ONLY IN THE PRESENCE OF THE COUNTY ENGINEER.  
BEFORE WORK CAN BE STARTED, THE CONTRACTOR MUST OBTAIN A PERMIT TO EXCAVATE IN COUNTY STREETS FROM THE  
L.A. COUNTY ROAD DEPT. 100 W. 3RD ST. AND MAKE A REPORT WITH THE COUNTY ENGINEER, ROOM 324 MAIN AMERICAN BLDG.,  
Rm. 324 SO. BROADWAY IMMEDIATE TO COVER THE COST OF CONSTRUCTION INSPECTION AND RECORD PLANS.  
APPROVAL OF THIS PLAN BY THE COUNTY OF LOS ANGELES DOES NOT CONSTITUTE A REPRESENTATION AS TO THE ACCURACY  
OR THE LOCATION OF OR THE EXISTENCE OR NON-EXISTENCE OF ANY UNDERGROUND UTILITY PIPE, OR STRUCTURE WITHIN THE  
LIMITS OF THIS PROJECT. THIS NOTE APPLIES TO ALL PAGES.  
IF WORK IS TO BE DONE IN A STATE HIGHWAY, A PERMIT MUST BE OBTAINED FROM THE STATE OF CALIFORNIA, DIVISION OF  
HIGHWAYS, 130 SOUTH SPRING STREET.

COUNTY OF LOS ANGELES, CALIFORNIA

APPROVED, JOHN A. LAMBE, COUNTY ENGINEER

APPROVED, A. M. RAWIN, CHIEF ENGINEER

By: *A. P. ...* By: *J. ...*  
SANITATION ENGINEER OFFICE ENGINEER

CHECKED BY: *P. ...* 6-23-56  
OFFICE OF COUNTY ENGINEER, REG. C. E. NO. 7860

Revisions Approved by  
City of Gardena  
*Charles Albert Smith*  
Asst. City Engineer RCE 5408

Revisions Approved by  
City of Hawthorne  
*Charles P. Handy*  
City Engineer RCE 9766

REVISED: Sewer alignment Sta. 0102 to 21768, sewer stations & grades  
0102 to 1116434, added utilities on plan and profile.

Checked by: *J. K. ...* 9-6-56  
Office of County Engineer RCE 3406

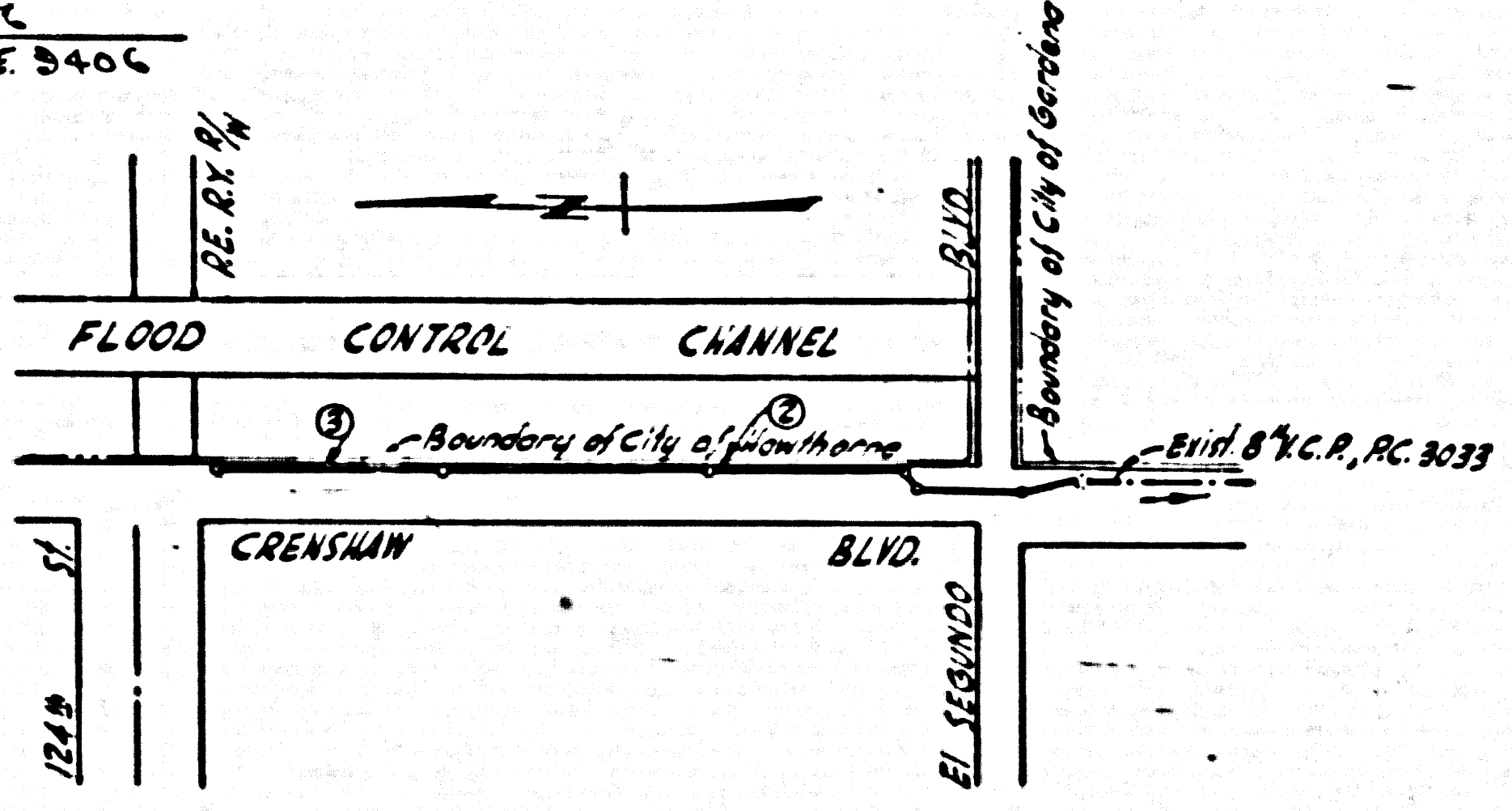

NO CHARGE FOR  
CONNECTIONS  
*J. K. ...* 6-22-56

Approved by  
City of Gardena  
*Charles Albert Smith*  
Asst. City Engineer RCE 5400

Approved by  
City of Hawthorne  
*Charles P. Handy*  
City Engineer RCE 9766

SHEETS	PAGES
1	1-2
2	3

REVISED: Sewer alignment Sta. 0100 to Sta. 3100 addition  
M.N., changed location of M.N.'s, added utilities & curbs.

Checked by: *J. K. ...* 9-27-56  
Office of County Engineer Reg. C. E. No. 3406

CRENSHAW BLVD.  
Scale 1" = 300'  
RC 3971

Lead 10-1-56 *W. ...*

P.C. 3971 PAGE 2

NO CHARGE FOR  
CONNECTIONS

23,498

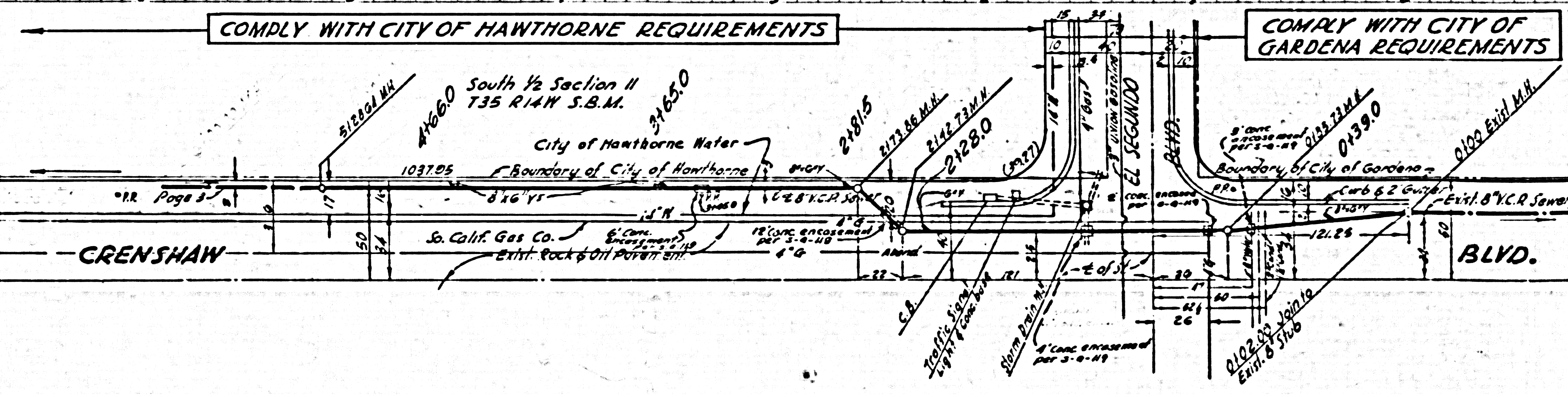
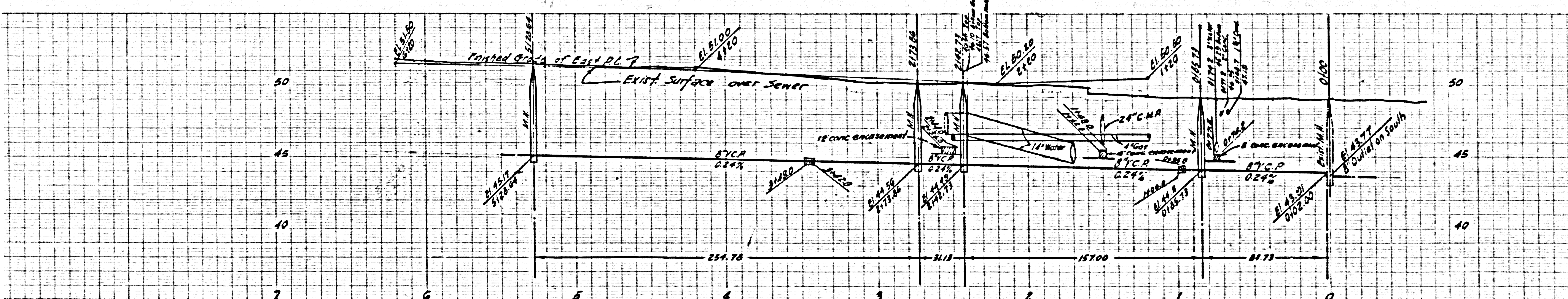

Trim Line

WQ 5676-115

NO CHARGE FOR CONNECTIONS

23,499

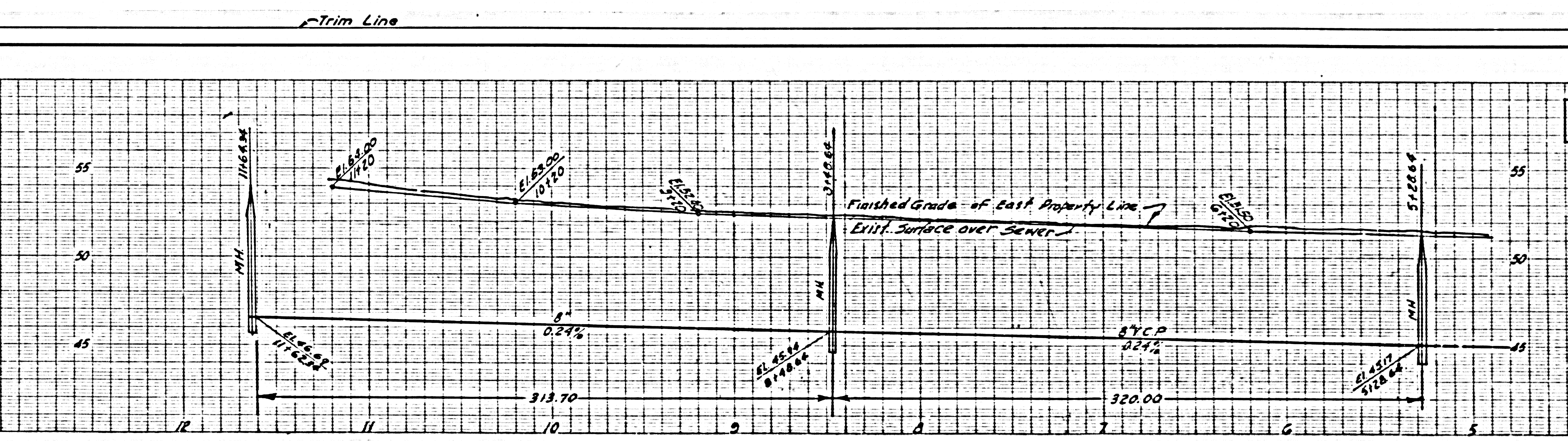

COMPLY WITH CITY OF HAWTHORNE REQUIREMENTS

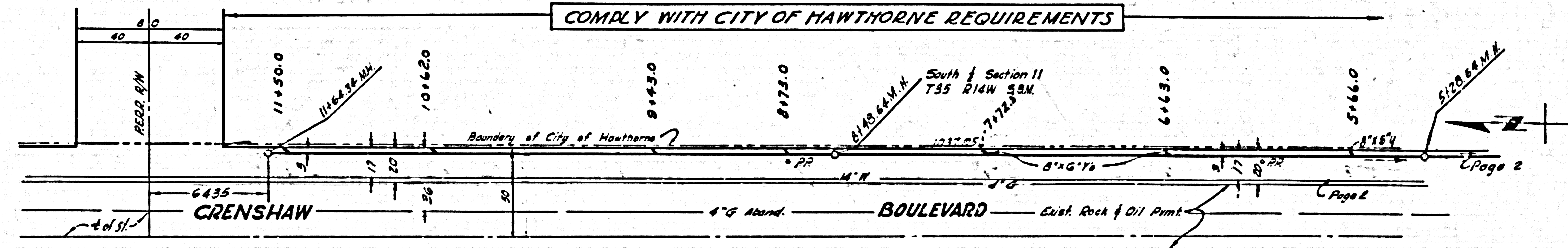

Trim Line

17559