

BM - C-3M-1, Elev. 137.92, LLB 112, P. 141  
EASTERN AVE. AT BANDINI BLVD  
3/4" I.P. on E. Prod. of BANDINI, 50' W. of E.

NO CHARGE FOR CONNECTIONS  
*L. Curtis 10-17-56*

before breaking into any existing structure  
and before final acceptance of this work.  
County Sanitation District should be notified  
in order that required inspection may be made.

EAST LOS ANGELES BLDG. DIST. NO. 6

- NOTES
1. PROVIDE STAKES FOR THE PROPERTY LINE OR PROPERTY LINES PRODUCED AT RIGHT ANGLES TO THE SEWER LINE AT THE CENTER LINE OF EACH MANHOLE.
  2. NO REPRESENTATIVE OF THE COUNTY ENGINEER WILL BE AT THE LAYOUT OF ANY PORTION OF THE WORK.
  3. THE OWNER OR HIS AUTHORIZED REPRESENTATIVE SHALL FURNISH THE COUNTY ENGINEER WITH GRADE SHEETS AND STATION FOR ALL BRANCH LATERALS AND Y BRANCHES AND SHALL PROVIDE STAKES FOR THEM AT THESE PROPOSED LOCATIONS WITH STATIONING PLAINLY MARKED. ANY CHANGE IN LOCATION SHALL BE REQUESTED IN WRITING BY THE OWNER OR HIS REPRESENTATIVE.
  4. NO REVISIONS SHALL BE MADE IN THESE PLANS WITHOUT THE APPROVAL OF THE COUNTY ENGINEER.
  5. USE STANDARD MANHOLE FRAMES AND COVERS, S.A.-117, EXCEPT AS NOTED.
  6. USE STANDARD STRENGTH PIPE EXCEPT AS NOTED.
  7. USE CEMENT MORTAR FOR ALL VITRIFIED CLAY PIPE JOINTS.
  8. RESURFACE ALL TRENCH WITHIN PAVED AREA TO MEET L.A. COUNTY ROAD DEPT. OR CALIF. STATE HIGHWAY DEPT. REQUIREMENTS IN ACCORDANCE WITH PERMITS.
  9. ENCASE FOUR FEET OF SEWER AT POINTS OF INTERFERENCE WITH POLES, S.A. 119.
  10. HORIZONTAL LATERALS TO BE CONSTRUCTED WITH 45° BENDS EXCEPT AS NOTED.
  11. ALL TRENCHES SHALL BE BRICK SEWER STRUCTURES, S.A.-124, EXCEPT AS NOTED.
  12. FOR ALLOWABLE SLOPES USE FORMULA NO. 1, SPEC. SEC. 54.
  13. MANHOLE TOPS IN UNIMPROVED RIGHTS-OF-WAY TO BE 4" ABOVE FINISHED GRADE.

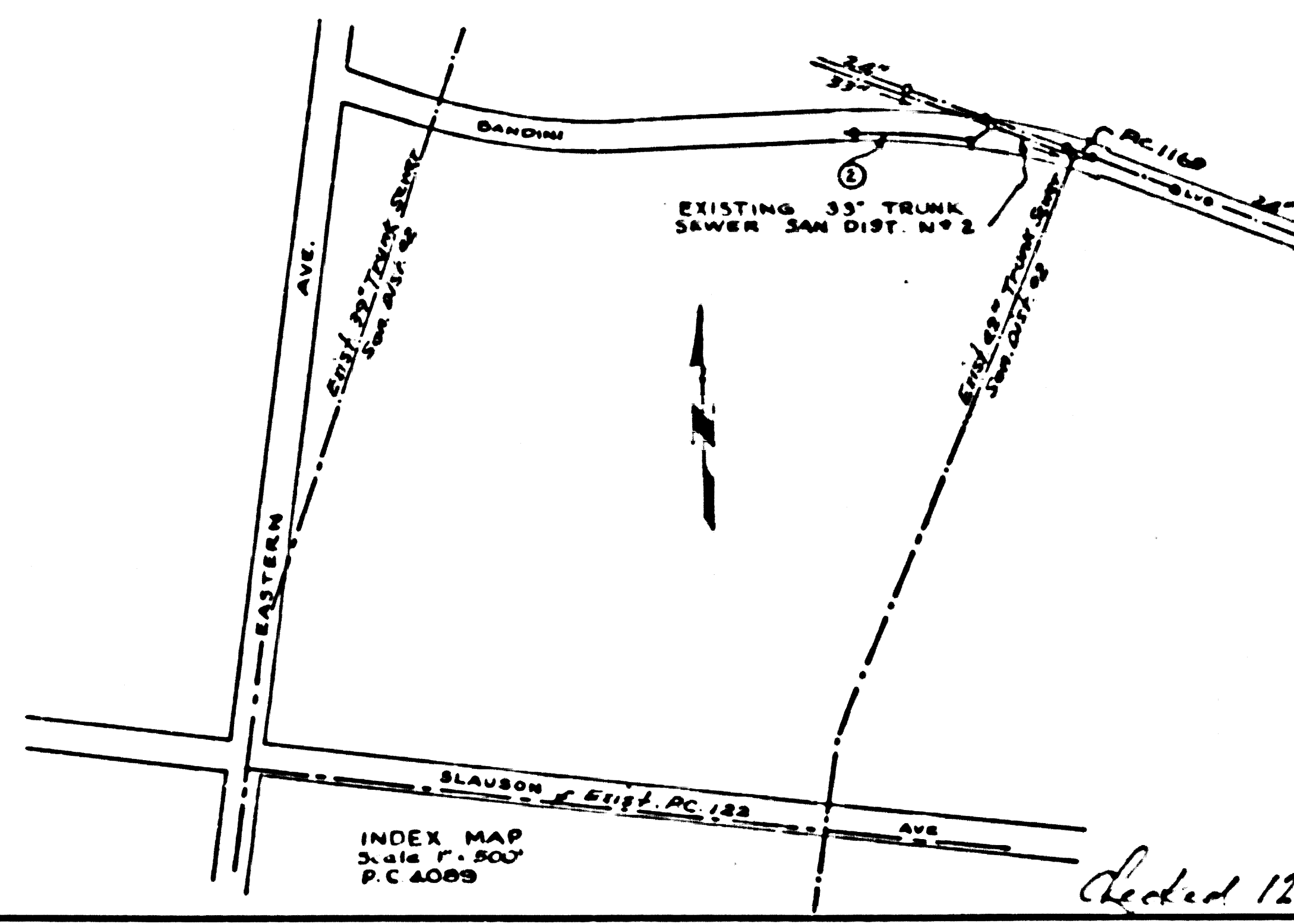

PROFILE ALIGNMENT AND GRADE OF **P.C. 4089**  
**SANITARY SEWERS** PAGE 1  
TO BE CONSTRUCTED IN  
**BANDINI BLVD.**  
FROM  
1600'± TO 2013'± EAST OF E. EASTERN AVE

PRIVATE CONTRACT NO. 4089  
W.S. 36  
1 SHEET, 2 PAGES (23,741)  
SCALE: VERT. 1" = 4' HORIZ. 1" = 40'  
JULY, 1956  
PREPARED IN THE OFFICES OF  
**CENTRAL MANUFACTURING DISTRICT**  
BY *A. P. Collins*  
REG. C. E. NO. 7707  
FOR LEGEND SEE PLAN NO. S.A.-64

NOTES

GRADES TO WHICH THIS IMPROVEMENT IS TO BE CONSTRUCTED ARE SHOWN ON PLANS AND PROFILES. GRADE POINTS FOR TOP OF CURB, CENTER LINE OF STREET, TO CENTER LINE OF ALLEYS ARE SHOWN BY CIRCLES ON PROFILES. AT ALL POINTS BETWEEN DESIGNATED POINTS THE GRADE SHALL BE ESTABLISHED SO AS TO CONFORM TO A STRAIGHT LINE DRAWN BETWEEN SAID DESIGNATED POINTS.

ELEVATIONS ARE IN FEET ABOVE U.S.C. & G.S. SEA LEVEL, DATUM OF 1929.

THIS DRAWING AND THE DATA HEREON ARE HEREBY MADE A PART OF THE SPECIFICATIONS.

WORK SHALL BE CONSTRUCTED ACCORDING TO SPECIFICATIONS ON FILE IN THE OFFICE OF THE COUNTY ENGINEER AND SHALL BE PROSECUTED ONLY IN THE PRESENCE OF THE COUNTY ENGINEER.

WHOLE WORK CAN BE STARTED, THE CONTRACTOR MUST OBTAIN A PERMIT TO EXCAVATE IN COUNTY STREETS FROM THE L.A. COUNTY ROAD DEPT., 108 W. 2ND ST. AND MAKE A DEPOSIT WITH THE COUNTY ENGINEER, ROOM 324 PAIN AMERICAN BUILDING, 330 SO. BROADWAY, SUFFICIENT TO COVER THE COST OF CONSTRUCTION INSPECTION AND RECORD PLANS.

APPROVAL OF THIS PLAN BY THE COUNTY OF LOS ANGELES DOES NOT CONSTITUTE A REPRESENTATION AS TO THE ACCURACY OF THE LOCATION OR OF THE EXISTENCE OR NON-EXISTENCE OF ANY UNDERGROUND UTILITY PIPE, OR STRUCTURE WITHIN THE LIMITS OF THIS PROJECT. THIS NOTE APPLIES TO ALL PAGES.

IF WORK IS TO BE DONE IN A STATE HIGHWAY, A PERMIT MUST BE OBTAINED FROM THE STATE OF CALIFORNIA, DIVISION OF HIGHWAYS, 120 SOUTH SPRING STREET.

COUNTY OF LOS ANGELES, CALIFORNIA

APPROVED, JOHN A. LAMBE, COUNTY ENGINEER  
BY *A. P. Collins*  
SANITATION ENGINEER

APPROVED, A. M. BAWN, CHIEF ENGINEER  
BY *J. P. Williams*  
OFFICE ENGINEER

CHECKED BY *P. K. Kuhn* 10-17-56  
OFFICE OF COUNTY ENGINEER, S.B.C. E. NO. 7860

BANDINI BLVD.

P.C. 4089

P.C. 4089 PAGE 2

NO CHARGE FOR CONNECTIONS

(23,742)

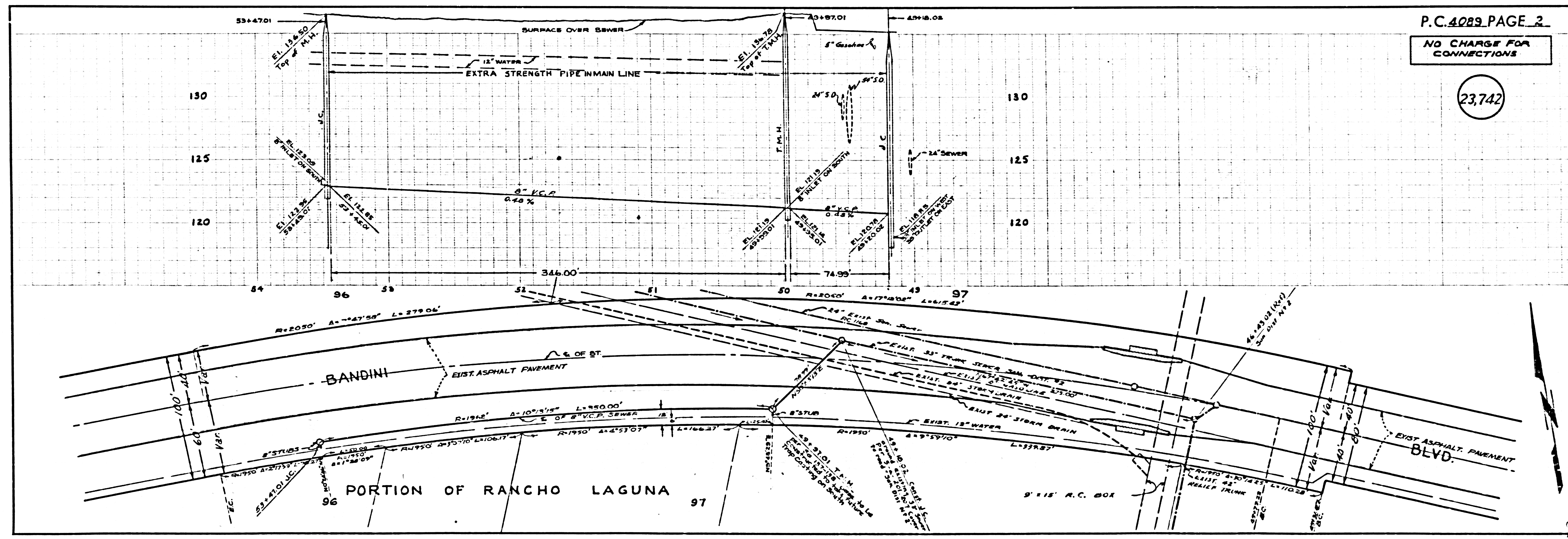

P.C. 4089