

WHITTIER BLDG. DIST. No 11

P.C. 4115
PAGE 1

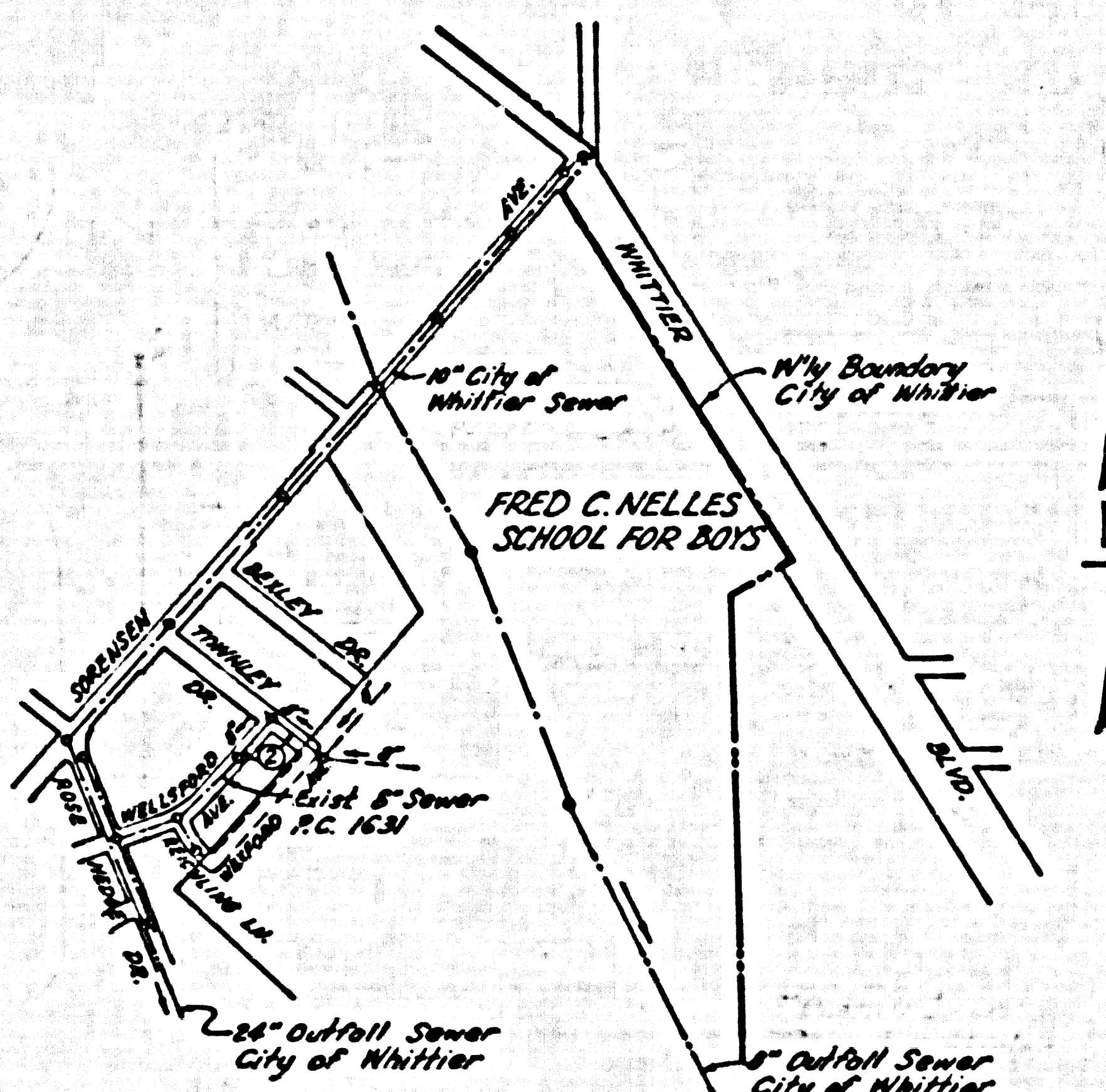

INDEX MAP
SCALE: 1"=600'
P.C. 4115

- NOTES:
NO REPRESENTATIVE OF THE COUNTY ENGINEER WILL SURVEY OR LAYOUT ANY PORTION OF THE WORK.
NO REVISIONS SHALL BE MADE IN THESE PLANS WITHOUT APPROVAL OF THE COUNTY ENGINEER.
PROVIDE STAKES ON THE PROPERTY LINE OR PROPERTY LINES PRODUCED AT RIGHT ANGLES TO THE SEWER LINE AT THE CENTERLINE OF EACH MANHOLE.
- USE STANDARD STRENGTH PIPE EXCEPT AS NOTED.
 - USE CEMENT MORTAR FOR ALL VITRIFIED CLAY PIPE JOINTS.
 - ENCASE FOUR FEET OF SEWER AT POINTS OF INTERFERENCE WITH POLES; PER S-A-118. GRADE OF CENTER LINE OF STREET EXCEPT AS NOTED.
 - USE FORMULA NO. 1, SEC. 54 OF SPECIFICATIONS TO COMPUTE ALLOWABLE LEAKAGE.
 - ALL STRUCTURES SHALL BE BRICK SEWER STRUCTURES AS PER PLAN NO. S-A-104, EXCEPT AS NOTED.
 - USE STANDARD MANHOLE FRAMES AND COVERS AS PER PLAN NO. S-A-117, EXCEPT AS NOTED.
 - RESURFACE TRENCH WITHIN PAVED AREA TO MEET L.A. COUNTY ROAD DEPT. REQUIREMENTS IN ACCORDANCE WITH PERMIT.

USE FORMULA NO. SEC. 51 OF SPECIFICATIONS TO COMPUTE ALLOW:
B.M. 7-B.M. 116, ELEV. 205.85, CHISELED "X" IN N.E. COR. CONCRETE SLAB OF IRRIGATION BOX NEAR COMMISSARI
ABOVE ELEV. BASED ON THE FOLLOWING B.M.
B.M. 1-16, ELEV. 211.32, P.D. 1202, P. 13 (1952 ADJUSTMENT)
C.S. MONUMENT IN MANHOLE
27' S. 12° W. & WHITTIER BLVD., 107' N. W. & WASHINGTON BLVD.

COLLECT CHARGES AS INDICATED
77 7/8 Dennis 2-4-56

STATE OF CALIFORNIA
DEPARTMENT OF PUBLIC WORKS
DIVISION OF ARCHITECTURE
LOS ANGELES BRANCH OFFICE
By Claude J. DeLoach, AUGUST 30, 1956
SENIOR CIVIL ENGINEER, REG. C.E. NO. 6768

PRIVATE CONTRACT NO. 4115
PROFILE, ALIGNMENT AND GRADE OF
SANITARY SEWERS (23,779)
TO BE CONSTRUCTED BY
WELLSFORD AVENUE
AND
AND TOWNLEY DRIVE WAY (2)
W.S. 37
ONE SHEET; TWO PAGES

SCALE: VERT. 1"=4' H.C. 1"=40' H.C.
AUGUST, 1956
COUNTY OF LOS ANGELES, CALIFORNIA
JOHN A. LAMBIE COUNTY ENGINEER
CHECKED BY: [Signature] 7-5-56 OFFICE OF COUNTY ENGINEER, REG. C.E. NO. 7840
APPROVED: [Signature] SANITATION DIVISION

A. M. RAWN
COUNTY ENGINEER OF COUNTY
SANITATION DISTRICT NO. 18
BY: [Signature]
OFFICE ENGINEER

FOR LEGEND
SEE PLAN NO. S-A-64

NOTE:
GRADE TO WHICH THIS IMPROVEMENT IS TO BE CONSTRUCTED AND SHOWN ON PLANS AND PROFILES, GRADE POINTS FOR TOP OF CURB, COVERED LINE OF STREET OR CENTER LINE OF ALLEY AND SHOWN BY CIRCLES ON PROFILES, AT ALL POINTS BETWEEN ADJACENT POINTS THE GRADE SHALL BE ESTABLISHED SO AS TO CONFORM TO A STRAIGHT LINE DRAWN BETWEEN SAID DESIGNATED POINTS.
ELEVATIONS ARE IN FEET ABOVE U.S.C. & G.S. SEA LEVEL DATUM OF 1929.
WHERE SHALL BE CONSTRUCTION ACCORDING TO SPECIFICATIONS ON FILE IN THE OFFICE OF THE COUNTY ENGINEER AND SHALL BE PROSECUTED ONLY IN THE PRESENCE OF THE COUNTY ENGINEER.
THIS DRAWING AND THE DATA HEREON ARE HEREBY MADE A PART OF THE SPECIFICATIONS.
BIDDING SHALL BE OPENED AT THE OFFICE OF THE COUNTY ENGINEER, 100 WEST SECOND STREET, LOS ANGELES, CALIFORNIA, AT 10:00 A.M. ON THE DAY AND DATE SPECIFIED IN THE BIDDING NOTICES.
APPROVAL OF THIS PLAN BY THE COUNTY OF LOS ANGELES DOES NOT CONSTITUTE A REPRESENTATION AS TO THE ACCURACY OF THE LOCATION OF OR THE EXISTENCE OR NON-EXISTENCE OF, ANY UNDERGROUND UTILITY, PIPE OR STRUCTURE WITHIN THE LIMITS OF THIS PROJECT.

checked 12-14-56 [Signature]

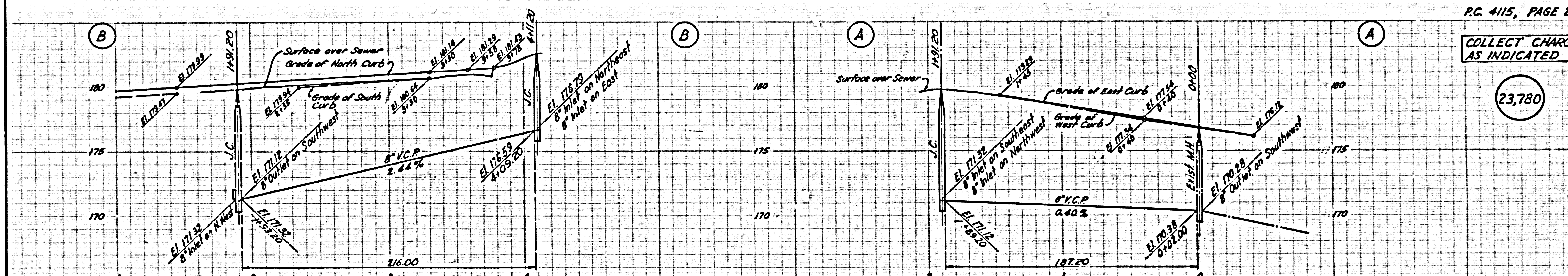

P.C. 4115, PAGE 2

COLLECT CHARGES AS INDICATED

(23,780)

