

B.M. U.S.G.S. B.M. No. 35 (U.S. 820)  
Elev. 2355.999 (U.S.C. & G.S. Adj. 1932)  
Lancaster 400' W. of Station; 1'  
from N.W. cor. Farmers & Merchants  
Bank; Bronze Tablet stamped "2356-  
1914-35"

NOTE:  
Elev. of this B.M. per Rd. Dept.  
L.B. 118-23 is 2355.53  
Elevations shown on this plan  
are based on El. 2355.53. (See Ca.  
Surv. F.B. 1222-97.)

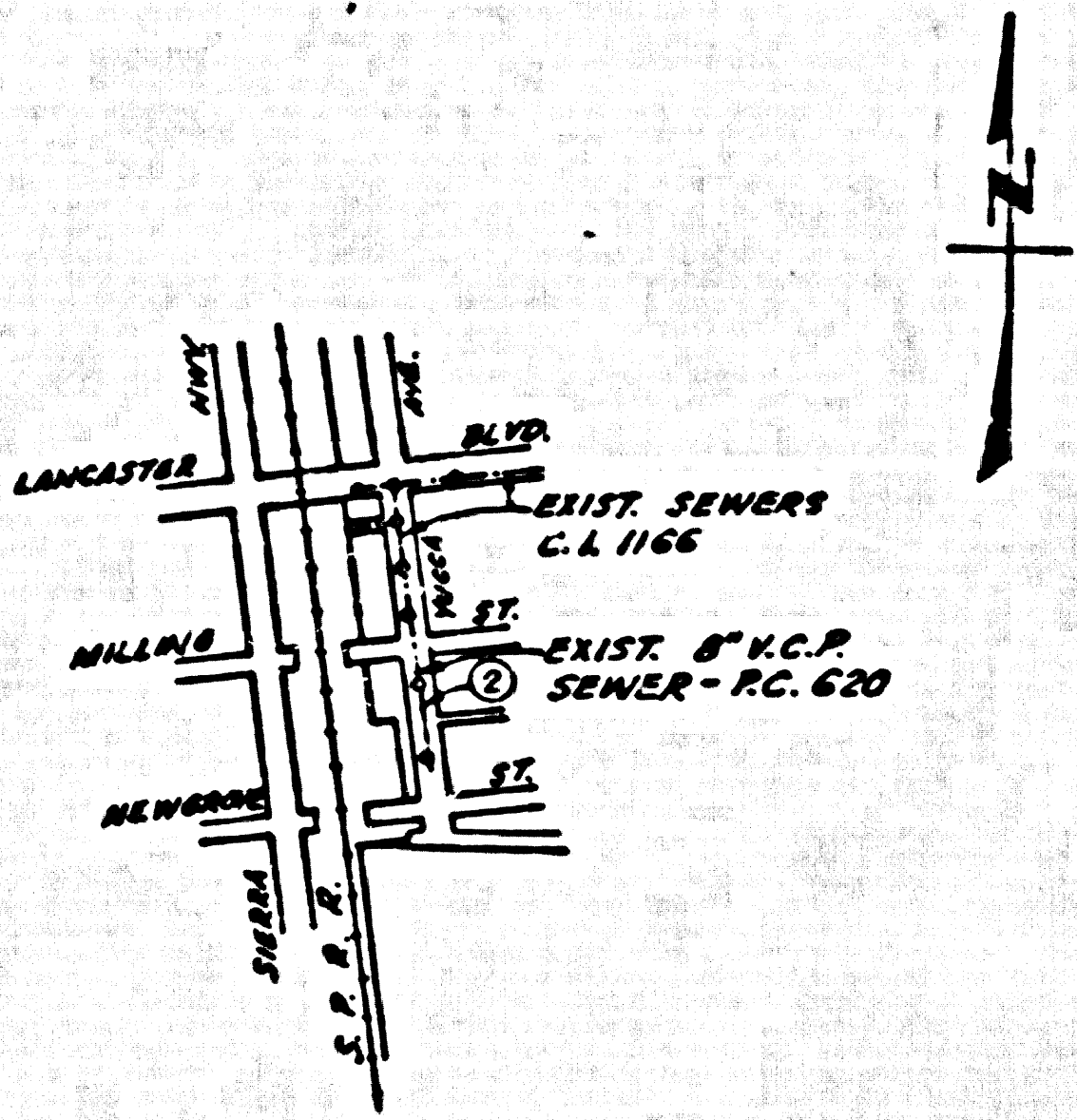

INDEX MAP  
SCALE: 1"=1000'  
P.C. 4145

LANCASTER BLDG. DIST. NO. 8

- PROVIDE STAKES ON THE PROPERTY LINE OR PROPERTY LINES PRODUCED AT RIGHT ANGLES TO THE SEWER LINE AT THE CENTER LINE OF EACH MANHOLE.
- NO REPRESENTATIVE OF THE COUNTY ENGINEER WILL SURVEY OR LAY OUT ANY PORTION OF THE WORK.
- THE OWNER OR HIS AUTHORIZED REPRESENTATIVE SHALL FURNISH THE COUNTY ENGINEER WITH GRADE SHEET AND STATION FOR ALL HOUSE LATERALS AND Y BRANCHES AND SHALL PROVIDE TRAILS FOR THEM AT THEIR PROPER LOCATIONS WITH STATIONING PLAINLY MARKED. ANY CHANGE IN LOCATION SHALL BE REQUESTED BY WRITING BY THE OWNER OR HIS REPRESENTATIVE.
- NO REVISIONS SHALL BE MADE IN THESE PLANS WITHOUT THE APPROVAL OF THE COUNTY ENGINEER.
- USE STANDARD MANHOLE FRAMES AND COVERS, 6-1/2'x6-1/2'x6-1/2'.
- USE STANDARD STRENGTH PIPE UNLESS OTHERWISE NOTED.
- USE CHAMFER JOINTS FOR ALL VITRIFIED CLAY PIPE JOINTS.
- RESURFACE ALL TRENCH WITHIN PAVED AREA TO MEET L.A. COUNTY ROAD DEPT., OR CALIF. STATE HIGHWAY DEPT. REQUIREMENTS IN ACCORDANCE WITH PERMITS.
- ENCASE FOUR FEET OF SEWER AT POINTS OF INTERFERENCE WITH POLES, 6-1/2'x6-1/2'.
- HOUSE LATERALS TO BE CONSTRUCTED WITH INVERT 6" BELOW CURB GRADE UNLESS OTHERWISE NOTED.
- ALL STRUCTURES SHALL BE BRICK SEWER STRUCTURES, 6-1/2'x6-1/2'x6-1/2'.
- FOR ALLOWABLE SPACING USE FORMULA NO. 1001, SPEC. SEC. 11.
- MANHOLE TOPS IN UNIMPROVED RIGHTS-OF-WAY TO BE 6" ABOVE FINISHED GRADE.
- DIG ALL JOINTS WITHIN 50 FEET OF PROPERTY LINES.
- THE PRIVATE SUBMITTER IS TO FURNISH THE HOUSE LATERAL DEPTH AT THE PROPERTY LINE BELOW THE TOP OF CURB ELEVATION FOR EACH HOUSE LATERAL, ON THE GRADE SHEET.

NO CHARGE  
FOR CONNECTIONS  
S.K. White 9-17-56

PROFILE ALIGNMENT AND GRADE P.C. 4145  
SANITARY SEWERS PAGE 1

TO BE CONSTRUCTED IN  
YUCCA AVENUE (24,196) (2)

PRIVATE CONTRACT NO. 4145

W.S. 70  
ONE SHEET, TWO PAGES

SCALE: VERT. 1"=6' HORIZ. 1"=50' AUGUST, 1956  
PREPARED IN THE OFFICES OF

George M. Hall  
REG. C. E. NO. 2182

FOR LEGEND SEE PLAN NO. S-A-64

NOTES:  
GRADE TO WHICH THIS IMPROVEMENT IS TO BE CONSTRUCTED SHOWN ON PLANS AND PROFILES. GRADE POINTS FOR TOP OF CURB, CENTER LINE OF STREETS, OR CENTER LINE OF ALLEYS ARE SHOWN BY CIRCLES ON PROFILES AT ALL POINTS BETWEEN DESIGNATED POINTS THE GRADE SHALL BE ESTABLISHED SO AS TO CONFORM TO A STRAIGHT LINE BETWEEN SAID DESIGNATED POINTS.

COUNTY OF LOS ANGELES, CALIFORNIA

APPROVED, JOHN A. LAMBE, COUNTY ENGINEER  
APPROVED, A. M. RAWN, CHIEF ENGINEER  
BY A.P. Collins  
CHECKED BY R. E. ...  
OFFICE OF COUNTY ENGINEER, REG. C. E. NO. 7164

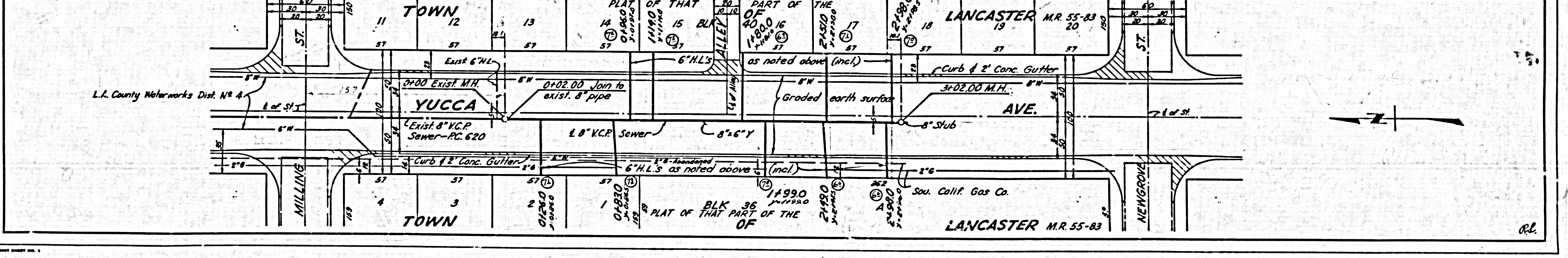
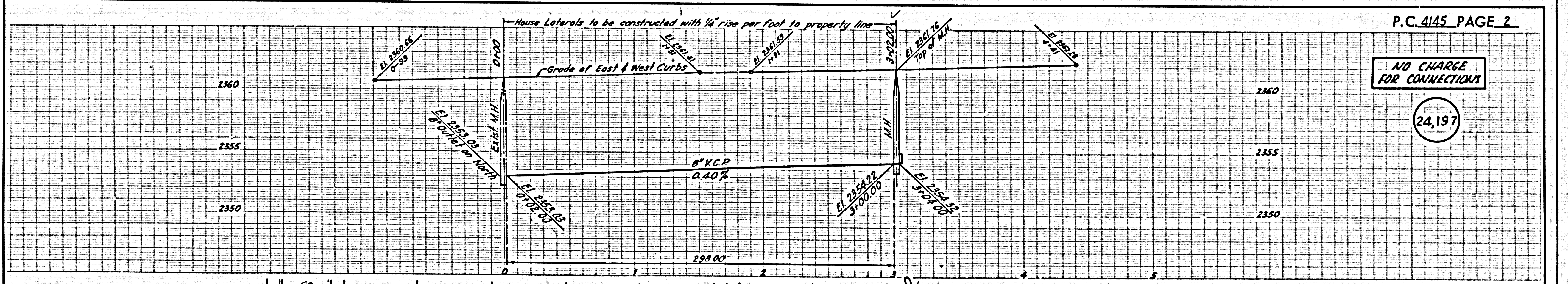

P.C. 4145 PAGE 2

NO CHARGE  
FOR CONNECTIONS  
24,197

P.C. 4145