

PALMDALE BLDG. DIST. NO. 2.1

PROFILE ALIGNMENT AND GRADE OF **P.C. 4163**
SANITARY SEWERS PAGE **1**
 TO BE CONSTRUCTED IN
SANITARY SEWER R/W

PRIVATE CONTRACT NO. 4163
 W.S. 65
 1 SHEET, 2 PAGES (24,182)
 SCALE: 1" = 40' AUGUST, 1956
 PREPARED IN THE OFFICES OF
R.L. STUCKEY CO. (2)
 REG. C.E. NO. 6067
 FOR LEGEND SEE PLAN NO. C-A-64

B.M. U.S.G.S. G-426 (U.S. 3187) C1-2636.421 0.6 MI. N. of
 Palmdale Sta. on S.P.R.R. 51d disk on conc. post 25ft. W of E
 of track.

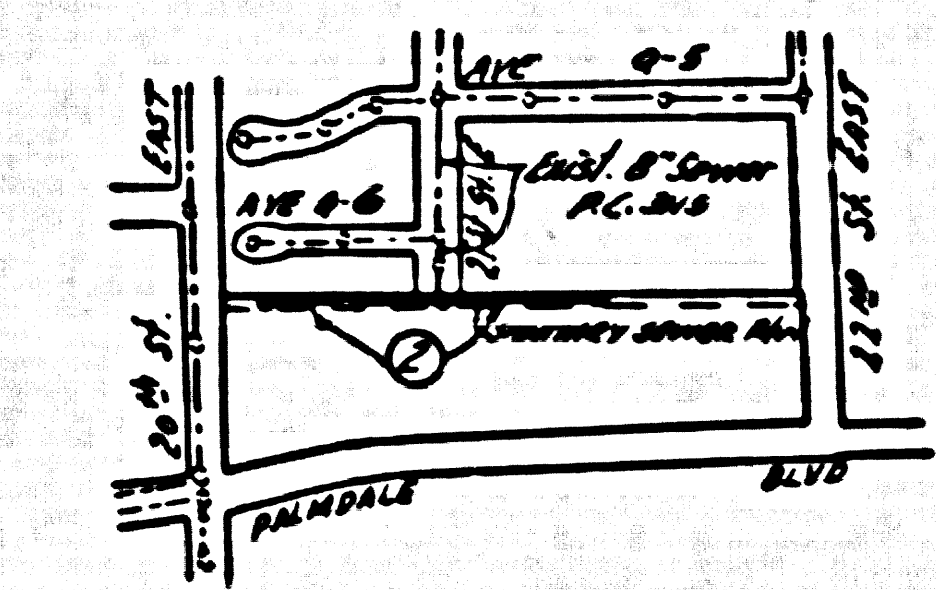

Scale: 1"=600'

INDEX MAP
 P.C. 4163

- NOTES:
- PROVIDE STAKES ON THE PROPERTY LINE OR PROPERTY LINES PRODUCED AT RIGHT ANGLES TO THE SEWER LINE AT THE CENTER LINE OF EACH MANHOLE.
 - NO REPRESENTATIVE OF THE COUNTY ENGINEER WILL SURVEY OR LAYOUT ANY PORTION OF THE WORK.
 - THE OWNER OR HIS AUTHORIZED REPRESENTATIVE SHALL FURNISH THE COUNTY ENGINEER WITH GRADE SHEETS AND STATION FOR ALL HOUSE LATERALS AND Y BRANCHES AND SHALL PROVIDE STAKES FOR THEM AT THEIR PROPER LOCATIONS WITH STATIONING PLAINLY MARKED. ANY CHANGE IN LOCATION SHALL BE REQUESTED IN WRITING BY THE OWNER OR HIS REPRESENTATIVE.
 - NO REVISIONS SHALL BE MADE IN THESE PLANS WITHOUT THE APPROVAL OF THE COUNTY ENGINEER.
 - USE STANDARD MANHOLE FRAMES AND COVERS, S-A-117, EXCEPT AS NOTED.
 - USE STANDARD STRENGTH PIPE EXCEPT AS NOTED.
 - USE CEMENT MORTAR FOR ALL VITRIFIED CLAY PIPE JOINTS.
 - RESURFACE ALL TRENCH WITHIN PAVED AREA TO MEET L. A. COUNTY ROAD DEPT. OR CALIF. STATE HIGHWAY DEPT. REQUIREMENTS BY ACCORDANCE WITH PERMITS.
 - INCREASE FOLD OUT OF SEWER AT POINTS OF INTERFERENCE WITH POLES, S-A-119.
 - HOUSE LATERALS TO BE CONSTRUCTED WITH INVERTS AT PROPERTY LINE. 1" MINIMUM CURB GRADE EXCEPT AS NOTED.
 - ALL STRUCTURES SHALL BE SINCE SEWER STRUCTURES, S-A-104, EXCEPT AS NOTED.
 - FOR ALLOWABLE LEAKAGE TEST USE FORMULA NO. 1, S.P.C.E., SEC. 21.
 - MANHOLE TOPS IN UNIMPROVED SHORTS-OR-WAY TO BE 6" ABOVE FINISHED GRADE.
 - Sell all joints with 4" cement mortar that are within 20 ft of all property lines or in sanitary sewer rights of way.

COLLECT CHARGES
 AS INDICATED
 L. Collins 2-1-57

NOTES:
 GRADES TO WHICH THIS IMPROVEMENT IS TO BE CONSTRUCTED ARE SHOWN ON PLANS AND PROFILES. GRADE POINTS FOR TOP OF CURB, CENTER LINE OF STREET, OR CENTER LINE OF ALLEYS ARE SHOWN BY CIRCLES ON PROFILES. AT ALL POINTS BETWEEN DESIGNATED POINTS THE GRADE SHALL BE ESTABLISHED SO AS TO CONFORM TO A STRAIGHT LINE DRAWN BETWEEN SAID DESIGNATED POINTS.
 ELEVATIONS ARE IN FEET ABOVE U.S.C. & G.S. SEA LEVEL DATUM OF 1929.
 THIS DRAWING AND THE DATA HEREON ARE HEREBY MADE A PART OF THE SPECIFICATION.
 WORK SHALL BE CONSTRUCTED ACCORDING TO SPECIFICATIONS ON FILE IN THE OFFICE OF THE COUNTY ENGINEER AND SHALL BE PROSECUTED ONLY IN THE PRESENCE OF THE COUNTY ENGINEER.
 BEFORE WORK CAN BE STARTED, THE CONTRACTOR MUST OBTAIN A PERMIT TO EXCAVATE BY COUNTY STREET FROM THE L. A. COUNTY ROAD DEPT., 100 W. 5TH ST AND MAKE A DEPOSIT WITH THE COUNTY ENGINEER, ROOM 534 SAN AMERICAN BUILDING, 238 SO. HOUGHTON AVENUE TO COVER THE COST OF CONSTRUCTION INSPECTION AND RECORD PLANS.
 APPROVAL OF THIS PLAN BY THE COUNTY OF LOS ANGELES DOES NOT CONSTITUTE A REPRESENTATION AS TO THE ACCURACY OF THE LOCATION OF OR THE EXISTENCE OR NON-EXISTENCE OF ANY UNDERGROUND UTILITY PIPE, OR STRUCTURE WITHIN THE LIMITS OF THE PROJECT THIS NOTE APPLIES TO ALL PAGES.
 IF WORK IS TO BE DONE IN A STATE HIGHWAY, A PERMIT MUST BE OBTAINED FROM THE STATE OF CALIFORNIA, DIVISION OF HIGHWAYS, 120 SOUTH BRIDGE STREET.

COUNTY OF LOS ANGELES, CALIFORNIA
 APPROVED, JOHN A. LAMBE, COUNTY ENGINEER
 APPROVED, A. M. BAWN, CHIEF ENGINEER
 BY A.P. Collins SANITATION ENGINEER BY L. Collins CIVIL ENGINEER
 CHECKED BY E.V. Wicks 1-4-57
 OFFICE OF COUNTY ENGINEER, REG. C. E. NO. 3406

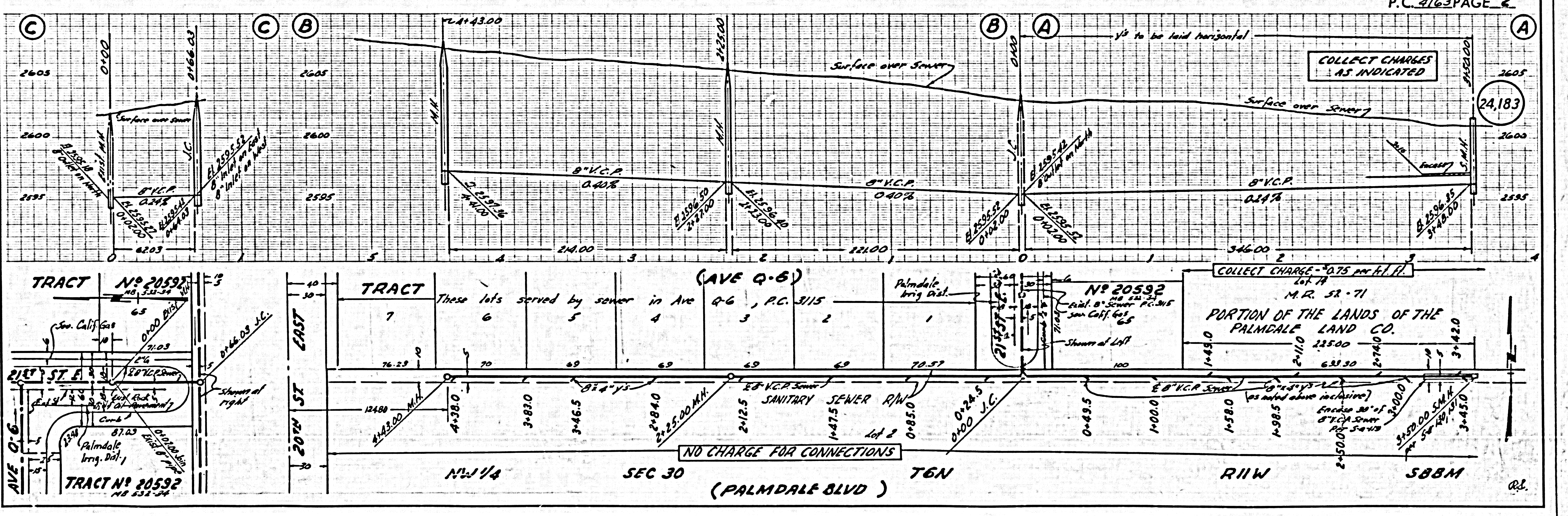

P.C. 4163 PAGE 2

COLLECT CHARGES
 AS INDICATED

(24,183)

NO CHARGE FOR CONNECTIONS

PORTION OF THE LANDS OF THE
 PALMDALE LAND CO.

P.C. 4163