

SAN DIMAS BLDG. DIST. NO. 10

PROFILE ALIGNMENT AND GRADE OF P.C. 4166
 SANITARY SEWERS PAGE 1
 TO BE CONSTRUCTED IN
HOLLENBECK STREET (24.499)

B.M.: LAT 10 N.E. corner of P.C.C. Leading
 of Frost Steps House #2322 Graveny Ave.
 100' x 1/2 of Sta. 143+32 per Calif. Div. of
 Highways datum. El. 447.52

COLLECT CHARGES
 AS INDICATED

APPROVED: *[Signature]* 11/13/56
 City Engineer, City of West Covina

- NOTES
- PROVIDE STAKES ON THE PROPERTY LINE OR PROPERTY LINES PRODUCED AT RIGHT ANGLES TO THE SEWER LINE AT THE CENTER LINE OF EACH MANHOLE.
 - NO REPRESENTATIVE OF THE COUNTY ENGINEER WILL SURVEY OR LAYOUT ANY PORTION OF THE WORK.
 - THE OWNER OR HIS AUTHORIZED REPRESENTATIVE SHALL FURNISH THE COUNTY ENGINEER WITH GRAB SHEETS AND STATIONING FOR ALL HOUSE LATERALS AND Y-BRANCHES AND SHALL PROVIDE STAKES FOR THEM AT THEIR PROPER LOCATIONS WITH STATIONING PLAINLY MARKED. ANY CHANGE IN LOCATION SHALL BE REQUESTED IN WRITING BY THE OWNER OR HIS REPRESENTATIVE. NO REVISIONS SHALL BE MADE IN THESE PLANS WITHOUT THE APPROVAL OF THE COUNTY ENGINEER.
 - USE STANDARD MANHOLE FRAMES AND COVERS, S.A.-117, EXCEPT AS NOTED.
 - USE STANDARD STRENGTH PIPE EXCEPT AS NOTED.
 - USE CURBOUT MANHOLE FOR ALL WITHIN CLAY PIPE JOINTS.
 - RESURFACE ALL TRENCH WITHIN PAVED AREA TO MEET L.A. COUNTY ROAD DEPT. OR CALIF. STATE HIGHWAY DEPT. REQUIREMENTS IN ACCORDANCE WITH PERMITS.
 - SHOULDER FOUR FEET OF SEWER AT POINTS OF INTERFERENCE WITH POLES, S.A.-119.
 - SHOULDER LATERALS TO BE CONSTRUCTED WITH SEWERS AT PROPERTY LINE. SEE PLAN SHOWING CURB GRAB EXCEPT AS NOTED.
 - ALL STRUCTURES SHALL BE BRICK SEWER STRUCTURES, S.A.-194, EXCEPT AS NOTED.
 - FOR ALLOWABLE LEAKAGE TEST USE FORMULA NO. 1, SPEC'S, SEC. 5A.
 - MANHOLE TOPS IN UNIMPROVED RIGHTS-OF-WAY TO BE 6" ABOVE FINISHED GRADE.
 - CONTRACTOR MUST OBTAIN AN EXCAVATION PERMIT FROM THE CITY OF WEST COVINA.

APPROVED: Nov 13, 1956
[Signature] R.E. BAILEY
 SANITATION ENGINEER, CITY OF WEST COVINA

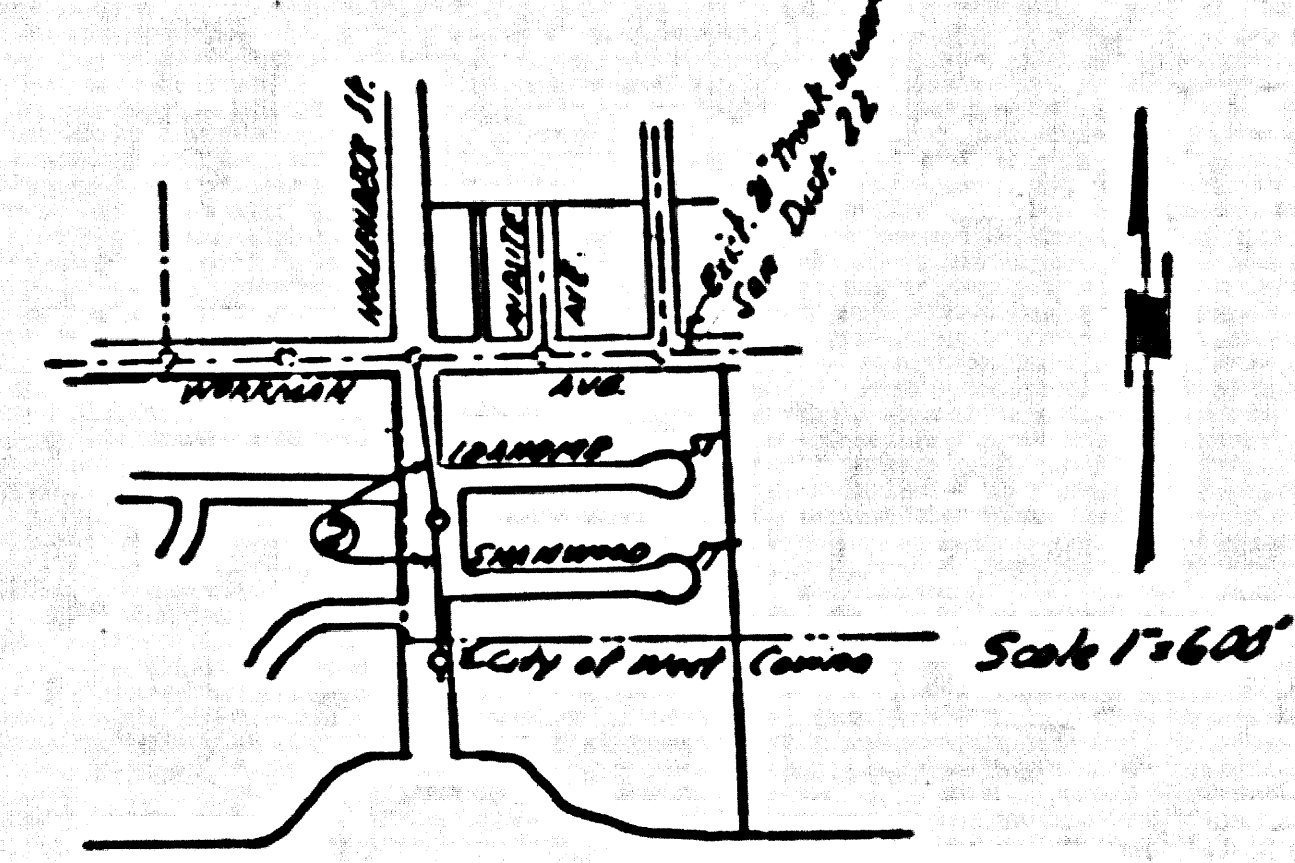

before breaking into any existing structure
 and before final acceptance of this work,
 County Sanitation District should be notified
 in order that required inspection may be made.

PRIVATE CONTRACT NO. 4166
 W.S. 47
 1 SHEET, 2 PAGES
 SCALE: VERT. 1"=4'
 HORIZ. 1"=40' Sept., 1956
 PREPARED IN THE OFFICES OF
HAROLD L. JOHNSON
 REG. C. E. NO. 1668
 FOR LEGEND SEE PLAN NO. S-A-84

NOTES

GRADES TO WHICH THIS IMPROVEMENT IS TO BE CONSTRUCTED ARE SHOWN ON PLANS AND PROFILES. GRADE POINTS FOR TOP OF CURB, CENTER LINE OF STREETS, OR CENTER LINE OF ALLEYS ARE SHOWN BY CIRCLES ON PROFILES AT ALL POINTS BETWEEN DESIGNATED POINTS THE GRADE SHALL BE ESTABLISHED SO AS TO CONFORM TO A STRAIGHT LINE DRAWN BETWEEN SAID DESIGNATED POINTS.

ELEVATIONS ARE IN FEET ABOVE U.S.C. & G.S. SEA LEVEL UNLESS OTHERWISE NOTED.

THE DRAWINGS AND THE DATA HEREON ARE HEREBY MADE A PART OF THE SPECIFICATIONS.

WORK SHALL BE CONSTRUCTED ACCORDING TO SPECIFICATIONS ON FILE IN THE OFFICE OF THE COUNTY ENGINEER AND SHALL BE PROSECUTED ONLY IN THE PRESENCE OF THE COUNTY ENGINEER.

BEFORE WORK CAN BE STARTED, THE CONTRACTOR MUST OBTAIN A PERMIT TO STAYAIN IN COUNTY STREETS FROM THE L.A. COUNTY ROAD DEPT., 116 W. 5TH ST. LOS ANGELES 5, CALIF. WITH THE COUNTY ENGINEER, ROOM 504 MAIN AMERICAN BLDG., L.A. COUNTY ROAD DEPT., 116 W. 5TH ST. LOS ANGELES 5, CALIF. FOR THE LOCATION OF ANY UNDERGROUND UTILITY PIPE, OR STRUCTURE WITHIN THE LIMITS OF THE PROJECT THIS NOTE APPLIES TO ALL PAGES.

IF WORK IS TO BE DONE IN A STATE HIGHWAY, A PERMIT MUST BE OBTAINED FROM THE STATE OF CALIFORNIA, DIVISION OF HIGHWAYS, 128 SOUTH SPRING STREET.

COUNTY OF LOS ANGELES, CALIFORNIA

APPROVED, JOHN A. LAMBE, COUNTY ENGINEER
 APPROVED, A. M. BAWAL, CHIEF ENGINEER
 SANITATION ENGINEER
 BY *[Signature]* BY *[Signature]*
 OFFICE ENGINEER
 CHECKED BY *[Signature]* 12-12-56
 OFFICE OF COUNTY ENGINEER, REG. C. E. NO. 7060

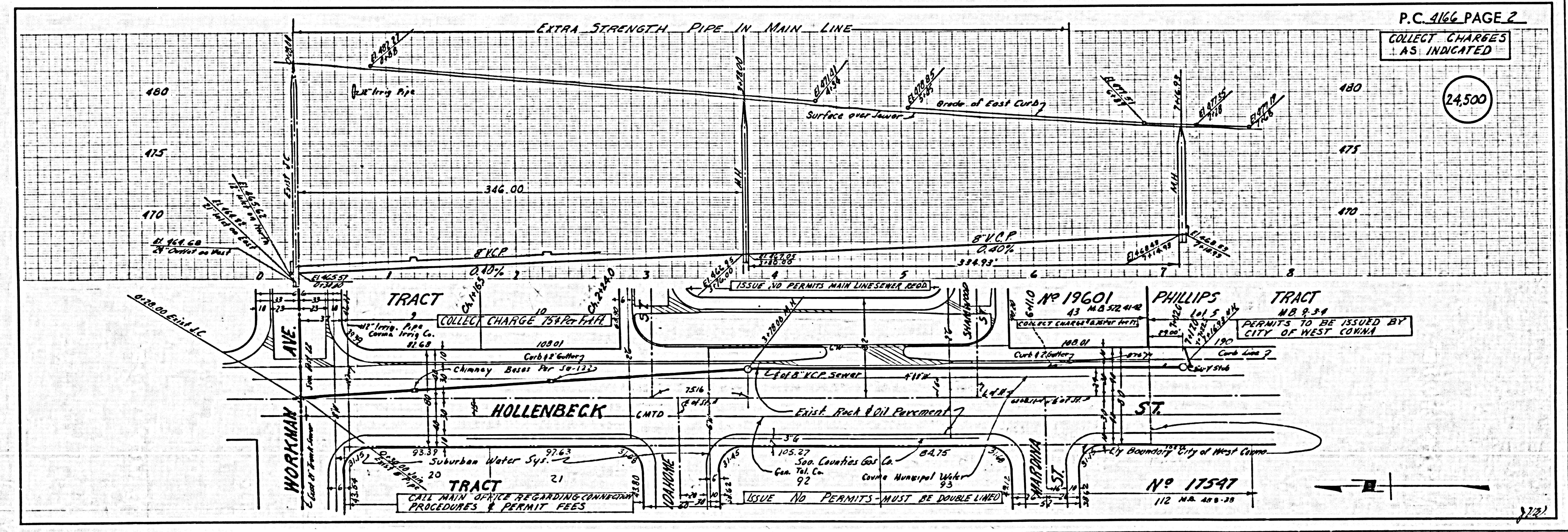

P.C. 4166 PAGE 2
 COLLECT CHARGES
 AS INDICATED

(24.500)

CALL MAIN OFFICE REGARDING CONNECTION PROCEDURES & PERMIT FEES

ISSUE NO PERMITS - MUST BE DOUBLE LINED

PERMITS TO BE ISSUED BY CITY OF WEST COVINA

NO 17547
 112 N.B. 40-38

P.C. 4166
 ZONE CHANGE 24.55
 Rev. 500-41