

BM J-2 F.B. 76337 EL 2392.498
Top of Brass Cap Man. in handwell @
Intersection of Ave J & Division

LANCASTER BLDG. DIST. NO. 8

- NOTES
- PROVIDE GRADE ON THE PROPERTY LINE OR PROPERTY LINE PRODUCE AT RIGHT ANGLES TO THE SEWER LINE AT THE CORNER OF EACH BUILDING.
 - NO REPRESENTATIVE OF THE COUNTY ENGINEER WILL BE ON LOCATE ANY PORTION OF THE WORK.
 - THE OWNER OF THE AUTHORIZED REPRESENTATIVE SHALL FURNISH THE COUNTY ENGINEER WITH GRAB SHEETS AND STATION FOR ALL MAIN LATERALS AND Y BRANCHES AND 18" PIPE STAIRS FOR THOSE AT THESE PROPOSED LOCATIONS WITH STATIONING PLANNED. ANY CHANGE IN LOCATION SHALL BE REQUESTED BY THE OWNER OR THE REPRESENTATIVE.
 - NO REVISIONS SHALL BE MADE IN THESE PLANS WITHOUT THE APPROVAL OF THE COUNTY ENGINEER.
 - USE STANDARD STANDARD FRAME AND COVER, 18" x 11", EXCEPT AS NOTED.
 - USE STANDARD BRICKWORK FOR SEWER AS NOTED.
 - USE CHERRY BROS. FOR ALL OTHERS EXCEPT AS NOTED.
 - REINFORCE ALL TRENCH WITH PERFORATED AREA TO MEET L.A. COUNTY ROAD DEPT. OR CALIF. STATE HIGHWAY DEPT. SPECIFICATIONS IN ACCORDANCE WITH PERMITS.
 - SHALL BE FOR THE USE OF THE COUNTY ENGINEER TO BE CONSTRUCTED WITH PERMITS, 18" x 11", EXCEPT AS NOTED.
 - SHALL BE FOR THE USE OF THE COUNTY ENGINEER TO BE CONSTRUCTED WITH PERMITS, 18" x 11", EXCEPT AS NOTED.
 - ALL STRUCTURES SHALL BE BUILT WITH STRUCTURE, 18" x 11", EXCEPT AS NOTED.
 - FOR ROADWAY BRIDGE USE FORMULA NO. 1, SPEC. SEC. 11.
 - SHOWING TRENCH TO BE CONSTRUCTED WITH PERMITS, 18" x 11", EXCEPT AS NOTED.
 - The owner's Engineer is to furnish the House Lateral depth after property line below the top of curb elevation, for each House Lateral, on the Grade Sheet.
 - DALL ALL PIPE JOINTS THAT ARE WITHIN 20 FEET OF ANY PROPERTY LINE WITH 1/4 INCHES OF CEMENT MORTAR.

NO CHARGE FOR CONNECTIONS
See Section 2.10.56

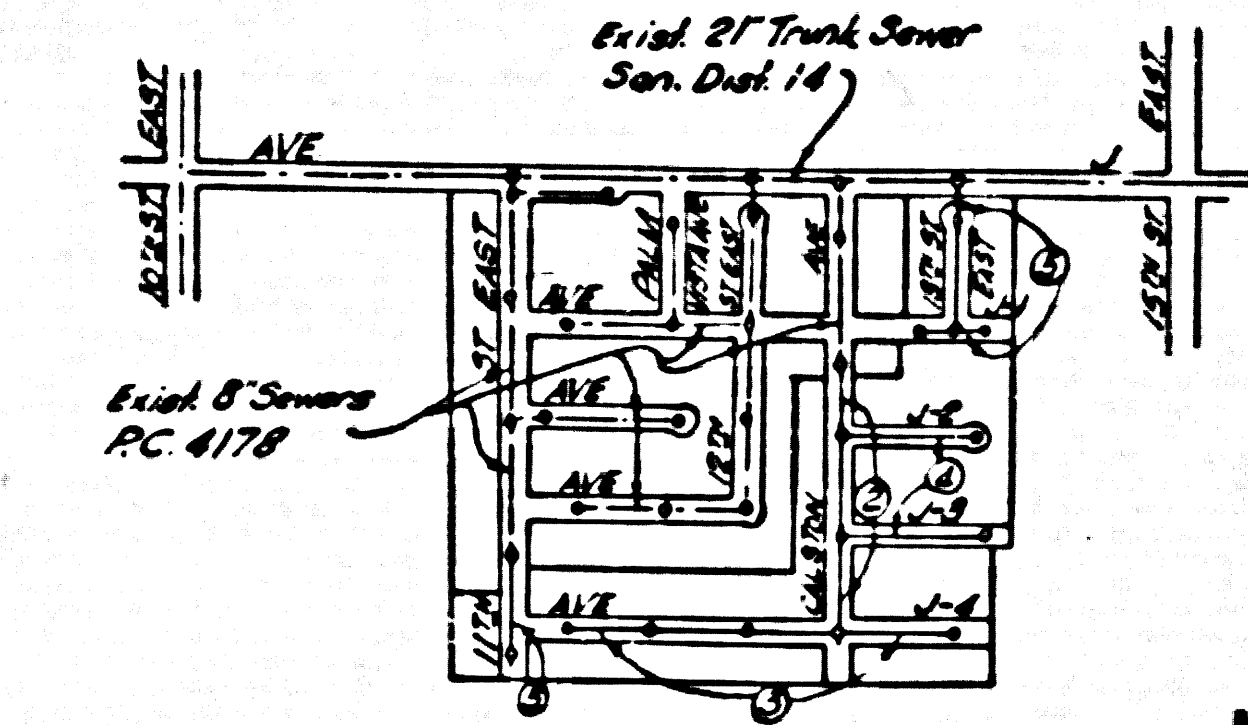

INDEX MAP
TRACT NO. 23319 P.C. 4212
SCALE: 1" = 600'

Before breaking into any existing structure and before final acceptance of this work, County Sanitation District should be notified in order that required inspection may be made.

PROFILE ALIGNMENT AND GRADE OF
SANITARY SEWERS
TO BE CONSTRUCTED IN
TRACT NO. 23319

PRIVATE CONTRACT NO. 4212

W.S. 70
3 SHEETS, 5 PAGES
SCALE: HORIZ. 1" = 40' VERT. 1" = 4' OCT. 1956
PREPARED IN THE OFFICES OF
ACTION ENGINEERING CO.
J. P. Collins
REG. C. E. NO. 1197
FOR LEGEND SEE PLAN NO. S-A-64

BEFORE THIS APPROVEMENT IS TO BE CONSTRUCTED THE ENGINEER HAS REVIEWED THE PLANS AND PROPOSED GRADE POINTS FOR THE SEWER, CENTER LINE OF STREETS, OR CENTER LINE OF ALLEYS AND SHOWN BY CIRCLES ON PROFILES AT ALL POINTS BETWEEN INDICATED POINTS THE GRADE SHALL BE OBSERVED TO BE IN CONFORMANCE WITH A STANDARD AND SHOWN BETWEEN EACH MAIN LATERAL POINTS.

EXPLANATIONS ARE IN THE ABOVE SPECIFICATIONS, BEYOND OF THIS THE DRAWING AND THE DATA HEREON ARE HEREBY MADE A PART OF THE SPECIFICATIONS.

WORK SHALL BE CONSTRUCTED ACCORDING TO SPECIFICATIONS ON FILE IN THE OFFICE OF THE COUNTY ENGINEER AND SHALL BE PROSECUTED ONLY IN THE OFFICE OF THE COUNTY ENGINEER.

IF BEFORE WORK CAN BE STARTED, THE CONTRACTOR MUST OBTAIN A PERMIT TO EXCAVATE IN COUNTY SHEETS FROM THE COUNTY ROAD DEPT. BEFORE WORK IS STARTED. THE CONTRACTOR MUST OBTAIN A PERMIT TO EXCAVATE IN COUNTY SHEETS FROM THE COUNTY ROAD DEPT. BEFORE WORK IS STARTED. THE CONTRACTOR MUST OBTAIN A PERMIT TO EXCAVATE IN COUNTY SHEETS FROM THE COUNTY ROAD DEPT. BEFORE WORK IS STARTED.

IF WORK IS TO BE DONE IN A STATE HIGHWAY, A PERMIT MUST BE OBTAINED FROM THE STATE OF CALIFORNIA, DIVISION OF HIGHWAYS, 120 SOUTH BRIDGE STREET.

COUNTY OF LOS ANGELES, CALIFORNIA

APPROVED, JOHN A. LAMME, COUNTY ENGINEER

APPROVED, A. H. SAWAL, CHIEF ENGINEER

J. P. Collins
SANITATION ENGINEER

J. P. Collins
SANITATION ENGINEER

CHECKED BY: P. S. K... 12-18-56
OFFICE OF COUNTY ENGINEER, BOX 2, S. H. 7860

Removal of 1st Footings
CHECKED BY: J. P. Collins 4-9-57
OFFICE OF THE COUNTY ENGINEER, BOX 2, S. H. 7860

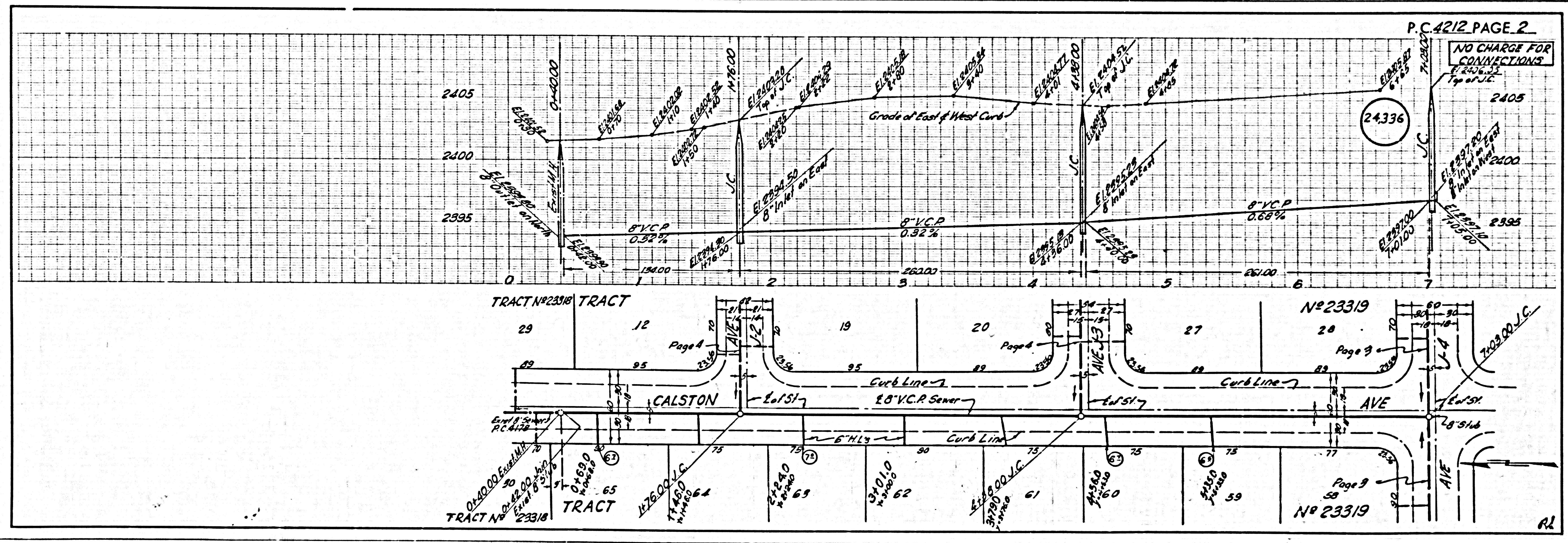

P.C. 4212 PAGE 2

NO CHARGE FOR CONNECTIONS
See Section 2.10.56

P.C. 4212

