

B.V. P.128 E.B.1441-10 E.L1743-16  
 L&T mch. 1/4 of N. end C.R. of the  
 NW Cor. of My St. & 18 Alley N. of Whittier Blvd

WHITTIER BLDG. DIST. NO. 11 (PICO RIVERA)

PROFILE ALIGNMENT AND GRADE OF  
**SANITARY SEWERS** PAGE 1  
 TO BE CONSTRUCTED IN  
 SANITARY SEWER R/W 26573  
 NORTH OF WHITTIER BLVD.

PRIVATE CONTRACT NO. 4225

W.S. 56  
 - 1 SHEET - 2 PAGES  
 SCALE: 1" = 40' DEC. 1958  
 PREPARED BY THE OFFICES OF  
**OLSON SURVEYING SERVICE**

PERMITS TO BE ISSUED BY  
 CITY OF MONTEBELLO

NO CHARGE  
 FOR CONNECTIONS  
 L. Leguina L.S.

- NOTES
- PROVIDE STAKES ON THE PROPERTY LINE OR PROPERTY LINES PROMISED AT RIGHT ANGLES TO THE SEWER LINE AT THE CENTER LINE OF EACH MANHOLE.
  - NO REPRESENTATIVE OF THE COUNTY ENGINEER WILL SURVEY OR LAY OUT ANY PORTION OF THE WORK.
  - THE OWNER OR HIS AUTHORIZED REPRESENTATIVE SHALL FURNISH THE COUNTY ENGINEER WITH CLEAR EVIDENCE AND REASON FOR ALL HOUSE LATERALS AND Y BRANCHES AND SHALL PROVIDE STAKES FOR THEM AT THEIR PROPER LOCATIONS WITH STATION AND PLAINET NUMBER. ANY CHANGE IN LOCATION SHALL BE REQUESTED BY WRITING BY THE OWNER OR HIS REPRESENTATIVE.
  - NO VENTILATION SHALL BE SHOWN IN THESE PLANS WITHOUT THE APPROVAL OF THE COUNTY ENGINEER.
  - USE STANDARD MANHOLE FRAMES AND COVERS, S.A. 117, EXCEPT AS NOTED.
  - USE STANDARD 10" STRENGTH PIPE EXCEPT AS NOTED.
  - USE CHAMFER BRIGHT FOR ALL VITRIFIED CLAY PIPE JOINTS.
  - REINFORCE ALL STRUCTURE WITHIN PAVED AREA TO MEET L. A. COUNTY ROAD B.M.P., OR CALIF. STATE HIGHWAY B.M.P., REQUIREMENTS IN ACCORDANCE WITH PLANS.
  - DISCARD FOUR FEET OF SEWER AT POINTS OF INTERFERENCE WITH POLES, S.A. 117.
  - STANDARD MANHOLE TO BE CONSTRUCTED WITH HYDROTEST AND PROTECTIVE COVER.
  - ALL STRUCTURES SHALL BE BRICK SEWER STRUCTURE, S.A. 194 EXCEPT AS NOTED.
  - FOR ALLOWANCE GRADES THAT USE FORMULA NO. 1, SEE SPEC. SEC. 11.
  - MANHOLE TOPS IN UNPAVED AREAS TO BE 4" ABOVE FINISHED GRADE.

NOTE:  
 THE CONTRACTOR SHALL NOTIFY THE CONSTRUCTION AND STORM DRAIN DIVISION BY TELEPHONE, MADISON 9-4747, EX. 362, AT LEAST 24 HOURS BEFORE STARTING ANY WORK UNDER THIS CONTRACT.

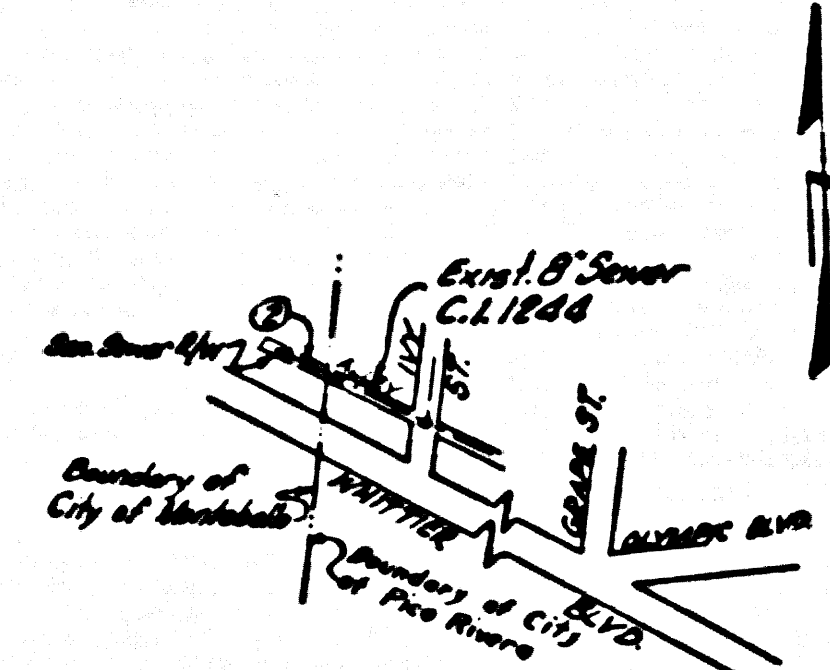

WORK TO WHICH THE IMPROVEMENT IS TO BE CONSTRUCTED AND SHOWN ON PLANS AND PROFILE GRADE POINTS FOR TOP OF CURB, CENTER LINE OF STREET, OR CENTER LINE OF ALLEY AND SECTION IN CIRCLES ON PROFILES AT ALL POINTS BETWEEN MANHOLE POINTS THE GRADE SHALL BE ESTABLISHED AS TO CONFORM TO A STRAIGHT LINE BEING DRAWN BETWEEN SAID MANHOLE POINTS.

MANHOLE TOPS IN PAVED AREAS SHALL BE 4" ABOVE FINISHED GRADE.

THE CONTRACTOR SHALL BE RESPONSIBLE FOR OBTAINING ALL NECESSARY PERMITS FROM THE CITY OF MONTEBELLO AND THE COUNTY ENGINEER. THE CONTRACTOR SHALL OBTAIN A PERMIT TO EXCAVATE IN THE COUNTY ENGINEER AND SHALL BE RESPONSIBLE FOR THE PROTECTION OF ALL UTILITIES UNDER THE STREET AND ALLEY.

THE CONTRACTOR SHALL BE RESPONSIBLE FOR OBTAINING ALL NECESSARY PERMITS FROM THE CITY OF MONTEBELLO AND THE COUNTY ENGINEER. THE CONTRACTOR SHALL OBTAIN A PERMIT TO EXCAVATE IN THE COUNTY ENGINEER AND SHALL BE RESPONSIBLE FOR THE PROTECTION OF ALL UTILITIES UNDER THE STREET AND ALLEY.

COUNTY OF LOS ANGELES, CALIFORNIA  
 APPROVED, JOHN A. LAMBE, COUNTY ENGINEER  
 APPROVED, A. H. BAWK, CHIEF ENGINEER  
 CHECKED BY: J. A. LAMBE - 1-6-58  
 OFFICE OF COUNTY ENGINEER, 800 C.E. NO. 3871

REVISED 12-11-58 MANHOLE MOVED  
 FROM STATION 12+50.00 TO 11+00.00  
 APPROVED: J. A. LAMBE 12-12-58  
 LOS ANGELES REGIONAL ENGINEER, E.V.O. C.E. NO. 3871

APPROVED, CITY OF MONTEBELLO  
 JANUARY 31, 1959  
 E.C. 10750

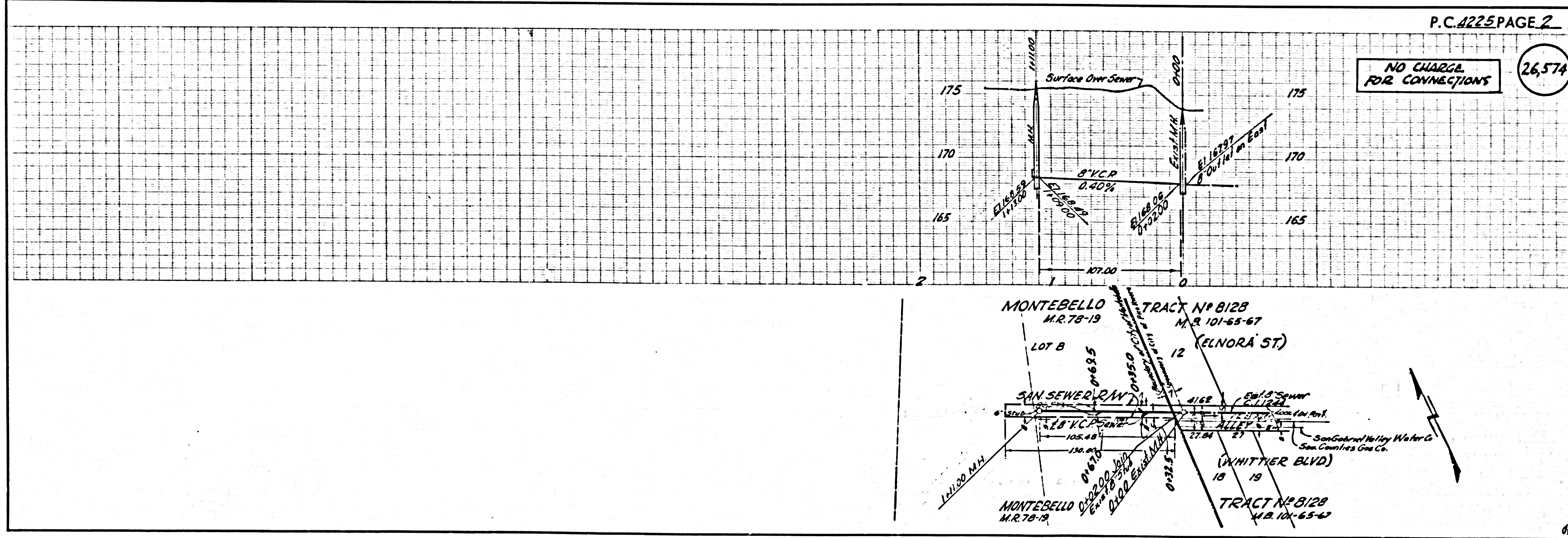

NO CHARGE  
 FOR CONNECTIONS  
 26574