

WHITTIER BLDG. DIST. NO. 11

PROFILE ALIGNMENT AND GRADE OF P.C. 4227
 SANITARY SEWERS PAGE 1
 TO BE CONSTRUCTED IN

TRACT No. 23459 (24451)

PRIVATE CONTRACT NO. 4227
 W.S. 38

2 SHEETS, 5 PAGES
 SCALE: HORIZ. 1" = 40' VERT. 1" = 4'

PREPARED IN THE OFFICES OF
 KEMMERER ENGINEERING CO., INC.
 By: *John C. Roman*
 M.C.E. NO. 8166

FOR LEGEND SEE PLAN NO. S-A-64

- NOTES
1. PROPERTY STAKES ON THE PROPERTY LINE OR PROPERTY LINES PRODUCED AT RIGHT ANGLES TO THE SEWER LINE AS THE CENTER LINE OF EACH MAINLINE.
 2. NO DIMENSIONS OF THE COUNTY ENGINEER WILL SURVEY OR LAYOUT ANY PORTION OF THE WORK.
 3. THE OWNER OR HIS AUTHORIZED REPRESENTATIVE SHALL FURNISH THE COUNTY ENGINEER WITH GRADE SHEETS AND STATION FOR ALL HOUSE LATERALS AND T-BRANCHES AND SHALL PROVIDE STAKES FOR THEM AT THESE PROPOSED LOCATIONS WITH STATION AND PLAINED BARRERS. ANY CHANGE IN LOCATION SHALL BE REQUESTED BY WRITING BY THE OWNER OR HIS REPRESENTATIVE.
 4. NO REVISIONS SHALL BE MADE IN THESE PLANS WITHOUT THE APPROVAL OF THE COUNTY ENGINEER.
 5. USE STANDARD STANDARD PIPES AND COVING, S.A.-117, EXCEPT AS NOTED.
 6. USE CHERRY HORTON FOR ALL WITHIN CLAY PIPE EXCEPT AS NOTED.
 7. SURFACE ALL TRENCH WITHIN PAVED AREAS TO MEET L.A. COUNTY ROAD DEPT. OR CALIF. STATE HIGHWAY DEPT. REQUIREMENTS IN ACCORDANCE WITH PERMITS.
 8. INDICATE FOUR FEET OF SEWER AT POINTS OF INTERFERENCE WITH POLES, S.A.-119.
 9. HOUSE LATERALS TO BE CONSTRUCTED WITH INVERTS AT PROPERTY LINE. SEE PLAN FOR CURB GRADE EXCEPT AS NOTED.
 10. ALL STRUCTURES SHALL BE BRICK OR CONCRETE STRUCTURES, S.A.-194, EXCEPT AS NOTED.
 11. FOR ALLOWABLE LEAKAGE TEST USE FORMULA NO. 1, S.P.C. 1, SEC. 14.
 12. HANDLE TOPS IN UNIMPROVED RIGHTS-OF-WAY TO BE 6" ABOVE FINISHED GRADE.
 13. THE PRIVATE ENGINEER IS TO FURNISH THE HOUSE LATERAL SERVICE AT THE PROPERTY LINE BELOW THE TOP OF CURB ELEVATION FOR EACH HOUSE LATERAL ON THE GRADE SHEET.

8 M. C.S. 38-2, HACIENDA BLVD. & L.A. ORANGE CO. LINE 2, INTER. @ 5th, Precast Man. 3 below the surface, and protected by a cast iron cover - California County Surveyors' Manual - 1954 ADJ. ELEV. 425.00' L.A. Co. ELEV. T.B. 1953-9

NO CHARGE FOR CONNECTIONS
See plan S-A-57

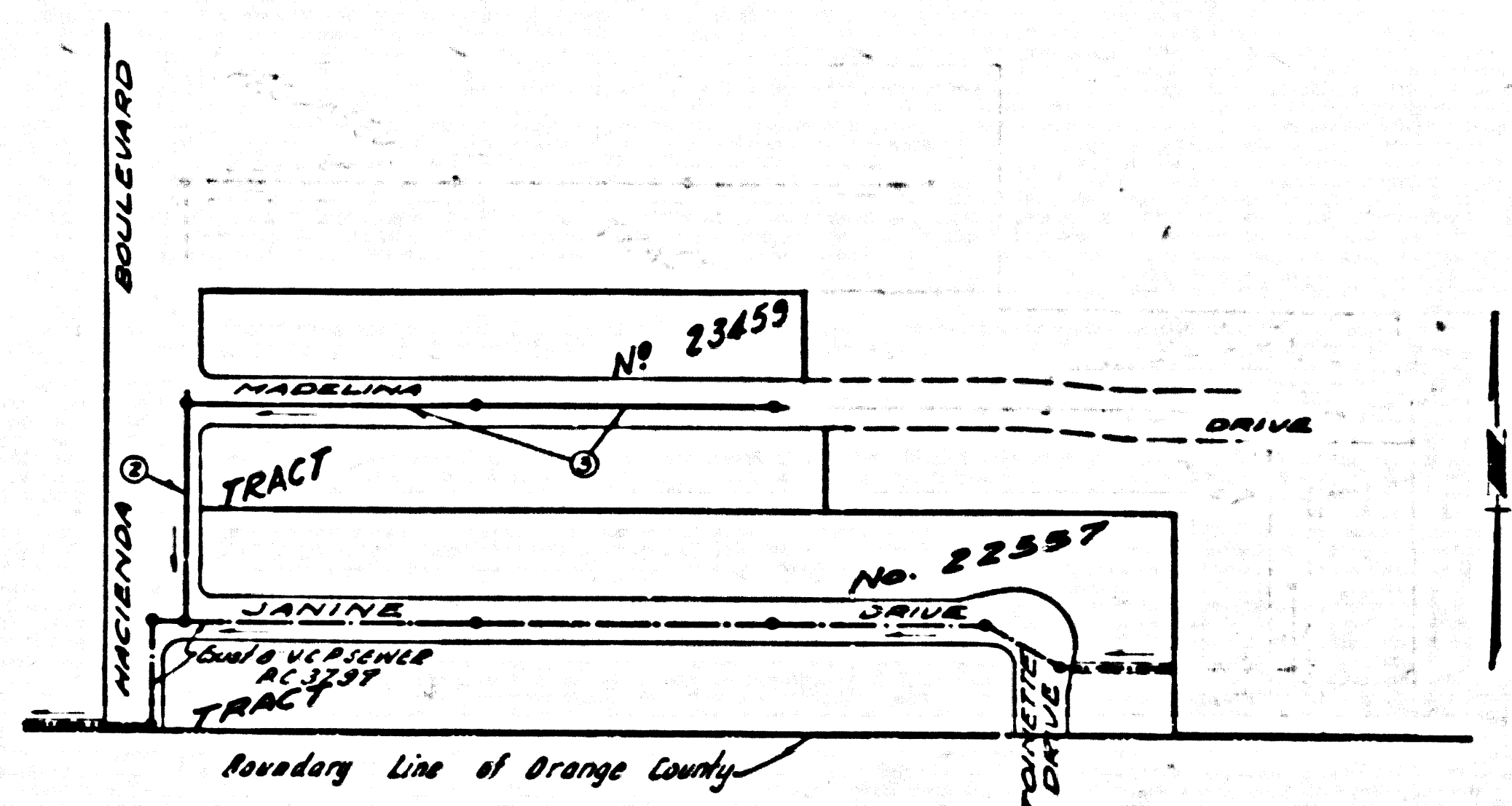

INDEX MAP
 TRACT No. 23459
 PC 4227 Scale: 1" = 200'

NOTES

GRADES TO WHICH THIS IMPROVEMENT IS TO BE CONSTRUCTED ARE SHOWN ON PLANS AND PROFILES. GRADE POINTS FOR TOP OF CURB, CENTER LINE OF STREET, OR CENTER LINE OF ALLEY ARE SHOWN BY CIRCLES ON PROFILES AT ALL POINTS BETWEEN REMARKED POINTS THE GRADE SHALL BE ESTABLISHED AS TO CONFORM TO A STRAIGHT LINE BETWEEN SAID REMARKED POINTS.

STATIONING AND INVERT ABOVE M.S.L. & S.A. 254 LEVEL, EXCEPT AS NOTED.

THIS DRAWING AND THE DATA HEREON ARE HEREBY MADE A PART OF THE SPECIFICATION.

WORK SHALL BE CONSTRUCTED ACCORDING TO SPECIFICATIONS ON FILE IN THE OFFICE OF THE COUNTY ENGINEER AND SHALL BE INSPECTED ONLY IN THE PRESENCE OF THE COUNTY ENGINEER.

BEFORE WORK CAN BE STARTED, THE CONTRACTOR MUST OBTAIN A PERMIT TO EXCAVATE IN COUNTY RIGHTS FROM THE L.A. COUNTY ROAD DEPT. 100 W. 3rd St. AND MAKE A REPORT WITH THE COUNTY ENGINEER, ROOM 234 PAN AMERICAN BUILDING 138 SO. BROADWAY REFERRED TO COVER THE COST OF CONSTRUCTION INSPECTION AND EXPOSE PLANS.

APPROVAL OF THIS PLAN BY THE COUNTY OF LOS ANGELES DOES NOT CONSTITUTE A REPRESENTATION AS TO THE ACCURACY OF THE LOCATION OF OR THE EXISTENCE OR NON-EXISTENCE OF ANY UNRECORDED EASEMENTS, RIGHTS, OR INTERESTS WITHIN THE LIMITS OF THIS PROJECT. THE BUYER AGREES TO ALL THESE.

IF WORK IS TO BE DONE ON A STATE HIGHWAY, A PERMIT MUST BE OBTAINED FROM THE STATE OF CALIFORNIA, DIVISION OF HIGHWAYS, 128 SOUTH SPRING ST., SACRAMENTO, CALIF.

COUNTY OF LOS ANGELES, CALIFORNIA

APPROVED, JOHN A. LAMBE, COUNTY ENGINEER
 APPROVED, A. M. BAWIN, CHIEF ENGINEER
 BY: *J. P. Collins* SANITATION ENGINEER
 BY: *J. P. Collins* CHIEF ENGINEER
 CHECKED BY: *Sk. W. ...*
 OFFICE OF COUNTY ENGINEER, M.C.E. NO. 2646

P.C. 4227 PAGE 2

NO CHARGE FOR CONNECTIONS

(24452)

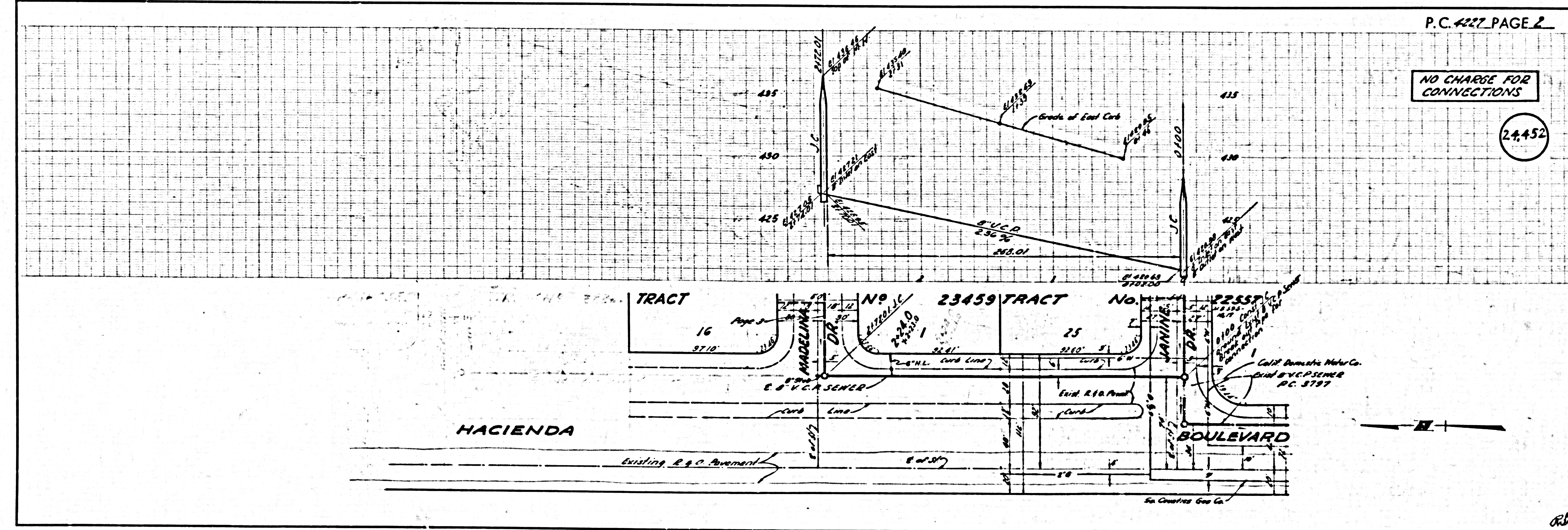

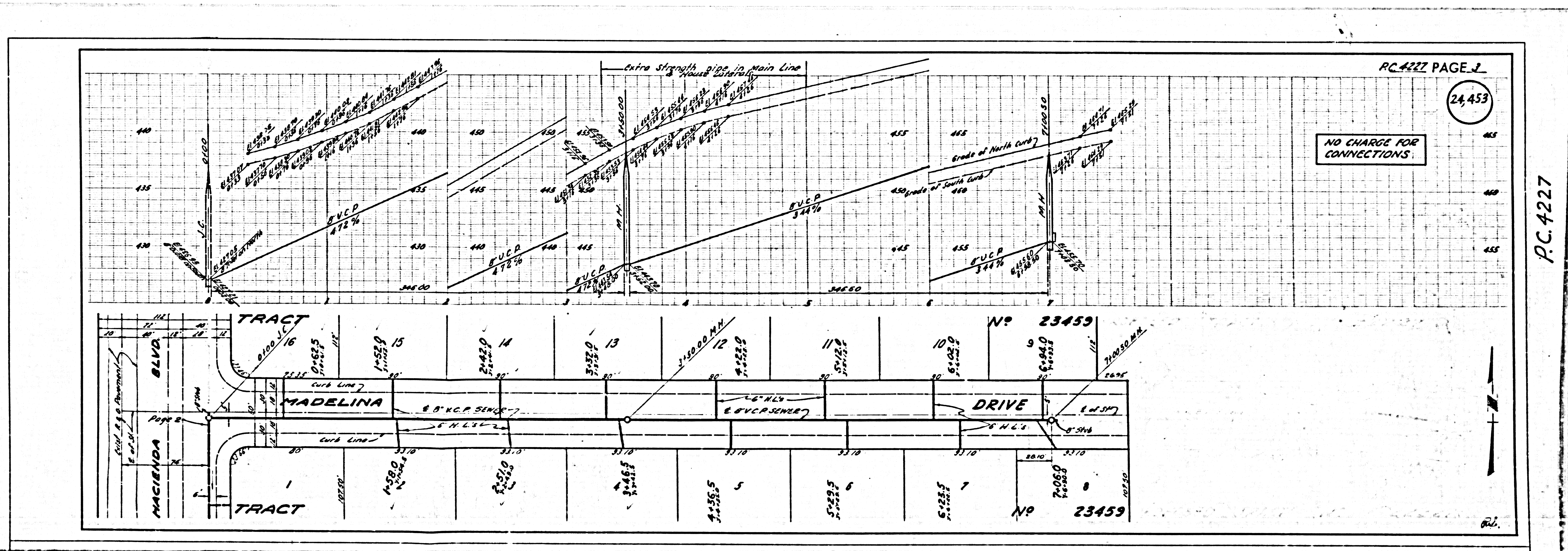

PC 4227 PAGE 2

24,453

NO CHARGE FOR CONNECTIONS

PC 4227