

County Surveyor B.M. 56-2 Co. Precise Survey 1933 Adj. Elev. 355.588 Add 6.055' To All Elevations Shown Hereon To Agree With 1933 Adjustment.

DOUBLE SCALE

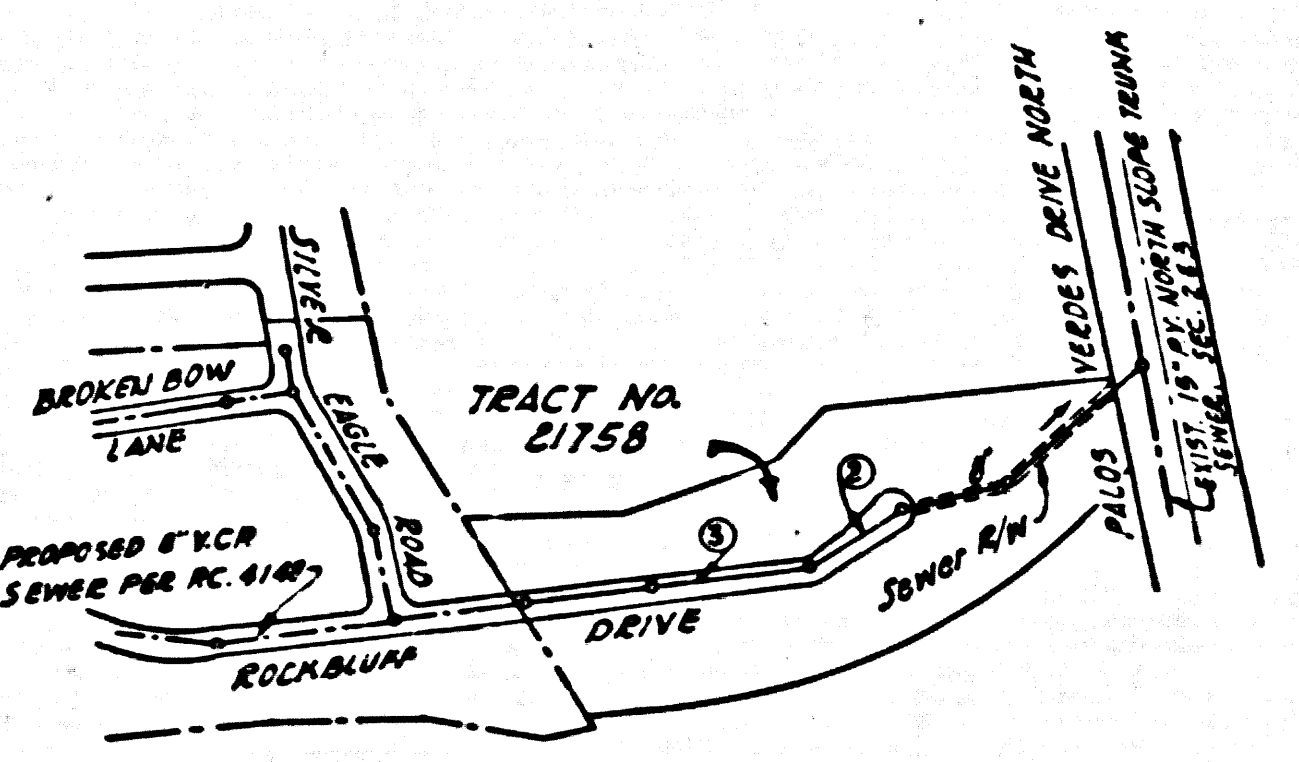

INDEX MAP
TRACT 21758
Scale 1"=400'
P.C. 4228

NO CHARGE FOR CONNECTIONS
Date 1-24-57

before breaking into any existing structure and before final acceptance of this work. County Sanitation District should be notified in order that required inspection may be made.

LOMITA BLDG. DIST. NO. 7.1

- NOTE:
- PROVIDE GRADES ON THE PROPERTY LINE OR PROPERTY LINES PRODUCED AT RIGHT ANGLES TO THE SEWER LINE AT THE CENTER LINE OF EACH MANHOLE.
 - NO REPRESENTATIVE OF THE COUNTY ENGINEER WILL SURVEY OR LAYOUT ANY PORTION OF THE WORK.
 - THE OWNER OR HIS AUTHORIZED REPRESENTATIVE SHALL FURNISH THE COUNTY ENGINEER WITH GRADE SHEETS AND STATION FOR ALL HOUSE LATERALS AND 7' MANHOLES AND SHALL PROVIDE STAKES FOR THESE AT THESE PROPER LOCATIONS WITH STANDARD PLAINLY MARKED. ANY CHANGE IN LOCATION SHALL BE INDICATED BY STAKES BY THE OWNER OR HIS REPRESENTATIVE.
 - NO REVISIONS SHALL BE MADE IN THESE PLANS WITHOUT THE APPROVAL OF THE COUNTY ENGINEER.
 - USE STANDARD MANHOLE FRAMES AND COVERS, 6-11/2" DEPTH AS NOTED.
 - USE STANDARD STRENGTH PIPE EXCEPT AS NOTED.
 - USE CHAMFER NOTCH FOR ALL VITRIFIED CLAY PIPE JOINTS.
 - RESURFACE ALL TRENCH WITHIN PAVED AREA TO MEET L. A. COUNTY ROAD DEPT. OR CALIF. STATE HIGHWAY DEPT. SPECIFICATIONS IN ACCORDANCE WITH POINTS.
 - INDICATE FOUR (4) FEET OF COVER AT POINTS OF INTERFERENCE WITH POLES, 6-11/2"
 - HOUSE LATERALS TO BE CONSTRUCTED WITH MANHOLE AT PROPERTY LINE 7' FEET BELOW CURB GRADE EXCEPT AS NOTED.
 - ALL STRUCTURES SHALL BE BRICE SEWER STRUCTURES, E.G.-R.I. EXCEPT AS NOTED.
 - FOR ALTERNATE SIZES USE FORMULA NO. 1 SPEC. SEC. 11.
 - MANHOLE TOPS IN UNIMPROVED PORTS OF WAY TO BE 6" ABOVE FINISHED GRADE.
 - (a) NO CONSTRUCTION WILL BE PERMITTED IN FILLED AREAS UNLESS ACCEPTABLE CERTIFICATION IS SUBMITTED TO THE CONSTRUCTION DIVISION OF THE COUNTY ENGINEER'S DEPARTMENT THAT COMPACTION IS GREATER THAN 80%.
 - (b) IF COMPACTION IS LESS THAN 80%, THE SEWER MUST BE CRADLED AS SHOWN ON PLAN.
 - (c) IF COMPACTION IS GREATER THAN 90%, CRADLING IS NOT REQUIRED, HOWEVER JOINT COMPOUND MUST BE SUBSTITUTED FOR CEMENT MORTAR FOR ALL JOINTS IN FILLED AREAS.
 - THE PRIVATE ENGINEER IS TO FURNISH THE HOUSE LATERAL DEPTH AT THE PROPERTY LINE BELOW THE (TOP OF CURB ELEVATION) FOR EACH HOUSE LATERAL ON THE GRADE SHEET.

ENGINEERING SERVICE CORPORATION 1127 W. WASHINGTON BLVD. LOS ANGELES 15, CALIF. B. 9-7381	
REVISIONS	TRACED BY M.M. C. 211
	DES'G'D BY B.B.
	C.K'D BY
	SUBMITTED
SUB STRUCTURES OK'D	
W. O. NO.	DWG. NO.
6777-34	11
DATE	SCALE
OCT. '56	AS SHOWN
L.R.	P.B.

PROFILE ALIGNMENT AND GRADE OF SANITARY SEWERS TO BE CONSTRUCTED IN

TRACT No 21758

PRIVATE CONTRACT NO. 4228

W.S. 27
2 SHEETS, 3 PAGES
SCALE: HORIZ. 1"=40' VERT. 1"=4' NOVEMBER 1956

PREPARED IN THE OFFICES OF ENGINEERING SERVICE CORPORATION

C. F. Koenig
C. E. NO. 3652

FOR LEGEND SEE PLAN NO. S-A-64

GRADES TO WHICH THIS IMPROVEMENT IS TO BE CONSTRUCTED ARE SHOWN ON PLANS AND PROFILES. GRADE POINTS FOR TOP OF CURB, CENTER LINE OF STREET, OR CENTER LINE OF ALLEY ARE SHOWN BY CIRCLES ON PROFILES. AT ALL POINTS BETWEEN REGULARLY SPACED GRADE POINTS THE GRADE SHALL BE INTERPOLATED SO AS TO CONFORM TO A STRAIGHT LINE BETWEEN ADJACENT GRADE POINTS.

REVISIONS ARE BY PERMITS U.S.C. & G.S. SEA LEVEL DATUM OF 1929. THE MEASUREMENT AND DATA HEREON ARE HEREBY MADE A PART OF THE SPECIFICATIONS. WORK SHALL BE CONSTRUCTED ACCORDING TO SPECIFICATIONS ON FILE IN THE OFFICE OF THE COUNTY ENGINEER AND SHALL BE PROSECUTED ONLY IN THE PRESENCE OF THE COUNTY ENGINEER.

BEFORE WORK CAN BE STARTED, THE CONTRACTOR SHALL OBTAIN A PERMIT TO EXCAVATE IN COUNTY STREETS FROM THE L. A. COUNTY ROAD DEPT. AND FROM THE COUNTY ENGINEER. WORK WITHIN THE COUNTY ENGINEER'S JURISDICTION SHALL BE IN ACCORDANCE WITH THE L. A. COUNTY ROAD DEPT. LAW OF THIS CITY AND SHALL BE SUBJECT TO THE COUNTY ENGINEER'S JUDICIAL AND ADMINISTRATIVE SUPERVISION. THE CONTRACTOR SHALL BE RESPONSIBLE FOR THE ACCURACY OF THE LOCATION OF OR THE EXISTENCE OR NON-EXISTENCE OF ANY UNDERGROUND UTILITY PIPE, OR STRUCTURE WITHIN THE LIMITS OF THE PROJECT. THE USER SHALL BE RESPONSIBLE FOR THE ACCURACY OF THE LOCATION OF OR THE EXISTENCE OF ANY UNDERGROUND UTILITY PIPE, OR STRUCTURE WITHIN THE LIMITS OF THE PROJECT. THE USER SHALL BE RESPONSIBLE FOR THE ACCURACY OF THE LOCATION OF OR THE EXISTENCE OF ANY UNDERGROUND UTILITY PIPE, OR STRUCTURE WITHIN THE LIMITS OF THE PROJECT.

COUNTY OF LOS ANGELES, CALIFORNIA

APPROVED, JOHN A. LAMBE, COUNTY ENGINEER

APPROVED, A. H. PAWEL, CHIEF ENGINEER

BY C. F. Koenig, ENGINEER

CHECKED BY S. K. White, 1-23-57

OFFICE OF COUNTY ENGINEER, R.M. C. & NO. 3464

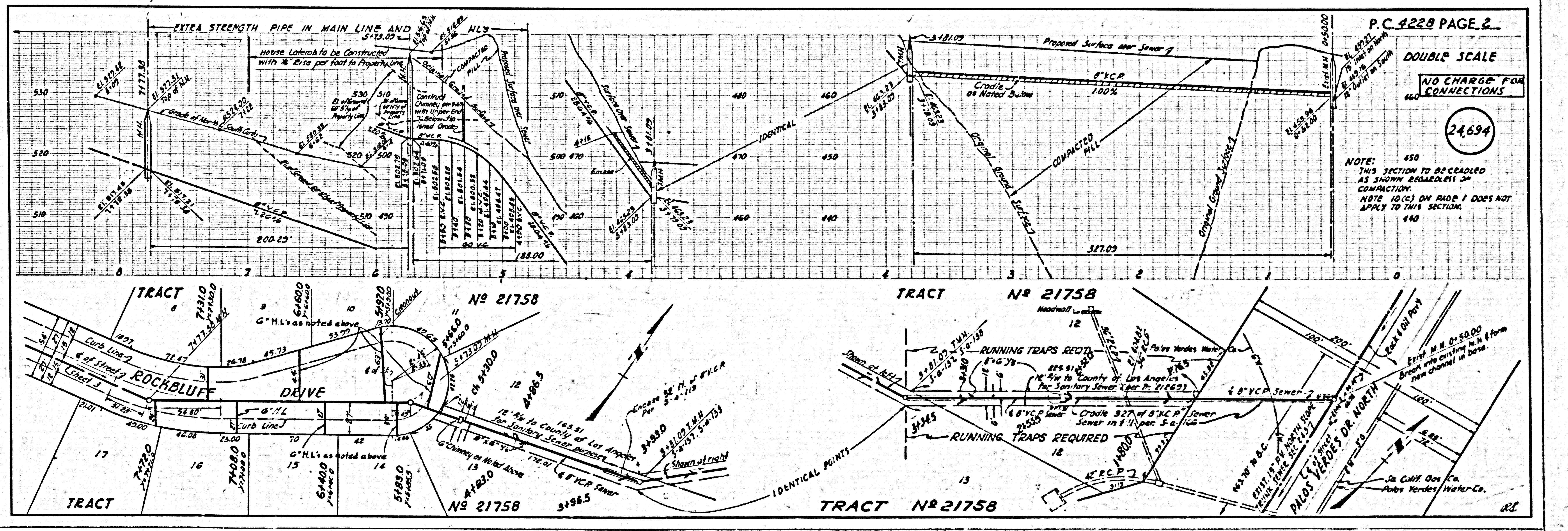

P.C. 4228 PAGE 2

DOUBLE SCALE

NO CHARGE FOR CONNECTIONS

24694

NOTE: THIS SECTION TO BE CRADLED AS SHOWN REGARDLESS OF COMPACTION. NOTE: 10' (3) ON ROAD 1 DOES NOT APPLY TO THIS SECTION.

