

EAST LOS ANGELES BLDG. DIST. NO. 6

PROFILE ALIGNMENT AND GRADE OF P.C. 4239
 SANITARY SEWERS PAGE 1
 TO BE CONSTRUCTED IN
 MAPLE AVENUE
 SANITARY SEWER RIGHT OF WAY

PRIVATE CONTRACT NO. 4239

W.S. 36
 1 SHEETS, 2 PAGES

SCALE: HORIZONTAL 1" = 40' VERTICAL 1" = 4'

NOVEMBER, 1956

PREPARED IN THE OFFICES OF
 CAL ENGINEERS
 Russell C. Sedberry
 REG. NO. 6322

FOR LEGEND SEE PLAN NO. S-A-64

- NOTES:
1. PROFILE GRADES ON THE PROPERTY LINE OR PROPERTY LINES FRONTED AT RIGHT ANGLES TO THE SEWER LINE AT THE CENTER LINE OF EACH PARCEL.
 2. NO REPRESENTATIVE OF THE COUNTY ENGINEER WILL SURVEY OR LAYOUT ANY PORTION OF THE WORK.
 3. THE OWNER OR HIS AUTHORIZED REPRESENTATIVE SHALL FURNISH THE COUNTY ENGINEER WITH GRADE POINTS AND STATION FOR ALL HOUSE LATERALS AND Y BRANCHES AND SHALL FURNISH STAKES FOR THESE AT THESE PROPER LOCATIONS WITH STATIONING PLAINLY MARKED. ANY CHANGE IN LOCATION SHALL BE REQUESTED IN WRITING BY THE OWNER OR HIS REPRESENTATIVE.
 4. NO REVISIONS SHALL BE MADE IN THESE PLANS WITHOUT THE APPROVAL OF THE COUNTY ENGINEER.
 5. USE STANDARD MANHOLE FRAMES AND COVERS, S.A-119, EXCEPT AS NOTED.
 6. USE STANDARD BRICKWORK PIPE EXCEPT AS NOTED.
 7. USE CHAMFER JOISTS FOR ALL VITRIFIED CLAY PIPE JOINTS.
 8. RESURFACE ALL TRENCH WITHIN PAVED AREA TO MEET L.A. COUNTY ROAD DEPT. OR C.T. STATE HIGHWAY DEPT. BRIDGE, GRADES BY ACCORDANCE WITH PERMITS.
 9. BRIDGE OVER FREE OF SEWER AT POINTS OF INTERFERENCE WITH POLE, S.A-119.
 10. BRIDGE LATERALS TO BE CONSTRUCTED WITH JOISTS AS PROPOSED. SEE BRIDGE OVER GRADE SHEET AS NOTED.
 11. ALL STRUCTURES SHALL BE BRICK SEWER STRUCTURES, S.A-104, EXCEPT AS NOTED.
 12. FOR ALLOWABLE BRIDGE TEST USE FORMULA NO. 1, SPEC. SEC. 06.
 13. MANHOLE TOPS IN UNIMPROVED RIGHTS-OF-WAY TO BE 4" ABOVE FINISHED GRADE.

NOTE:
 THE CONTRACTOR SHALL NOTIFY THE CONSTRUCTION & STORM DRAIN DIVISION BY TELEPHONE, MADISON 94747, EXT. 362, AT LEAST 24 HRS. BEFORE STARTING ANY WORK UNDER THIS CONTRACT.

INDEX TABLE	
SHEET	PAGES
1	2

NO CHARGE FOR CONNECTIONS
 - J. W. Minkler 5-18-57 -

B.M. 57-944 L.A. Co. Rd. Dept. Elev. 174.647
 6' Int. Van Ave. and Washington Blvd.
 6" cast cap in standard man box

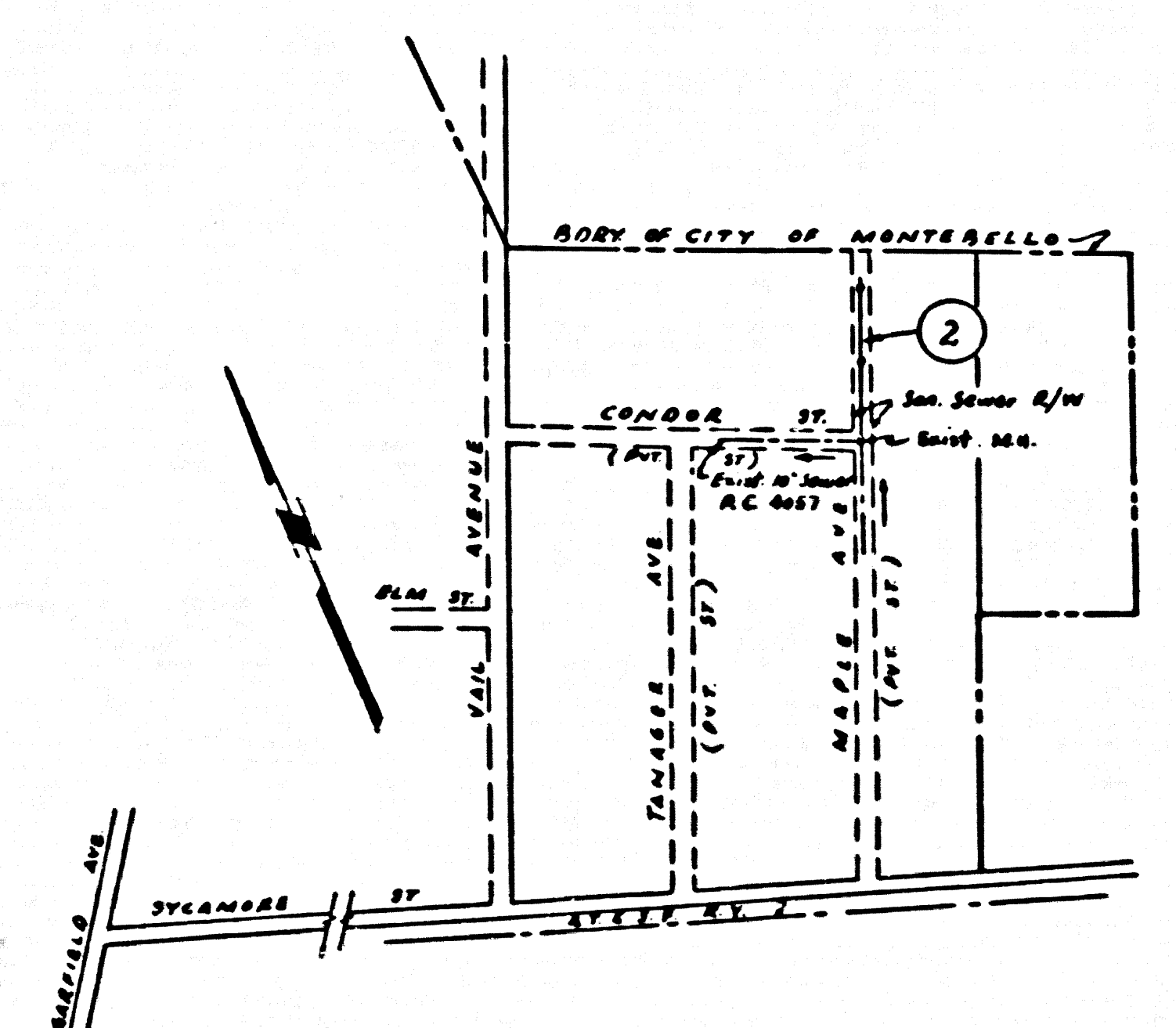

INDEX MAP
 SCALE 1" = 666'
 MAPLE AVE. B/W EXT.
 P.C. 4239

P.C. 4239 PAGE 2

NO CHARGE FOR CONNECTIONS

24752

