

B.M. # 8 Elev. 117.553 F.B. 2228, pp. 33
 3rd. Ave. @ 6th St. N.W. cor.
 21' 1/2" in curb, 13' W of E. end
 For additional B.M.'s used on this improvement, see printed list

CAPITAL PROJECT NO. 8855.02
 PROFILE, ALIGNMENT AND GRADE OF
SANITARY SEWERS
 TO BE CONSTRUCTED IN

24,987

JOHN ANSON FORD PARK
 P.C. 4273

PAGE 1 OF 3 PAGES

SCALE VERT. 1" = 4 FT. HORIZ. 1" = 40 FT. MARCH, 1957

COUNTY OF LOS ANGELES, CALIFORNIA

JOHN A. LAMBIE COUNTY ENGINEER

SUBMITTED *C. H. Hughes* ASSISTANT SANITATION ENGINEER APPROVED *A. M. Rawns* SANITATION ENGINEER

A. M. RAWNS
 CHIEF ENGINEER OF COUNTY
 SANITATION DISTRICT NO. 8
 BY *A. M. Rawns* OFFICE ENGINEER

- FIRESTONE BUILDING DISTRICT NO. 1**
- USE STANDARD STRENGTH PIPE EXCEPT AS NOTED.
 - USE CEMENT MORTAR FOR ALL VITRIFIED CLAY PIPE JOINTS.
 - CONSTRUCT HOUSE LATERALS WITH INVERTS AT CURB, OR PROPERTY LINE FEET BELOW CURB GRADE, OR GRADE OF CENTER LINE OF STREET EXCEPT AS NOTED.
 - CONSTRUCT HOUSE LATERALS WITH 1/4 INCH RISE PER FT. TO PROPERTY LINE, EXCEPT AS NOTED.
 - ALL STRUCTURES SHALL BE BRICK SEWER STRUCTURES AS PER PLAN NO. S-A-130, EXCEPT AS NOTED.
 - USE STANDARD MANHOLE FRAMES AND COVERS AS PER PLAN NO. S-A-131, EXCEPT AS NOTED.
 - RESURFACE TRENCH WITHIN PAVED AREA WITH PREMIX ROCK AND OIL 3 INCHES IN THICKNESS EXCEPT AS NOTED.
 - FIGURES IN CIRCLES AT ENDS OF HOUSE LATERALS INDICATE DEPTH BELOW CURB GRADE, OR GRADE OF CENTER LINE OF STREET.
 - CONSTRUCTION IN STATE HIGHWAYS SHALL CONFORM WITH STATE HIGHWAY PERMIT.
 - USE FORMULA NO. 1 SEC. 54 OF SPECIFICATIONS TO COMPUTE ALLOWABLE LEAKAGE.

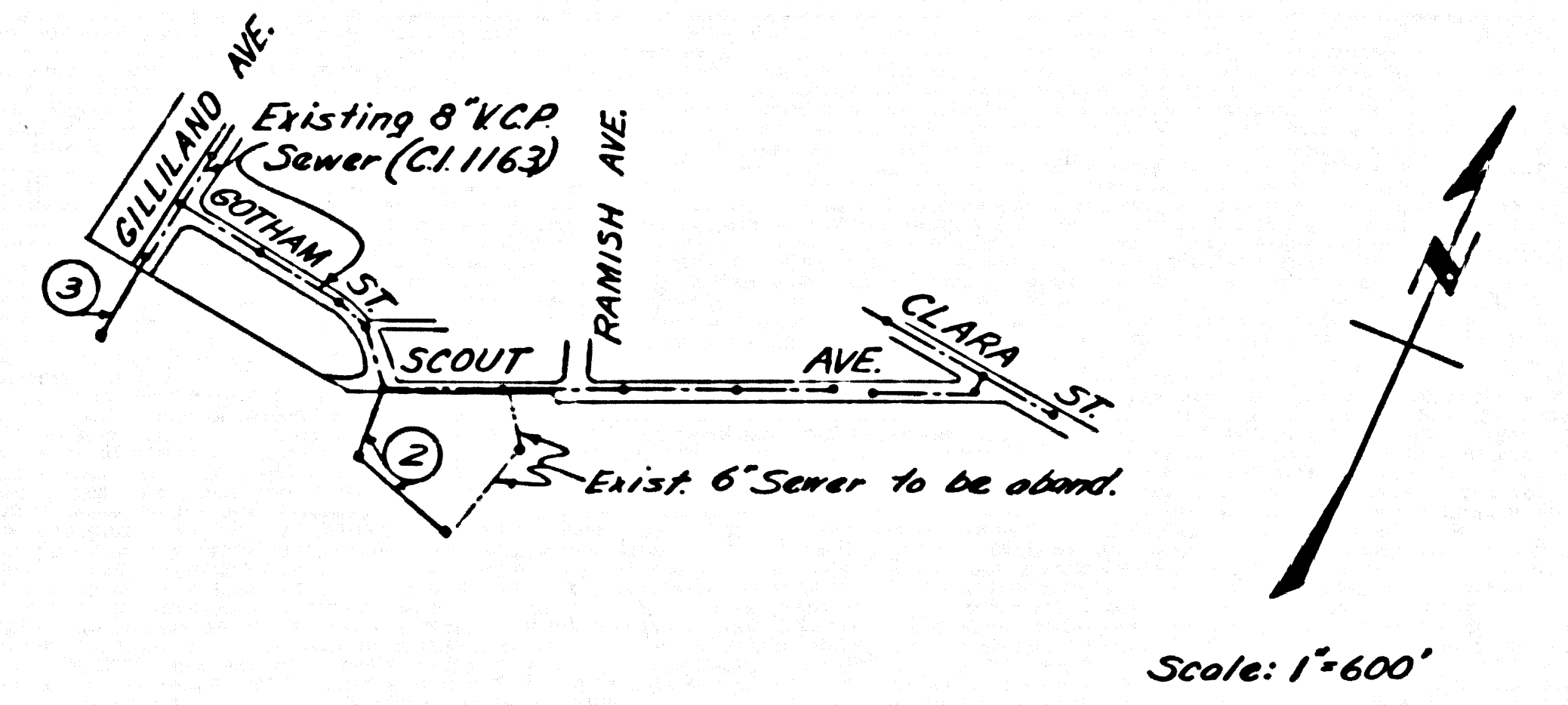

INDEX MAP
 CAPITAL PROJECT NO. 8855.02
 P.C. 4273

FOR LEGEND
 SEE PLAN NO. S-A-64

NOTE: GRADES TO WHICH THIS IMPROVEMENT IS TO BE CONSTRUCTED ARE SHOWN ON PLANS AND PROFILES. GRADE POINTS FOR TOP OF CURB, CENTER LINE OF STREET OR COVER LINE OF ALLEY ARE SHOWN BY CIRCLES OR PROFILES. AT ALL POINTS BETWEEN DESIGNATED POINTS THE GRADE SHALL BE ESTABLISHED SO AS TO CONFORM TO A STRAIGHT LINE BETWEEN SAID DESIGNATED POINTS.

REFERENCES ARE IN FEET ABOVE U. S. C. & G. S. SEA LEVEL DATUM AS OF 1929.

SMALL PORTIONS OF ADDITIONAL WORK WHICH MAY BE SHOWN BUT WHICH CANNOT BE ASCERTAINED IN ADVANCE, SHALL BE SHOWN IN THE PROFILES.

THIS DRAWING AND THE DATA HEREON ARE HEREBY MADE A PART OF THE SPECIFICATIONS.

REFERENCES			
W. S. 36	DESIGNED	KRIEGL	MAR, 1957
A. B.	TRACED	W. BROWER	MAR, 1957
F. B.	CHECKED	KRIEGL	APRIL, 1957

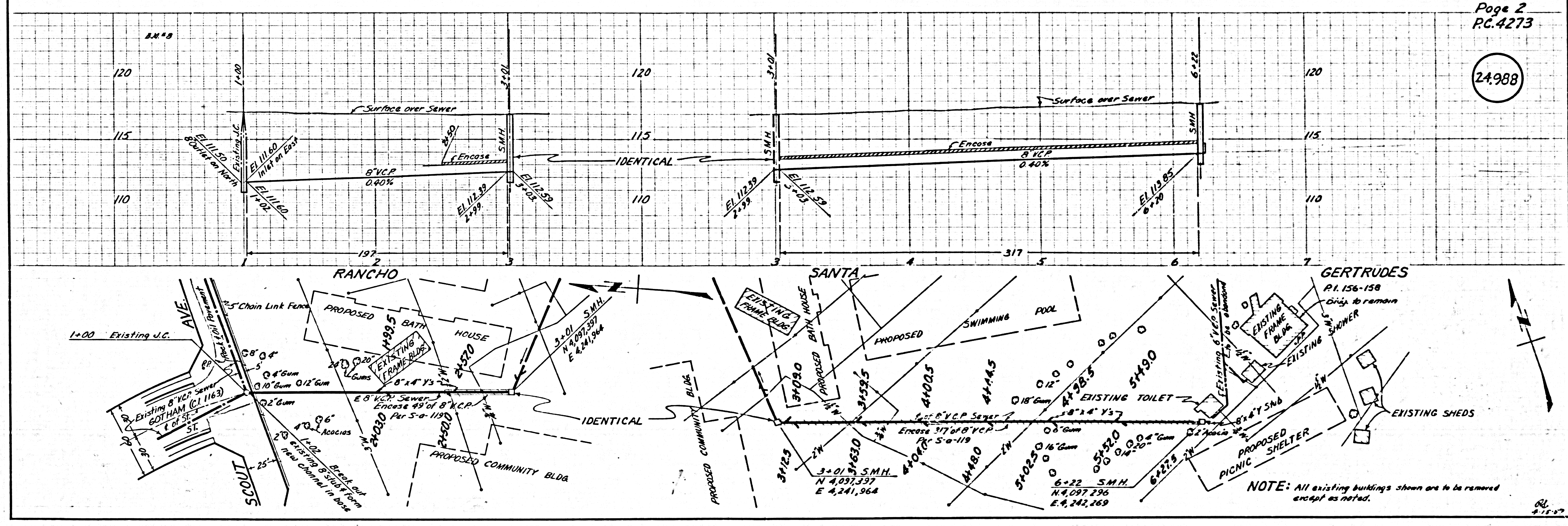

24,988

NOTE: All existing buildings shown are to be removed except as noted.

SM's checked
 4-15-57

