

INDEX MAP
TRACT No 23558
P.C. 4274
SCALE 1"=300'

BENCH MARK
C.S.B.M. 19-3 C.S.F.B. 1383-2 Elev. 332.218
Mission Dr. & Rosemead Blvd. (W. side) on the center line of Mission Drive 50' West of angle point

TEMPLE CITY BLDG. DIST. NO. 5

- NOTES**
- PROVIDE STAKES ON THE PROPERTY LINE OR PROPERTY LINES PRODUCED AT RIGHT ANGLES TO THE SEWER LINE AT THE CENTER LINE OF EACH MANHOLE.
 - NO REPRESENTATIVE OF THE COUNTY ENGINEER WILL SURVEY OR LAYOUT ANY PORTION OF THE WORK.
 - THE OWNER OR HIS AUTHORIZED REPRESENTATIVE SHALL FURNISH THE COUNTY ENGINEER WITH GRADE SHEETS AND STATIONING FOR ALL HOUSE LATERALS AND T BRANCHES & HE SHALL PROVIDE STAKES FOR TURNS AT THEIR PROPER LOCATIONS WITH STATIONING AND PLAINLY MARKED. ANY CHANGE IN LOCATION SHALL BE REQUESTED BY WRITING BY THE OWNER OR HIS REPRESENTATIVE.
 - NO REVISIONS SHALL BE MADE IN THESE PLANS WITHOUT THE APPROVAL OF THE COUNTY ENGINEER.
 - USE STANDARD MANHOLE FRAMES AND COVERS, S.A.-117.
 - USE STANDARD STRENGTH PIPE.
 - USE CEMENT MORTAR FOR ALL VITRIFIED CLAY PIPE JOINTS.
 - RESURFACE ALL TRENCH WITHIN PAVED AREA TO MEET L.A. COUNTY S&J&B DEPT. OR CALIF. STATE HIGHWAY DEPT. REQUIREMENTS IN ACCORDANCE WITH PERMITS.
 - ENCASE FOUR FEET OF SEWER AT POINTS OF INTERFERENCE WITH POLES, S.A.-119.
 - HOUSE LATERALS TO BE CONSTRUCTED WITH INVERTS AT PROPERTY LINE $\frac{1}{2}$ FOOT BELOW CURB GRADE.
 - ALL STRUCTURES SHALL BE BRICK SEWER STRUCTURES, S.A.-104.
 - FOR ALLOWABLE LEAKAGE TEST USE FORMULA NO. 1 SPEC'S, SEC. 204.
 - MANHOLE TOPS IN UNIMPROVED HIGHWAYS OR WAYS TO BE 6" ABOVE FINISH GRADE.
 - THE PRIVATE ENGINEER IS TO FURNISH THE HOUSE LATERAL DEPTH AT THE PROPERTY LINE BELOW THE TOP OF CURB ELEVATION FOR EACH HOUSE LATERAL ON THE GRADE SHEET.

PROFILE ALIGNMENT AND GRADE OF **P.C. 4274**
SANITARY SEWERS PAGE **1**

TO BE CONSTRUCTED IN
TRACT No 23558 (23,954)
(2)

PRIVATE CONTRACT NO. 4274
W.S. 44

1 SHEET, 2 PAGES
SCALE: VERT. 1"=4' HORIZ. 1"=40' DECEMBER, 1956

PREPARED BY THE OFFICES OF
TREADWELL ENGINEERING CORPORATION

BY *W.A. Treadwell*
REG. C. E. NO. 410

FOR LEGEND SEE PLAN NO. S.A-64

NOTE
GRADES TO WHICH THIS IMPROVEMENT IS TO BE CONSTRUCTED ARE SHOWN ON PLANS AND PROFILES. GRADE POINTS FOR TOP OF CURBS, CENTER LINE OF STREETS, OR CENTER LINE OF ALLEYS ARE SHOWN BY CIRCLES ON PROFILES. AT ALL POINTS BETWEEN DESIGNATED POINTS THE GRADE SHALL BE ESTABLISHED SO AS TO COMFORM TO A STRAIGHT LINE DRAWN BETWEEN SAID DESIGNATED POINTS.
REVISIONS ARE IN PINK ABOVE BLUE & OR. SETS LEAVE ORIGINAL OF 1955.
THIS DRAWING AND THE DATA HEREON ARE HEREBY MADE A PART OF THE SPECIFICATIONS.
WORK SHALL BE CONSTRUCTED ACCORDING TO SPECIFICATIONS ON FILE IN THE OFFICE OF THE COUNTY ENGINEER AND SHALL BE PROTECTED ONLY IN THE PRESENCE OF THE COUNTY ENGINEER.
BEFORE WORK CAN BE STARTED, THE CONTRACTOR MUST OBTAIN A PERMIT TO EXCAVATE IN COUNTY STREETS FROM THE L.A. COUNTY ROAD DEPT. USE W. 316 1/2' AND MAKE A REPORT WITH THE COUNTY ENGINEER ROOM 324 PAV. AMERICAN BLDG. 322 5th BROADWAY SUFFICIENT TO COVER THE COST OF CONSTRUCTION INSPECTION AND RECORD PLANS.
APPROVAL OF THIS PLAN BY THE COUNTY OF LOS ANGELES DOES NOT CONSTITUTE A REPRESENTATION AS TO THE ACCURACY OF THE LOCATION OF OR THE EXISTENCE OR NON-EXISTENCE OF ANY UNDERGROUND UTILITY PIPE, OR STRUCTURE WITHIN THE LIMITS OF THIS PROJECT THIS NOTE APPLIES TO ALL PAGES.
IF WORK IS TO BE DONE IN A STATE HIGHWAY, A PERMIT MUST BE OBTAINED FROM THE STATE OF CALIFORNIA, DIVISION OF HIGHWAYS, 128 SOUTH SPRING STREET.

NO CHARGE FOR CONNECTIONS
P.K. Kuban 1-3-57

COUNTY OF LOS ANGELES, CALIFORNIA
APPROVED, JOHN A. LAMBE, COUNTY ENGINEER
APPROVED, A. M. BAWN, CHIEF ENGINEER
BY *A.P. Collins* (SANTATION ENGINEER) BY *A. M. Bawn* (OFFICE ENGINEER)
CHECKED BY *P.K. Kuban 1-3-57*
OFFICE OF COUNTY ENGINEER, Rm. C. E. NO. 7862

dated 1-16-57 W.A. Treadwell

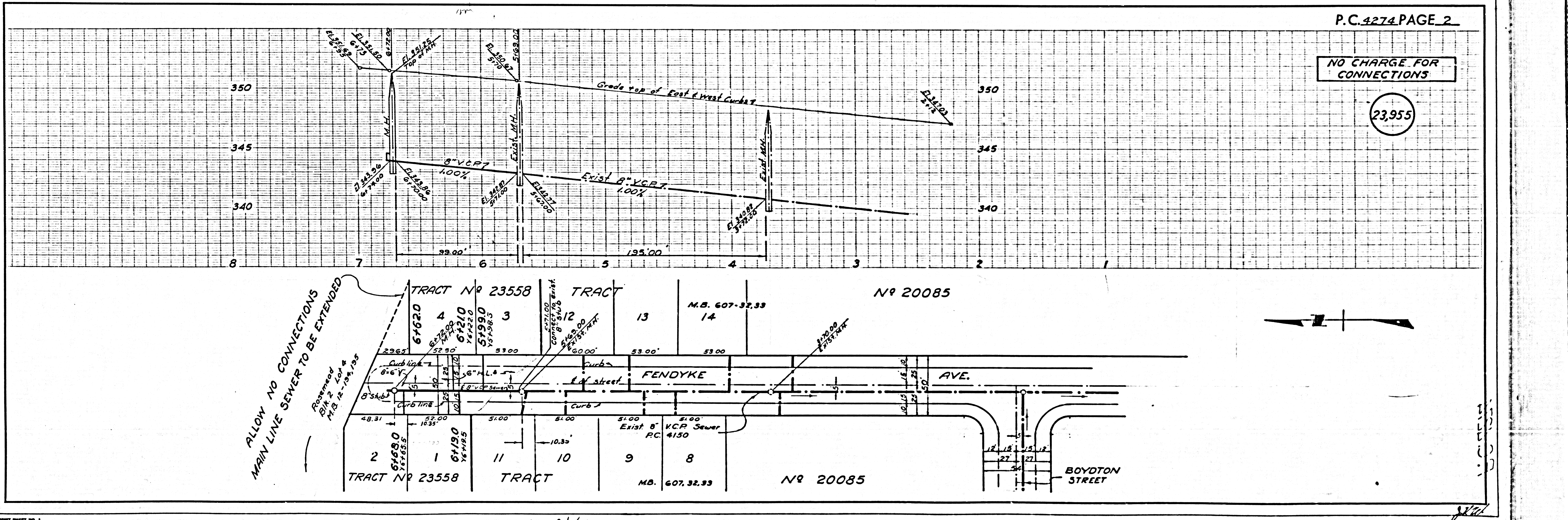

P.C. 4274 PAGE 2

NO CHARGE FOR CONNECTIONS

(23,955)

ALLOW NO CONNECTIONS
MAIN LINE SEWER TO BE EXTENDED

quels sheet 0'K