

LENNOX BLDG. DIST. NO. 7

PROFILE ALIGNMENT AND GRADE OF  
**SANITARY SEWERS** PAGE 1  
 TO BE CONSTRUCTED IN  
**INGLEWOOD AVENUE** (24,340)

PRIVATE CONTRACT NO. 4283

W.S. 25  
 ONE SHEET, TWO PAGES  
 SCALE: HORIZ. 1" = 40' VERT. 1" = 4'  
 JANUARY, 1957  
 PREPARED IN THE OFFICES OF  
**PATRICK FRETTO**

By Patrick Fretto  
 REG. C. E. NO. 7664  
 FOR LEGEND SEE PLAN NO. S-A-64

B.M. - SY 2807, Elev. 59.812 Co. Precise Levels - 1955 Adj.  
 Manhattan Beach Blvd. & Inglewood Ave. ± 35' N. & ± 28' E. of Int.  
 Lead & Bench Nail - S.W. Cor. Conc. Base for Metro. Water Dist. Pumps

- NOTES**
- PROVIDE STAKES ON THE PROPERTY LINE OR PROPERTY LINES PRODUCED AT RIGHT ANGLES TO THE SEWER LINE AT THE CENTER LINE OF EACH MANHOLE.
  - NO REPRESENTATIVE OF THE COUNTY ENGINEER WILL SURVEY OR LAYOUT ANY PORTION OF THE WORK.
  - THE OWNER OR HIS AUTHORIZED REPRESENTATIVE SHALL FURNISH THE COUNTY ENGINEER WITH GRADE SHEETS AND STATION FOR ALL HOUSE LATERALS AND Y BRANCHES AND SHALL PROVIDE STAKES FOR THEM AT THEIR PROPER LOCATIONS WITH STATIONING PLAINLY MARKED. ANY CHANGE IN LOCATION SHALL BE REQUESTED IN WRITING BY THE OWNER OR HIS REPRESENTATIVE.
  - NO REVISIONS SHALL BE MADE IN THESE PLANS WITHOUT THE APPROVAL OF THE COUNTY ENGINEER.
  - USE STANDARD MANHOLE FRAMES AND COVERS, S.A.-117.
  - USE STANDARD STRENGTH PIPE EXCEPT AS NOTED.
  - USE CEMENT MORTAR FOR ALL VITRIFIED CLAY PIPE JOINTS.
  - RESURFACE ALL TRENCH WITHIN PAVED AREA TO MEET L. A. COUNTY ROAD DEPT. OR CALIF. STATE HIGHWAY DEPT. SPECIFICATIONS IN ACCORDANCE WITH PERMITS.
  - ENCASE PLUS FOOT OF SEWER AT POINTS OF INTERFERENCE WITH POLES, S.A.-119.
  - HOUSE LATERALS TO BE CONSTRUCTED WITH 4" DIA. 12" V.C.P. - 1.00% SLOPE - 4" DIA. 12" V.C.P. - 1.00% SLOPE - 4" DIA. 12" V.C.P. - 1.00% SLOPE.
  - ALL STRUCTURES SHALL BE BRICK SEWER STRUCTURES, S.A.-104.
  - FOR ALLOWABLE LEAKAGE TEST USE FORMULA NO. 1 SPEC. SEC. 04.
  - MANHOLE TOPS TO BE UNIMPROVED GRADE UNLESS OTHERWISE INDICATED.

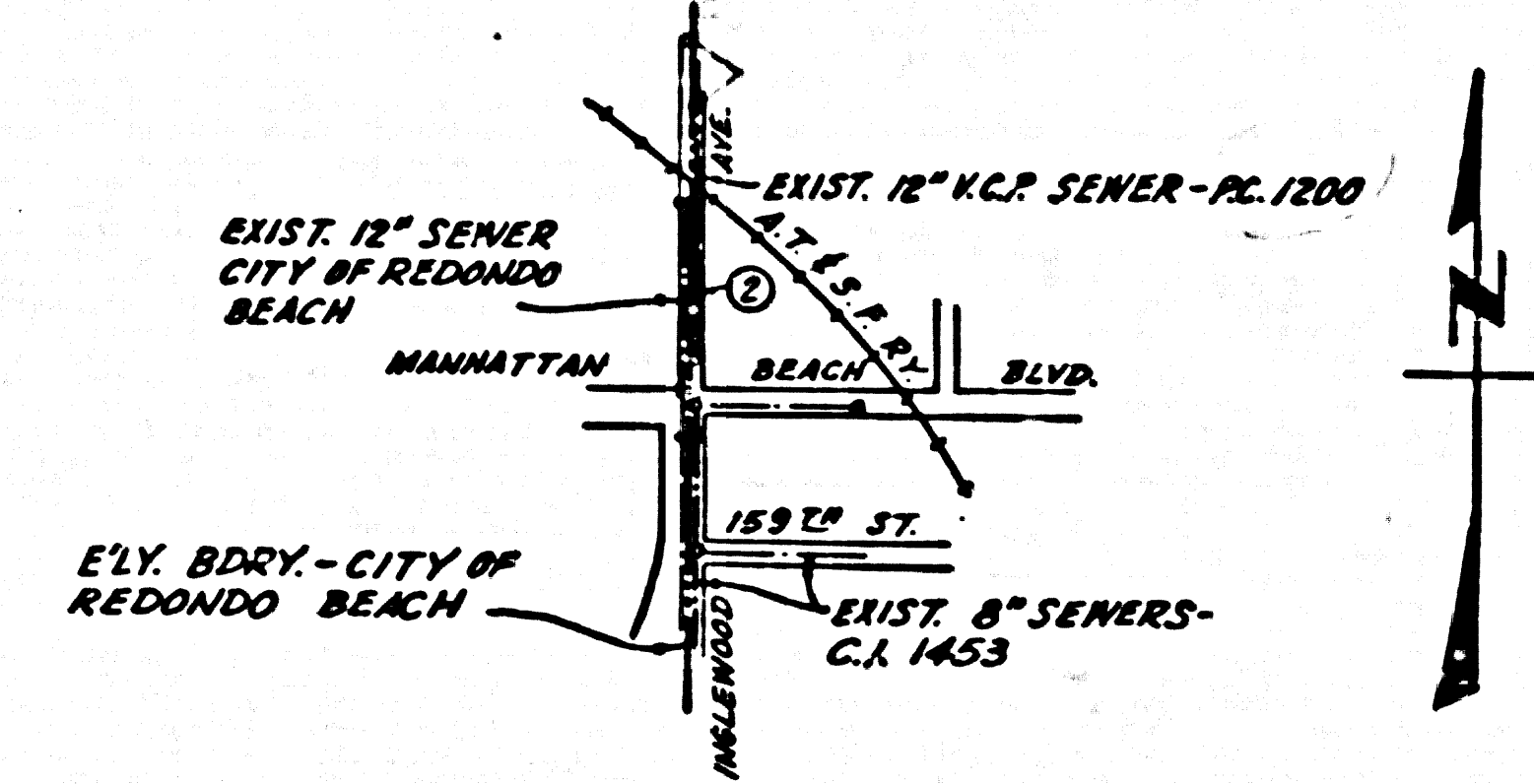

INDEX MAP  
 SCALE: 1" = 600'  
 P.C. 4283

NO CHARGE FOR CONNECTIONS  
 24,340-57

**NOTES**

GRADES TO WHICH THIS IMPROVEMENT IS TO BE CONSTRUCTED ARE SHOWN ON PLANS AND PROFILES. GRADE POINTS FOR TOP OF CURBS, CENTER LINE OF STREETS, OR CENTER LINE OF ALLEYS ARE SHOWN BY CIRCLES ON PROFILES AT ALL POINTS BETWEEN DESIGNATED POINTS THE GRADE SHALL BE ESTABLISHED SO AS TO CONFORM TO A STRAIGHT LINE DRAWN BETWEEN SAID DESIGNATED POINTS.

ELEVATIONS ARE IN FEET ABOVE U.S.C. & G.S. SEA LEVEL DATUM OF 1929.

THIS DRAWING AND THE DATA HEREON ARE HEREBY MADE A PART OF THE SPECIFICATIONS.

WORK SHALL BE CONSTRUCTED ACCORDING TO SPECIFICATIONS ON FILE IN THE OFFICE OF THE COUNTY ENGINEER AND SHALL BE PROSECUTED ONLY IN THE PRESENCE OF THE COUNTY ENGINEER.

BEFORE WORK CAN BE STARTED THE CONTRACTOR MUST OBTAIN A PERMIT TO EXCAVATE IN COUNTY STREETS FROM THE L. A. COUNTY ROAD DEPT., 100 W. 5TH ST. AND MAKE A DEPOSIT WITH THE COUNTY ENGINEER ROOM 204 PAN AMERICAN BUILDING 225 SO. HOUGHTON ST. TO COVER THE COST OF CONSTRUCTION INSPECTION AND RECORD PLANS.

APPROVAL OF THIS PLAN BY THE COUNTY OF LOS ANGELES DOES NOT CONSTITUTE A REPRESENTATION AS TO THE ACCURACY OF THE LOCATION OF OR THE EXISTENCE OR NON-EXISTENCE OF ANY UNDERGROUND UTILITY PIPE, OR STRUCTURE WITHIN THE LIMITS OF THIS PROJECT. THIS NOTE APPLIES TO ALL PAGES.

WORK IS TO BE DONE IN A STATE HIGHWAY, A PERMIT MUST BE OBTAINED FROM THE STATE OF CALIFORNIA, DIVISION OF HIGHWAYS, 120 SOUTH BRINK STREET.

COUNTY OF LOS ANGELES, CALIFORNIA

APPROVED, JOHN A. LAMME, COUNTY ENGINEER

APPROVED, A. M. BAWN, CHIEF ENGINEER

By A. P. Collins SANITATION ENGINEER

By J. P. ... CHIEF ENGINEER

CHECKED BY P. F. ... 1-17-57

OFFICE OF COUNTY ENGINEER, REG. C. E. NO. 7860

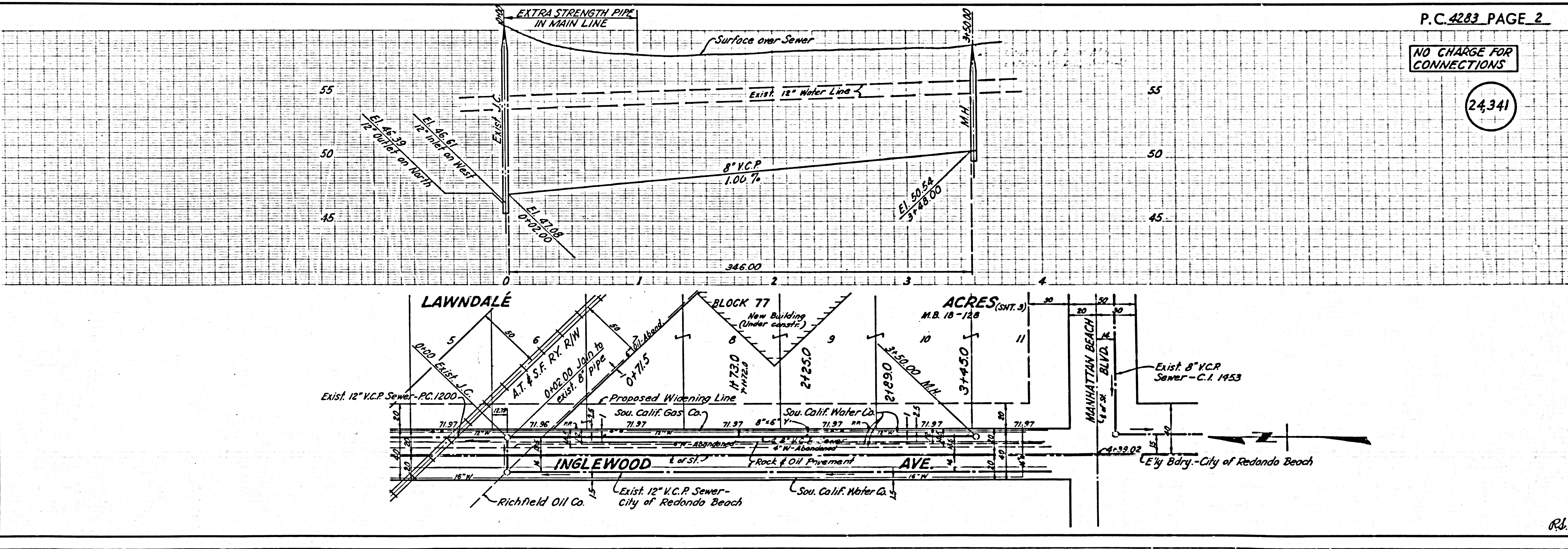

P.C. 4283 PAGE 2

NO CHARGE FOR CONNECTIONS

(24,341)

Rd.