

B.M. M.E. 75 Elev 248.23 F.B. 1728 pg 45  
 Peck Rd. & Schmidt Rd. S.W. Cor  
 31' spk in curb 6' W of W end of Curb

**PUEENTE BLDG. DIST. NO. 2**

- NO. 1151  
 PROVIDE STAKES ON THE PROPERTY LINE OR PROPERTY LINES INDICATED AT RIGHT ANGLES TO THE SEWER LINE AT THE CENTER LINE OF EACH MANHOLE
- NO REPRESENTATIVE OF THE COUNTY ENGINEER WILL SURVEY OR LAYOUT ANY PORTION OF THE WORK
- THE OWNER OR HIS AUTHORIZED REPRESENTATIVE SHALL FURNISH THE COUNTY ENGINEER WITH GRADE SHEETS AND STATION FOR ALL HOUSE LATERALS AND Y BRANCHES AND SHALL PROVIDE STAKES FOR THEM AT THEIR PROPER LOCATIONS WITH STATION AND PLAINLY MARKED ANY CHANGE IN LOCATION SHALL BE REQUESTED IN WRITING BY THE OWNER OR HIS REPRESENTATIVE
- NO REVISIONS SHALL BE MADE IN THESE PLANS WITHOUT THE APPROVAL OF THE COUNTY ENGINEER
- USE STANDARD MANHOLE FRAMES AND COVERS, S.A. 117, EXCEPT AS NOTED
  - USE STANDARD STRENGTH PIPE EXCEPT AS NOTED
  - USE CEMENT MORTAR FOR ALL VITRIFIED CLAY PIPE JOINTS
  - RESURFACE ALL TRENCH WITHIN 4' SIDE AREA TO MEET L. J. COUNTY ROAD DEPT. OR CALIF. STATE HIGHWAY DEPT. REQUIREMENTS IN ACCORDANCE WITH PERMITS
  - ENCASE FOUR FEET OF SEWERS AT POINTS OF INTERFERENCE WITH POLES, S.A. 119
  - HOUSE LATERALS TO BE CONSTRUCTED WITH INVERTS AT PROPERTY LINE 10" BELOW CURB GRADE EXCEPT AS NOTED
  - ALL STRUCTURES SHALL BE BUILT WITH STRUCTURAL S.A. 116, EXCEPT AS NOTED
  - FOR ALLOWABLE LEAKAGE TEST SEE FORMULA NO. 1, SPEC. SEC. III
  - MANHOLES TOPS IN UNIMPROVED AREAS OF WAYS TO BE 6" ABOVE FINISHED GRADE
  - The private engineer is to furnish the house lateral depth at the property line below the top of curb elevation for each house lateral on the grade level

TO BE CONSTRUCTED IN  
**TRACT No 23323** (25,365)

(3)  
**PRIVATE CONTRACT NO. 4311**

W.S. 37  
 2 SHEETS; 3 PAGES

SCALE: VERT. 1"=4' HORIZ. 1"=40'  
 JAN., 1957  
 PREPARED IN THE OFFICES OF  
**HAROLD L. JOHNSON**

By *Harold L. Johnson* 3.16.57  
 REG. C. E. NO. 7688

FOR LEGEND SEE PLAN NO. S-A-64

NOTE: GRADES TO WHICH THIS IMPROVEMENT IS TO BE CONSTRUCTED ARE SHOWN ON PLANS AND PROFILES. GRADE POINTS FOR TOP OF CURB, CENTER LINE OF TRIMETS, OR CENTER LINE OF ALLEYS ARE SHOWN BY CIRCLES ON PROFILES AT ALL POINTS BETWEEN DESIGNATED POINTS. THE GRADE SHALL BE ESTABLISHED SO AS TO CONFORM TO A STRAIGHT LINE BETWEEN SAID DESIGNATED POINTS.

REVISIONS AND BE SET ABOVE U.S.G. 801 SEA LEVEL, DATUM OF 1917

THIS DRAWING AND THE DATA HEREON ARE HEREBY MADE A PART OF THE SPECIFICATIONS

WORK SHALL BE CONSTRUCTED ACCORDING TO SPECIFICATIONS ON FILE IN THE OFFICE OF THE COUNTY ENGINEER AND SHALL BE PROSECUTED ONLY IN THE PRESENCE OF THE COUNTY ENGINEER

BEFORE WORK CAN BE STARTED, THE CONTRACTOR MUST OBTAIN A PERMIT TO EXCAVATE IN COUNTY STREETS UNDER THE L. A. COUNTY ROAD DEPT. LAW AND MAKE A REPORT WITH THE COUNTY ENGINEER, UNDER THE SANITARIAN BUILDING LAW, 330.50, ROADWAY SUFFICIENT TO COVER THE COST OF CONSTRUCTION INSPECTION AND RECORD PLANS

APPROVAL OF THIS PLAN BY THE COUNTY OF LOS ANGELES DOES NOT CONSTITUTE A REPRESENTATION AS TO THE ACCURACY OF THE LOCATION OF OR THE EXISTENCE OR NON-EXISTENCE OF ANY UNDERGROUND UTILITY PIPE, GAS STRUCTURE WITHIN THE LIMITS OF THIS PROJECT. THIS NOTE APPLIES TO ALL PAGES

IF WORK IS TO BE DONE IN A STATE HIGHWAY, A PERMIT MUST BE OBTAINED FROM THE STATE OF CALIFORNIA, DIVISION OF HIGHWAYS, 126 SOUTH SPRING STREET

COUNTY OF LOS ANGELES, CALIFORNIA

APPROVED, JOHN A. LAMME, COUNTY ENGINEER  
 APPROVED, A. M. RAWN, CHIEF ENGINEER  
 BY *A. P. Collins* 4-3-57  
 SANITARIAN ENGINEER  
 BY *A. M. Rawn*  
 OFFICE ENGINEER  
 CHECKED BY *W. K. Under* 4-3-57  
 OFFICE OF COUNTY ENGINEER, REG. C. E. NO. 3486

NO CHARGE FOR CONNECTIONS  
*L. Collins 4-3-57*

Before breaking into any existing structure, and before final acceptance of this work, County Sanitation District should be notified in order that required inspection may be made.

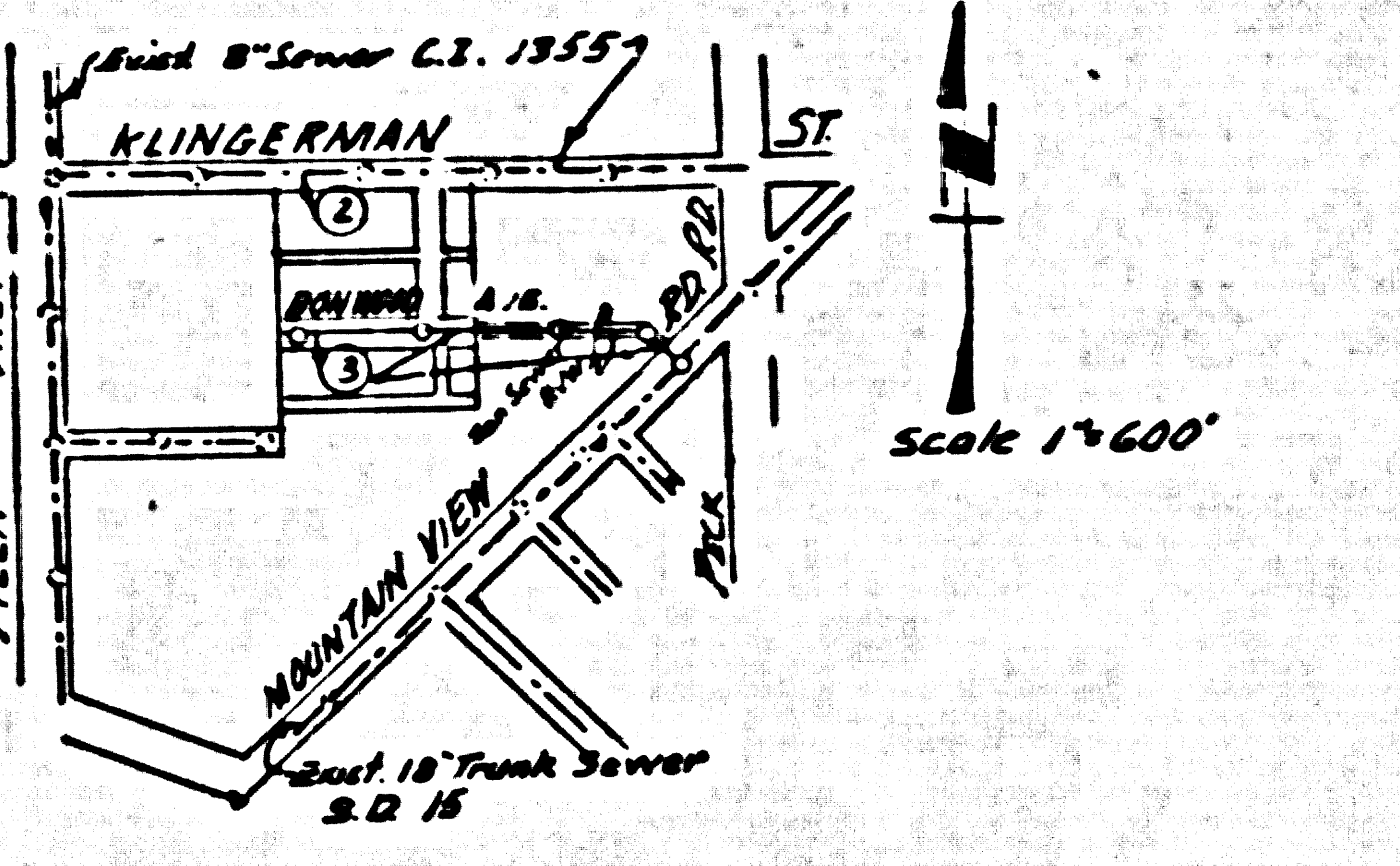

INDEX MAP  
 P.C. 4311  
 TRACT No 23323

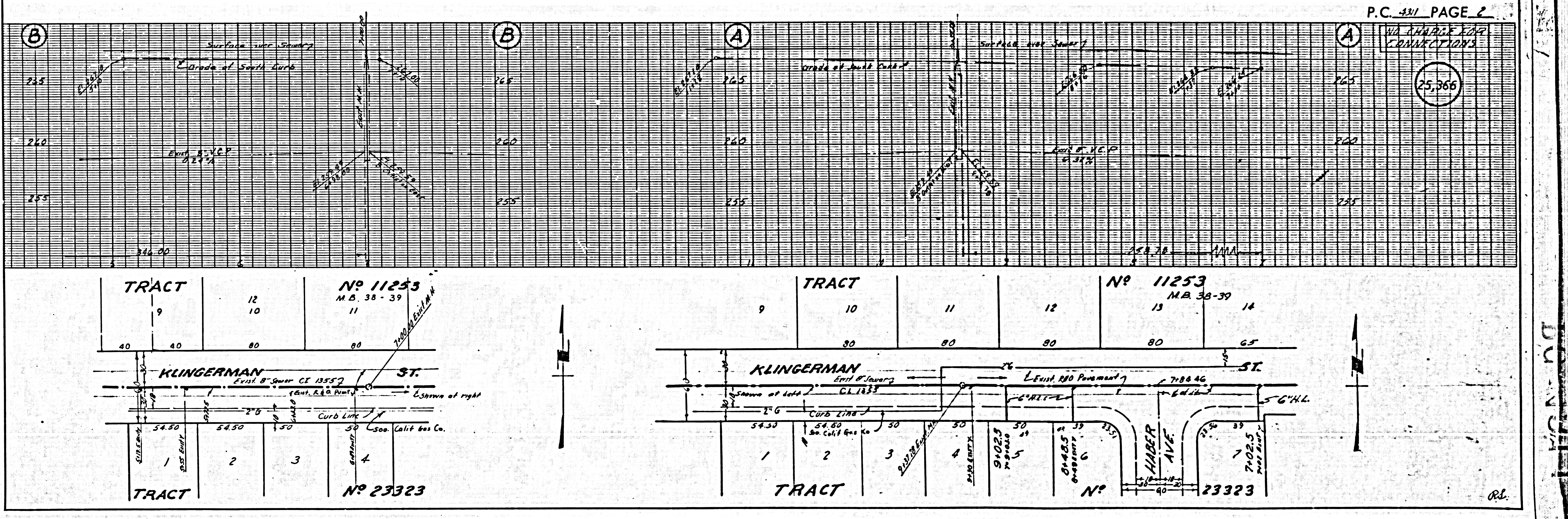

NO CHARGE FOR CONNECTIONS

25,367

