

B.M. 536 - ELEVATION 38.730, F.B. 1180 P. 170
 220' ST. (N. SIDE) AT MEYLER STREET
 DT. SP. IN S. END HEADWALL, E. SIDE OF DRIVE TO HOSPITAL

LOMITA BLDG. DIST. NO. 7L

PROFILE ALIGNMENT AND GRADE OF P.C. 4384
 SANITARY SEWERS PAGE 1

TO BE CONSTRUCTED IN
 TRACT, NO. 23710

PRIVATE CONTRACT NO. 4384

W.S. 28

1 SHEET, 2 PAGES

SCALE: VERT. 1" = 4'
 HORIZ. 1" = 40' APRIL, 1957

PREPARED IN THE OFFICES OF
 R. L. Ransall
 REG. C. E. NO. 2304

FOR LEGEND SEE PLAN NO. S-A-61

- NOTES:
1. PROVIDE STAKES ON THE PROPERTY LINE OR PROPERTY LINES PRODUCED AT RIGHT ANGLES TO THE SEWER LINE AT THE CENTER LINE OF EACH MANHOLE.
 2. NO REPRESENTATIVE OF THE COUNTY ENGINEER WILL SURVEY OR LAYOUT ANY PORTION OF THE WORK.
 3. THE OWNER OR HIS AUTHORIZED REPRESENTATIVE SHALL FURNISH THE COUNTY ENGINEER WITH GRADE SHEETS AND STATION FOR ALL HOUSE LATERALS AND Y BRANCHES AND SHALL PROVIDE STAKES FOR THEM AT THEIR PROPER LOCATIONS WITH STATIONING PLAINLY MARKED. ANY CHANGE IN LOCATION SHALL BE REQUESTED IN WRITING BY THE OWNER OR HIS REPRESENTATIVE.
 4. NO REVISIONS SHALL BE MADE IN THESE PLANS WITHOUT THE APPROVAL OF THE COUNTY ENGINEER.
 5. USE STANDARD MANHOLE FRAMES AND COVERS, S.A.-117 EXCEPT AS NOTED.
 6. USE STANDARD STRENGTH PIPE EXCEPT AS NOTED.
 7. USE CEMENT MORTAR FOR ALL VITRIFIED CLAY PIPE JOINTS.
 8. RESURFACE ALL TRENCH WITHIN PAVED ALLEYS TO MEET L. A. COUNTY ROAD DEPT., OR CALIF. STATE HIGHWAY DEPT. REQUIREMENTS IN ACCORDANCE WITH PERMITS.
 9. ENCASE FLAT FEET OF SEWERS AT POINTS OF INTERFERENCE WITH POLES, S.A.-119.
 10. HOUSE LATERALS TO BE CONSTRUCTED WITH INVERTS AT PROPERTY LINE, 6" FEET BELOW CURB GRADE EXCEPT AS NOTED.
 11. ALL STRUCTURES SHALL BE BRICK SEWER STRUCTURES, S.A.-104, EXCEPT AS NOTED.
 12. FOR ALLOWABLE LEAKAGE TEST USE FORMULA NO. 1, S.P.C.S. 1957, SPEC. S.C. 10.
 13. MANHOLE TOPS IN UNIMPROVED RIGHTS-OF-WAY TO BE 6" ABOVE FINISHED GRADE.

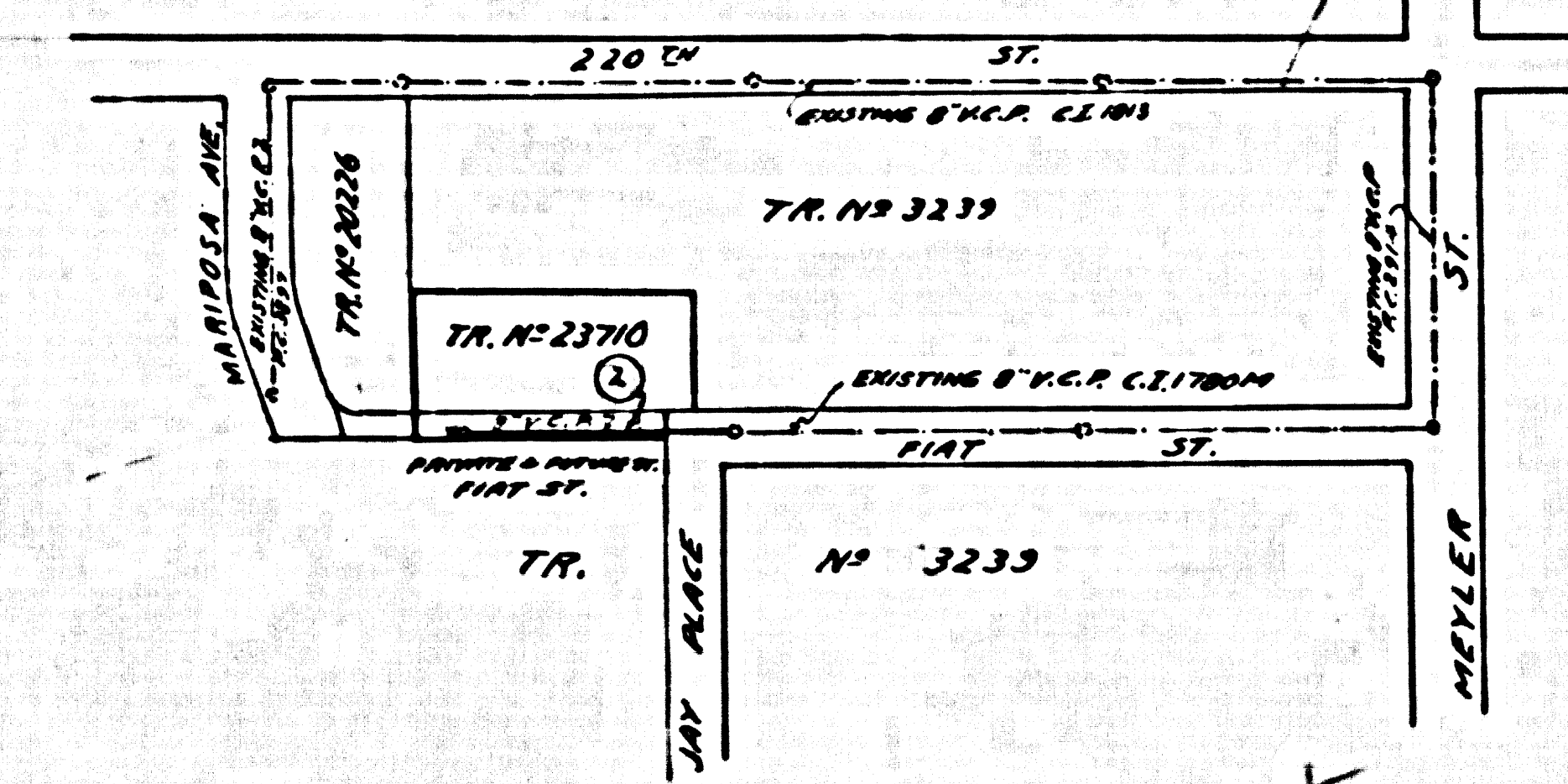

SCALE 1" = 200'

Handwritten notes:
 Note: Grade shown in background of plan is the existing ground surface. The sewer line is shown in red and the manhole is shown in blue. The sewer line is shown to enter the B.M. 536.

COLLECT CHARGES AS INDICATED

Handwritten: Connection Note
 ABANDONED

NOTES:
 GRADES TO 1-INCH THIS IMPROVEMENT IS TO BE CONSTRUCTED ARE SHOWN ON PLANS AND PROFILES. GRADE POINTS FOR TOP OF CURB, CENTER LINE OF STREETS, OR CENTER LINE OF ALLEYS ARE SHOWN BY CIRCLES ON PROFILES. AT ALL POINTS BETWEEN INDICATED POINTS THE GRADE SHALL BE ESTABLISHED SO AS TO CONFORM TO A STRAIGHT LINE BEYOND THE LAST DESIGNATED POINT.
 ELEVATIONS ARE IN FEET ABOVE MEAN SEA LEVEL DATUM OF 1929.
 THIS DRAWING AND THE DATA HEREON ARE HEREBY MADE A PART OF THE SPECIFICATIONS.
 WORK SHALL BE CONSTRUCTED ACCORDING TO SPECIFICATIONS ON FILE IN THE OFFICE OF THE COUNTY ENGINEER AND SHALL BE PROSECUTED ONLY IN THE PRESENCE OF THE COUNTY ENGINEER.
 BEFORE WORK CAN BE STARTED, THE CONTRACTOR MUST OBTAIN A PERMIT TO EXCAVATE IN COUNTY STREETS FROM THE L. A. COUNTY ROAD DEPT., 126 W. 2ND ST. AND MAKE A REPORT WITH THE COUNTY ENGINEER, ROOM 324 PAM AMERICAN BUILDING, 210 SO. BROADWAY SUPPLEMENT TO COVER THE COST OF CONSTRUCTION INSPECTION AND RECORD PLANS.
 APPROVAL OF THIS PLAN BY THE COUNTY OF LOS ANGELES DOES NOT CONSTITUTE A REPRESENTATION AS TO THE ACCURACY OF THE LOCATION OF OR THE EXISTENCE OR NON-EXISTENCE OF ANY UNDERGROUND UTILITY PIPE, OR STRUCTURE WITHIN THE LIMITS OF THIS PROJECT. THIS NOTE APPLIES TO ALL PAGES.
 IF WORK IS TO BE DONE IN A STATE HIGHWAY, A PERMIT MUST BE OBTAINED FROM THE STATE OF CALIFORNIA, DIVISION OF HIGHWAYS, 157 SOUTH SPRING STREET.

COUNTY OF LOS ANGELES, CALIFORNIA

APPROVED, JOHN A. LAMBE, COUNTY ENGINEER APPROVED, A. M. RAWL, CHIEF ENGINEER
 CO. SAN. DIST. NO. 18

BY _____ SANITATION ENGINEER BY _____ OFFICE ENGINEER
 CHECKED BY _____ OFFICE OF COUNTY ENGINEER, SAN. C. & NO. _____

P.C. 4384 PAGE 2

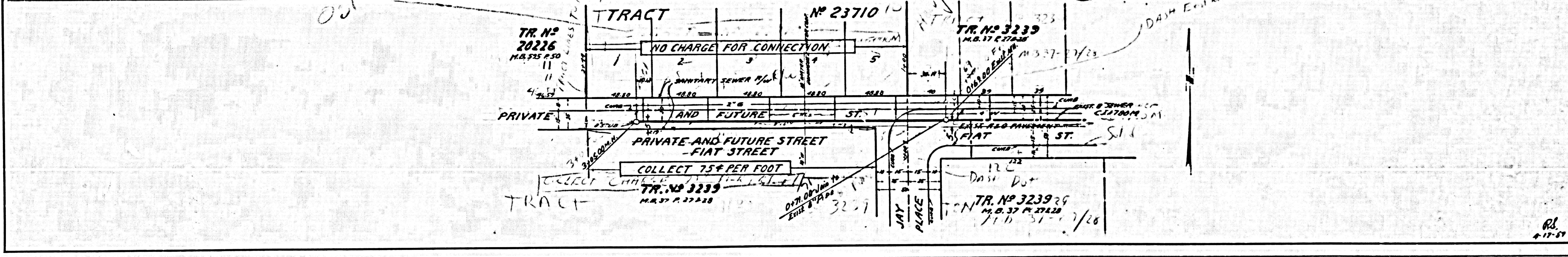
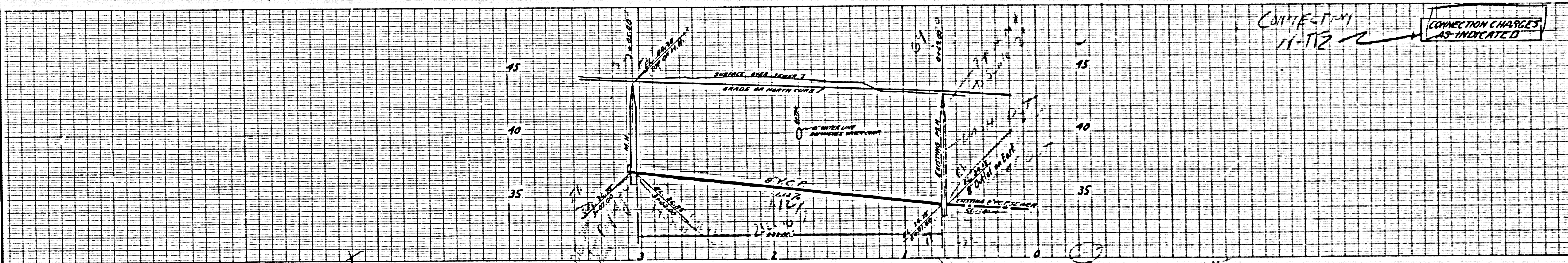

R.L.
 4-17-57