

BNA: S. 53 F.B. 759-24 El. 251.269  
Bl. Spk. in Cb. 4' S. of S. and Curb Ref.  
S.E. Cor. Hillview Ave. & 187 ST.

EAST LOS ANGELES BLDG. DIST. NO. 6

- NOTES:
- PROVIDE STAKES ON THE PROPERTY LINE OR PROPERTY LINE'S PRODUCED AT RIGHT ANGLES TO THE SEWER LINE AT THE CENTER LINE OF EACH MANHOLE.
  - NO REPRESENTATIVE OF THE COUNTY ENGINEER WILL SURVEY OR LAYOUT ANY PORTION OF THE WORK.
  - THE OWNER OR HIS AUTHORIZED REPRESENTATIVE SHALL FURNISH THE COUNTY ENGINEER WITH GRADE SHEETS AND STATIONING FOR ALL HOUSE LATERALS AND Y BRANCHES AND SHALL PROVIDE STAKES FOR THEM AT THEIR PROPER LOCATIONS WITH STATIONING PLAINLY MARKED. ANY CHANGE IN LOCATION SHALL BE REQUESTED BY WRITING BY THE OWNER OR HIS REPRESENTATIVE.
  - NO REVISIONS SHALL BE MADE IN THESE PLANS WITHOUT THE APPROVAL OF THE COUNTY ENGINEER.
  - USE STANDARD MANHOLE FRAMES AND COVERS, S.A-117, EXCEPT AS NOTED.
  - USE STANDARD MANHOLE FRAMES EXCEPT AS NOTED.
  - USE CEMENT MORTAR FOR ALL VITRIFIED CLAY PIPE JOINTS.
  - RESURFACE ALL TRENCH WITHIN PAVED AREA TO MEET L. A. COUNTY ROAD DEPT. OR CALIF. STATE HIGHWAY DEPT. REQUIREMENTS IN ACCORDANCE WITH PERMITS.
  - ENCASE FOUR FEET OF SEWER AT POINTS OF INTERFERENCE WITH POLES, S.A-119.
  - HOUSE LATERALS TO BE CONSTRUCTED WITH INVERTS AT PROPERTY LINE 6 FEET BELOW CURB GRADE EXCEPT AS NOTED.
  - ALL STRUCTURES SHALL BE BRICK SEWER STRUCTURES, S.A-104, EXCEPT AS NOTED.
  - FOR ALLOWABLE LEAKAGE TEST USE FORMULA NO. 1 SPEC. 1, SEC. 2.
  - MANHOLE TOPS IN UNAPPROVED RIGHTS-OF-WAY TO BE 6" ABOVE FINISHED GRADE.
- Note: The Private Engineer is to furnish the House Lateral depth at the property line below the Grade of the S of Alley on the Grade Street.*

PROFILE ALIGNMENT AND GRADE OF P.C. 4392  
SANITARY SEWERS PAGE 1  
TO BE CONSTRUCTED IN  
187 ALLEY EAST OF ATLANTIC BLVD

PRIVATE CONTRACT NO. 4392  
W.S. 36  
1 SHEET, 2 PAGES  
SCALE: VERT. 1" = 4'  
HORIZ. 1" = 40' APRIL, 1957  
PREPARED BY THE OFFICES OF  
OLSON SURVEYING SERVICE  
*Richard A. Collins*  
REG. C. E. NO. 2222  
FOR LEGEND SEE PLAN NO. S-A-64

24581

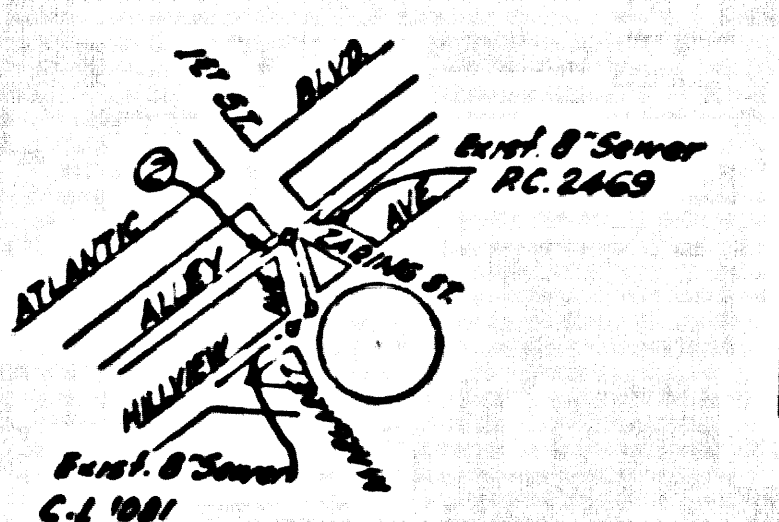

INDEX MAP  
P.C. 4392  
SCALE: 1" = 400'

NO CHARGE FOR CONNECTIONS  
4-23-57

NOTE: GRADES TO WHICH THIS IMPROVEMENT IS TO BE CONSTRUCTED ARE SHOWN ON PLANS AND PROFILE GRADE POINTS FOR TOP OF CURBS, CENTER LINE OF STREETS, OR CENTER LINE OF ALLEYS ARE SHOWN BY CIRCLES ON PROFILES. AT ALL POINTS BETWEEN DESIGNATED POINTS THE GRADE SHALL BE ESTABLISHED SO AS TO CONFORM TO A STRAIGHT LINE DRAWN BETWEEN SAID DESIGNATED POINTS.

ELEVATIONS ARE IN FEET ABOVE U.S.C. & G.S. SEA LEVEL UNLESS OTHERWISE NOTED.

THE SEWERING AND THE DATA HEREON ARE HEREBY MADE A PART OF THE SPECIFICATIONS.

WORK SHALL BE CONSTRUCTED ACCORDING TO SPECIFICATIONS ON FILE IN THE OFFICE OF THE COUNTY ENGINEER AND SHALL BE INSPECTED BY HIM IN THE PRESENCE OF THE COUNTY ENGINEER.

BEFORE WORK CAN BE STARTED, THE CONTRACTOR MUST OBTAIN A PERMIT TO EXCAVATE IN COUNTY STREETS FROM THE L. A. COUNTY ROAD DEPT. FOR THE USE OF ST. AND MAKE A DEPOSIT WITH THE COUNTY ENGINEER ROOM 204 PAV. AMERICAN BLDG. 234 SO. BROADWAY SUFFICIENT TO COVER THE COST OF CONSTRUCTION INSPECTION AND RECORD PLANS.

APPROVAL OF THIS PLAN BY THE COUNTY OF LOS ANGELES DOES NOT CONSTITUTE A REPRESENTATION AS TO THE ACCURACY OF THE LOCATION OF OR THE EXISTENCE OR NON-EXISTENCE OF ANY UNDERGROUND UTILITY PIPE, OR STRUCTURE WITHIN THE LIMITS OF THIS PROJECT. THIS NOTE APPLIES TO ALL PAGES.

IF WORK IS TO BE DONE IN A STATE HIGHWAY, A PERMIT MUST BE OBTAINED FROM THE STATE OF CALIFORNIA, DIVISION OF HIGHWAYS, 120 SOUTH SPRING STREET.

COUNTY OF LOS ANGELES, CALIFORNIA

APPROVED, JOHN A. LAMBE, COUNTY ENGINEER  
APPROVED, A. M. BAWN, CHIEF ENGINEER  
BY A.P. Collins SANITATION ENGINEER  
BY A.M. Bawn OFFICE ENGINEER  
CHECKED BY S.K. Wilson  
OFFICE OF COUNTY ENGINEER, REG. C. E. NO. 59556  
APPROVED BY INDUSTRIAL WASTE DIVISION  
BY J. Stewart DATE 4/4/57

P.C. 4392 PAGE 2

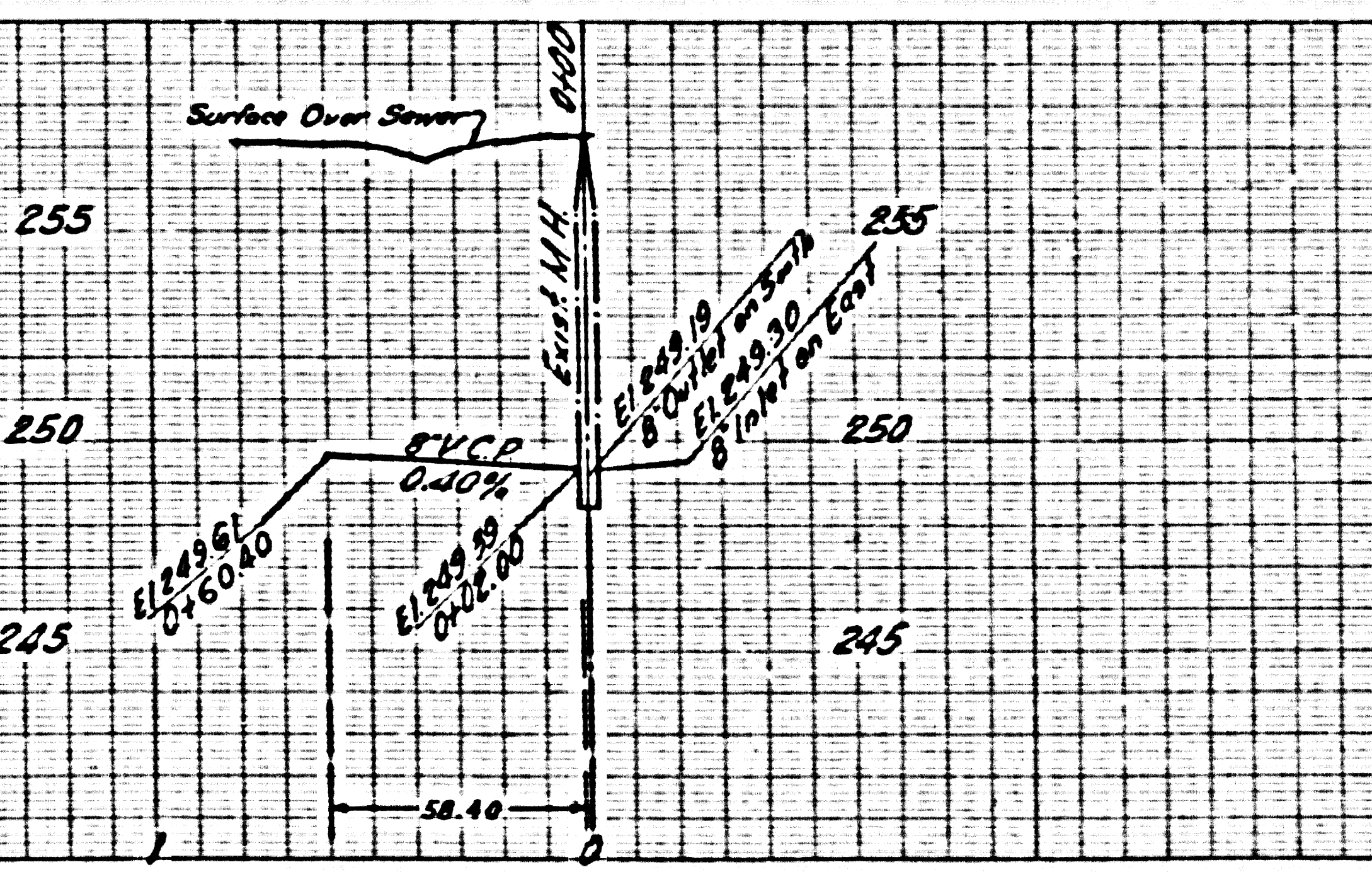

NO CHARGE FOR CONNECTIONS

24582

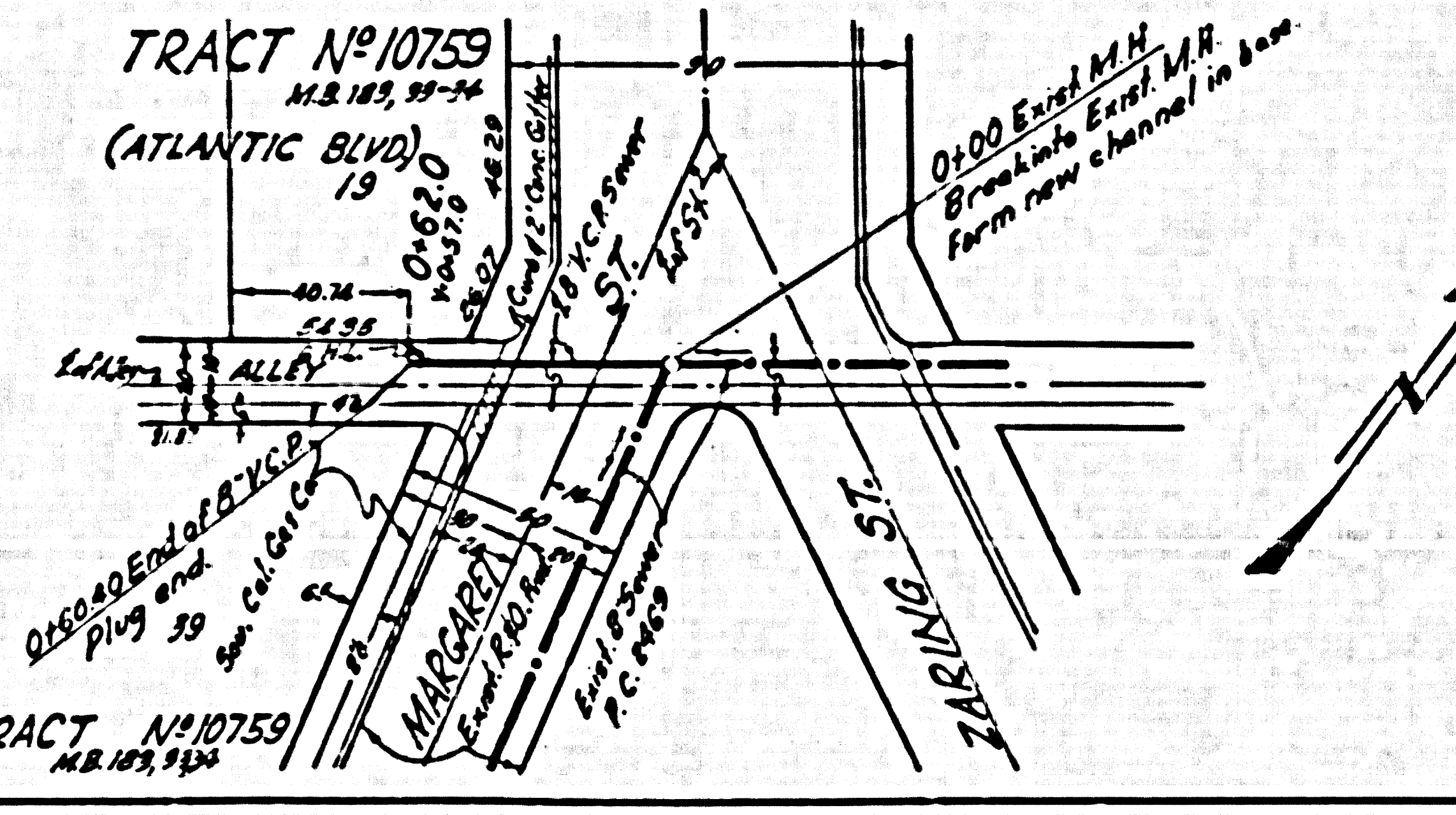

P.C. 4392