

BH & L. CO. SURVEY 1096 ELEV. 160790888 DATUM  
 CUT SPRING SOUTH END OF WEST HEADWALL  
 U.P.R.R. CO. MAIN LINE BRIDGE NO. 616

**E. LOS ANGELES BLDG. DIST. NO. 6**

PROFILE ALIGNMENT AND GRADE OF P.C. 4425  
**SANITARY SEWERS** PAGE 1

25,189

TO BE CONSTRUCTED IN  
 RIGHT OF WAY IN  
 TRACT No 7777 LOT 1  
 MB 115 13-14

TUBEWAY AVENUE - PRIVATE ST.

**PRIVATE CONTRACT NO. 4425**

W.S. 36

1 SHEET, 2 PAGES

SCALE: VERT. 1" = 4' HORIZ. 1" = 40'  
 MARCH, 1957

PREPARED IN THE OFFICES OF

UNION PACIFIC RAILROAD COMPANY

By *J. A. Montgomery* REG. C.E. NO. 9152

FOR LEGEND SEE PLAN NO. S-A-64

NO CHARGE  
 FOR CONNECTIONS  
*J. A. Montgomery*

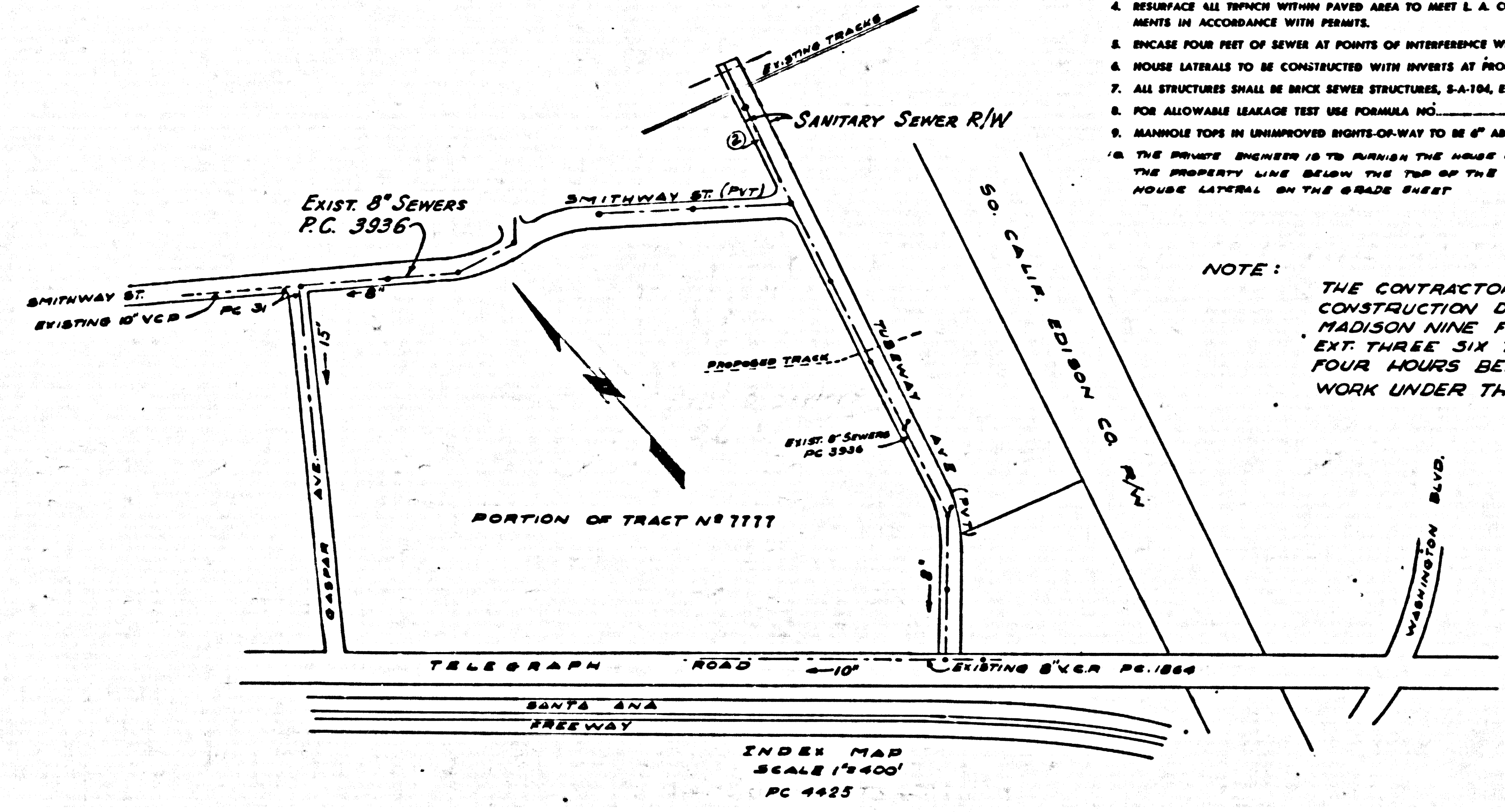

- NOTES:
- PROVIDE STAKES ON THE PROPERTY LINE OR PROPERTY LINES PRODUCED AT RIGHT ANGLES TO THE SEWER LINE AT THE CENTER LINE OF EACH MANHOLE.
  - NO REPRESENTATIVE OF THE COUNTY ENGINEER WILL SURVEY OR LAYOUT ANY PORTION OF THE WORK.
  - THE OWNER OR HIS AUTHORIZED REPRESENTATIVE SHALL FURNISH THE COUNTY ENGINEER WITH GRADE SHEETS AND STATION FOR ALL HOUSE LATERALS AND V BRANCHES AND SHALL PROVIDE STAKES FOR THEM AT THEIR PROPER LOCATIONS WITH STATIONING PLAINLY MARKED. ANY CHANGE IN LOCATION SHALL BE REQUESTED IN WRITING BY THE OWNER OR HIS REPRESENTATIVE.
  - NO REVISIONS SHALL BE MADE IN THESE PLANS WITHOUT THE APPROVAL OF THE COUNTY ENGINEER.
  - USE STANDARD MANHOLE FRAMES AND COVERS, S.A.-117, EXCEPT AS NOTED.
  - USE STANDARD STRENGTH PIPE EXCEPT AS NOTED.
  - USE CEMENT MORTAR FOR ALL VITRIFIED CLAY PIPE JOINTS.
  - RESURFACE ALL TRENCH WITHIN PAVED AREA TO MEET L. A. COUNTY ROAD DEPT. OR CALIF. STATE HIGHWAY DEPT. REQUIREMENTS IN ACCORDANCE WITH PERMITS.
  - ENCASE FOUR FEET OF SEWER AT POINTS OF INTERFERENCE WITH POLES, S.A.-119.
  - HOUSE LATERALS TO BE CONSTRUCTED WITH INVERTS AT PROPERTY LINE 6 FEET BELOW CURB GRADE EXCEPT AS NOTED.
  - ALL STRUCTURES SHALL BE BRICK SEWER STRUCTURES, S.A.-124, EXCEPT AS NOTED.
  - FOR ALLOWABLE LEAKAGE TEST USE FORMULA NO. 1 SPEC. SEC. 2.
  - MANHOLE TOPS IN UNIMPROVED RIGHTS-OF-WAY TO BE 6" ABOVE FINISHED GRADE.
  - THE ENGINEER IS TO FURNISH THE LARGE LATERAL DEPTH AT THE PROPERTY LINE BELOW THE TOP OF THE CURB FOR EACH HOUSE LATERAL ON THE GRADE SHEET.

NOTE:  
 THE CONTRACTOR SHALL NOTIFY THE  
 CONSTRUCTION DIVISION BY TELEPHONE,  
 MADISON NINE FOUR SEVEN FOUR SEVEN,  
 SIX THREE SIX TWO, AT LEAST TWENTY  
 FOUR HOURS BEFORE STARTING ANY  
 WORK UNDER THIS CONTRACT

NOTE:  
 GRADES TO WHICH THIS IMPROVEMENT IS TO BE CONSTRUCTED ARE SHOWN ON PLANS AND PROFILES. GRADE POINTS FOR TOP OF CURB, CENTER LINE OF STREET, OR CENTER LINE OF ALLEYS ARE SHOWN BY CIRCLES ON PROFILES. AT ALL POINTS BETWEEN DESIGNATED POINTS THE GRADE SHALL BE ESTABLISHED SO AS TO CONFORM TO A STRAIGHT LINE BEYOND BETWEEN SAID DESIGNATED POINTS.  
 ELEVATIONS ARE IN FEET ABOVE U.S. SEA LEVEL DATUM OF 1929.  
 THIS DRAWING AND THE DATA HEREON ARE HEREBY MADE A PART OF THE SPECIFICATIONS.  
 WORK SHALL BE CONSTRUCTED ACCORDING TO SPECIFICATIONS ON FILE IN THE OFFICE OF THE COUNTY ENGINEER AND SHALL BE PROSECUTED ONLY IN THE PRESENCE OF THE COUNTY ENGINEER.  
 BEFORE WORK CAN BE STARTED, THE CONTRACTOR MUST OBTAIN A PERMIT TO EXCAVATE IN COUNTY STREETS FROM THE L. A. COUNTY ROAD DEPT., 108 W. 2ND ST. AND MAKE A DEPOSIT WITH THE COUNTY ENGINEER, ROOM 228 PAN AMERICAN BUILDING, 225 SO. BROADWAY SUFFICIENT TO COVER THE COST OF CONSTRUCTION INSPECTION AND RECORD PLANS.  
 APPROVAL OF THIS PLAN BY THE COUNTY OF LOS ANGELES DOES NOT CONSTITUTE A REPRESENTATION AS TO THE ACCURACY OF THE LOCATION OF OR THE EXISTENCE OR NON-EXISTENCE OF ANY UNDERGROUND UTILITY PIPE, OR STRUCTURE WITHIN THE LIMITS OF THE PROJECT. THIS NOTE APPLIES TO ALL PAGES.  
 IF WORK IS TO BE DONE IN A STATE HIGHWAY, A PERMIT MUST BE OBTAINED FROM THE STATE OF CALIFORNIA, DIVISION OF HIGHWAYS, 120 SOUTH SPRING STREET.

COUNTY OF LOS ANGELES, CALIFORNIA

APPROVED, JOHN A. LAMBE, COUNTY ENGINEER  
 APPROVED, A. M. RAWN, CHIEF ENGINEER  
 CO. SAN. DIST. NO. 2  
 BY *J. A. Montgomery* *A. M. Rawn*  
 SANITATION ENGINEER OFFICE ENGINEER  
 CHECKED BY *J. A. Montgomery* 10-11-57  
 OFFICE OF COUNTY ENGINEER, REG. C. E. NO. 5466  
 APPROVED BY  
 INDUSTRIAL WASTE DIVISION  
 BY *Arthur V. ...* DATE 4/1/57

P.C. 4425 PAGE 2

NO CHARGE  
 FOR CONNECTIONS

25,190

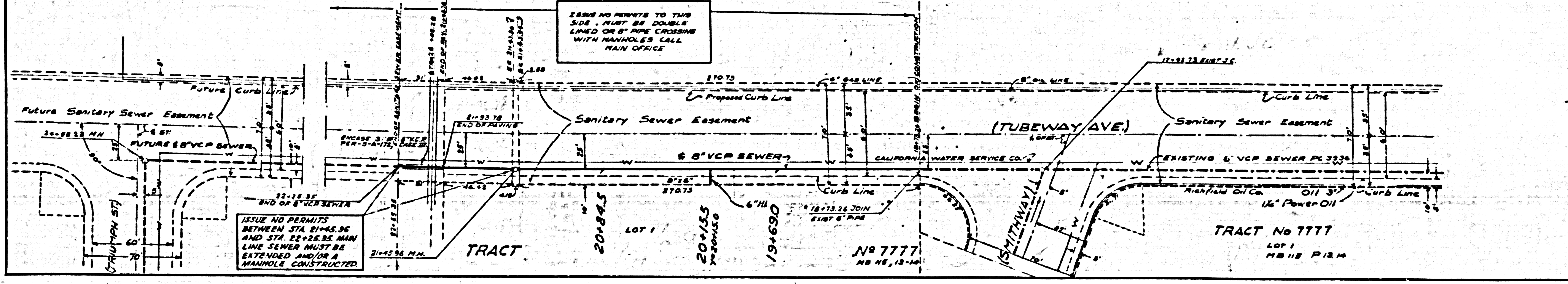
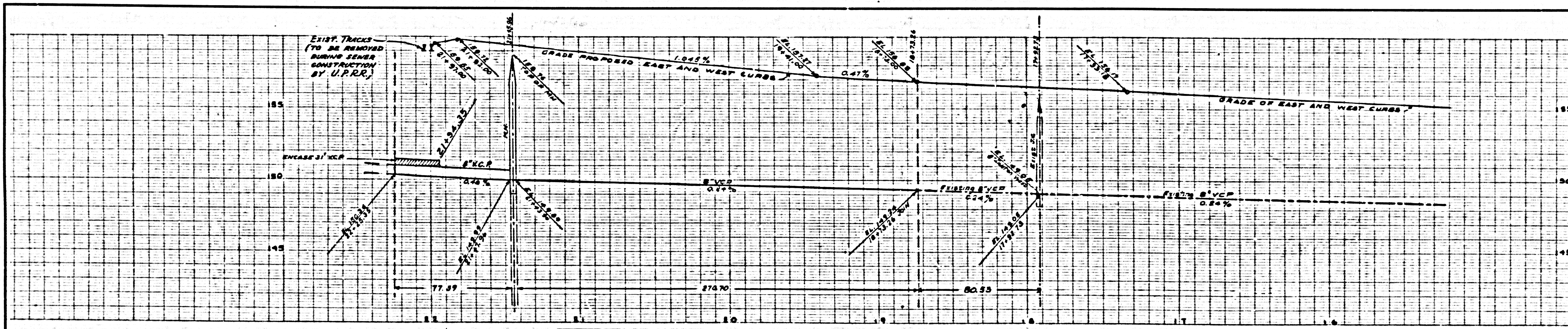

ISSUE NO PERMITS  
 BETWEEN STA 21+45.96  
 AND STA. 22+25.35 MAN  
 LINE SEWER MUST BE  
 EXTENDED AND/OR A  
 MANHOLE CONSTRUCTED.

LEAVE NO PERMITS TO THIS  
 SIDE MUST BE DOUBLE  
 LINED OR 8\"/>

P.C. 4425