

LOMITA BLDG. DIST. NO. 7/1

PROFILE ALIGNMENT AND GRADE OF P.C. 4445  
SANITARY SEWERS PAGE 1  
TO BE CONSTRUCTED IN  
MAIN STREET

PRIVATE CONTRACT NO. 4445

W.S. 25

1 SHEET, 2 PAGES

SCALE: VERT. 1" = 4' HORIZ. 1" = 40'

JULY, 1957

PREPARED IN THE OFFICES OF  
CONLEY ENGINEERING COMPANY

By Hugh G. Conley  
REG. C. E. NO. 5566

FOR LEGEND SEE PLAN NO. S-A-64

- NOTES:
- PROVIDE STAKES ON THE PROPERTY LINE OR PROPERTY LINES PRODUCED AT RIGHT ANGLES TO THE SEWER LINE AT THE CENTER LINE OF EACH MANHOLE.
  - NO REPRESENTATIVE OF THE COUNTY ENGINEER WILL SURVEY OR LAYOUT ANY PORTION OF THE WORK.
  - THE OWNER OR HIS AUTHORIZED REPRESENTATIVE SHALL FURNISH THE COUNTY ENGINEER WITH GRADE SHEETS AND STATION FOR ALL HOUSE LATERALS AND Y BRANCHES AND SHALL PROVIDE STAKES FOR THEM AT THEIR PROPER LOCATIONS WITH STATIONING PLAINLY MARKED. ANY CHANGE IN LOCATION SHALL BE REQUESTED IN WRITING BY THE OWNER OR HIS REPRESENTATIVE.
  - NO REVISIONS SHALL BE MADE IN THESE PLANS WITHOUT THE APPROVAL OF THE COUNTY ENGINEER.
  - USE STANDARD MANHOLE FRAMES AND COVERS, S-A-117, EXCEPT AS NOTED.
  - USE STANDARD STRENGTH PIPE EXCEPT AS NOTED.
  - USE CEMENT MORTAR FOR ALL VITRIFIED CLAY PIPE JOINTS.
  - RESURFACE ALL TRENCH WITHIN PAVED AREA TO MEET L. A. COUNTY ROAD DEPT., OR CALIF. STATE HIGHWAY DEPT. REQUIREMENTS IN ACCORDANCE WITH PERMITS.
  - INCREASE FOUR FEET OF SEWER AT POINTS OF INTERFERENCE WITH POLES, S-A-119.
  - HOUSE LATERALS TO BE CONSTRUCTED WITH INVERTS AT PROPERTY LINE 6 FEET BELOW 6 of Street.
  - ALL STRUCTURES SHALL BE BRICK SEWER STRUCTURES, S-A-104, EXCEPT AS NOTED.
  - FOR ALLOWABLE LEAKAGE TEST USE FORMULA NO. 1 SPECS. SEC. 39.
14. The private Engineer is to furnish the house lateral depth at the property line across the 6 of street elevation for each house lateral.

NO CHARGE FOR CONNECTIONS  
6-11-57

NOTE:  
The contractor shall notify the construction & Storm Drain Division by Telephone MA. 9-4747 Ext. 362 At least 24 hrs. before starting any work under this contract.

APPROVED:  
John L. Pette 6-12-57  
INDUSTRIAL WASTE DIVISION

NOTES:

GRADES TO WHICH THIS IMPROVEMENT IS TO BE CONSTRUCTED ARE SHOWN ON PLANS AND PROFILES. GRADE POINTS FOR TOP OF CURBS, CENTER LINE OF STREETS, OR CENTER LINE OF ALLEYS ARE SHOWN BY CIRCLES ON PROFILES AT ALL POINTS BETWEEN DESIGNATED POINTS THE GRADE SHALL BE ESTABLISHED SO AS TO COMFORM TO A STRAIGHT LINE DRAWN BETWEEN SAID DESIGNATED POINTS.

ELEVATIONS ARE IN FEET ABOVE MEAN SEA LEVEL UNLESS OTHERWISE NOTED.

THIS DRAWING AND THE DATA HEREON ARE HEREBY MADE A PART OF THE SPECIFICATIONS.

WORK SHALL BE CONSTRUCTED ACCORDING TO SPECIFICATIONS ON FILE IN THE OFFICE OF THE COUNTY ENGINEER AND SHALL BE PROSECUTED ONLY IN THE PRESENCE OF THE COUNTY ENGINEER.

BEFORE WORK CAN BE STARTED, THE CONTRACTOR MUST OBTAIN A PERMIT TO EXCAVATE IN COUNTY STREETS FROM THE L. A. COUNTY ROAD DEPT., 126 W. 2ND ST. AND MAKE A BRANCH WITH THE COUNTY ENGINEER, ROOM 234 PAV. AMERICAN BLDG., 132 S. O. BROADWAY SUFFICIENT TO COVER THE COST OF CONSTRUCTION INSPECTION AND RECORD PLANS.

APPROVAL OF THIS PLAN BY THE COUNTY OF LOS ANGELES DOES NOT CONSTITUTE A REPRESENTATION AS TO THE ACCURACY OF THE LOCATION OF OR THE EXISTENCE OR NON-EXISTENCE OF ANY UNDERGROUND UTILITY PIPE, OR STRUCTURE WITHIN THE LIMITS OF THIS PROJECT. THIS NOTE APPLIES TO ALL PAGES.

IF WORK IS TO BE DONE IN A STATE HIGHWAY, A PERMIT MUST BE OBTAINED FROM THE STATE OF CALIFORNIA, DIVISION OF HIGHWAYS, 138 SOUTH SPRING STREET.

COUNTY OF LOS ANGELES, CALIFORNIA

APPROVED, JOHN A. LAMBE, COUNTY ENGINEER

APPROVED, A. M. RAWN, CHIEF ENGINEER

BY John A. Lamb 6-12-57  
COUNTY ENGINEER

BY A. M. Rawn  
CHIEF ENGINEER

CHECKED BY A. K. Wicks 6-12-57  
OFFICE OF COUNTY ENGINEER, REG. C. E. NO. 5486

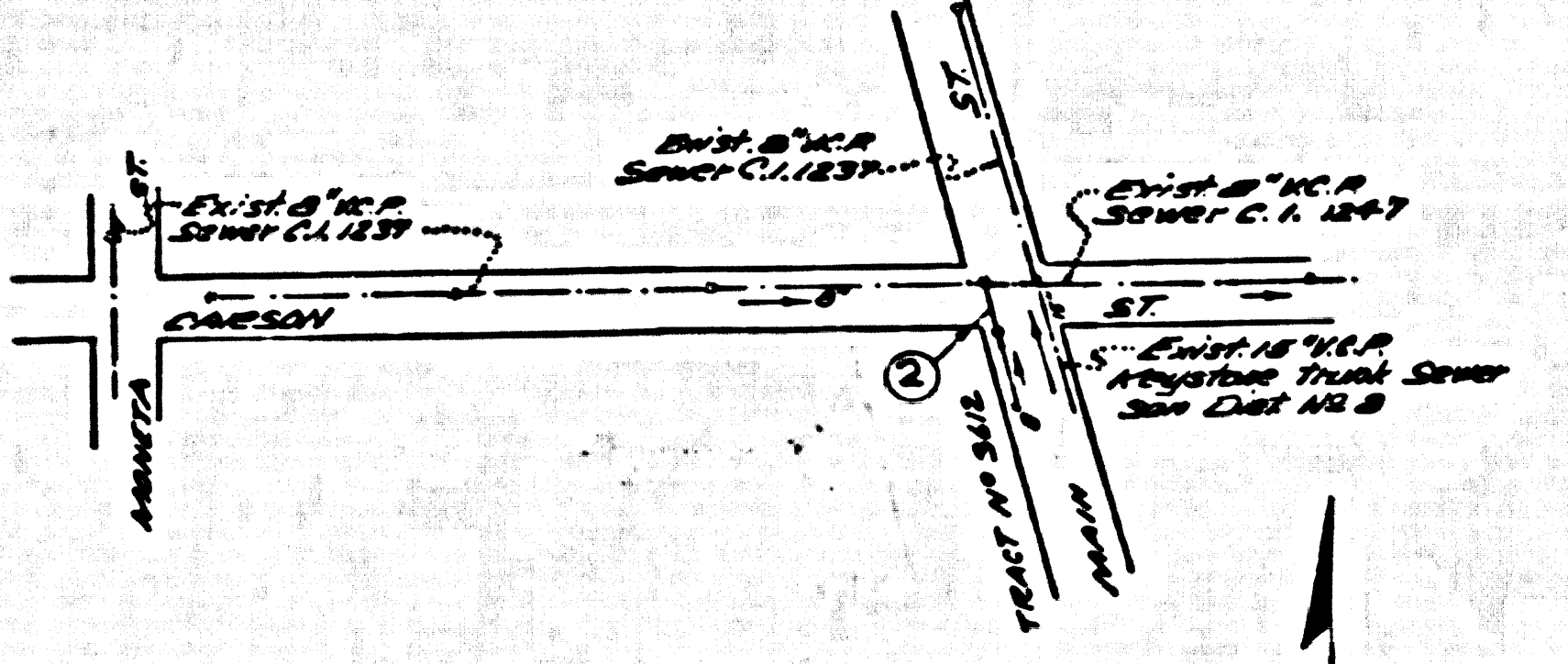

INDEX MAP  
SCALE 1" = 300'  
P.C. 4445

INDEX TABLE	
SHEETS	PAGES
1	2

1. C.M. 444-25A City 35364 P.D. 1812-184  
C.P. 502. In Part 2162.2 City of L.A.  
C.P. 502. In Part 2162.2 City of L.A.

2. C.M. 444-25E City 34364 P.D. 1812-184  
C.P. 502. In Part 2162.2 City of L.A.  
C.P. 502. In Part 2162.2 City of L.A.

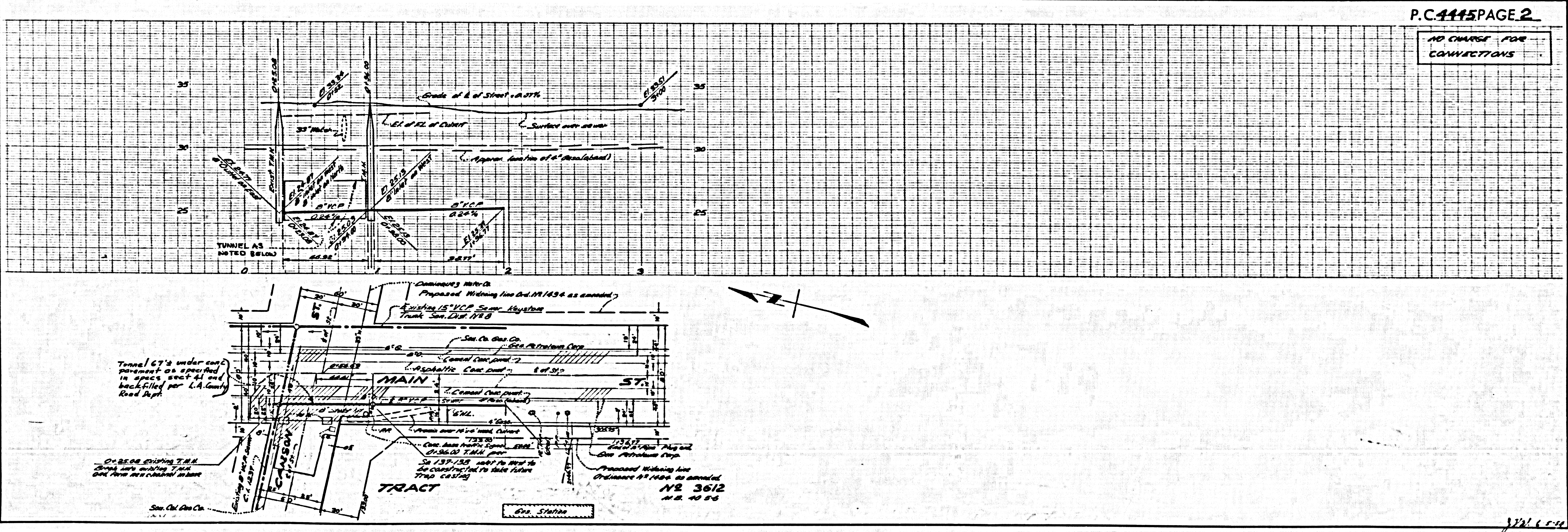

P.C. 4445 PAGE 2

NO CHARGE FOR CONNECTIONS

Tunnel 67' under pavement as specified in specs. 6-1-61 and back-filled per L.A. County Road Dept.

On 25.00 existing T.M. Brdg. into existing T.M. and from new channel above.

Proposed Widening Ord. 111484 as amended  
N2 3612  
M.S. 40 56