

LENNOX BLDG. DIST. N^o 7

THE COUNTY ENGINEER HAS REVIEWED THIS PLAN AND FOUND IT TO BE IN ACCORDANCE WITH THE SANITATION AND PUBLIC HEALTH ORDINANCES AND REGULATIONS OF THE COUNTY OF LOS ANGELES, CALIF. AT LEAST TO THE EXTENT INDICATED BY THE WORDS "AS SHOWN" AND "AS NOTED". ANY WORK UNDER THIS PLAN MUST BE DONE IN ACCORDANCE WITH THE SANITATION AND PUBLIC HEALTH ORDINANCES AND REGULATIONS OF THE COUNTY OF LOS ANGELES, CALIF. AND OBTAIN A PERMIT FROM THE COUNTY ENGINEER, ROOM 324, 255 SOUTH BROADWAY.

Private Contract No. 4452
 John A. Lambie - County Engineer
 Approved _____
 Sanitation Engineer

425
 31572

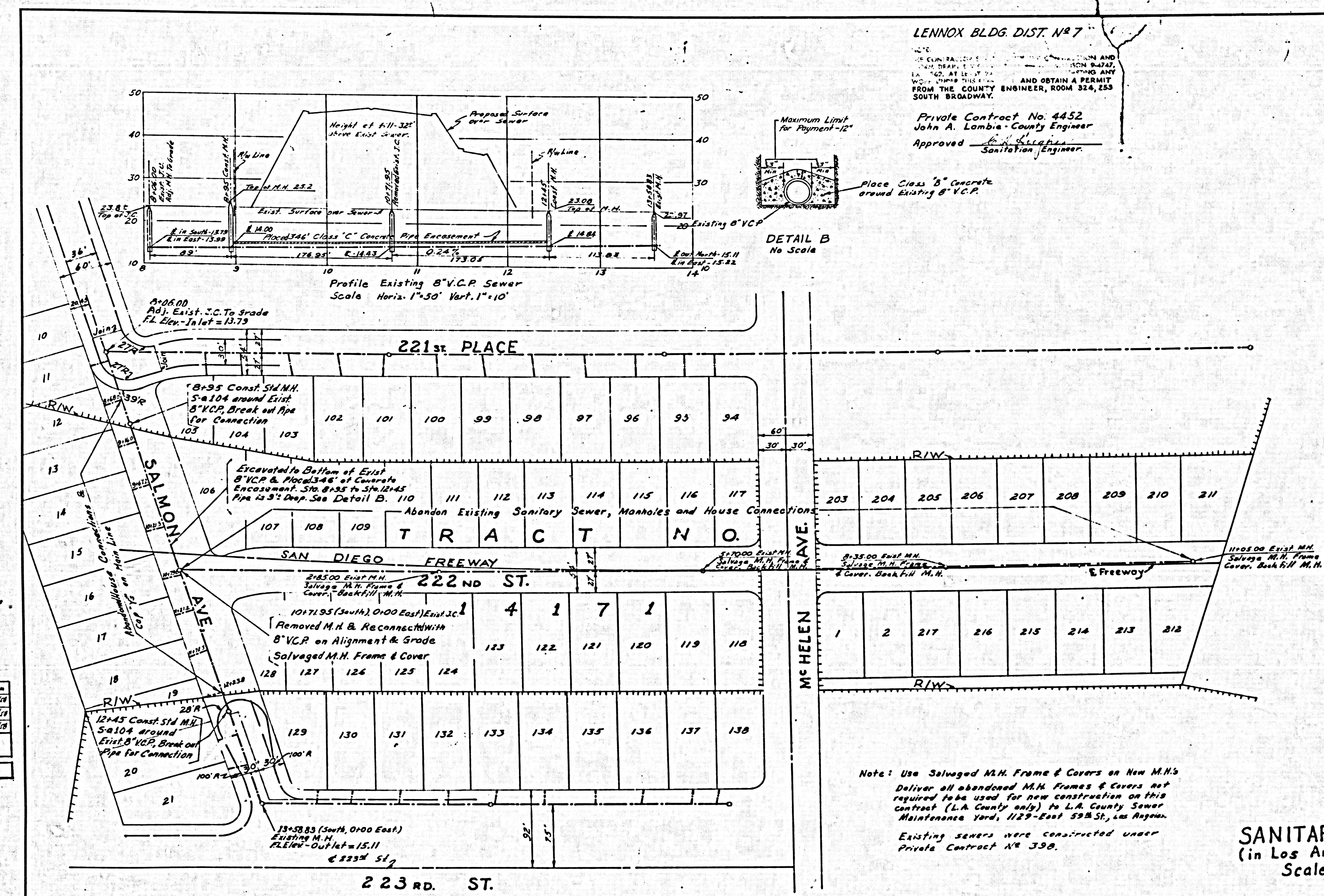

Design Dept.	100	100
Designed	EX	5/14
Traced	AM	5/14
Checked	VP	5/18
Supervised By	V. Paul	
Right of Way		

SANITARY SEWERS
 (in Los Angeles County)
 Scale 1"=50'