

VALINDA ENGINEERING CO.		W.O.
PROFILE, ALIGNMENT AND GRADE OF SANITARY SEWERS TO BE CONSTRUCTED IN SAN JOSE RANCH CO.		
DATE		SCALE - 1" = 40' HORIZ. 1" = 4' VERT.
DRAWN BY		APPROVED:
MATERIAL LIST QUANT. UNIT SIZE DESCRIP.		
1		
2		
3		
4		
5		
6		
7		
8		
9		
10		

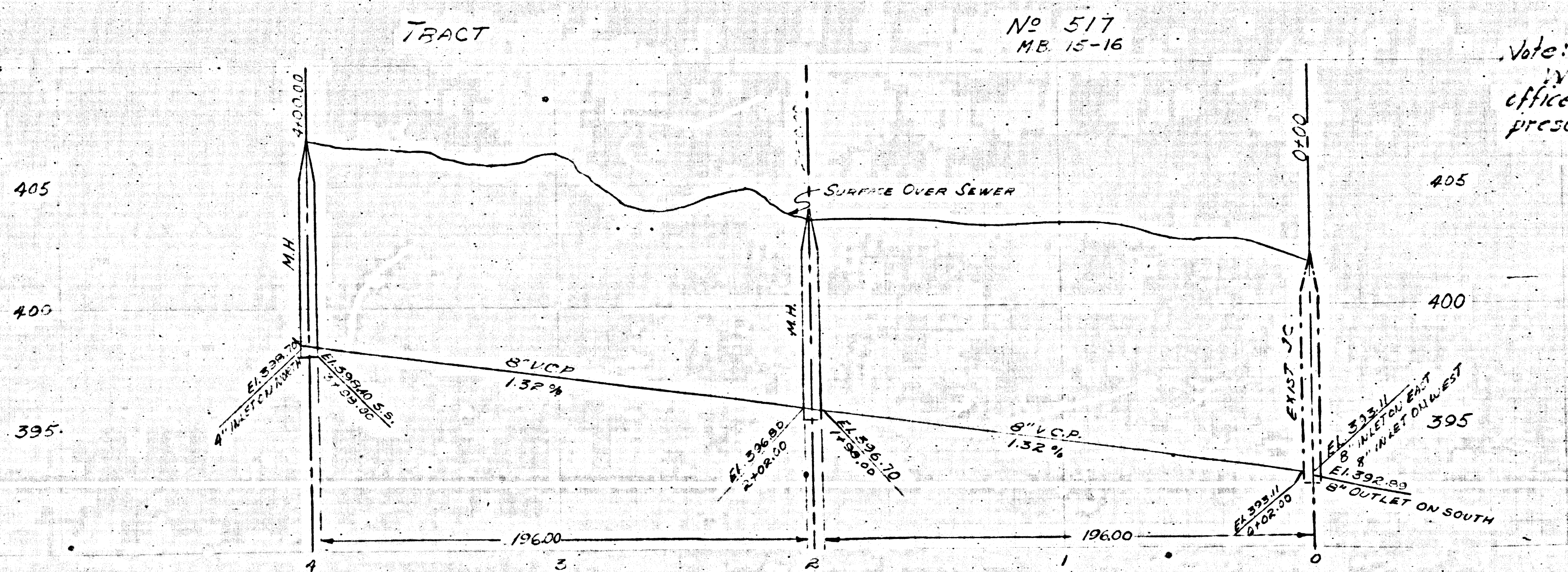

Note: Work shall be constructed according to specifications on file in the office of the County Engineer and shall be prosecuted only in the presence of the County Engineer.

B.M. S.G. 1014 EL. 327.027  
 SET L.B. NAILS CURB OF DRIVEWAY  
 TO HOUSE, N. 575 GLENDALE AVE. ± 35'  
 62.30' E. OF INTERSECTION E/11077 AVE  
 6' GLENDALE AVE ± 350' E. OF BEG. OF CURB

COUNTY OF LOS ANGELES, CALIFORNIA  
 APPROVED, JOHN A. LAMBIE, County Engineer  
 Checked by Willard V. Y. R.E. 10778  
 APPROVED, A. M. BAWN, Chief Engineer  
 Co. San. Div. No. 113  
 Office Engineer  
 Office of County Engineer Reg. C. E. No. 2425

- NOTE:
1. Use STANDARD MANHOLE FRAMES & COVERS, S-0-117 (PRIVATE RATE).
  2. Use STANDARD STRENGTH PIPE EXCEPT AS NOTED.
  3. Use CEMENT MORTAR FOR ALL VITRIFIED CLAY JOINTS.
  4. ENCASE FOUR FEET OF SEWER AT POINTS OF INTERFERENCE WITH S-0-117.
  5. ALL STRUCTURES SHALL BE BRICK SEWER STRUCTURES, S-0-104.
  6. FOR ALLOWABLE LEAKAGE TEST, USE FORMULA NO. 1 SPEC'S SEC.
  7. MANHOLE TOPS: IN UNIMPROVED RIGHTS-OF-WAY TO BE 6" ABOVE FINISH GRADE.
  8. THE CONTRACTOR SHALL NOTIFY THE CONSTRUCTION AND SPEC. DIVISION BY TELEPHONE NUMBER 3-8747 EXT. 568 AT LEAST 24 HOURS BEFORE STARTING ANY WORK UNDER THIS CONTRACT.

NOTE: Approval of this FINAL Contract is for 8" sewer only.