

S.M. 6-14 E.L.O.B. 201 CSF-6 1207 pg. 10  
Compton Blvd. & Garfield Ave. N.E. Cor.  
Well Cut in Pavement-Set in Concrete

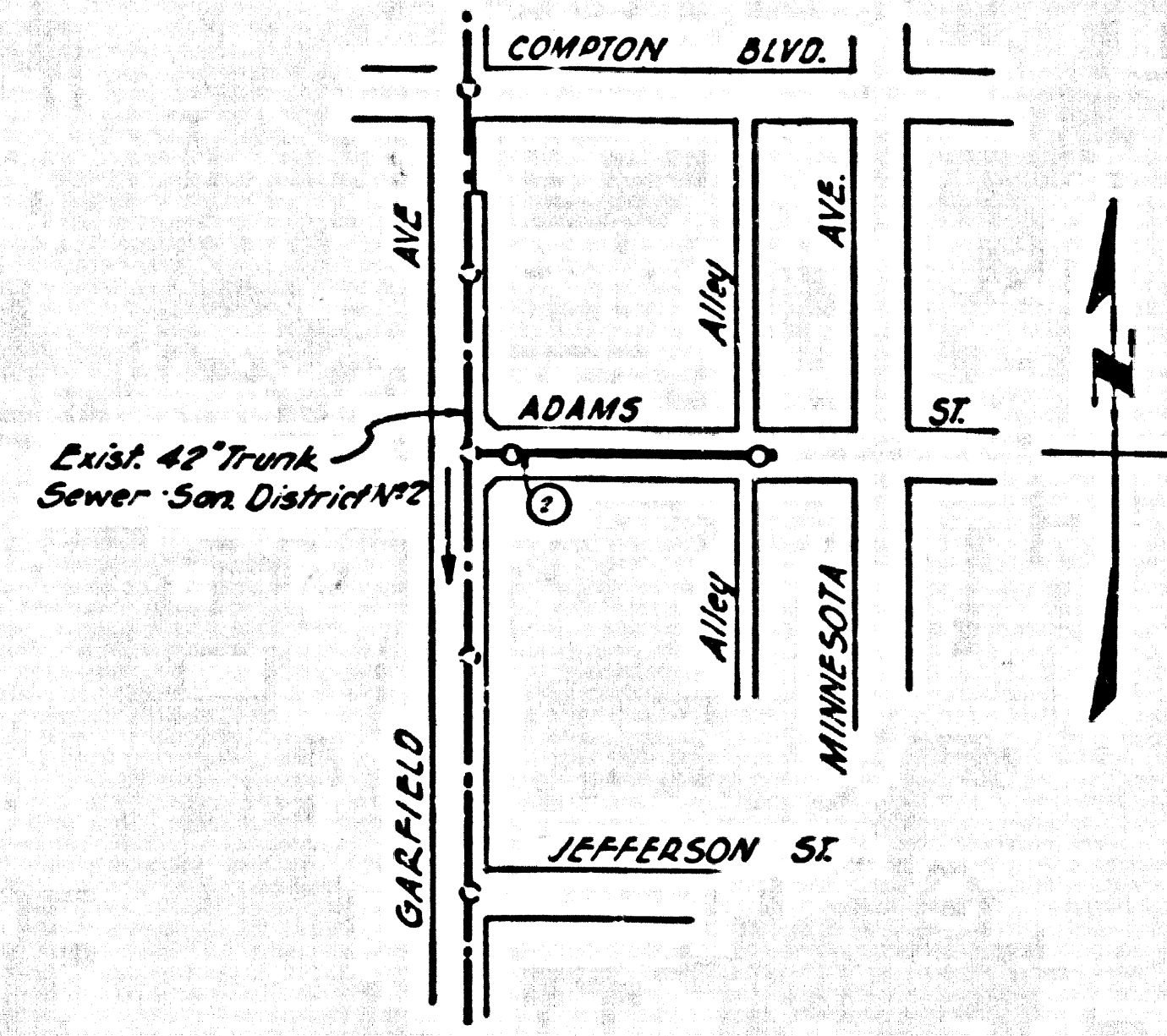

**INDEX MAP**  
Scale 1"=300'  
R.C. 4500

NOTE: Figure in Circle Indicates Page Number

**BELLFLOWER BLDG. DIST. NO. 4.**

- NOTES**
- PROPOSE GRADE ON THE PROPERTY LINE OR PROPERTY LINE PROPOSED AT SOME ANGLES TO THE SEWER LINE AT THE CORNER AND OF SAID BUILDING.
  - NO REPRESENTATIVE OF THE CITY ENGINEER WILL SURVEY OR LAYOUT ANY PORTION OF THE WORK.
  - THE OWNER OF THE APPLICABLE REPRESENTATIVE SHALL FURNISH THE CITY ENGINEER WITH GRADE SHEETS AND STATION FOR ALL HOUSE LATERALS AND T. BRANCHES AND SHALL RECEIVE GRADE SHEETS FOR THESE AT THEIR PROPER LOCATIONS WITH BRANCH AND PLUMBING MARKS. ANY CHANGE IN LOCATION SHALL BE REQUESTED IN WRITING BY THE OWNER OR HIS REPRESENTATIVE.
  - NO REVISIONS SHALL BE MADE IN THESE PLANS WITHOUT THE APPROVAL OF THE CITY ENGINEER.
  - USE STANDARD MANHOLE FRAMES AND COVERS, S.A. 117, EXCEPT AS NOTED.
  - USE STANDARD BRICKWORK FOR ALL STRUCTURE.
  - USE CHINA BLOCKS FOR ALL VITRIFIED CLAY PIPE JOINTS.
  - REINFORCE ALL STRUCTURE WITHIN PAVED AREA TO MEET L. A. COUNTY ROAD DEPT., OR CALIF. STATE HIGHWAY DEPT. GRADING REQUIREMENTS IN ACCORDANCE WITH PERMITS.
  - INDICATE POINT OF VIEW OR POINT OF INTERFERENCE WITH POULDS, S.A. 119.
  - HOUSE LATERALS TO BE CONSTRUCTED WITH BRICKS AT PROPERTY LINE. SEE SHOW GRADE OF ST. STREET.
  - ALL STRUCTURES SHALL BE BRICK STRUCTURE, S.A. 104, EXCEPT AS NOTED.
  - FOR ALLOWABLE BRIDGE USE FORMULA NO. 1, SPEC. SEC. 8-4.
  - SHOW HOW TO IMPROVED SHORT-CUTS TO BE MADE ABOVE PROPOSED GRADE.
  - THE CONTRACTOR SHALL NOTIFY THE COUNTY ENGINEER AND SPECIAL BRANCH ENGINEER BY TELEPHONE NUMBER 8-4747, 8-1134 AT LEAST 24 HOURS BEFORE STARTING ANY WORK UNDER THIS CONTRACT.
  - THE PRIVATE ENGINEER IS TO FURNISH THE HOUSE LATERAL DEPTH AS THE PROPERTY LINE BEING THE BOUNDARY OF CONTIGUOUS PROPERTY FOR EACH HALF OF LATERAL ON THE GRADE SHEET.

before breaking into any existing structure  
and before final acceptance of this work.  
County Sanitation District should be notified  
in order that required know-tice can be made.

CONNECTION CHARGES  
AS INDICATED  
C. Curtis 5-22-57

PROFILE ALIGNMENT AND GRADE OF **P.C. 4500**  
**SANITARY SEWERS** PAGE **1**  
TO BE CONSTRUCTED IN

**ADAMS STREET**  
**PRIVATE CONTRACT NO. 4500**

W.S. 32  
1 SHEET, 2 PAGES  
SCALE: HORIZ. 1"=40' JULY, 1957  
VERT. 1"=4'

PREPARED IN THE OFFICES OF  
**CURTIS ENGINEERING**  
By Charles C. Curtis  
REG. C. E. NO. 7271  
FOR LEGEND SEE PLAN NO. S-A-64

**NOTE**  
GRADES TO WHICH THIS IMPROVEMENT IS TO BE CONSTRUCTED ARE SHOWN ON PLANS AND PROFILES. GRADE POINTS FOR TOP OF CURBS, CENTER LINE OF STREETS, OR CENTER LINE OF ALLEYS ARE SHOWN BY CIRCLES ON PROFILES AT ALL POINTS BETWEEN DESIGNATED POINTS. THE GRADE SHALL BE DETERMINED SO AS TO CONFORM TO A STRAIGHT LINE BETWEEN SAID DESIGNATED POINTS.  
IF GRADES ARE IN FEET ABOVE M.S.L. 2.84 SEA LEVEL, SHOW DEPTH OF FEET.  
THIS DRAWING AND THE DATA HEREON ARE HEREBY MADE A PART OF THE SPECIFICATIONS.  
WORK SHALL BE CONSTRUCTED ACCORDING TO SPECIFICATIONS ON FILE IN THE OFFICE OF THE CITY ENGINEER AND SHALL BE INSPECTED ONLY IN THE PRESENCE OF THE CITY ENGINEER.  
A COUNTY ROAD DEPT. OR CALIF. STATE HIGHWAY DEPT. PERMITS SHALL BE OBTAINED BY THE CONTRACTOR BEFORE ANY WORK UNDER THIS CONTRACT IS STARTED. THE CONTRACTOR SHALL OBTAIN A PERMIT TO EXCAVATE BY COUNTY ENGINEER FROM THE COUNTY ENGINEER. THE CONTRACTOR SHALL OBTAIN A PERMIT TO EXCAVATE BY COUNTY ENGINEER FROM THE COUNTY ENGINEER. THE CONTRACTOR SHALL OBTAIN A PERMIT TO EXCAVATE BY COUNTY ENGINEER FROM THE COUNTY ENGINEER.  
THE CONTRACTOR SHALL BE RESPONSIBLE FOR THE COST OF CONSTRUCTION AND INSPECTION AND SHALL BE RESPONSIBLE FOR THE COST OF THE PROJECT. THE CONTRACTOR SHALL BE RESPONSIBLE FOR THE COST OF THE PROJECT. THE CONTRACTOR SHALL BE RESPONSIBLE FOR THE COST OF THE PROJECT.  
IN WORTH IT TO BE DONE IN A STATE MANNER, A PERMIT MUST BE OBTAINED FROM THE STATE OF CALIFORNIA, DIVISION OF HIGHWAYS, 120 SOUTH BRIDGE STREET.

**CITY OF PARAMOUNT, CALIFORNIA**  
APPROVED, JOHN A. LAMBE, CITY ENGINEER  
APPROVED, A. M. RAWL, CHIEF ENGINEER  
BY John A. Lambe BY A. M. Rawl  
SEAL NO. 10000  
SEAL NO. 10000  
CHECKED BY W. C. White 5-22-57  
OFFICE OF CITY ENGINEER, REG. C. E. NO. 2823

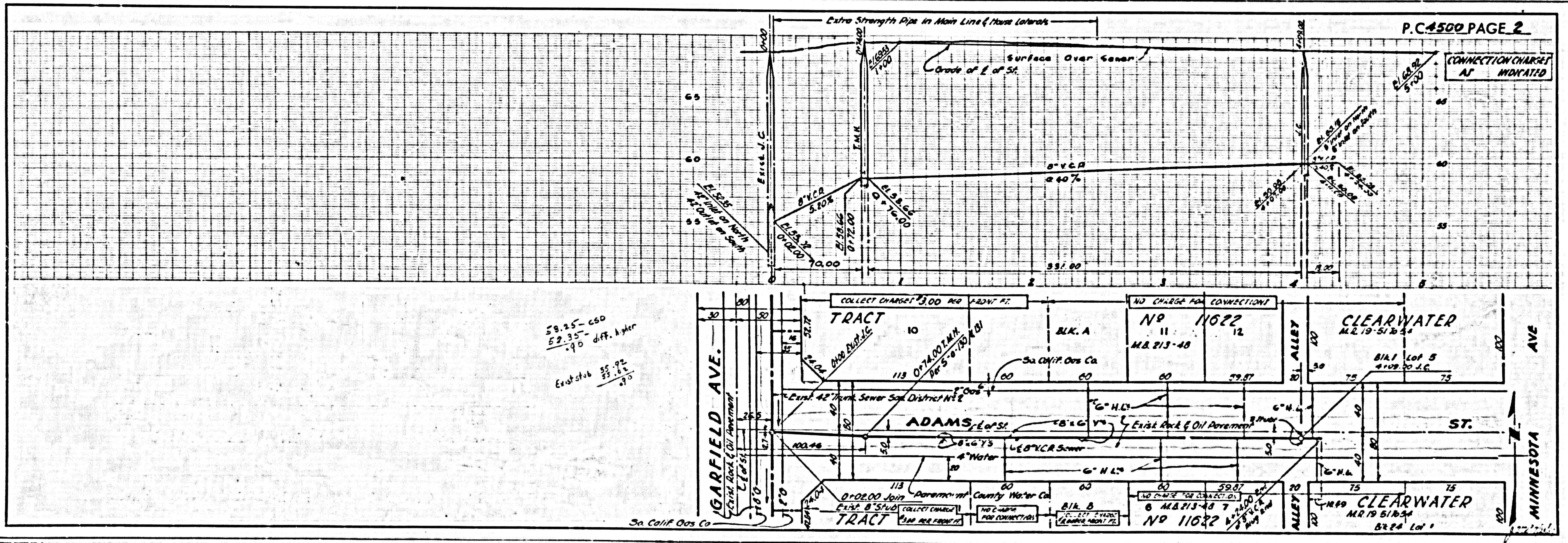

59.95 - 660  
52.35 - diff. 1.40 ft  
Exst. 42" Trunk  
55.75  
53.75

P.C. 4500 PAGE 2

CONNECTION CHARGES  
AS INDICATED