

**WHITTIER BLDG. DIST. NO. 11**

- NOTES:**
- PROVIDE STAKES ON THE PROPERTY LINE OR PROPERTY LINES PRODUCED AT RIGHT ANGLES TO THE SEWER LINE AT THE CENTER LINE OF EACH MANHOLE.
  - NO REPRESENTATIVE OF THE COUNTY ENGINEER WILL SURVEY OR LAYOUT ANY PORTION OF THE WORK.
  - THE OWNER OR HIS AUTHORIZED REPRESENTATIVE SHALL FURNISH THE COUNTY ENGINEER WITH GRADE SHEETS AND STATIONING FOR ALL HOUSE LATERALS AND T BRANCHES AND SHALL PROVIDE STAKES FOR THEM AT THEIR PROPER LOCATIONS WITH STATIONING PLAINLY MARKED. ANY CHANGE IN LOCATION SHALL BE REQUESTED IN WRITING BY THE OWNER OR HIS REPRESENTATIVE.
  - NO REVISIONS SHALL BE MADE IN THESE PLANS WITHOUT THE APPROVAL OF THE COUNTY ENGINEER.
  - USE STANDARD MANHOLE FRAMES AND COVERS, S.A. 117, EXCEPT AS NOTED.
  - USE STANDARD STRENGTH PIPE EXCEPT AS NOTED.
  - USE CHIMNEY MORTAR FOR ALL VITRIFIED CLAY PIPE JOINTS, ON "SPEED SEAL" OR "WEDGE LOCK" PER SPEC. SEC. 26.7.04.
  - REPLACE ALL TRENCH WITHIN PAVED AREA TO MEET L.A. COUNTY ROAD DEPT. OR CALIF. STATE HIGHWAY DEPT. REQUIREMENTS IN ACCORDANCE WITH PERMITS.
  - ENCASE FOUR FEET OF SEWER AT POINTS OF INTERFERENCE WITH POLES, S.A. 119.
  - HOUSE LATERALS TO BE CONSTRUCTED WITHIN IMPROVED RIGHTS-OF-WAY OR PROPERTY LINES EXCEPT AS NOTED.
  - ALL STRUCTURES SHALL BE BRICK SEWER STRUCTURES, S.A. 104, EXCEPT AS NOTED.
  - FOR ALLOWABLE LEAKAGE TEST USE FORMULA NO. 1, SPEC. SEC. 54.
  - MANHOLE TOPS IN UNIMPROVED RIGHTS-OF-WAY TO BE LEVEL WITH FINISHED GRADE.

**NOTE:**  
THE CONTRACTOR SHALL NOTIFY THE CONSTRUCTION AND STORM DRAIN DIVISION BY TELEPHONE, MADISON 9-4747, EXT. 243, AT LEAST 24 HOURS BEFORE STARTING ANY WORK UNDER THIS CONTRACT.

**NOTE:**  
THE CONTRACTOR SHALL NOTIFY UTILITY COMPANIES BEFORE STARTING CONSTRUCTION.

B.M. 51.1147. ELEV. 269.538  
Lead a nail in top of 42" standpipe  
on East edge @ S.W. cor. of Leffingwell  
Rd. @ First Ave. 4 1/2' above ground.

**NO CHARGE FOR CONNECTIONS**  
L. Brown 2-6-58

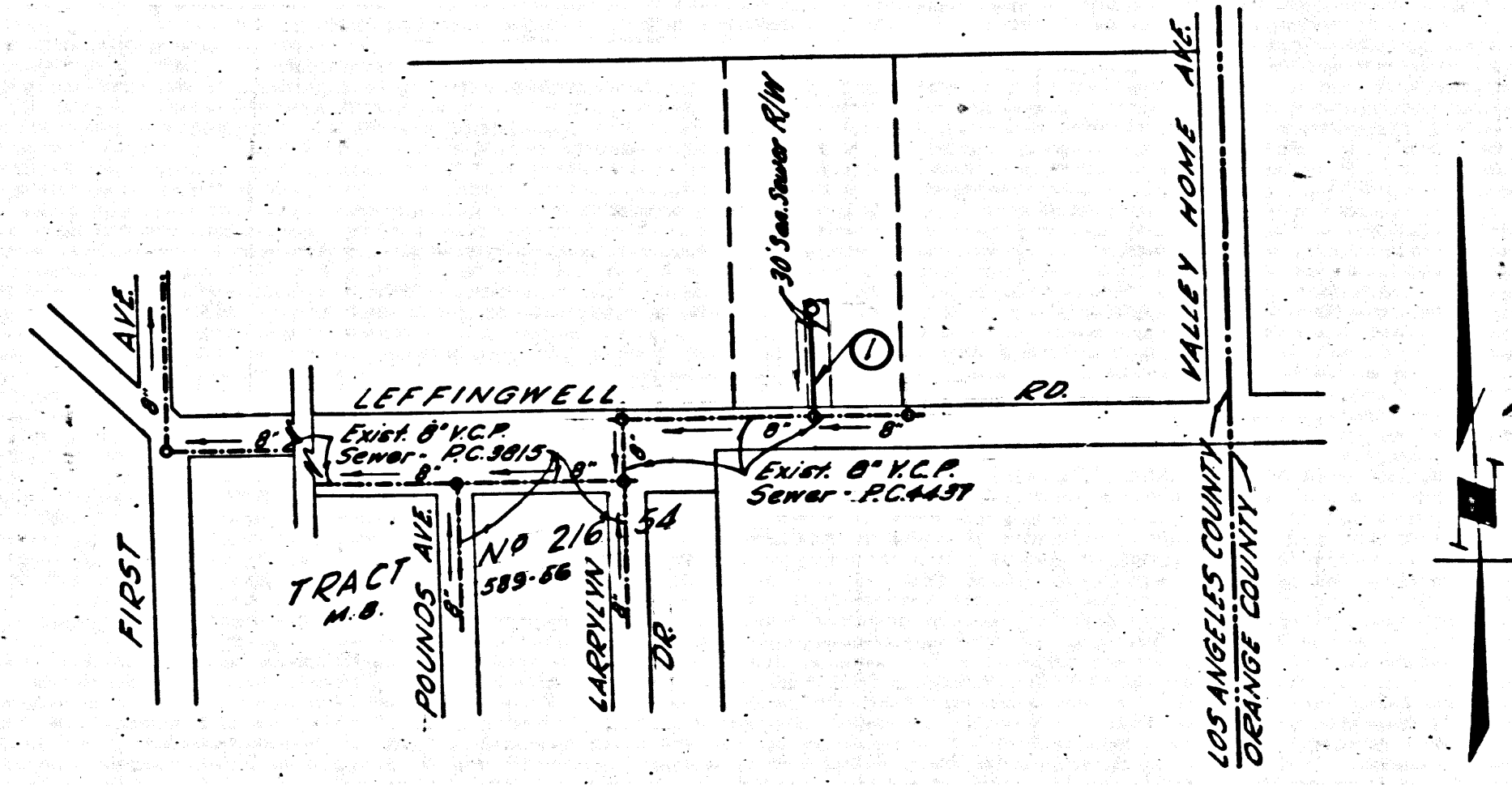

**INDEX MAP**  
Scale 1" = 300' R.C. 4527

PROFILE ALIGNMENT AND GRADE OF **P.C. 4527**  
**SANITARY SEWERS** PAGE **1**  
TO BE CONSTRUCTED IN

**SANITARY SEWER R/W**  
**NORTH OF LEFFINGWELL ROAD**  
**PRIVATE CONTRACT NO. 4527**

W.S. 3d  
1 SHEETS, 1 PAGE  
SCALE: VERT. 1" = 4'  
HORIZ. 1" = 40'  
FEB., 1958  
PREPARED IN THE OFFICES OF  
**KEMMERER ENGINEERING CO., INC.**  
By *Wanda C. Johnson*  
REG. C. E. NO. 2544

FOR LEGEND SEE PLAN NO. S-A-64  
**NOTE:**  
GRADES TO WHICH THIS IMPROVEMENT IS TO BE CONSTRUCTED ARE SHOWN ON PLANS AND PROFILES. GRADE POINTS FOR TOP OF CURB, CENTER LINE OF STREETS, OR CENTER LINE OF ALLEYS ARE SHOWN BY CIRCLES ON PROFILES. AT ALL POINTS BETWEEN DESIGNATED POINTS THE GRADE SHALL BE ESTABLISHED SO AS TO CONFORM TO A STRAIGHT LINE DRAWN BETWEEN SAID DESIGNATED POINTS.  
ELEVATIONS ARE IN FEET ABOVE U.S.C. & G.S. SEA LEVEL DATUM OF 1929.  
THIS DRAWING AND THE DATA HEREON ARE HEREBY MADE A PART OF THE SPECIFICATIONS.  
NO WORK SHALL BE CONSTRUCTED ACCORDING TO SPECIFICATIONS ON FILE IN THE OFFICE OF THE COUNTY ENGINEER AND SMALL WORK SHALL BE CONSTRUCTED ACCORDING TO SPECIFICATIONS ON FILE IN THE OFFICE OF THE COUNTY ENGINEER.  
NO PROSECUTION SHALL BE INSTITUTED UNLESS THE CONTRACTOR OBTAINS A PERMIT TO EXCAVATE IN A CITY STREET FROM THE L.A. COUNTY ROAD DEPT. THE WORK SHALL BE MADE A DEPOSIT WITH THE COUNTY ENGINEER, ROOM 224 STAN. AMERICAN BLDG., 225 SO. BROADWAY, SUFFICIENT TO COVER THE COST OF CONSTRUCTION INSPECTION AND RECORD PLANS.  
APPROVAL OF THIS PLAN BY THE COUNTY OF LOS ANGELES DOES NOT CONSTITUTE A REPRESENTATION AS TO THE ACCURACY OF THE LOCATION OF OR THE EXISTENCE OR NON-EXISTENCE OF ANY UNDERGROUND UTILITY PIPE, OR STRUCTURE WITHIN THE LIMITS OF THIS PROJECT. THIS NOTE APPLIES TO ALL PAGES.  
IF WORK IS TO BE DONE IN A STATE HIGHWAY, A PERMIT MUST BE OBTAINED FROM THE STATE OF CALIFORNIA, DIVISION OF HIGHWAYS, 120 SOUTH SPRING STREET.

**COUNTY OF LOS ANGELES, CALIFORNIA**  
APPROVED, JOHN A. LAUMB, COUNTY ENGINEER  
APPROVED, A. M. RAWN, CHIEF ENGINEER  
CO. S.A.L. DIST. NO. 18  
By *L. A. Hughes* By *C. P. Dineen*  
SANITATION ENGINEER P.E. OFFICE ENGINEER  
CHECKED BY *John L. Lutz* 2-6-58  
OFFICE OF COUNTY ENGINEER, REG. C. E. NO. 3871