

FIRESTONE BLDG. DIST. NO. 1

PROFILE ALIGNMENT AND GRADE OF **P.C. 4533**
SANITARY SEWERS PAGE **1**
 TO BE CONSTRUCTED IN
ATLANTIC AVENUE (25,233)

PRIVATE CONTRACT NO. 4533

W.S. 32

1 SHEET, 2 PAGES

SCALE: VERT. 1"=4' SEPTEMBER 1957

PREPARED IN THE OFFICES OF
T.L. MANNING ENGINEERING CO.

By J.L. Manning
 REG. C. E. NO. 7226

FOR LEGEND SEE PLAN NO. S-A-64

NOTES:
 GRADES TO WHICH THIS IMPROVEMENT IS TO BE CONSTRUCTED ARE SHOWN ON PLANS AND PROFILES. GRADE POINTS FOR TOP OF CURB, CENTER LINE OF STREET, OR CENTER LINE OF ALLEYS ARE SHOWN BY CIRCLES ON PROPERTY AT ALL POINTS BETWEEN DESIGNATED POINTS THE GRADE SHALL BE ESTABLISHED SO AS TO CONFORM TO A STRAIGHT LINE BETWEEN SAID DESIGNATED POINTS.
 ELEVATIONS ARE IN FEET ABOVE U.S.C. & G.S. MEAN SEA LEVEL DATUM OF 1929.
 THIS DRAWING AND THE DATA HEREON ARE HEREBY MADE A PART OF THE SPECIFICATIONS.
 BEFORE WORK CAN BE STARTED, THE CONTRACTOR MUST OBTAIN A PERMIT TO EXCAVATE IN COUNTY STREETS FROM THE L. A. COUNTY ROAD DEPT., 101 W. 5TH ST. AND MAKE A DEPOSIT WITH THE COUNTY ENGINEER, ROOM 304 SAN AMERICAN BUILDING, 333 SO. BROADWAY SUFFICIENT TO COVER THE COST OF CONSTRUCTION INSPECTION AND RECORD PLANS.
 APPROVAL OF THE PLAN BY THE COUNTY OF LOS ANGELES DOES NOT CONSTITUTE A REPRESENTATION AS TO THE ACCURACY OF THE LOCATION OF OR THE EXISTENCE OR NON-EXISTENCE OF ANY UNDERGROUND UTILITY PIPE, OR STRUCTURE WITHIN THE LIMITS OF THIS PROJECT. THIS NOTE APPLIES TO ALL PAGES.
 IF WORK IS TO BE DONE IN A STATE HIGHWAY, A PERMIT MUST BE OBTAINED FROM THE STATE OF CALIFORNIA, DIVISION OF HIGHWAYS, 128 SOUTH SPRING STREET.

COUNTY OF LOS ANGELES, CALIFORNIA

APPROVED, JOHN A. LAMBE, COUNTY ENGINEER

APPROVED, A. M. BAYNE, CHIEF ENGINEER

BY J.A. Hughes
 SANITATION ENGINEER

BY G.P. Bennett
 CHIEF ENGINEER

CHECKED BY Carl G. P...
 OFFICE OF COUNTY ENGINEER, REG. C. E. NO. 7, 633

Before breaking into any existing structure
 and before final acceptance of this work
 County Sanitation District should be notified
 in order that required inspection may be made.

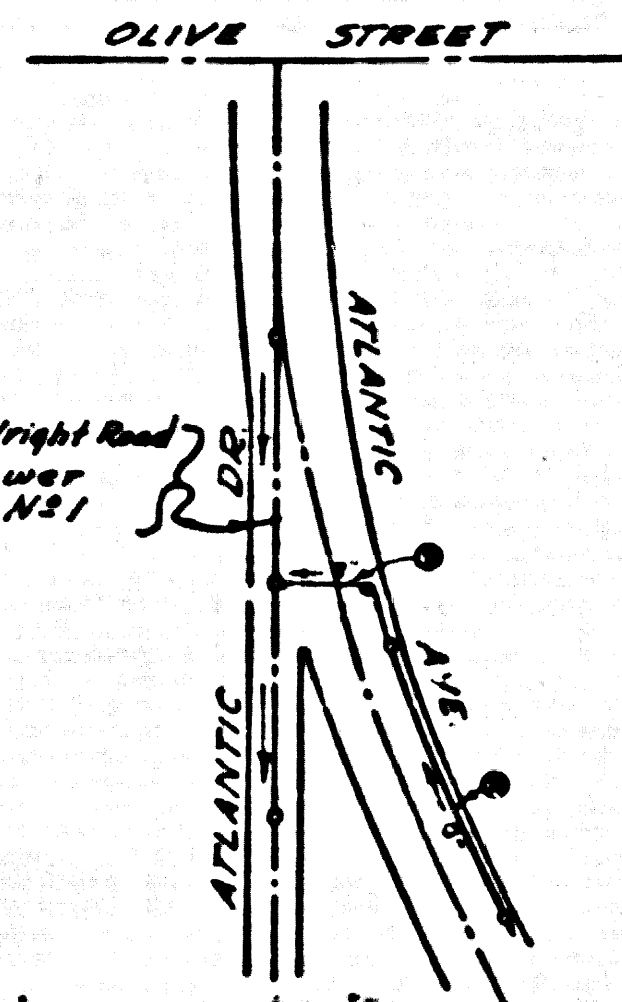

INDEX MAP
 PG. 4533
 SCALE: 1"=300'

BENCH MARK 17 ELEV. 62.0 LB 28.14 IN
 N.E. COR. OF TRINITY ISLAND
 N.E. COR. OF ATLANTIC DIST. DRIVE
 STREET 25' N. OF CURB RETURN.

NOTE:
 THE CONTRACTOR SHALL NOTIFY THE CONSTRUCTION AND STORM DRAIN DIVISION BY TELEPHONE, MADISON 94747, EXT. 362, AT LEAST 24 HOURS BEFORE STARTING ANY WORK UNDER THIS CONTRACT.

CONNECTION CHARGES
 AS INDICATED.
 See Note 10-15-57

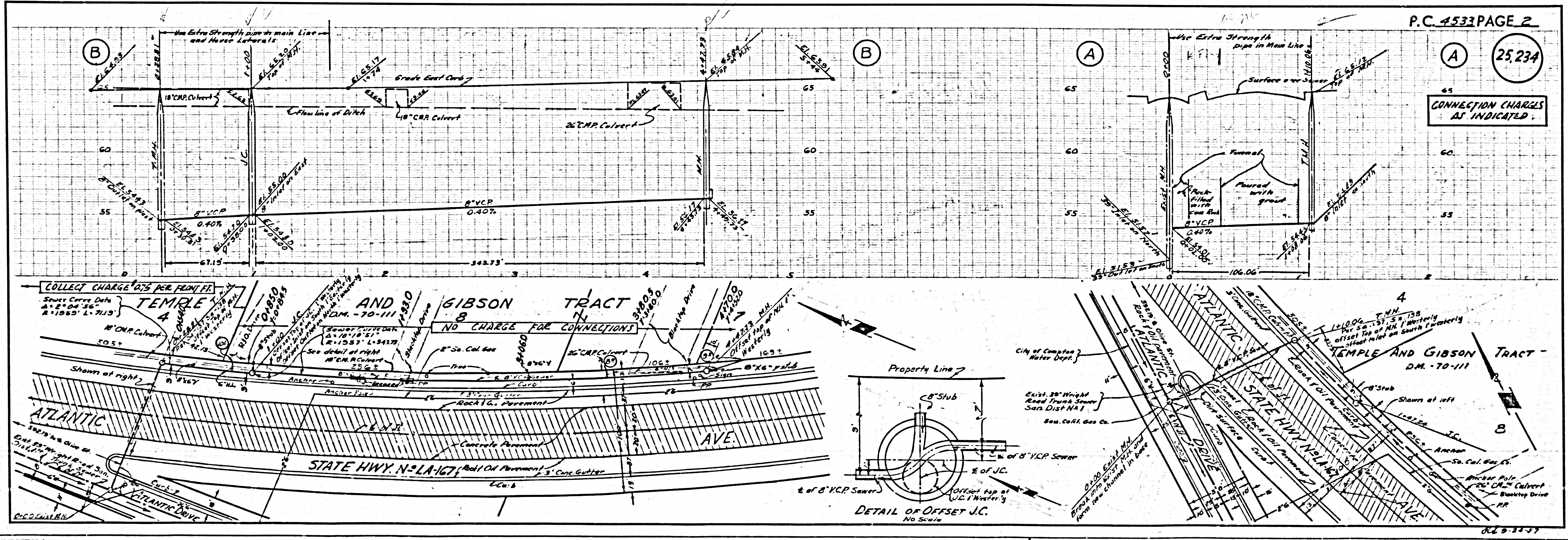

P.C. 4533 PAGE 2
(A) 25,234
CONNECTION CHARGES
 AS INDICATED.

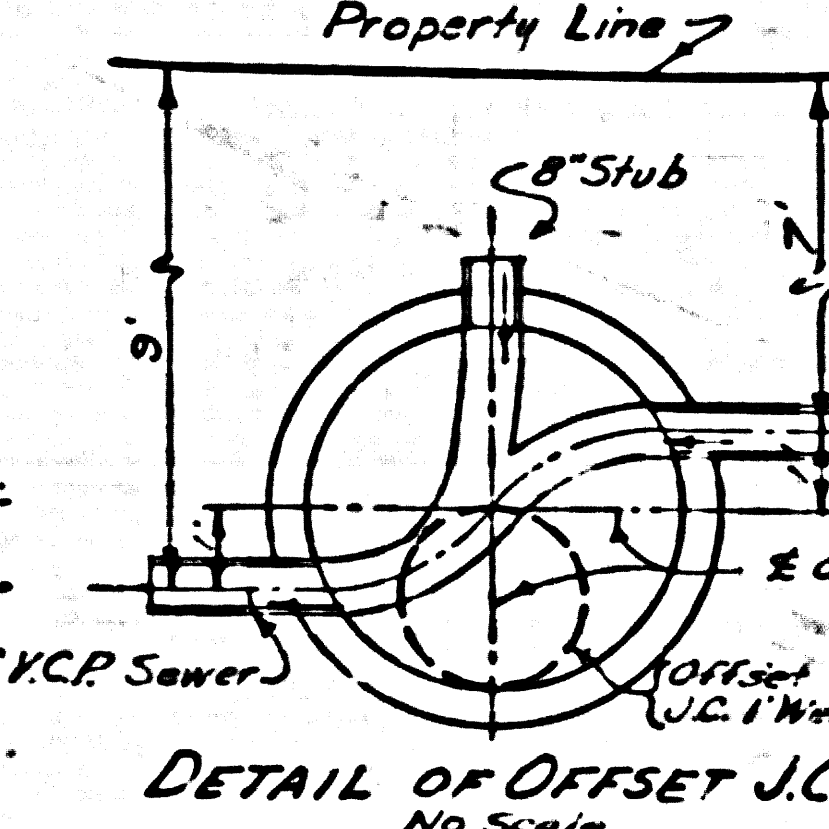

DETAIL OF OFFSET J.C.
 No Scale