

LAKWOOD BLDG. DIST. NO. 4.01

- NOTES:
- PROVIDE STAKES ON THE PROPERTY LINE OR PROPERTY LINES PRODUCED AT RIGHT ANGLES TO THE SEWER LINE AT THE CENTER LINE OF EACH MANHOLE.
  - NO REPRESENTATIVE OF THE CITY ENGINEER WILL SURVEY OR LAYOUT ANY PORTION OF THE WORK.
  - THE OWNER OR HIS AUTHORIZED REPRESENTATIVE SHALL FURNISH THE CITY ENGINEER WITH GRADE SHEETS AND STATION FOR ALL HOUSE LATERALS AND Y BRANCHES AND SHALL PROVIDE STAKES FOR THEM AT THEIR PROPER LOCATIONS WITH STATIONING PLAINLY MARKED. ANY CHANGE IN LOCATION SHALL BE REQUESTED IN WRITING BY THE OWNER OR HIS REPRESENTATIVE.
  - NO REVISIONS SHALL BE MADE IN THESE PLANS WITHOUT THE APPROVAL OF THE COUNTY ENGINEER.
  - USE STANDARD MANHOLE FRAMES AND COVERS, S.A. 117, EXCEPT AS NOTED.
  - USE STANDARD STRENGTH PIPE EXCEPT AS NOTED.
  - USE CEMENT MORTAR FOR ALL VITRIFIED CLAY PIPE JOINTS.
  - RESURFACE ALL TRENCH WITHIN PAVED AREA TO MEET L. A. COUNTY ROAD DEPT. OR CALIF. STATE HIGHWAY DEPT. REQUIREMENTS IN ACCORDANCE WITH PERMITS.
  - ENCASE FOUR FEET OF SEWER AT POINTS OF INTERFERENCE WITH POLES, S.A. 172, CASE III.
  - HOUSE LATERALS TO BE CONSTRUCTED WITH INVERTS AT PROPERTY LINE  $5\frac{1}{2}$  FEET BELOW CURB GRADE EXCEPT AS NOTED.
  - ALL STRUCTURES SHALL BE BRICK SEWER STRUCTURES, S.A. 104, EXCEPT AS NOTED.
  - FOR ALLOWABLE LEAKAGE TEST USE FORMULA NO. 1 S.P.C.S., SEC. 54.
  - MANHOLE TOPS IN UNIMPROVED RIGHTS-OF-WAY TO BE 6" ABOVE FINISHED GRADE.
  - The private Engineer is to furnish the House Lateral depth at the property line below the elevation of centerline of Alley and top of Curb elevation for each House Lateral on the Grade Sheet.
  - The Contractor shall secure a sewer construction permit from the city of Long Beach; an encroachment permit from the state division of highways must be obtained before this permit is issued.

PROFILE ALIGNMENT AND GRADE OF P.C. 4548  
SANITARY SEWERS PAGE 1

TO BE CONSTRUCTED IN  
**CARSON STREET** (25251)

PRIVATE CONTRACT NO. 4548

W.S. 31  
1 SHEETS, 2 PAGES

SCALE: HORIZ. 1" = 40' VERT. 1" = 4' AUGUST, 1957

PREPARED IN THE OFFICES OF  
**TEGART ENGINEERS**

BY *Harold M. Tegtart*  
REG. C. E. NO. 2151

FOR LEGEND SEE PLAN NO. S-A-64

NOTE:  
THE CONTRACTOR SHALL NOTIFY THE CONSTRUCTION AND STORM DRAIN DIVISION BY TELEPHONE, MADSON 9-4747, EXT. 362, AT LEAST 24 HOURS BEFORE STARTING ANY WORK UNDER THIS CONTRACT.

ISSUE NO PERMITS  
UNTIL RIW IS CLEAR

B.M. SY 138 ELEV. 45.637  
WOODRUFF & CARSON ST.  
L.A.M. IN WEST CURB WOODRUFF ST.  
SO. OF CURB RET. @ S.W. COR. CARSON ST.  
L. A. Co. Road Dept.

Note:  
The contractor shall verify and be responsible for the location of all substructures.

APPROVED *Chalmers Bauer*  
City of Long Beach

NO CHARGE FOR  
CONNECTIONS  
*Sheet 10-17-57*

APPROVED FOR INDUSTRIAL WASTE  
*By Jack Irvine*

NOTE:  
GRADES TO WHICH THIS IMPROVEMENT IS TO BE CONSTRUCTED ARE SHOWN ON PLANS AND PROFILES. GRADE POINTS FOR TOP OF CURB, CENTER LINE OF STREETS, OR CENTER LINE OF ALLEYS ARE SHOWN BY CIRCLES OR PROFILES. AT ALL POINTS BETWEEN DESIGNATED POINTS THE GRADE SHALL BE ESTABLISHED SO AS TO CONFORM TO A STRAIGHT LINE DRAWN BETWEEN SAID DESIGNATED POINTS.  
ELEVATIONS ARE IN FEET ABOVE U.S.C. & G.S. SEA LEVEL DATUM OF 1929.  
THIS DRAWING AND THE DATA HEREON ARE HEREBY MADE A PART OF THE SPECIFICATIONS.  
WORK SHALL BE CONSTRUCTED ACCORDING TO SPECIFICATIONS ON FILE IN THE OFFICE OF THE CITY ENGINEER AND SHALL BE PROSECUTED ONLY IN THE PRESENCE OF THE COUNTY ENGINEER.  
BEFORE WORK CAN BE STARTED, THE CONTRACTOR MUST OBTAIN A PERMIT TO EXCAVATE IN COUNTY STREETS FROM THE L. A. COUNTY ROAD DEPT., 100 W. 2ND ST. AND MAKE A DEPOSIT WITH THE CITY ENGINEER, ROOM 354 PAN AMERICAN BUILDING, 315 SO. BROADWAY SUFFICIENT TO COVER THE COST OF CONSTRUCTION INSPECTION AND RECORD PLANS.  
APPROVAL OF THIS PLAN BY THE CITY OF LAKEWOOD DOES NOT CONSTITUTE A REPRESENTATION AS TO THE ACCURACY OF THE LOCATION OR OF THE EXISTENCE OR NON-EXISTENCE OF ANY UNDERGROUND UTILITY PIPE, OR STRUCTURE WITHIN THE LIMITS OF THIS PROJECT. THIS NOTE APPLIES TO ALL PAGES.  
IF WORK IS TO BE DONE IN A STATE HIGHWAY, A PERMIT MUST BE OBTAINED FROM THE STATE OF CALIFORNIA, DIVISION OF HIGHWAYS, 130 SOUTH SPRING STREET.

CITY OF LAKEWOOD, CALIFORNIA

APPROVED, JOHN A. LAMBE, CITY ENGINEER  
APPROVED, A. M. RAWIN, CHIEF ENGINEER

BY *J. A. Lambe* BY *A. M. Rawin*  
SANITATION ENGINEER CIVIL ENGINEER

CHECKED BY *St. Oude 10-31-57*  
OFFICE OF CITY ENGINEER, BOX C. E. NO. 2406

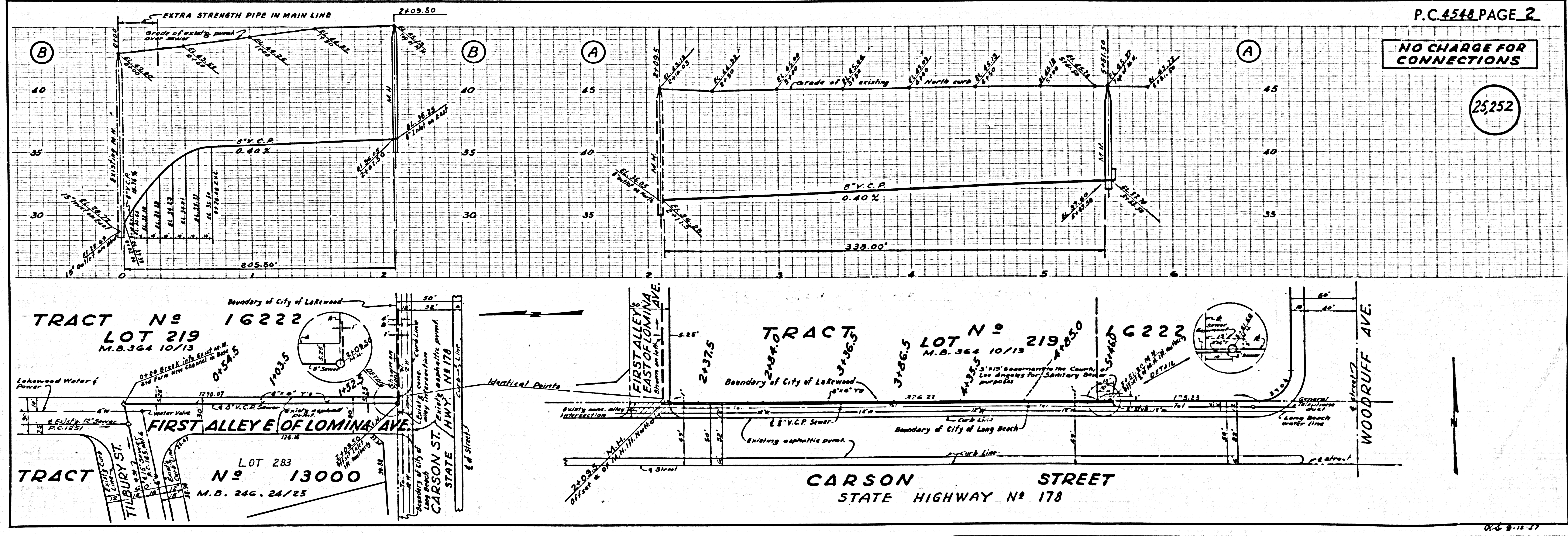

P.C. 4548 PAGE 2

NO CHARGE FOR  
CONNECTIONS

(25252)