

25,650

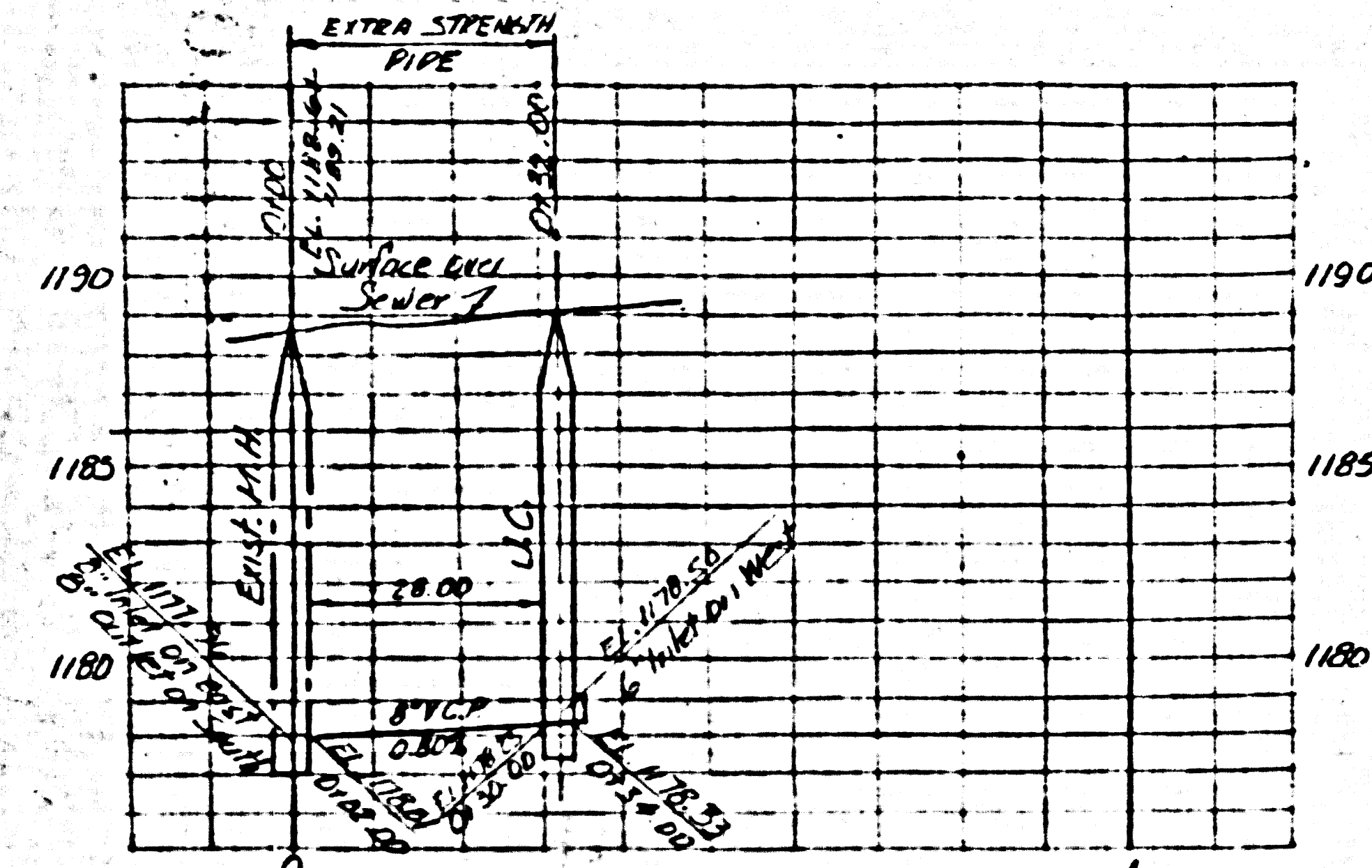

SCALE: HORIZ. 1"=20'
VERT. 1"=4'

NOTES:
SEWER LINE SHALL HAVE A MIN. COVER OF 3'-0" FROM TOP OF PIPE TO ADJOINING GRADE. MIN. SLOPE SHALL BE 0.005

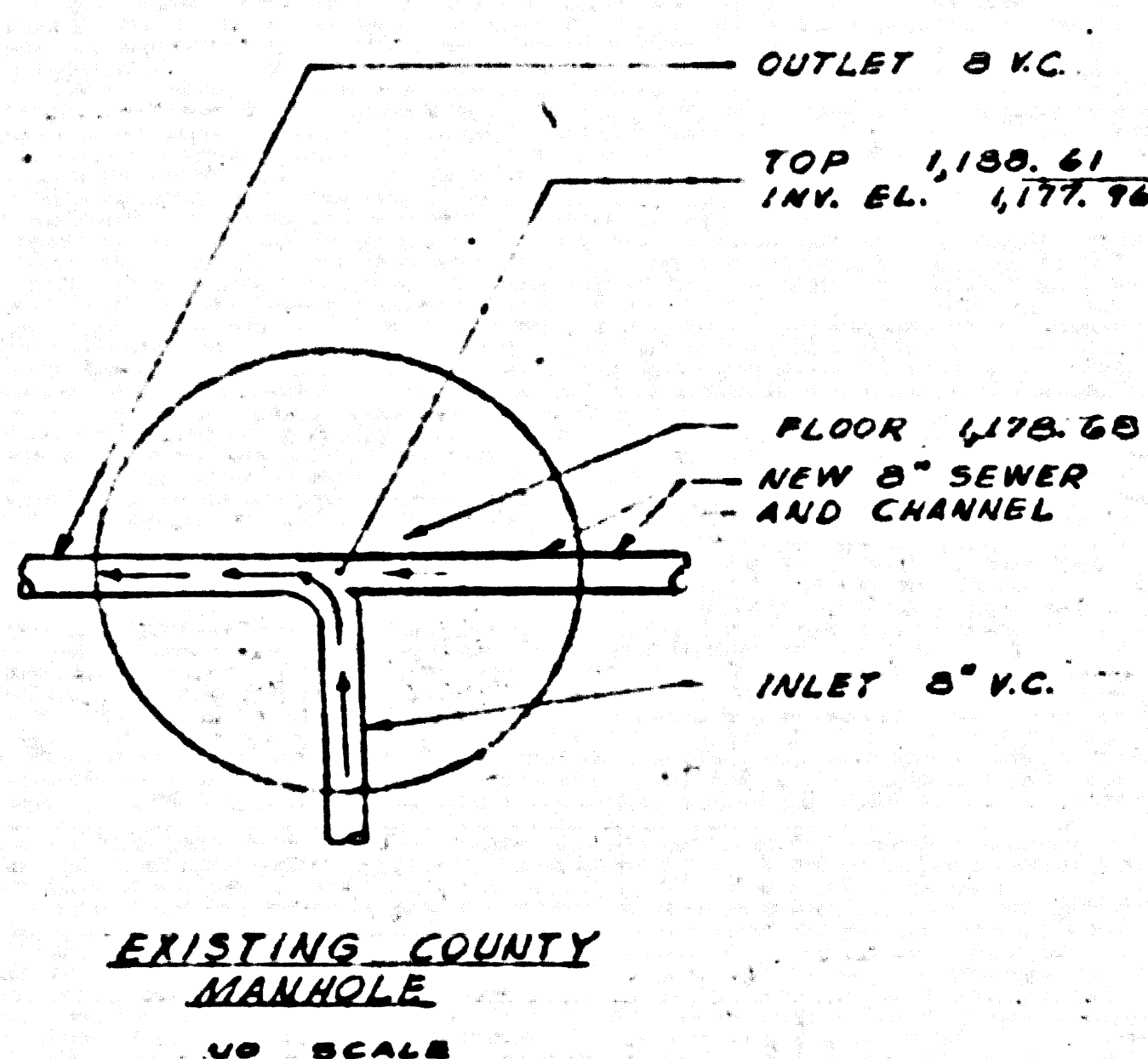

EXISTING COUNTY MANHOLE
NO SCALE

- LEGEND**
- D. FLOOR DRAIN
 - B. BATH TUB
 - K. SINK
 - S. SHOWER
 - T. WATERCLOSET
 - U. URINAL
 - W. WASH BASIN
 - M.H. MANHOLE
 - C.I. CAST IRON
 - V.C. VITRIFIED CLAY
 - G.C.O. GRADE CLEAN OUT
 - J.C. JUNCTION CHAMBER

- Note:
No representative of the County Engineer will survey or layout any portion of the work.
No revisions shall be made in these plans without approval of the County Engineer.
- Use standard manhole frames and covers, S-117, except as noted.
 - Use standard strength pipe, except as noted.
 - Use standard mortar for all vitrified clay pipe joints.
 - Reinforce all trench within paved areas to meet Los Angeles County Road Department or California State Highway requirements, in accordance with permit.
 - Enclose four feet of sewer at points of interference with poles as per S-119.
 - All structures shall be brick sewer structures S-104, except as noted.
 - For allowable leakage test use Formula No. 1, Spec's, Sec. 34.

Note:
Elevations are in feet above U.S.C. & G.S. Sea Level Datum of 1929.
This Drawing and the data hereon are hereby made a part of the specifications.
Work shall be constructed according to specifications on file in the office of the County Engineer and shall be prosecuted only in the presence of the County Engineer.
Before work can be started, the contractor must obtain a permit to excavate in County streets from the L. A. County Road Department, 108 West Second Street and a permit to cover construction excavation and record plans from the County Engineer, Room 324, 253 South Broadway.
If work is to be done in a state highway, a permit must be obtained from the State of California, Division of Highways, 120 South Spring Street.
Approval of this plan by the County of Los Angeles does not constitute a representation as to the accuracy of the location of, or the existence or non-existence of, any underground utility, pipe, or structure within the limits of this project.

R.M. LOS ANGELES CO. SURVEYORS' MONUMENT
F-2 ELEV. 1180.62
A BENCH MARK IN THE INTERSECTION OF LINCOLN STREET AND LINCOLN ROAD 113 ALTADENA

1007.
D-100 EXIST. M.H. BENCH MARK EXIST. M.H. AND FORM NEW CHANNEL IN BASE
EXIST. 8" V.C.P. SEWER - C.I. 1182-11 M. SOUTHWEST GAS CO.
Lynch Avenue Water Co.

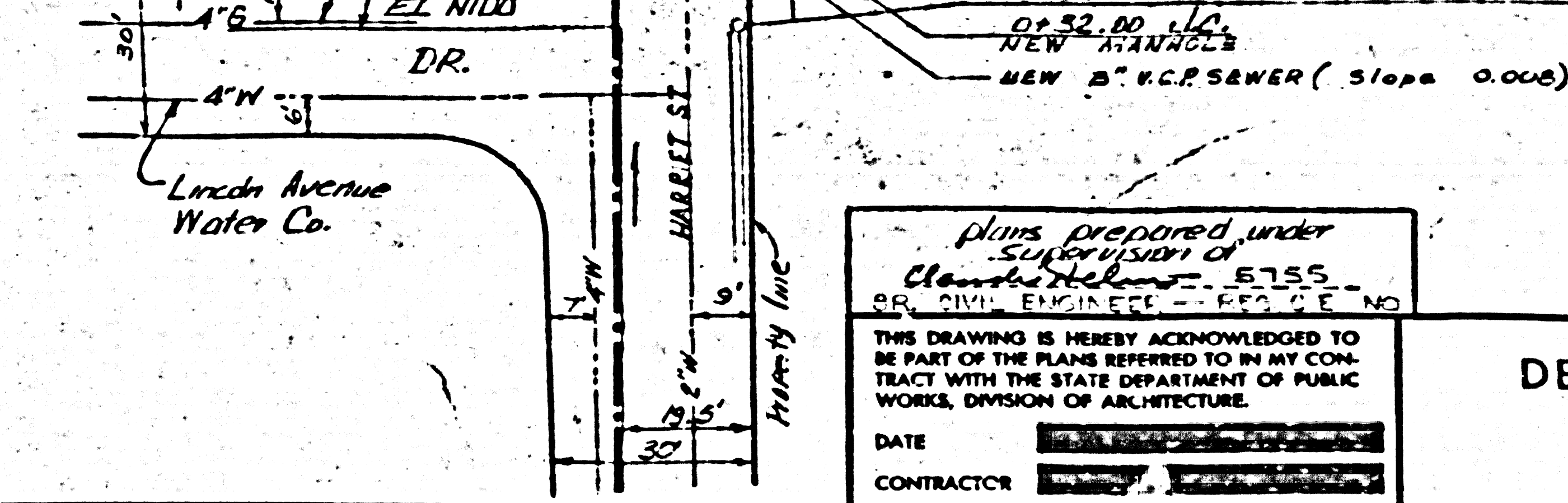
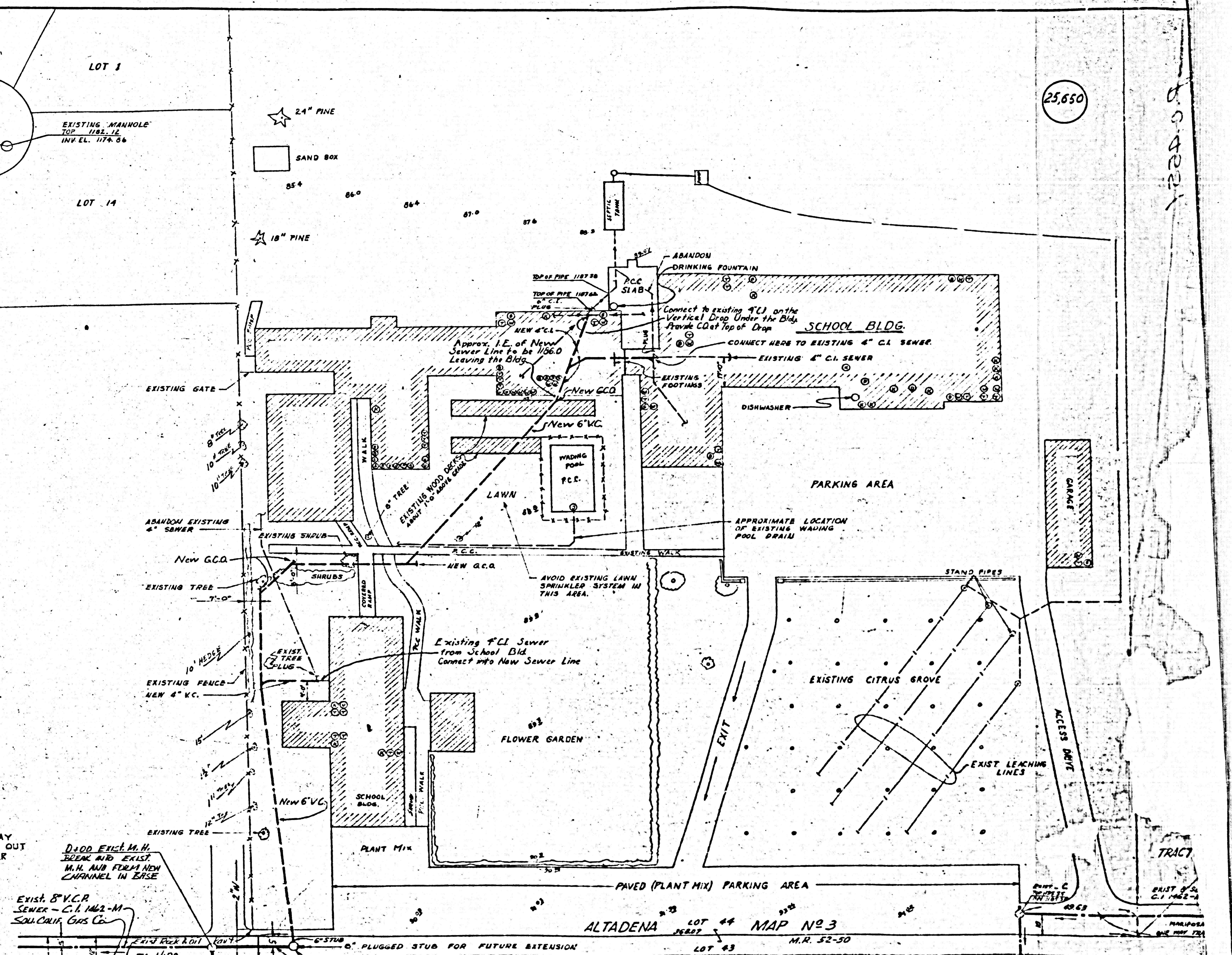

NOTE:
THE CONTRACTOR SHALL NOTIFY THE CONSTRUCTION AND STORM DRAIN DIVISION BY TELEPHONE, RADIOS, BULLET, ETC., AT LEAST 24 HOURS BEFORE STARTING ANY WORK UNDER THIS CONTRACT.
INSPECTION OF THE 6\"/>

COUNTY OF LOS ANGELES, CALIFORNIA
APPROVED, JOHN A. LAMBE, County Engineer
By: [Signature] Assistant Sanitation Engineer
APPROVED, A. M. BAWN, Chief Engineer
By: [Signature] Office Engineer
Checked: [Signature] 12-11-57
Office of County Engineer Reg. C. E. No. 2556

PRIVATE CONTRACT NO. ALTADENA BLDG DIST. NO. 44 MAP NO. 3
W.S. & B.R. No. 1 Guide 2-11-57 SHEETS 1

NOTE:
The above is drawn by the County Engineer and as to the following:
(a) All 8 inch or larger sanitary sewer lines.
(b) All manholes.

DESIGNED: DATE: 1-16-57
BY: A. A. Damm
CHECKED: 4-16-57
BY: [Signature]
SCALE: 1"=20'-0"
P.C. 4551

STATE OF CALIFORNIA
DEPARTMENT OF PUBLIC WORKS
DIVISION OF ARCHITECTURE
LOS ANGELES BRANCH OFFICE
BY ASSISTANT STATE ARCHITECT

DESIGNED	DATE	1-16-57
BY	BY	A. A. Damm
CHECKED	DATE	4-16-57
BY	BY	[Signature]

SHEET TITLE: SEWER PLAN
PROJECT: CORRECTION OF SEWAGE DISPOSAL SYSTEM
INSTITUTION SCHOOL FOR CEREBRAL PALSID CHILDREN
LOCATION: ALTADENA