

D.M.L-1 Elev 56.107 F.B. 2160, pg. 52  
 SOUTH ST. (S. side), 350' E. of E. of Woodruff Ave.  
 Di. 24" in 10' W. car. base of Parking Area Light.  
 For additional D.M.s. used on this improvement, see printed list

LAKEWOOD-BUILD. DIST. NO. 4.01

J.N.0860.06

PG. 4577  
 PAGE 1

COUNTY JOB NO. 0860.06

26,158

PROFILE, ALIGNMENT AND GRADE OF  
 SANITARY SEWERS

TO BE CONSTRUCTED IN  
**WOODRUFF AVENUE**  
 AND OTHER RIGHTS OF WAY  
**P.C. 4577**  
 PAGE 1 OF 3 PAGES

CITY OF LAKEWOOD, CALIFORNIA  
 JOHN A. LAMBIE CITY ENGINEER

SUBMITTED *H.P. Brander* ASSISTANT SANITATION ENGINEER  
 APPROVED *B.H. Hughes* SANITATION ENGINEER

A. M. RAWN  
 CHIEF ENGINEER OF COUNTY  
 SANITATION DISTRICT NO. 2  
 BY *A. M. Rawn* OFFICE ENGINEER

FOR LEGEND  
 SEE PLAN NO. S-A-64

NOTE: GRADES TO WHICH THIS IMPROVEMENT IS TO BE CONSTRUCTED ARE SHOWN ON PLANS AND PROFILES. GRADE POINTS FOR TOP OF CURB, CENTER LINE OF STREET OR CENTER LINE OF ALLEY ARE SHOWN BY CIRCLES ON PROFILES. AT ALL POINTS BETWEEN DESIGNATED POINTS THE GRADE SHALL BE ESTABLISHED SO AS TO CONFORM TO A STRAIGHT LINE DRAWN BETWEEN SAID DESIGNATED POINTS.  
 ELEVATIONS ARE IN FEET ABOVE U. S. C. & G. SEA LEVEL, DATUM OF 1929.  
 UNIT PRICES FOR ADDITIONAL WORK WHICH MAY BE REQUIRED BUT WHICH CANNOT BE ASCERTAINED IN ADVANCE, SHALL BE SUBMITTED IN THE PROPOSAL.  
 THIS DRAWING AND THE DATA HEREON ARE HEREBY MADE A PART OF THE SPECIFICATIONS.

REFERENCES	DESIGNED	WYTEN	Febr 1958
W. S. 33 B-5	TRACED	WYTEN	Febr 1958
A. B. 351 Pt 3, 990 Pt 3	CHECKED	M. V. BELL	Apr 1958
F. B. 2160			

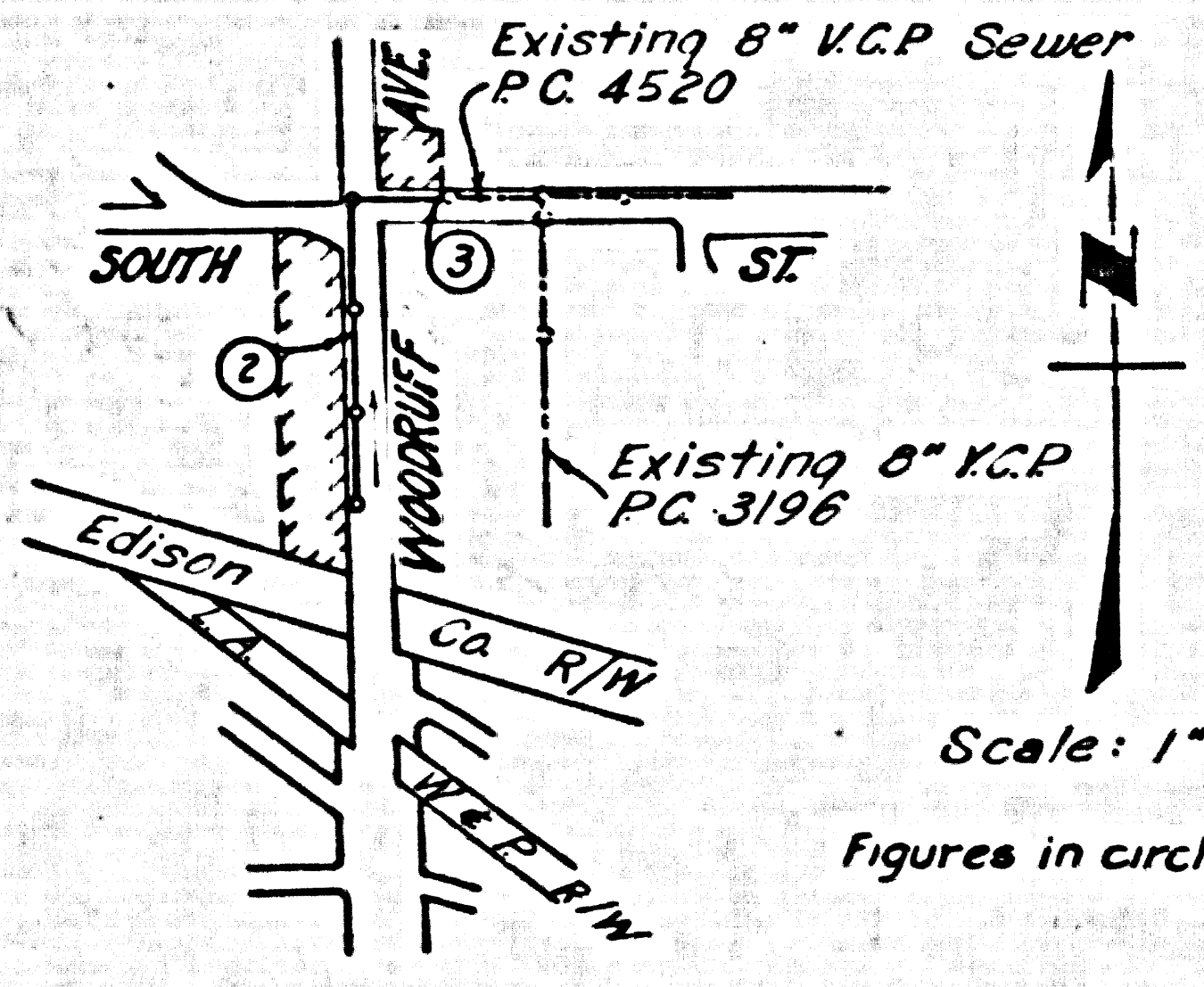

Scale: 1"=600'  
 Figures in circles indicate page numbers

INDEX MAP  
 P.C. 4577  
 J.N. 0860.06

NO CONNECTION CHARGES

USE STANDARD STRENGTH PIPE EXCEPT AS NOTED.  
 USE CEMENT MORTAR FOR ALL VITRIFIED CLAY PIPE JOINTS.

CONSTRUCT HOUSE LATERALS WITH 1/4 INCH RISE PER FT. TO PROPERTY LINE, EXCEPT AS NOTED.  
 ALL STRUCTURES SHALL BE BRICK SEWER STRUCTURES AS PER PLAN NO. S-A-104, EXCEPT AS NOTED.  
 USE STANDARD MANHOLE FRAMES AND COVERS AS PER PLAN NO. S-A-117, EXCEPT AS NOTED.

RESURFACE TRENCH WITHIN PAVED AREA WITH PREMIX ROCK AND OIL 4 INCHES IN THICKNESS ON 6 INCHES OF AGGREGATE BASE MATERIAL EXCEPT AS NOTED

CONSTRUCTION IN STATE HIGHWAYS SHALL CONFORM WITH STATE HIGHWAY PERMIT.

USE FORMULA NO. 1 SEC. 51 OF SPECIFICATIONS TO COMPUTE ALLOWABLE LEAKAGE.

WHERE PAVING IS CUT A TEMPORARY SURFACE OF PREMIX ROCK AND OIL SHALL BE INSTALLED AND MAINTAINED, AT THE CONTRACTOR'S EXPENSE, UNTIL FINAL RESURFACING IS COMPLETED.

AT THE INTERSECTION OF WOODRUFF AVE AND SOUTH ST ONE LANE OF TRAFFIC IN EACH DIRECTION SHALL BE KEPT OPEN AT ALL TIMES. IF THE CONCRETE PAVING IS CUT IT SHALL BE RESURFACED WITH CEMENT CONCRETE 9 INCHES IN THICKNESS ON 6 INCHES OF AGGREGATE BASE MATERIAL.

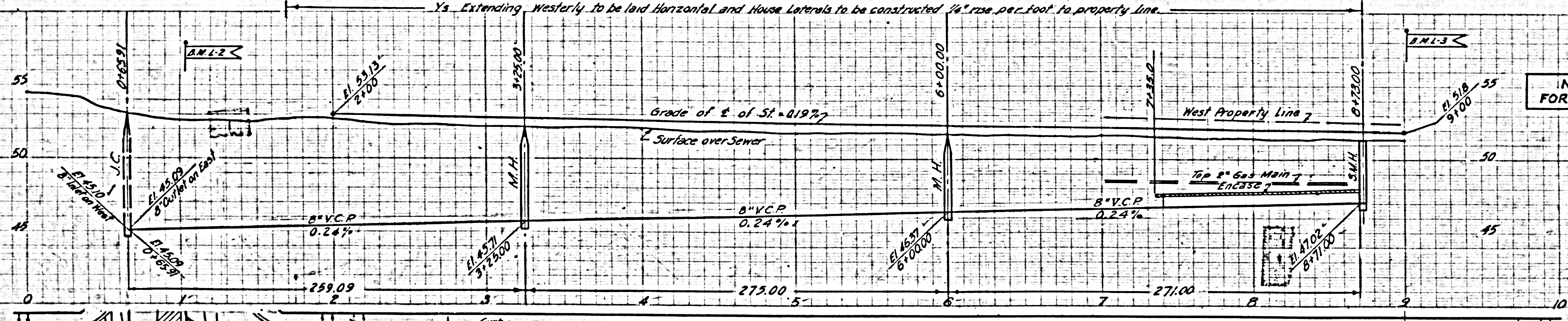

PG. 4577  
 PAGE 2

NO CHARGE FOR CONNECTIONS

26,159

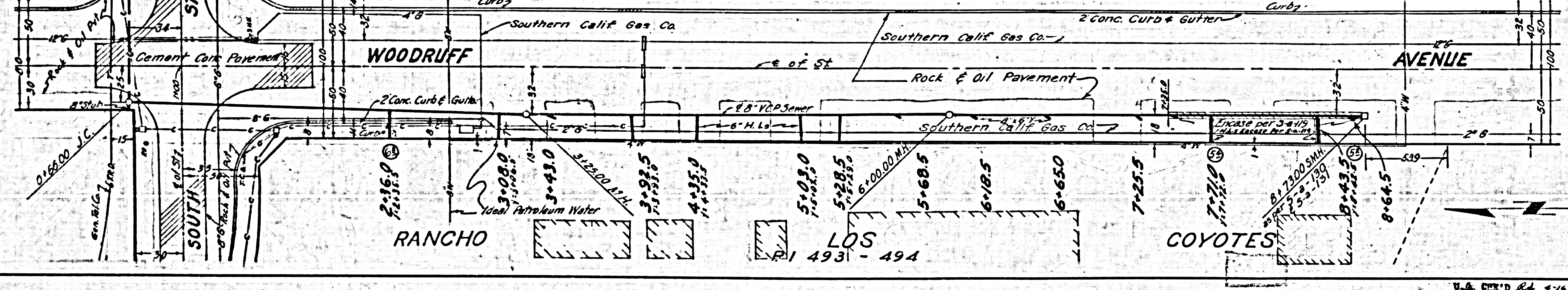

Drainage at Int. Poor Rest. Zone - C-4  
 F.B. 2160 Profile 95-104 Top 17, 01, 7-08 2-19, 23, 7-22

U.S. CEN'D Rd. 3-16-58  
 B.M.'S CHECK'D 6-11-58

26,160

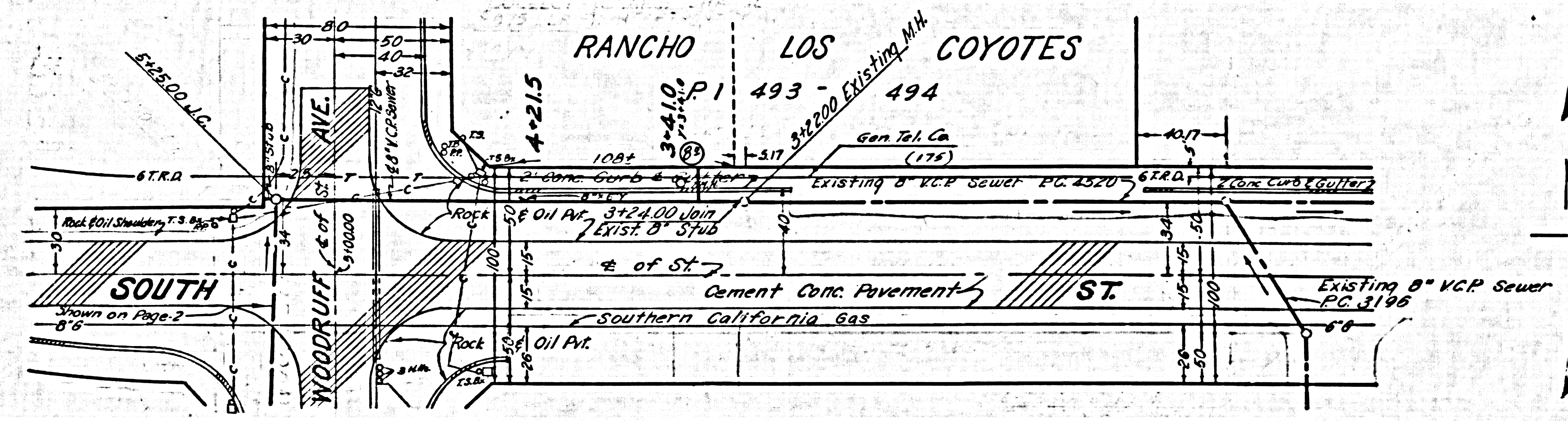
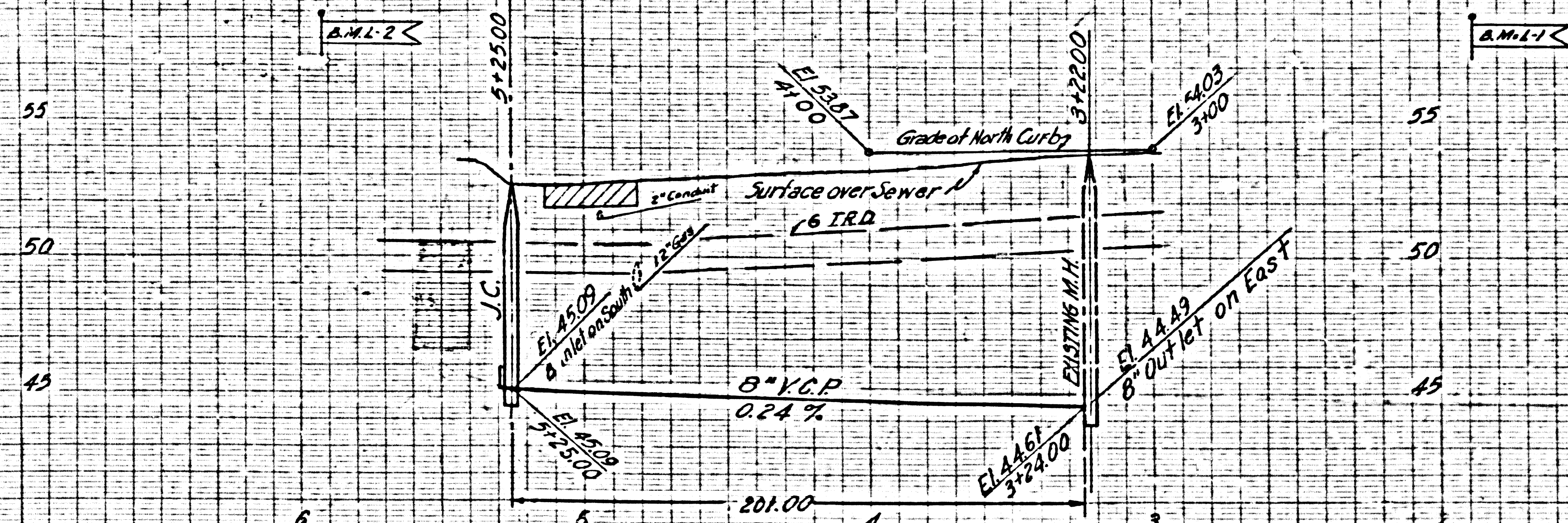

FB 2180 Profile by 85-114  
7/17/58  
P. 457Z

U.S. CH'D 2-28-58  
D. M'S CH'D 2-11-58

WOODRUFF AVE

SOUTH STREET

SEE 3 OF 3 SHEETS

PC 457Z